

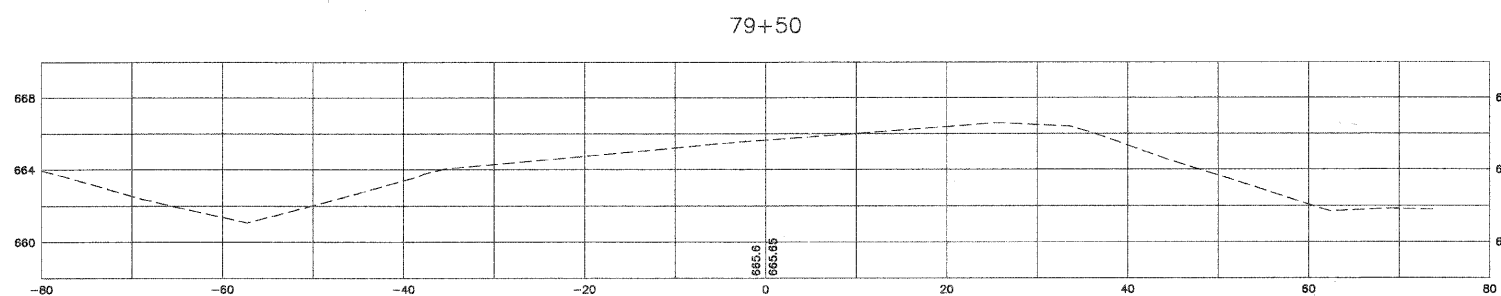

F.A.U. RTE.	SECTION	COUNTY	TOTAL SHEETS	SHEET NO.
1680	05-00038-00-PV	KANE/KENDALL	130	124
STA.		TO STA.		
FED. ROAD DIST. NO. -		ILLINOIS	FED. AID PROJECT	

PLAN	SURVEYED	BY	DATE
NOTE BOOK NO.	PLOTTED		
	CHECKED		
	BY		
	DATE		
	CADD FILE NAME		

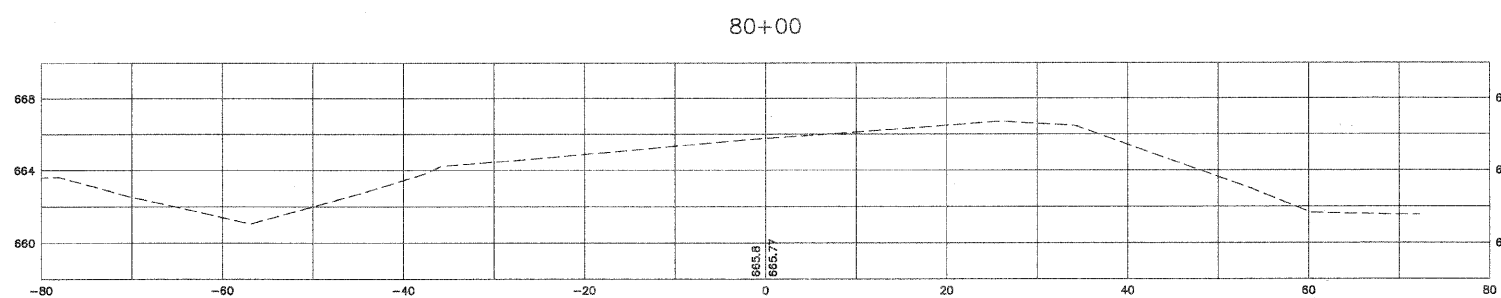
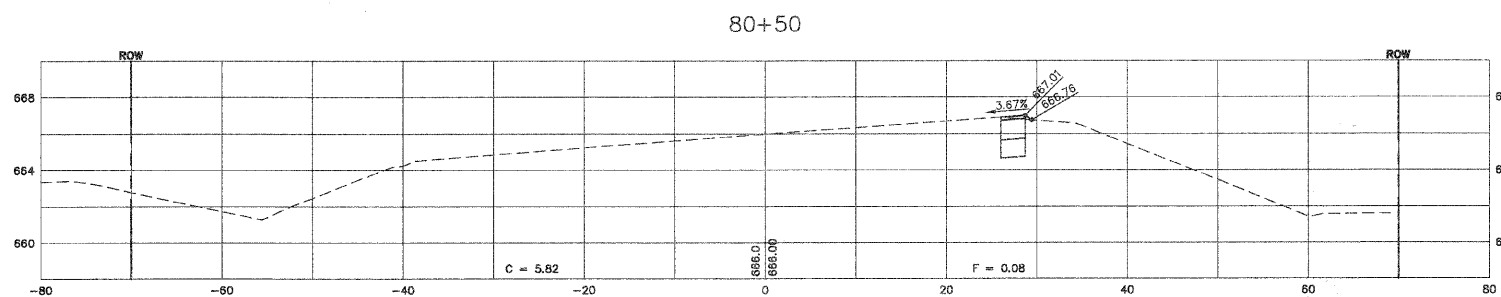

PROFILE	SURVEYED	BY	DATE
NOTE BOOK NO.	PLOTTED		
	CHECKED		
	BY		
	DATE		
	STRUCTURE NOTATIONS CHKD		

SCALE:
 HORIZONTAL 1" = 10'
 VERTICAL 1" = 5'

REVISIONS		ILLINOIS DEPARTMENT OF TRANSPORTATION	
NAME	DATE	<h1>ORCHARD ROAD CROSS SECTIONS</h1>	
SCALE:		DRAWN BY: KKP	
DATE: 03-26-09		CHECKED BY: TWW	