

### LEGEND

WORK AREA	(A) TEMPORARY PAVEMENT MARKING - LINE 4" (DOUBLE YELLOW)
COMPLETED TEMPORARY PAVEMENT	(B) TEMPORARY PAVEMENT MARKING - LINE 4" (SOLID WHITE)
COMPLETED PAVEMENT	(C) TEMPORARY PAVEMENT MARKING - LINE 4" (SOLID YELLOW)
COMPLETED TEMP. RESURFACING	(D) TEMPORARY PAVEMENT MARKING - LINE 6" (SKID-DASH WHITE)
DIRECTION OF TRAFFIC	(E) TEMPORARY PAVEMENT MARKING - LINE 6" (SOLID WHITE)
TRAILER MOUNTED ARROW BOARD	(F) TEMPORARY PAVEMENT MARKING - LINE 6" (2' DASH 6' SKIP, WHITE)
TYPE II BARRICADES WITH STEADY BURN LIGHT	CONSTRUCTION SIGN
TYPE III BARRICADE	VERTICAL PANEL

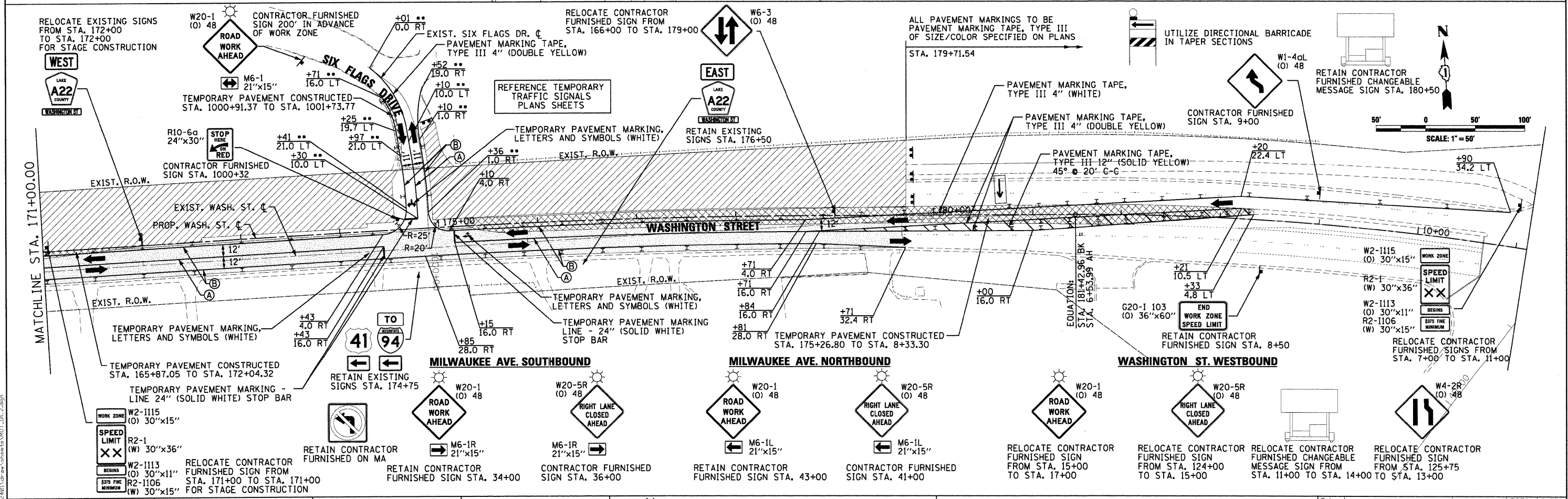
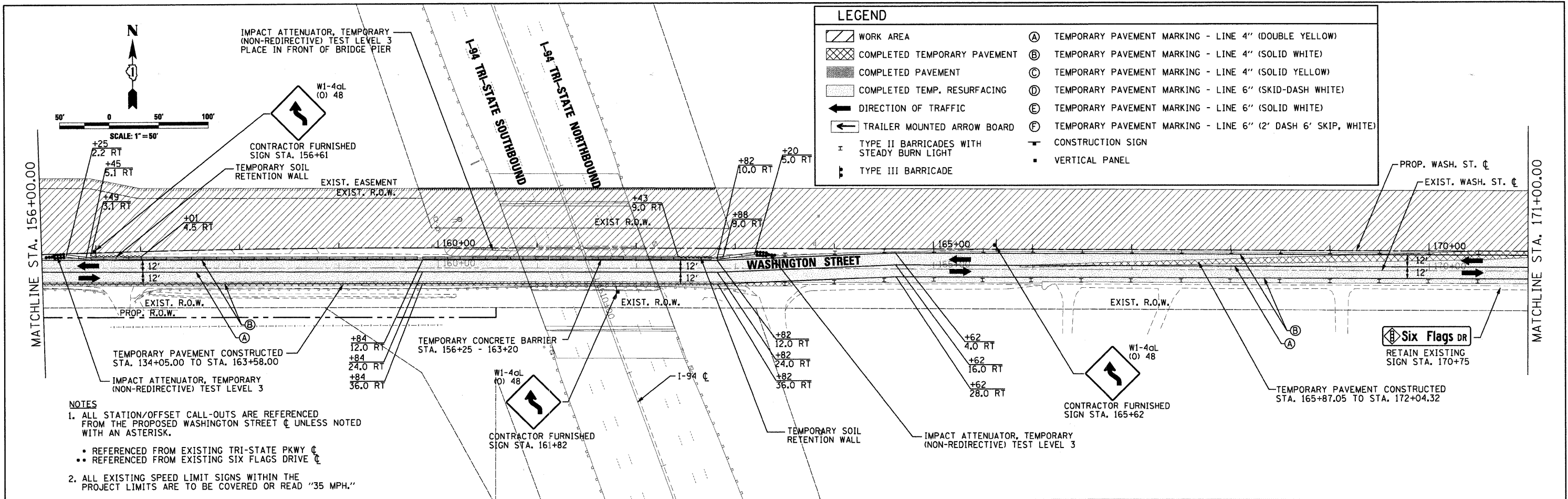

 <b>CMT</b> CRANFORD, MURPHY & TILLY, INC. CONSULTING ENGINEERS License No. 184-000613	USER NAME = Monica Crisman DESIGNED - SJP DRAWN - SJP CHECKED - KDN DATE - 07/15/09	REVISIONS REVISIONS REVISIONS REVISIONS	 <b>Lake County</b> Division of Transportation	<b>MAINTENANCE OF TRAFFIC STAGE 1A PLAN</b> SCALE: 50'=1" SHEET NO. 10 OF 24 SHEETS STA. 156+00 TO STA. 11+11.03		F.A. RTE. 1016 SECTION 02-00110-12-WR COUNTY LAKE TOTAL SHEETS 206 SHEET NO. 37 CONTRACT NO. 63209
	FEDERAL ROAD DIST. NO. 1 (ILLINOIS) FED. AID PROJECT					