

LEGEND:

- GRADING LIMIT
- ▨ GRADING AREA ON CENTERPOINT PROPERTY
- EXISTING CONTOUR
- PROPOSED CONTOUR

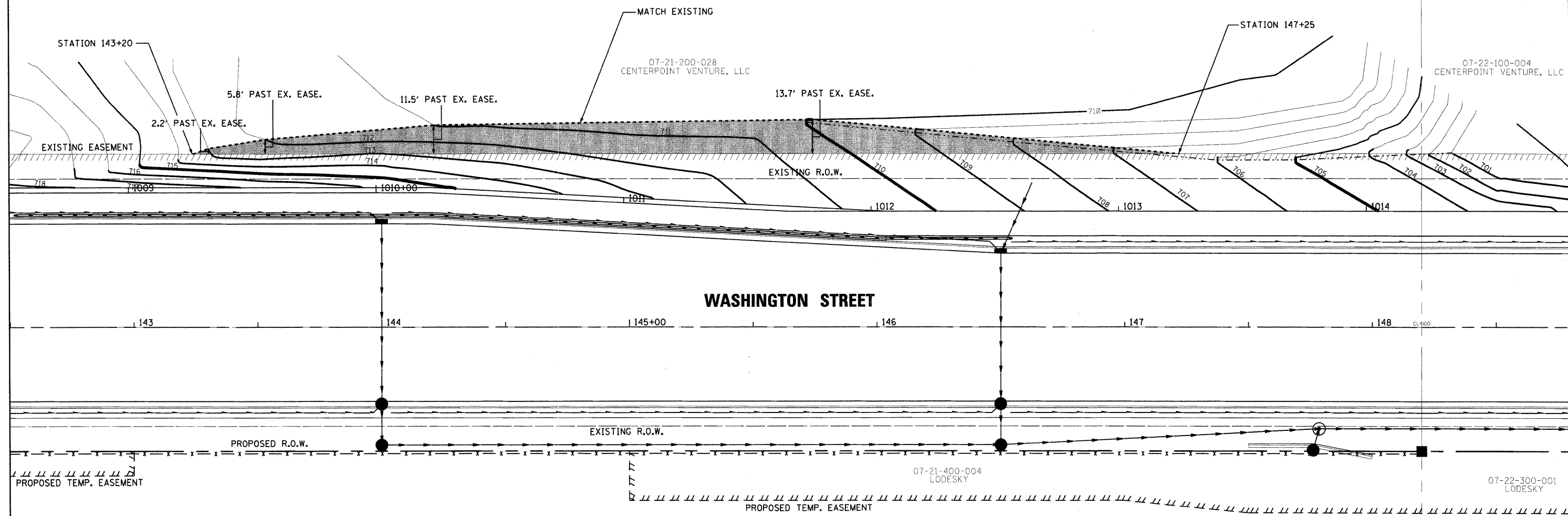
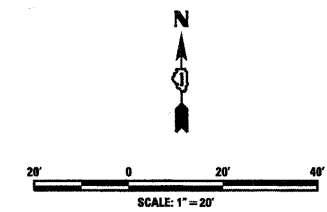

NOTES:

1. REFERENCE PROPOSED DRAINAGE PLAN SHEETS FOR DETAILS ASSOCIATED WITH PROPOSED DRAINAGE SYSTEM.
2. REFERENCE PROPOSED CROSS-SECTIONS FOR ADDITIONAL GRADING INFORMATION.
3. CONTRACTOR ACCESS TO CENTERPOINT PROPERTY SHALL BE LIMITED TO THE GRADING LIMIT DEPICTED ON THIS PLAN.

FILE NAME = I:\Lakeco\0822101\Draw\Utilities\CD_05.dgn

CMT <small>© Copyright CMT, Inc. CRAWFORD, MURPHY & TILLY, INC. CONSULTING ENGINEERS License No. 184-00063</small>	USER NAME = Steve Prange	DESIGNED - SJP	REVISED -	Lake County Division of Transportation	GRADING PLAN			F.A. RTE.	SECTION	COUNTY	TOTAL SHEETS	SHEET NO.
	PLOT SCALE = 20.0000' / IN.	DRAWN - SJP	REVISED -		SCALE: N.T.S.	SHEET NO. 3 OF 3 SHEETS	STA. N/A	TO STA. N/A	1016	02-00110-12-WR	LAKE	206
PLOT DATE = 05/29/09	CHECKED - KDN	REVISED -					CONTRACT NO. 63209			FED. ROAD DIST. NO. 1 ILLINOIS FED. AID PROJECT		
	DATE - 05/29/09	REVISED -										