

PROPOSED 2-CC E.O.P. POINTS	
Ⓝ	STA. 15+87.78, 30.4' LT. (TRI-STATE)
Ⓧ	STA. 140+81.23, 40.4' LT. (WASH)
Ⓜ	STA. 140+17.67, 30.0' LT. (WASH)

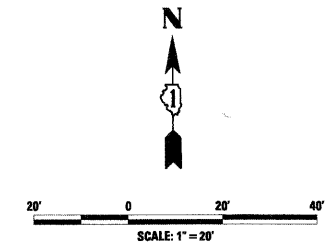

PROPOSED 2-CC E.O.P. POINTS	
Ⓝ	STA. 142+23.29, 42.0' LT. (WASH)
Ⓐ	STA. 15+57.78, 45.7' LT. (TRI-STATE)
Ⓟ	STA. 16+02.98, 30.4' RT. (TRI-STATE)

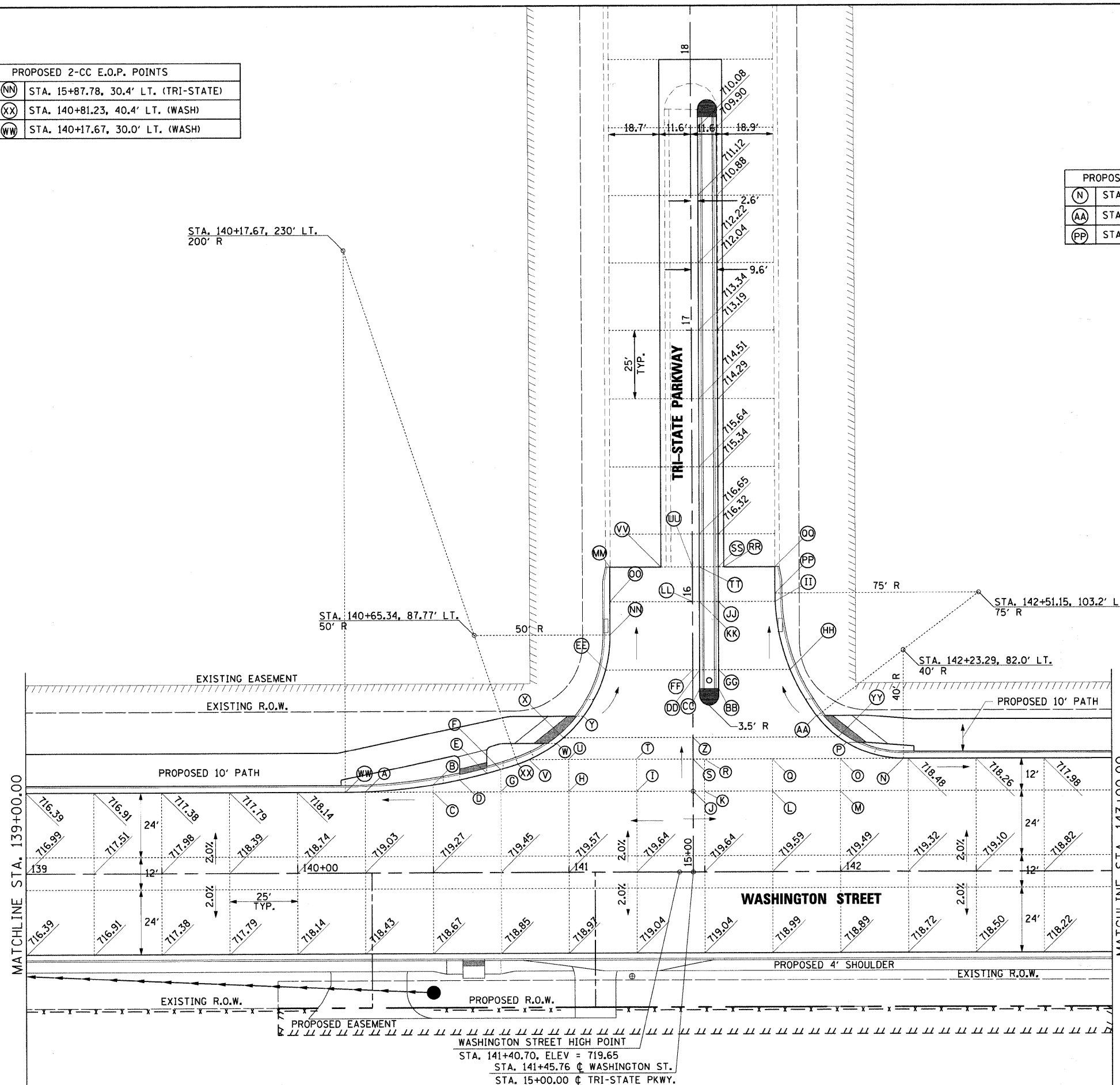

	STATION	OFFSET	ELEVATION
A	140+25.00	30.0' LT.	718.43
B	140+50.00	32.6' LT.	718.63
C	140+50.00	30.0' LT.	718.67
D	140+59.81	34.5' LT.	718.67
E	140+69.81	36.9' LT.	718.64
F	140+75.00	38.4' LT.	718.61
G	140+75.00	30.0' LT.	718.85
H	141+00.00	30.0' LT.	718.97
I	141+25.00	30.0' LT.	719.04
J	141+45.76	30.0' LT.	719.05
K	141+50.00	30.0' LT.	719.04
L	141+75.00	30.0' LT.	718.99
M	142+00.00	30.0' LT.	718.89
N	SEE 2-CENTERED CURVE TABLE		718.51
O	15+42.00	54.2' RT.	718.41
P	15+47.95	56.5' RT.	718.17
Q	15+42.00	29.2' RT.	718.63
R	15+42.00	4.2' RT.	718.80
S	15+42.00	0.0' LT.	718.81
T	15+42.00	20.8' LT.	718.77
U	15+42.00	45.8' LT.	718.55
V	15+42.00	60.3' LT.	718.45
W	15+47.96	50.2' LT.	718.27
X	15+50.00	47.7' LT.	718.19
Y	15+57.96	40.3' LT.	717.91
Z	15+50.00	0.0' LT.	718.63
AA	SEE 2-CENTERED CURVE TABLE		717.83
BB	15+68.00	9.6' RT.	718.03
CC	15+68.00	2.6' RT.	718.27
DD	15+75.00	2.6' RT.	718.10
EE	15+75.00	32.0' LT.	717.41
FF	15+75.00	0.0' LT.	718.05
GG	15+75.00	9.6' RT.	717.86
HH	15+75.00	35.9' RT.	717.33
II	16+00.00	30.5' RT.	716.82
JJ	16+00.00	9.6' RT.	717.24
KK	16+00.00	2.6' RT.	717.48
LL	16+00.00	0.0' LT.	717.43
MM	16+12.78	30.4' LT.	716.27
NN	SEE 2-CENTERED CURVE TABLE		717.11
OO	16+00.00	30.4' LT.	716.82
PP	SEE 2-CENTERED CURVE TABLE		716.69
QQ	16+12.78	30.4' RT.	716.28
RR	16+12.78	11.6' RT.	716.81
SS	16+12.78	9.6' RT.	716.85
TT	16+12.78	2.6' RT.	717.18
UU	16+12.78	0.0' LT.	717.11
VV	16+12.78	11.6' LT.	716.79
WW	SEE 2-CENTERED CURVE TABLE		718.35
XX	SEE 2-CENTERED CURVE TABLE		718.58
YY	15+50.00	53.5' RT.	718.10

FILE NAME: I:\Lakeco\0822-01\Draw\Sheets\N1.dwg



USER NAME = Steve Prange	DESIGNED - SJP	REVISIONS
PLOT SCALE = 20.0000' / IN.	DRAWN - SJP	REVISIONS
PLOT DATE = 05/29/09	CHECKED - KON	REVISIONS
	DATE - 05/29/09	REVISIONS



**TRI-STATE PARKWAY
INTERSECTION PAVING PLAN**

SCALE: 20'=1" SHEET NO. 1 OF 1 SHEETS STA. 139+00.00 TO STA. 143+00.00

F.A. RTE.	SECTION	COUNTY	TOTAL SHEETS	SHEET NO.
1016	02-00110-12-WR	LAKE	206	84
CONTRACT NO. 63209				
FED. ROAD DIST. NO. 1 ILLINOIS FED. AID PROJECT				