

DATE	
BY	
APPROVED	
PLOTTED	
TEMPLATE	
AREAS	
CHECKED	
NO.	

DATE	
BY	
APPROVED	
PLOTTED	
TEMPLATE	
AREAS	
CHECKED	
NO.	

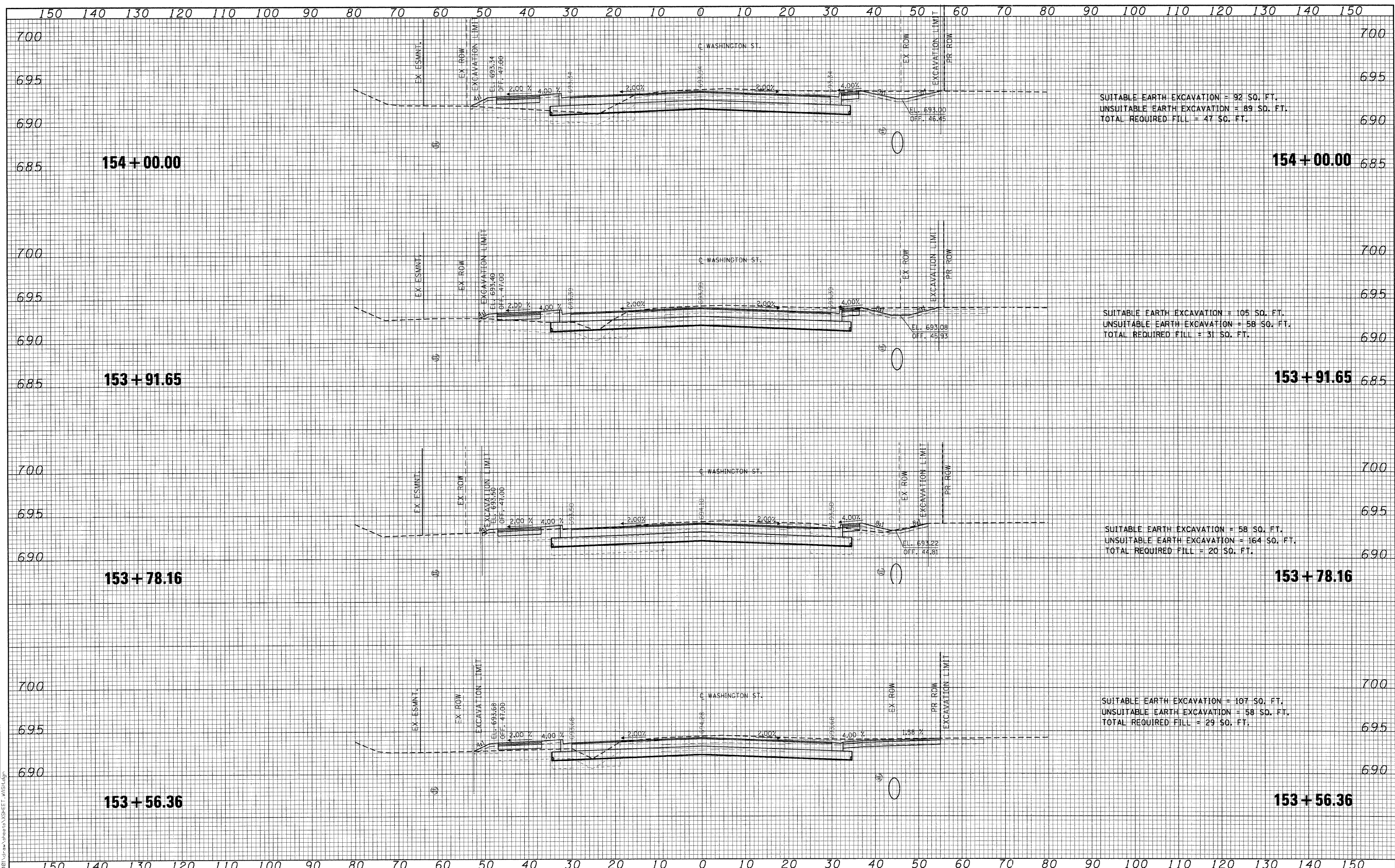

SUITABLE EARTH EXCAVATION = 92 SQ. FT.
 UNSUITABLE EARTH EXCAVATION = 89 SQ. FT.
 TOTAL REQUIRED FILL = 47 SQ. FT.

SUITABLE EARTH EXCAVATION = 105 SQ. FT.
 UNSUITABLE EARTH EXCAVATION = 58 SQ. FT.
 TOTAL REQUIRED FILL = 31 SQ. FT.

SUITABLE EARTH EXCAVATION = 58 SQ. FT.
 UNSUITABLE EARTH EXCAVATION = 164 SQ. FT.
 TOTAL REQUIRED FILL = 20 SQ. FT.

SUITABLE EARTH EXCAVATION = 107 SQ. FT.
 UNSUITABLE EARTH EXCAVATION = 58 SQ. FT.
 TOTAL REQUIRED FILL = 29 SQ. FT.

FILE NAME = I:\Lakeco\002240\Urban\Utilities\ASB\ASB.dgn

CMT
 CRAWFORD, MURPHY & TILLY, INC.
 CONSULTING ENGINEERS
 License No. 184-000613

USER NAME = Steve Prange
 PLOT SCALE = 10.0000' / 1".
 PLOT DATE = 05/23/09

DESIGNED - SJP
 DRAWN - SJP
 CHECKED - KDN
 DATE - 05/29/09

REVISED -
 REVISED -
 REVISED -
 REVISED -



WASHINGTON STREET - CROSS SECTION
 SCALE: 10H:5V SHEET NO. OF SHEETS STA. 153+56.36 TO STA. 154+00.00

F.A. RTE. 1016	SECTION 02-00110-12-WR	COUNTY LAKE	TOTAL SHEETS 206	SHEET NO. 141
FED. ROAD DIST. NO. 1 ILLINOIS FED. AID PROJECT			CONTRACT NO. 63209	