

F.A.P. RTE.	SECTION	COUNTY	SHEET NO.
379	06-00187-06-BT	COOK	2
FED. ROAD DIST. NO.		ILLINOIS	FED. AID PROJECT

**TRAFFIC SIGNAL LEGEND**

	PROPOSED	EXISTING
CONTROLLER	[Symbol]	[Symbol]
SERVICE INSTALLATION	[Symbol]	[Symbol]
SIGNAL HEAD	[Symbol]	[Symbol]
SIGNAL HEAD WITH BACKPLATE	[Symbol]	[Symbol]
SIGNAL HEAD, PEDESTRIAN	[Symbol]	[Symbol]
SIGNAL POST	[Symbol]	[Symbol]
MAST ARM ASSEMBLY AND POLE, STEEL	[Symbol]	[Symbol]
MAST ARM ASSEMBLY AND POLE, ALUMINUM	[Symbol]	[Symbol]
COMBINATION MAST ARM ASSEMBLY AND POLE, STEEL WITH LUMINAIRE	[Symbol]	[Symbol]
UNIT DUCT	[Symbol]	[Symbol]
COMMON TRENCH	[Symbol]	[Symbol]
HANDHOLE	[Symbol]	[Symbol]
HEAVY DUTY HANDHOLE	[Symbol]	[Symbol]
DOUBLE HANDHOLE	[Symbol]	[Symbol]
G.S. CONDUIT IN TRENCH (T) OR PUSHED (P)	[Symbol]	[Symbol]
PEDESTRIAN PUSHBUTTON DETECTOR	[Symbol]	[Symbol]
DETECTOR LOOP	[Symbol]	[Symbol]
CAST IRON JUNCTION BOX	[Symbol]	[Symbol]
EMERGENCY VEHICLE LIGHT DETECTOR	[Symbol]	[Symbol]
CONFIRMATION BEACON	[Symbol]	[Symbol]
SIGNAL HEAD OPTICALLY PROGRAMMED	[Symbol]	[Symbol]
CONDUIT SPLICE	[Symbol]	[Symbol]
WOOD POLE	[Symbol]	[Symbol]
RACEWAY FOR MAGNETIC DETECTOR, TYPE I OR TYPE II	[Symbol]	[Symbol]
VEHICLE DETECTOR, NON COMPENSATED MAGNETIC TYPE	[Symbol]	[Symbol]
RAILROAD CONTROL CABINET	[Symbol]	[Symbol]
TELEPHONE CONNECTION	[Symbol]	[Symbol]
ILLUMINATED SIGN "NO LEFT TURN"	[Symbol]	[Symbol]
ILLUMINATED SIGN "NO RIGHT TURN"	[Symbol]	[Symbol]
UNINTERRUPTIBLE POWER SUPPLY	[Symbol]	[Symbol]

**GENERAL NOTES**

- CONTRACTOR'S ATTENTION IS DRAWN TO DETECTOR LOOP DIVE HOLES THAT MAYBE WITHIN OR UNDER CURB TO BE REMOVED & REPLACED (ANY DAMAGE CAUSED TO DETECTOR LOOP LEAD-IN CABLE OR RACEWAYS SHALL BE REPAIRED BY CONTRACTOR AT THEIR EXPENSE. NO ADDITIONAL COMPENSATION WILL BE ALLOWED)
- DETECTABLE WARNING PLATES SHALL BE SUPPLIED AT ALL DEPRESSED CURB CUTS AS REQUIRED BY THE VILLAGE OF ARLINGTON HEIGHTS FROM THE MANUFACTURER IDENTIFIED IN THE SPECIAL PROVISIONS. (TYP)
- ADDED NOTES:
  - THE CONTRACTOR SHALL INFORM THE CHD DESIGN ENGINEER AT (312)603-1730 PRIOR TO THE START OF ANY WORK ON THE CONTRACT. A MINIMUM OF FIVE (5) WORKING DAYS ADVANCE NOTICE IS REQUIRED.
  - THE CONTRACTOR SHALL MARK LOCATIONS OF LOOPS AND CONTACT THE COUNTY DESIGN ENGINEER AT (312)603-1730 FOR LOCATION APPROVAL PRIOR TO CUTTING OF THE LOOPS. A MINIMUM OF FIVE (5) WORKING DAYS ADVANCE NOTICE IS REQUIRED.
  - IT IS THE CONTRACTOR'S RESPONSIBILITY TO LOCATE EXISTING TRAFFIC SIGNAL CABLES AND CONDUITS.
  - ALL ELECTRICAL CABLE SHALL HAVE A POLYVINYL CHLORIDE JACKET.
  - CARE IS TO BE TAKEN AS NOT TO DAMAGE ANY OF THE EXISTING TRAFFIC SIGNAL CONDUIT AND EQUIPMENT. IF ANY OF THE TRAFFIC SIGNAL CONDUIT AND EQUIPMENT IS DAMAGED, THE CONTRACTOR SHALL REPAIR AND/OR REPLACE THE CONDUIT AND/OR EQUIPMENT AT NO COST TO THE COUNTY.
- INSTALL (30"x30") W11-1 WITH SUPPLEMENTARY (24"x12") W16-7p BICYCLE CROSSING WARNING SIGNS
- PRIOR TO CONSTRUCTION A MEETING WILL BE HELD AT THE JOB SITE WITH REPRESENTATIVES OF THE COOK COUNTY HIGHWAY DEPARTMENT, TRAFFIC SIGNAL SECTION TO FIELD VERIFY THE THAT THE EXISTING TRAFFIC SIGNAL CONTROLLER IS COMPATIBLE WITH THE PROPOSED EMERGENCY VEHICLE PREEMPTION EQUIPMENT, AND CONFIRM INSTRUCTIONS FOR REWIRING THE RETROFITTED SIGNAL HEADS.
- THE CONTRACTOR WILL BE RESPONSIBLE TO ACQUIRE ALL NECESSARY PERMITS OR BONDS AND TO SATISFY THE REQUIREMENTS OF THE COOK COUNTY HIGHWAY DEPARTMENT AND LAKE COUNTY FOREST PRESERVE DISTRICT.

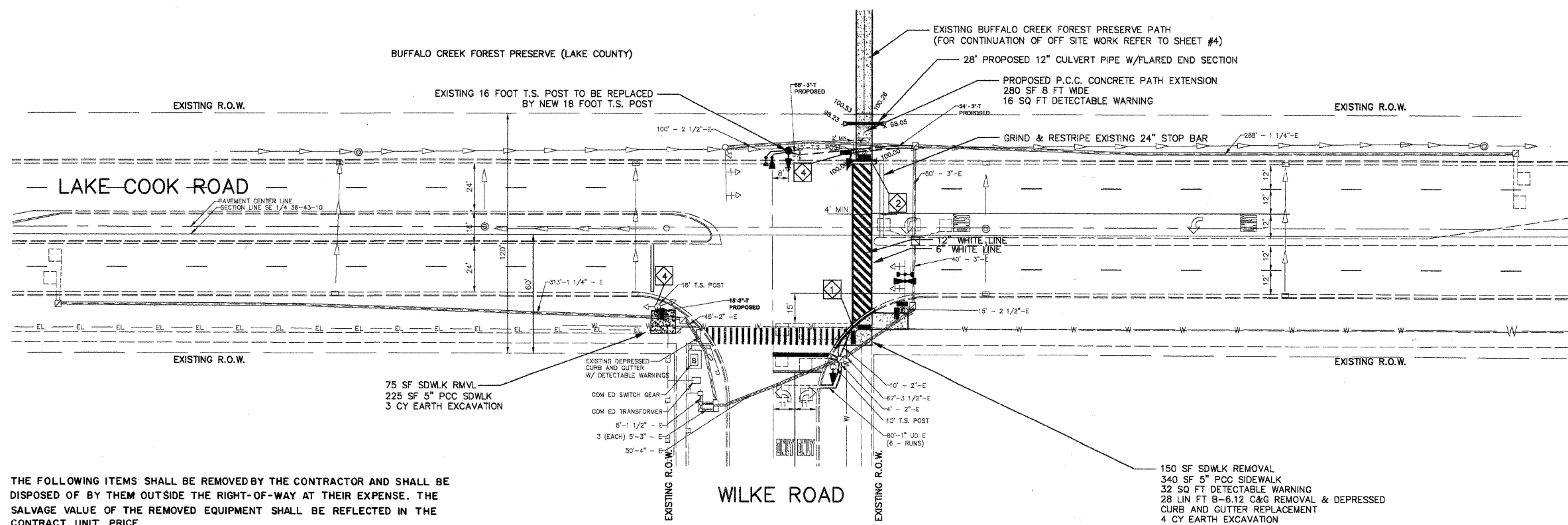

THE FOLLOWING ITEMS SHALL BE REMOVED BY THE CONTRACTOR AND SHALL BE DISPOSED OF BY THEM OUTSIDE THE RIGHT-OF-WAY AT THEIR EXPENSE. THE SALVAGE VALUE OF THE REMOVED EQUIPMENT SHALL BE REFLECTED IN THE CONTRACT UNIT PRICE.

- EACH TRAFFIC SIGNAL POST

RESTORATION OF WORK AREA. RESTORATION OF THE TRAFFIC SIGNAL WORK AREA SHALL BE INCIDENTAL TO THE RELATED PAY ITEM SUCH AS FOUNDATION, CONDUIT, HANDHOLE, TRENCH AND BACKFILL, ETC., AND NO EXTRA COMPENSATION SHALL BE ALLOWED. ALL ROADWAY SURFACES SUCH AS SHOULDERS, MEDIANS, SIDEWALKS, PAVEMENT, ETC. SHALL BE REPLACED IN KIND. ALL DAMAGE TO MOWED LAWNS SHALL BE REPLACED WITH AN APPROVED SOD, AND ALL DAMAGE TO UNMOWED FIELDS SHALL BE SEEDED IN ACCORDANCE WITH STANDARD SPECIFICATIONS 252 AND 250 RESPECTIVELY.

REVISIONS	
NAME	DATE

VILLAGE OF ARLINGTON HEIGHTS  
**TRAFFIC SIGNAL PLAN**

DATE: 05/20/2009  
DESIGNED BY: T. PONSBOT  
DRAWN BY: C. HORNUTH  
CHECKED BY: J. MASSARELLI P.E.

1" = 20' (HORIZ.)  
1" = 5' (VERT.)

DRAWING NAME: \\c:\a\h\engineering\BENG\CON\CA\04\Buffalo Creek\_Plan2009.dwg