

F.A.P. RTE.	SECTION	COUNTY	SHEET NO.
379	08-00187-00-BT	COOK	4
FED. ROAD DIST. NO.		ILLINOIS	FED. AID PROJECT

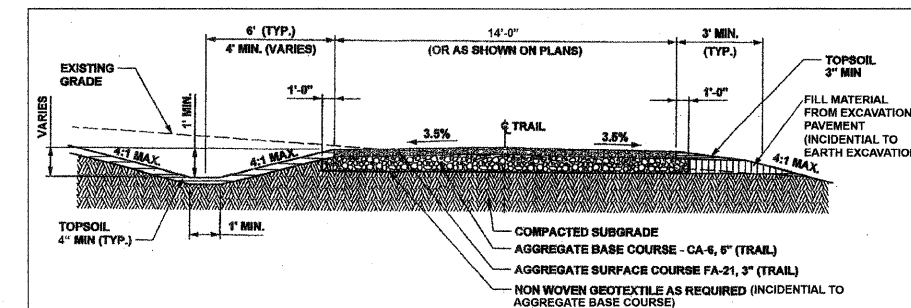

PROPOSED TYPICAL SECTION - BIKE PATH

- NOTES:**
1. ALL PORTIONS OF THE PROPOSED TRAIL SHALL BE INSTALLED AT OR BELOW EXISTING GRADE, EXCEPT WHERE PROPOSED GRADES ARE SHOWN ON PLANS.
 2. ALL DITCHES SHALL BE PLANTED WITH NATIVE VEGETATION AND COVERED WITH A BIODEGRADABLE EROSION CONTROL BLANKET (DS-75 STRAW BLANKET, NORTH AMERICAN GREEN WHICH PRICE SHALL BE INCIDENTAL TO SEEDING, CLASS 1 MODIFIED.)
 3. PROFILE OF THE EXISTING BICYCLE TRAIL SHALL BE ESTABLISHED IN THE FIELD TO THE SATISFACTION OF THE LAKE COUNTY FOREST PRESERVE DEPARTMENT OF PLANNING CONSERVATION AND DEVELOPMENT

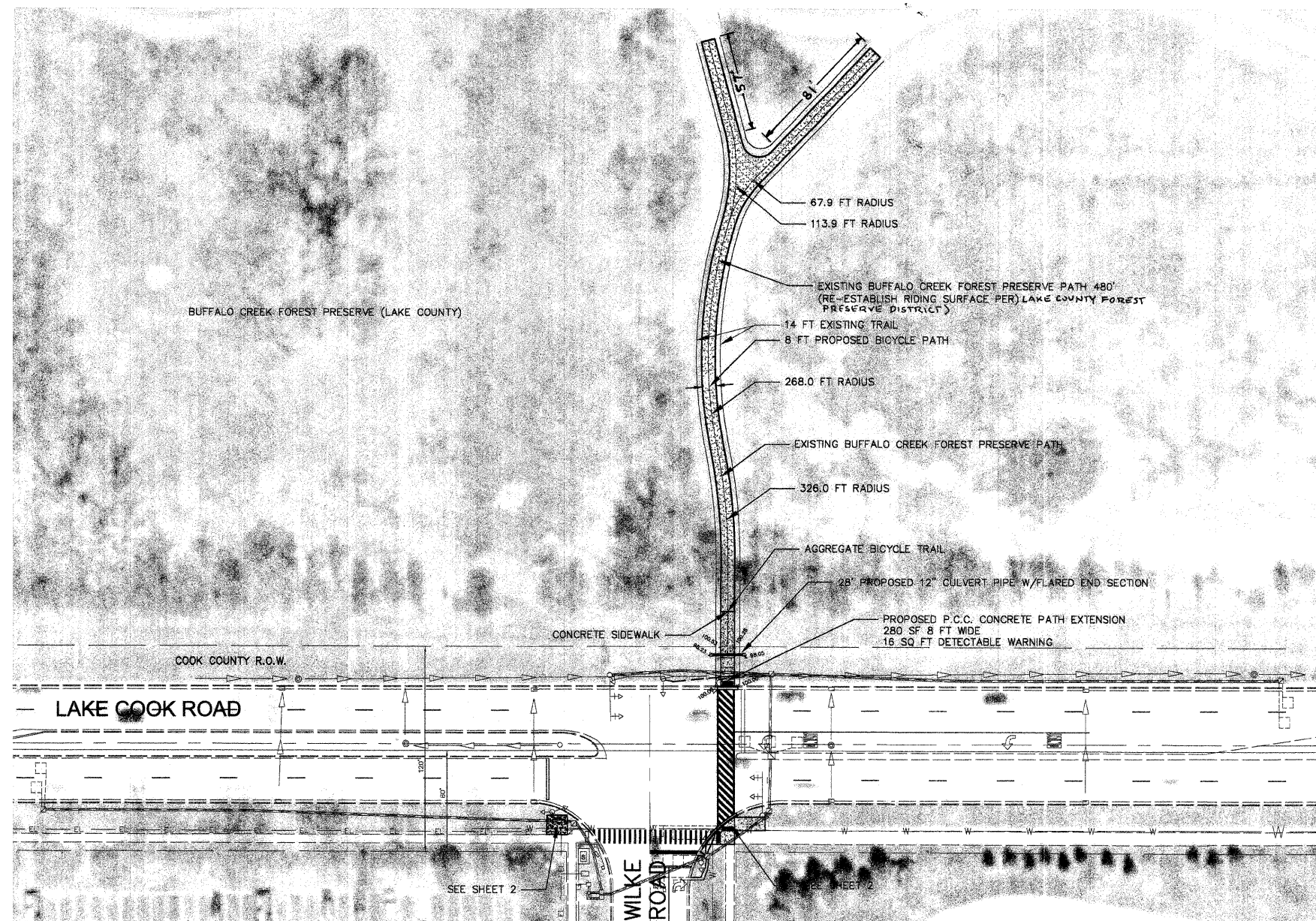
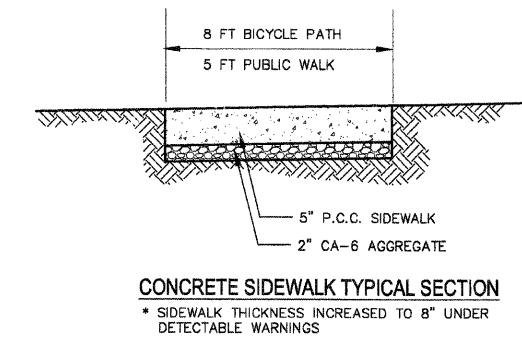

CONCRETE SIDEWALK TYPICAL SECTION
 * SIDEWALK THICKNESS INCREASED TO 8" UNDER DETECTABLE WARNINGS



DRAWING NAME: \\Chisler\engineering\ENG_COM\CMQAQ\Bicycle_Creek_Plan\Plan008.dwg

REVISIONS	
NAME	DATE

VILLAGE OF ARLINGTON HEIGHTS

BIKE PATH INSTALLATION PLAN

DATE: 05/20/2009
 DESIGNED BY: T. PONSOT
 DRAWN BY: C. HOWARTH
 CHECKED BY: J. MASSARELLI P.E.

0' 20' 40'

1" = 40' (HORIZ.)
 1" = 5' (VERT.)