

EXIST. CURVE 520  
 PI STA. = 417+03.88  
 $\Delta = 33^\circ 10' 21''$  (RT)  
 $D = 1^\circ 15' 01''$   
 $R = 4,582.89'$   
 $T = 1,365.02'$   
 $L = 2,653.35'$   
 $E = 198.97'$   
 $e = \text{-----}$   
 $T.R. = \text{-----}$   
 $S.E. RUN = \text{-----}$   
 $P.C. STA. = 403+38.86$   
 $P.T. STA. = 429+92.22$

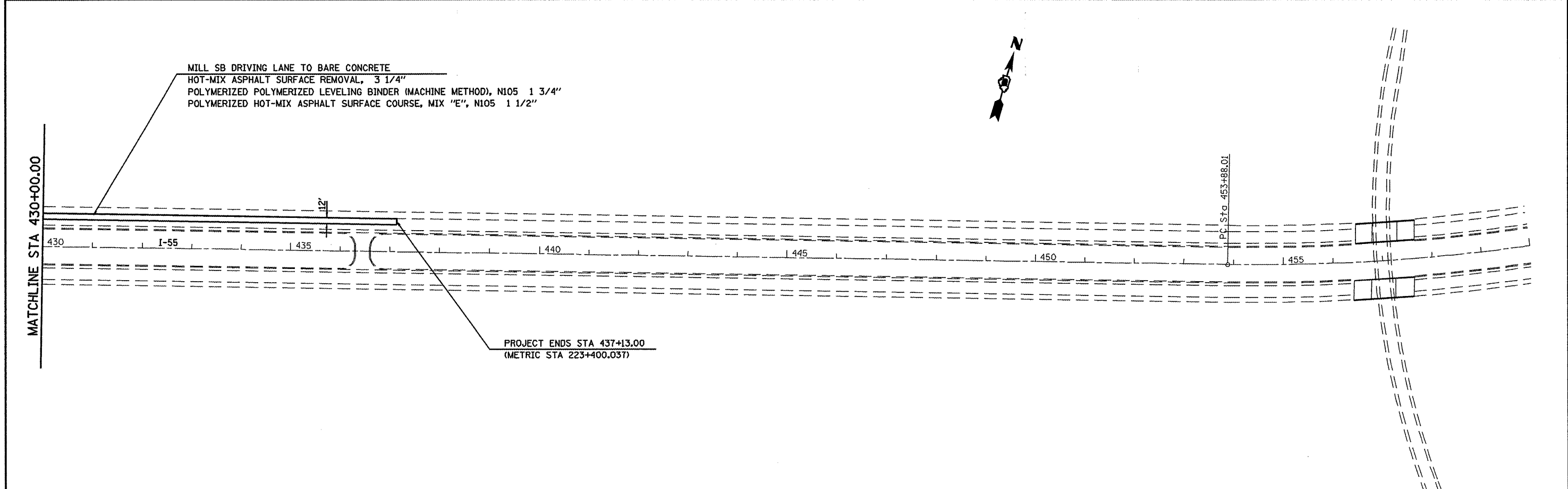

FILE NAME =	USER NAME = laughlinc1	DESIGNED -	REVISED -	<b>STATE OF ILLINOIS DEPARTMENT OF TRANSPORTATION</b>	<b>I-55 PLAN SHEET</b>			F.A.I. RTE.	SECTION	COUNTY	TOTAL SHEETS	SHEET NO.			
cr:\pwork\p\WIDOT\LAUGHLIN\140151730\0	72D16-shr-plan3.dgn	DRAWN -	REVISED -		SCALE: 1" = 100'	SHEET NO.	OF	SHEETS	STA.	TO STA.	55	(54-5,6)RS-1	LOGAN	8	7
	PLOT SCALE = 200.0000 // IN.	CHECKED -	REVISED -									CONTRACT NO. 72D16			
	PLOT DATE = Jul-31-2009 03:11:02PM	DATE -	REVISED -									ILLINOIS FED. AID PROJECT			