

TOP PLAN

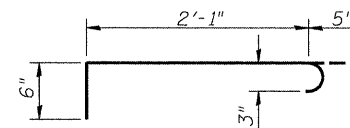

BAR s₄(E)

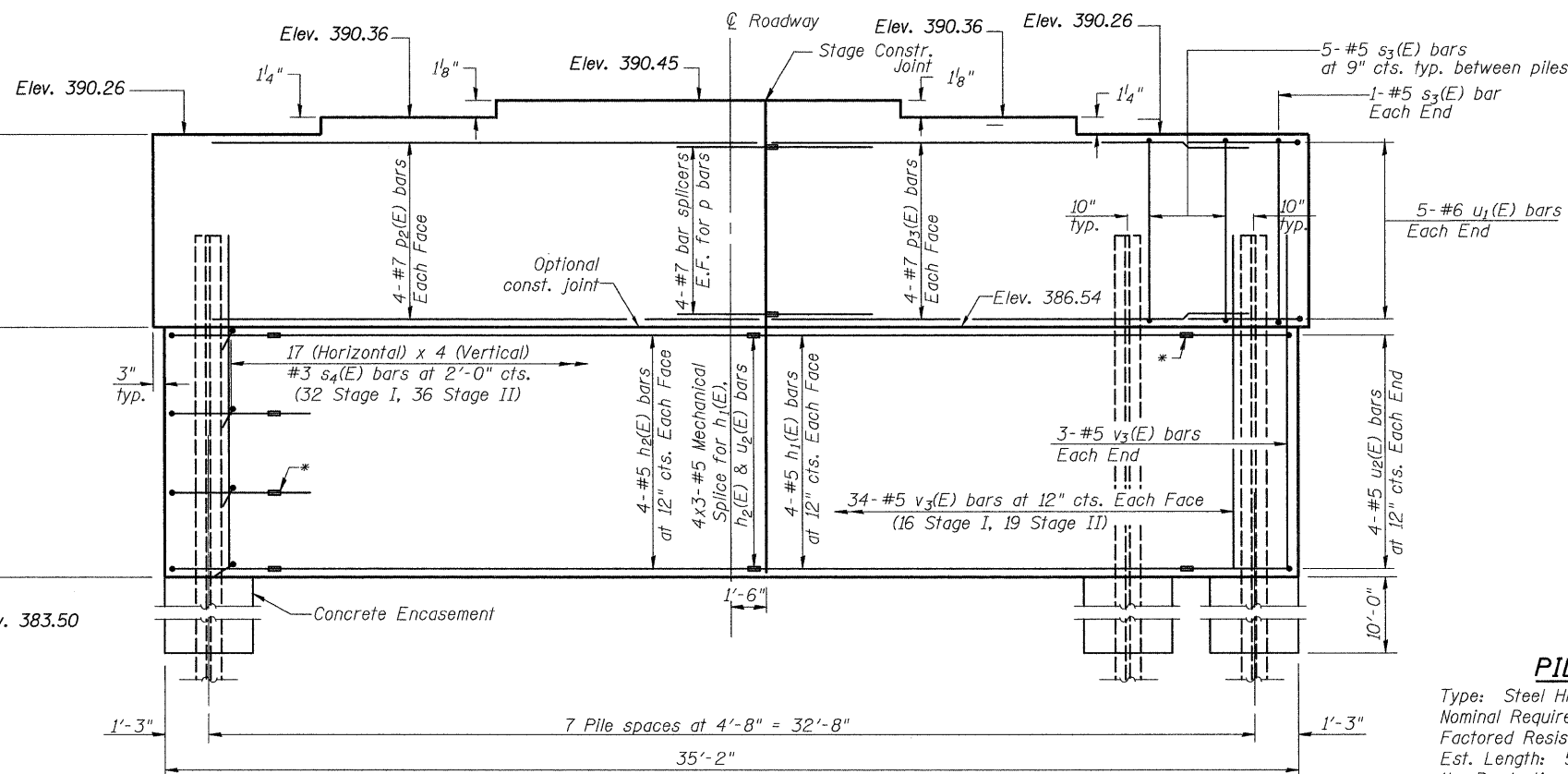

ELEVATION (Looking West)

* Mechanical Splice or Shop Welded per AWS D1.4

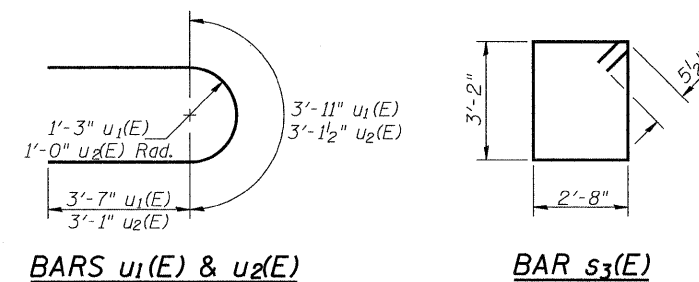

BARS u₁(E) & u₂(E)

BAR s₃(E)

BILL OF MATERIAL

Bar	No.	Size	Length	Shape
h ₁ (E)	8	#5	12'-6"	—
h ₂ (E)	8	#5	14'-0"	—
p ₂ (E)	8	#7	17'-8"	—
p ₃ (E)	8	#7	14'-8"	—
s ₃ (E)	37	#5	12'-7"	□
s ₄ (E)	68	#3	3'-0"	┌
u ₁ (E)	10	#6	11'-1"	U
u ₂ (E)	8	#5	9'-4"	U
v ₃ (E)	74	#5	4'-10"	—
Concrete Structures		Cu. Yd.	26.3	
Reinforcement Bars, Epoxy Coated		Pound	1900	
Furnishing Steel Piles, 14x73		Foot	399	
Driving Piles		Foot	399	
Test Pile, HP 14x73		Each	1	
Concrete Encasement		Cu. Yd.	14.6	
Bar Splicers		Each	8	
Mechanical Splice		Each	24	

PILE DATA

Type: Steel HP 14x73
Nominal Required Bearing: 578 kips
Factored Resistance Available: 185 kips
Est. Length: 57 ft.
No. Production Piles: 7
No. Test Piles: 1

Notes:
Space reinforcement in cap to miss anchor bolts. Pour steps monolithically with cap.
The Steel H Piles shall be according to AASHTO M270 Grade 50.
The Test Pile shall be driven to 110 percent of the nominal required bearing indicated in the Pile Data information.
For details of Bar Splicers, see sheet 18 of 23.
For details of piles and Concrete Encasement, see sheet 19 of 23.

Revised 5/21/09, PBB

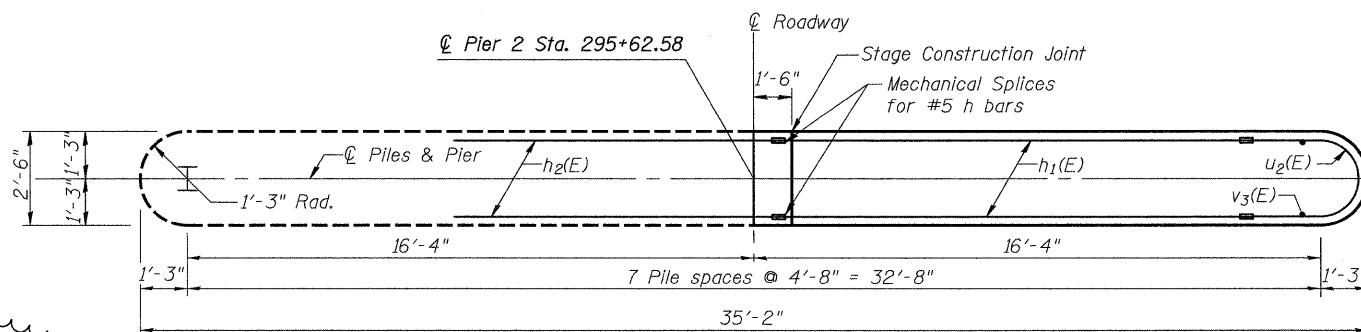

PILE LAYOUT & PIER PLAN

PIER 2
IL 15 OVER UNION DRAINAGE
DITCH OVERFLOW
WAYNE COUNTY
STATION 295+41.00
STRUCTURE NO. 096-0072

SHEET NO. 17 23 SHEETS	F.A.P. RTE. 823	SECTION (22BY2) B-1	COUNTY WAYNE	TOTAL SHEETS 142	SHEET NO. 54
	CONTRACT NO. 74238			FED. ROAD DIST. NO. ILLINOIS FED. AID PROJECT	