

LEGEND

XXX.XX INDICATES PROPOSED GRADE ELEVATION  
INTERVAL AROUND CURVES IS 20'  
UNLESS NOTED

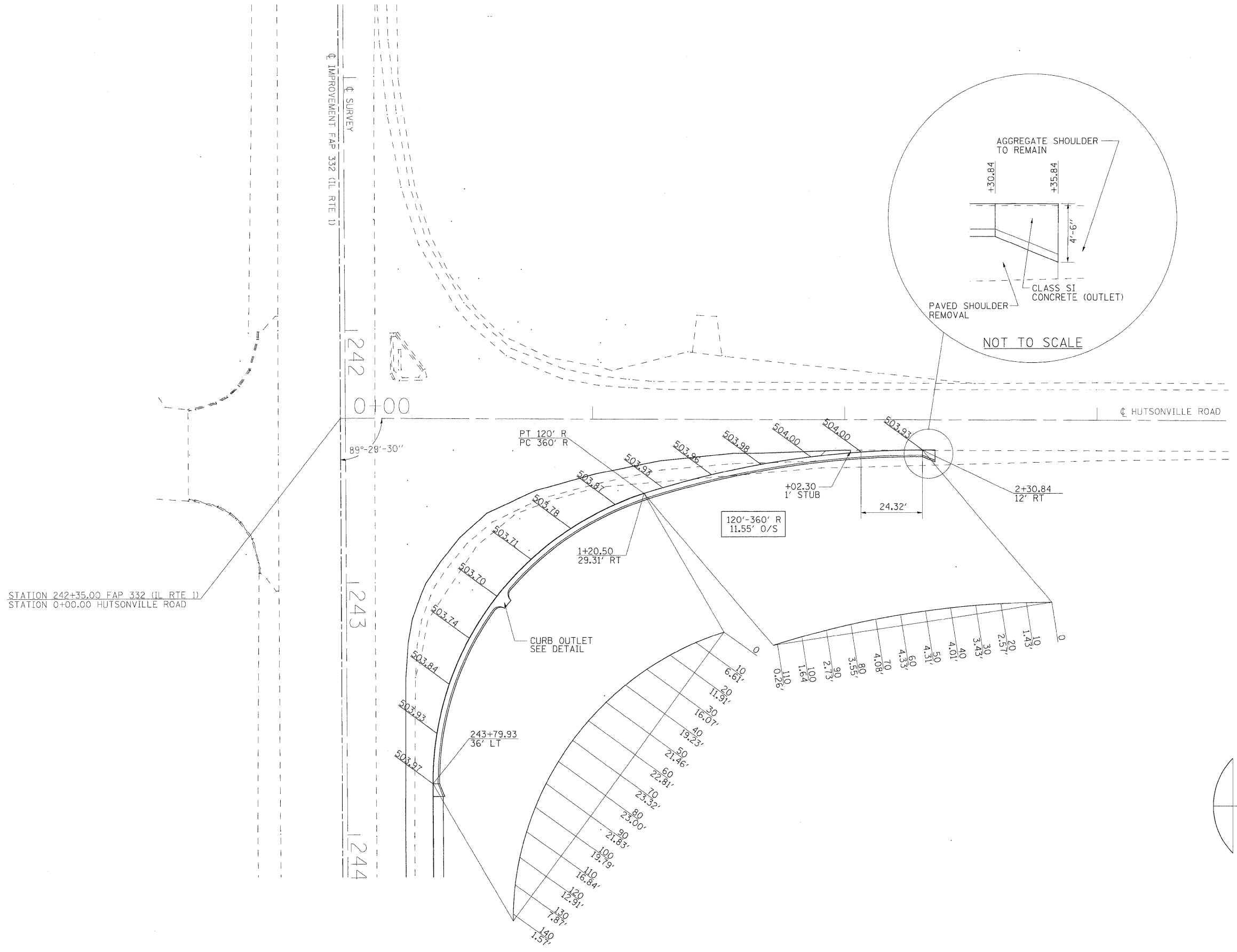

STATION 242+35.00 FAP 332 (IL RTE 1)  
STATION 0+00.00 HUTSONVILLE ROAD

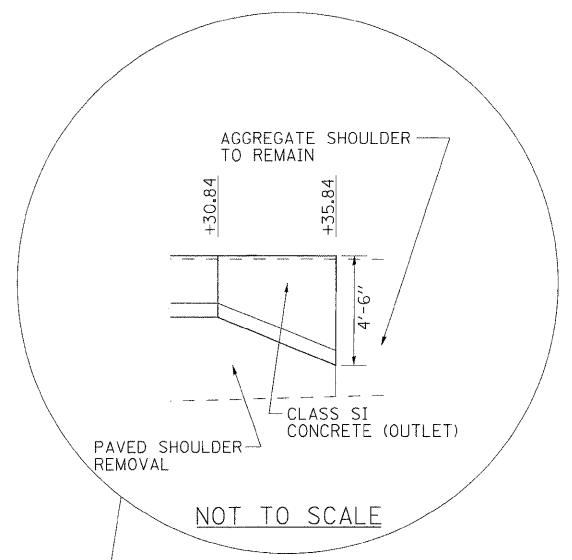
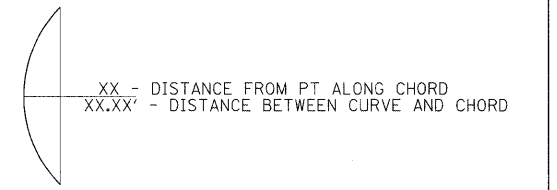

FILE NAME = P:\0340702\Hutsonville\Drawings\Intersection\geometrics.dgn	USER NAME = mackley	DESIGNED -	REVISED -	<b>STATE OF ILLINOIS DEPARTMENT OF TRANSPORTATION</b>	<b>INTERSECTION GEOMETRICS</b>			F.A.P. RTE. 332	SECTION 22N	COUNTY CRAWFORD	TOTAL SHEETS 22	SHEET NO. 10
	PLOT SCALE = 20.0000 "/td> <td>DRAWN -</td> <td>REVISED -</td> <td>SCALE:</td> <td>SHEET NO.</td> <td>OF SHEETS</td> <td>STA.</td> <td>TO STA.</td> <td colspan="3">CONTRACT NO. 74300</td>	DRAWN -	REVISED -		SCALE:	SHEET NO.	OF SHEETS	STA.	TO STA.	CONTRACT NO. 74300		
	PLOT DATE = 12/16/2008	CHECKED -	REVISED -		FED. ROAD DIST. NO. ILLINOIS FED. AID PROJECT							
		DATE -	REVISED -									