

PLAN SURVEYED BY DATE  
 PLOTTED BY  
 CHECKED BY  
 RT. OF WAY CHECKED BY  
 NO. CAD FILE NAME

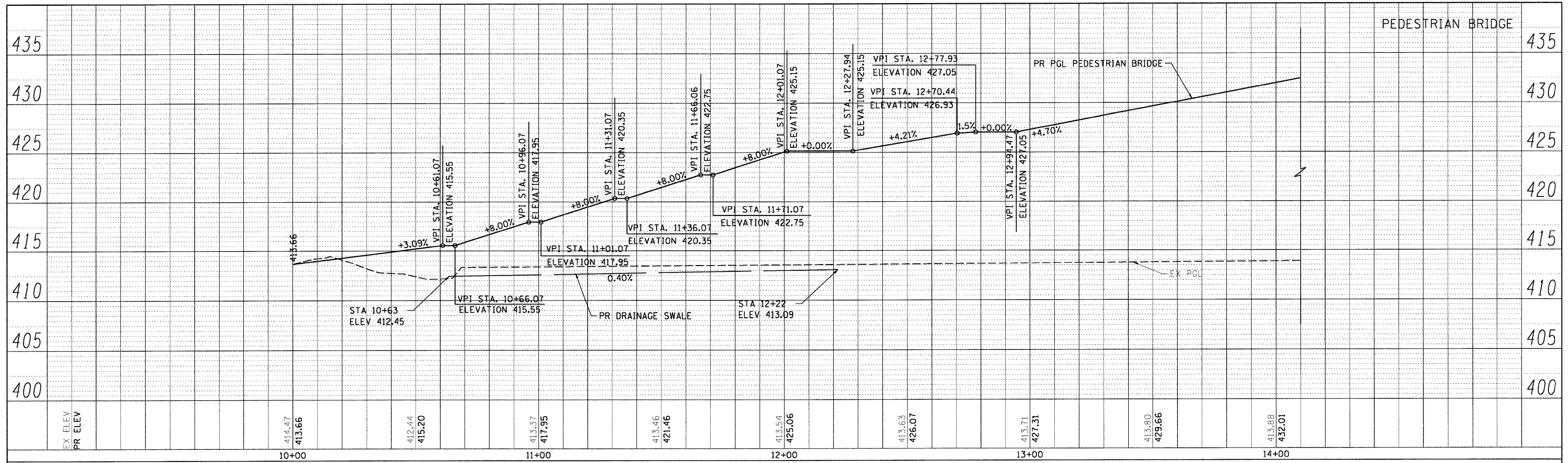

PROFILE SURVEYED BY DATE  
 PLOTTED BY  
 CHECKED BY  
 STRUCTURE NOTATIONS CHECKED BY  
 NO. CAD FILE NAME

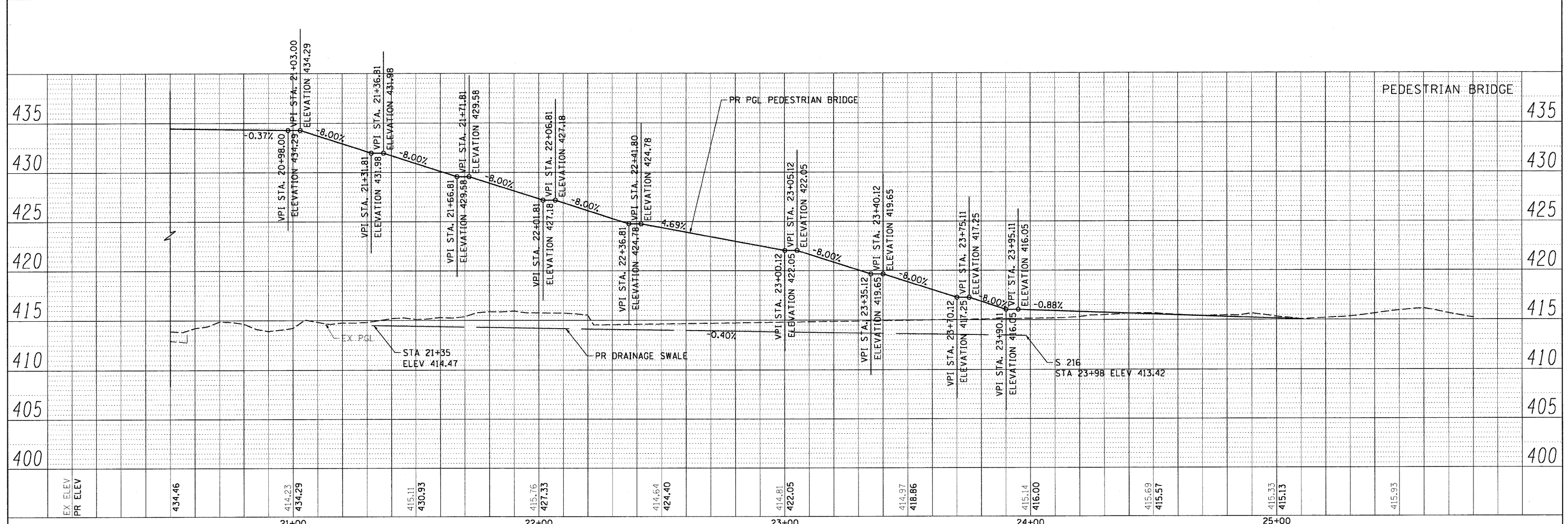

FILE NAME = D:\BTR-76C47-shr-Prof-01.dgn	USER NAME = maranj	DESIGNED - DJM	REVISED -	<b>STATE OF ILLINOIS DEPARTMENT OF TRANSPORTATION</b>	<b>PEDESTRIAN BRIDGE PROFILE</b>	F.A. RTE. 64	SECTION 82-1-IHBR	COUNTY ST. CLAIR	TOTAL SHEETS 93	SHEET NO. 20	
PLOT SCALE = 20,0000' / IN.	CHECKED - JL	DATE - 05/01/09	REVISED -			SCALE: 1"=20'H 1"=5'V	SHEET NO. 3 OF 3 SHEETS	TO STA.	CONTRACT NO. 76C47		
PLOT DATE = 5/5/2009	DATE - 05/01/09	REVISED -	REVISED -			FED. ROAD DIST. NO. ILLINOIS FED. AID PROJECT					