

F.A.I. RTE.	SECTION	COUNTY	TOTAL SHEETS	SHEET NO.
64	82-1T	ST. CLAIR	15	1

CONTRACT NO. 76C48 D-98-058-08

FOR INDEX OF SHEETS AND STANDARDS SEE SHEET NO. 2

STATE OF ILLINOIS DEPARTMENT OF TRANSPORTATION DIVISION OF HIGHWAYS PROPOSED HIGHWAY PLANS

F.A.I. ROUTE 64 (I-64)
 SECTION 82-1T
 STORM SEWER REPAIR

ST. CLAIR COUNTY
 C-98-073-09



LOCATION OF SECTION INDICATED THUS: — ■ —

MICROFILMED _____
 REEL NUMBER _____
 AWARDED _____
 RESIDENT ENGINEER _____
 AS BUILT CHANGES WERE MADE
 ON THE FOLLOWING SHEETS

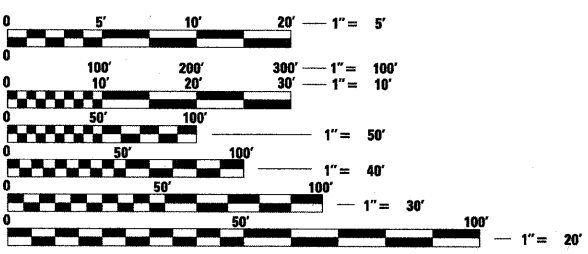

FULL SIZE PLANS HAVE BEEN PREPARED USING STANDARD ENGINEERING SCALES. REDUCED SIZED PLANS WILL NOT CONFORM TO STANDARD SCALES. IN MAKING MEASUREMENTS ON REDUCED PLANS, THE ABOVE SCALES MAY BE USED.

J.U.L.I.E.
 JOINT UTILITY LOCATION INFORMATION FOR EXCAVATION
 1-800-892-0123
 or 811

PROJECT ENGINEER MIKE PRITCHETT
SQUAD LEADER CHAD SANDERS
CONTRACT NO. 76C48

SEWER LINING PROJECT AREA



Tobin Bonnell 6/2/2009
TOBIN BONNELL DATE
 LICENSE EXPIRES 11/30/2009

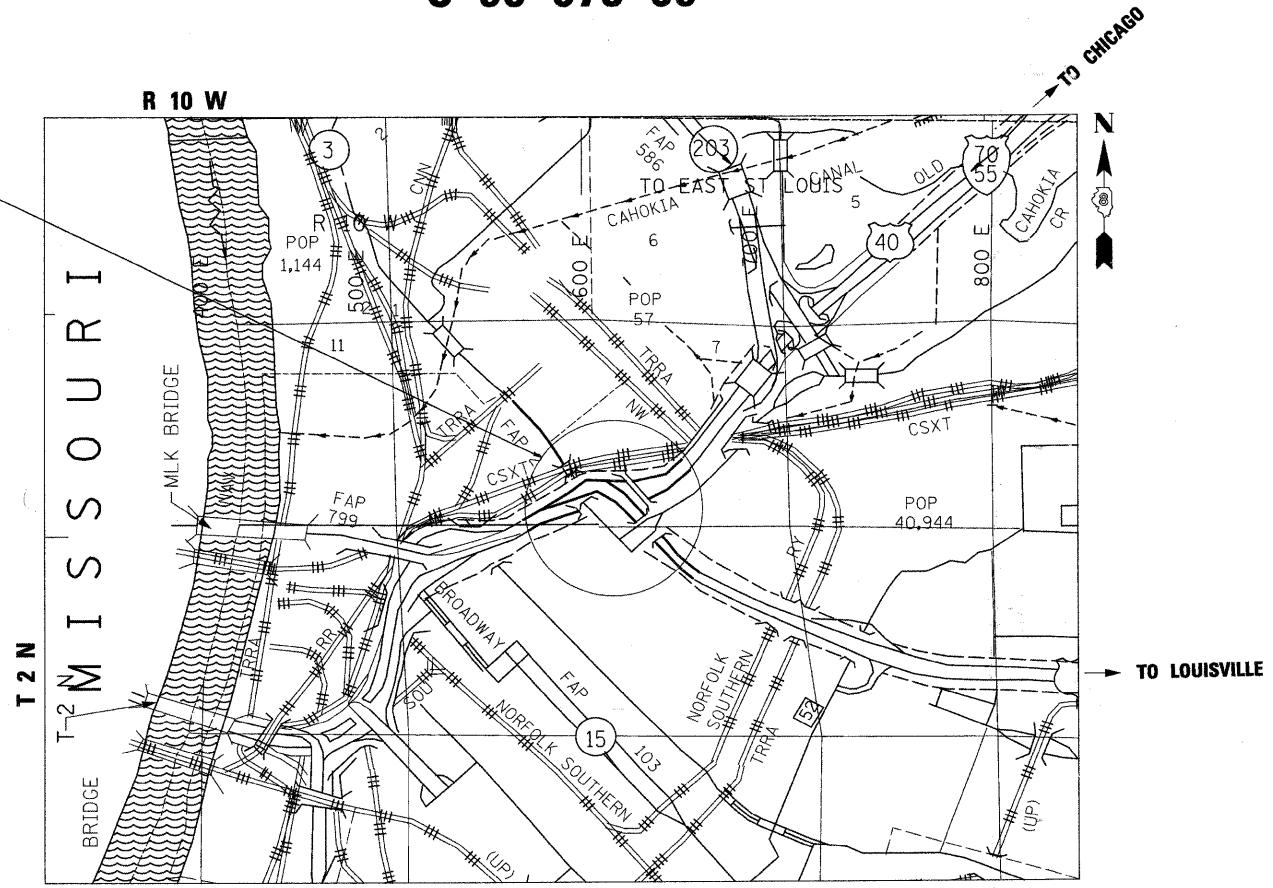

TOWNSHIP: CANTEEN
 GROSS LENGTH = 6,435' (1.219 MILES)
 NET LENGTH = 6,435' (1.219 MILES)

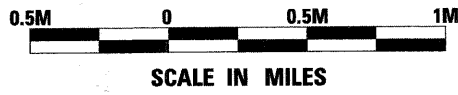

STATE OF ILLINOIS
 DEPARTMENT OF TRANSPORTATION
 DIVISION OF HIGHWAYS

SUBMITTED July 9 20 09
May C Jamie
 DEPUTY DIRECTOR OF HIGHWAYS, REGION ENGINEER
 August 14, 20 09
Charles J. Ingersoll
 ENGINEER OF DESIGN AND ENVIRONMENT
 August 14, 20 09
Christine M. Reed
 DIRECTOR, DIVISION OF HIGHWAYS

**PRINTED BY THE AUTHORITY
 OF THE STATE OF ILLINOIS**



PLOT DATE: 6/2/2009 1:45:07 PM

DGN-SPEC
 DATE-TIME
 REF-REF
 REF-REF

INDEX OF SHEETS

Sheet Number	Drawing Title
1	COVER SHEET
2	INDEX OF DRAWINGS / HIGHWAY STANDARDS
3	GENERAL NOTES/COMMITMENTS
4	SUMMARY OF QUANTITIES
5	SCHEDULE OF QUANTITIES
6	SCHEDULE OF QUANTITIES
7	SEWER LINING KEY PLAN
8	SEWER LINING PLAN SHEET
9	SEWER LINING PLAN SHEET
10	SEWER LINING PLAN SHEET
11	SEWER LINING PLAN SHEET
12	SEWER LINING PLAN SHEET
13	SEWER LINING PLAN SHEET
14	SEWER LINING PLAN SHEET
15	SEWER LINING PLAN SHEET
16	SEWER LINING PLAN SHEET

HIGHWAY STANDARDS

STANDARD NO.	DESCRIPTION
000001-05	STANDARD SYMBOLS, ABBREVIATIONS AND PATTERNS
001006	DECIMAL OF AN INCH AND OF A FOOT
442201-03	CLASS C AND D PATCHES
604001-03	FRAME AND LIDS - TYPE 1
701006-03	OFF-RD OPERATIONS, 2L, 2W, 15' (4.5 m) TO 24" (600 mm) FROM PAVEMENT EDGE
701101-02	OFF-RD OPERATIONS, MULTILANE, 15' (4.5 m) TO 24" (600 mm) FROM PAVEMENT EDGE
701106-02	OFF-RD OPERATIONS, MULTILANE, MORE THAN 15' (4.5 m) AWAY
701501-05	URBAN LANE CLOSURE, 2L, 2W, UNDIVIDED
701601-06	URBAN LANE CLOSURE, MULTILANE, 1W OR 2W WITH NONTRAVERSABLE MEDIAN
701701-06	URBAN LANE CLOSURE, MULTILANE INTERSECTION
701801-04	URBAN LANE CLOSURE, MULTILANE, 1W OR 2W, CROSSWALK OR SIDEWALK CLOSURE
701901-01	TRAFFIC CONTROL DEVICES

FILE NAME = PFILES

USER NAME = IDOT	DESIGNED - TTB	REVISED -
PLOT SCALE = 1.0000' / IN.	DRAWN - GDO	REVISED -
PLOT DATE = 2/18/2009	CHECKED - JAH	REVISED -
	DATE - 2/18/2009	REVISED -

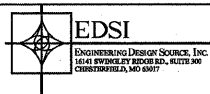

**STATE OF ILLINOIS
DEPARTMENT OF TRANSPORTATION**

INDEX OF DRAWINGS / HIGHWAY STANDARDS

SCALE: NONE SHEET NO. OF SHEETS STA. TO STA.

F.A.I. RTE.	SECTION	COUNTY	TOTAL SHEETS	SHEET NO.
64	82-1T	ST. CLAIR	16	2
D-98-058-08		CONTRACT NO. 76C48		
FED. ROAD DIST. NO.		ILLINOIS FED. AID PROJECT		

GENERAL NOTES

1. SAW CUTTING ON ALL EDGES FOR PAVEMENT PATCH ITEMS SHALL BE INCLUDED IN THE COST OF THE PAVEMENT PATCH ITEM AS INDICATED AND IN ACCORDANCE WITH SECTION 442 OF THE STANDARD SPECIFICATIONS.
2. IF ANY SECTION OR SUB-SECTION MONUMENTS ARE ENCOUNTERED, THE ENGINEER SHALL BE NOTIFIED BEFORE SUCH MONUMENTS ARE REMOVED OR RESURFACED OVER. THE CONTRACTOR SHALL PROTECT AND CAREFULLY PRESERVE ALL PROPERTY MARKERS AND MONUMENTS UNTIL THE OWNER, AN AUTHORIZED SURVEYOR, OR AGENT HAS WITNESSED OR OTHERWISE REFERENCED THEIR LOCATION.
3. EXCESS WORK FOR ANY ITEM NOT IN SCOPE SHALL BE PAID FOR ACCORDING TO ARTICLE 109.04 OF THE STANDARD SPECIFICATIONS.
4. THE USE OF VIBRATORY ROLLERS IS PROHIBITED IN THE RESIDENTIAL AREA. THIS DOES NOT RELIEVE THE CONTRACTOR OF DENSITY REQUIREMENTS FOR THE BITUMINOUS PAVEMENTS AS SPECIFIED IN THE SPECIAL PROVISIONS FOR SUPERPAVE BITUMINOUS CONCRETE MIXTURES.
5. THE CONTRACTOR SHALL FURNISH AND INSTALL WOOD SIGN POST SUPPORTS IN ACCORDANCE WITH SECTION 730 OF THE STANDARD SPECIFICATIONS.
6. HIGH EARLY STRENGTH CONCRETE MIX SHALL BE USED FOR ALL PCC PATCHING AND NO ADDITIONAL PAYMENT WILL BE CONSIDERED.
7. THE IDOT HIGHWAY STANDARDS LATEST REVISION NUMBERS SHALL APPLY TO THIS PROJECT.
8. EXCEPT WHERE DESIGNATED OTHERWISE, THE LOCATIONS AND/OR DEPTHS OF UNDERGROUND UTILITIES SHOWN HAVE BEEN TAKEN FROM OFFICE RECORD INFORMATION FURNISHED BY THE UTILITY OWNERS AND THE SUE SURVEYS. ALL UNDERGROUND UTILITIES MUST BE CONSIDERED APPROXIMATE.
9. PROTECTIVE COAT SHALL BE APPLIED TO ALL NEW GUTTER FLAGS, FACE OF CURB, AND MEDIAN SURFACE IN ACCORDANCE WITH THE SEASONAL REQUIREMENTS OF ARTICLE 420.18 OF THE STANDARD SPECIFICATIONS.
10. IF ANY UNSUITABLE MATERIAL IS ENCOUNTERED DURING CONSTRUCTION, IT WILL BE NECESSARY TO REMOVE THE UNSUITABLE MATERIAL AND REPLACE IT WITH A SUITABLE MATERIAL AS APPROVED BY THE ENGINEER. WORK SHALL BE IN ACCORDANCE WITH ARTICLES 202.03 AND 202.08 OF THE STANDARD SPECIFICATIONS.
11. THE CONTRACTOR SHALL VERIFY ALL DIMENSIONS AND CONDITIONS IN THE FIELD PRIOR TO CONSTRUCTION AND ORDERING OF MATERIALS.
12. AT EACH MANHOLE SPECIFIED IN THE PLANS AS TO BE RECONSTRUCTED WITH PAVEMENT PATCHING REQUIRED, 10 SQUARE YARDS OF THE APPROPRIATE PAVEMENT PATCHING WAS INCLUDED.

RAILROAD COORDINATION

SPECIAL ATTENTION IS CALLED TO ARTICLE 107.12. THE NAMES AND TELEPHONE NUMBERS OF THE RAILROADS WITHIN THE PROJECT AREA ARE AS FOLLOWS:

METROLINK - (314) 982-1400 EXT. 1874

AFTER COMPLETION OF CONSTRUCTION, RAILROAD DRAINAGE DITCHES SHALL BE CLEANED OF ALL DEBRIS TO THE SATISFACTION OF THE ENGINEER.

UTILITY COORDINATION

ILLINOIS STATE LAW REQUIRES A 48-HOUR NOTICE BE GIVEN TO ALL UTILITIES WITHIN THE PROJECT AREA BEFORE DIGGING BY CALLING J.U.L.I.E. AND BY NOTIFYING NON-J.U.L.I.E. MEMBERS INDIVIDUALLY. FIELD MARKING OF FACILITIES MAY ALSO BE OBTAINED BY PROVIDING A MINIMUM OF 96-HOURS NOTICE TO THE RESIDENT ENGINEER SO THAT UTILITY COMPANIES CAN BE NOTIFIED. AGENCIES KNOWN TO HAVE FACILITIES WITHIN THE PROJECT AREA ARE AS FOLLOWS:

- AMEREN UE
- AMERITECH
- CHARTER COMMUNICATIONS
- EXPLORER PIPELINE
- ILLINOIS POWER COMPANY
- ILLINOIS AMERICAN WATER
- MARATHON ASHLAND PIPELINE COMPANY
- MCI
- MCLEOD USA
- NORAM TRADING AND TRANSPORTATION COMPANY
- QWEST
- SPRINT
- WORLDCOM
- 360 NETWORKS

CITY OF EAST ST LOUIS - (618) 482-6737
 METRO EAST SANITARY DISTRICT - (618) 452-9400
 ST LOUIS NATIONAL STOCKYARDS COMPANY - (405) 235-8675

(MEMBERS OF J.U.L.I.E. (800)-892-0123 OR 811 ARE INDICATED BY *. NON-J.U.L.I.E. MEMBERS MUST BE NOTIFIED INDIVIDUALLY.)

COORDINATE SYSTEM AND DATUM

THIS PROJECT IS BASED ON THE MISSISSIPPI RIVER CROSSING (MRC) COORDINATE SYSTEM. THE MISSISSIPPI RIVER CROSSING (MRC) COORDINATE SYSTEM IS BASED ON A MODIFIED UNIVERSAL TRANSVERSE MERCATOR (UTM) SYSTEM. THE MRC COORDINATE SYSTEM HAS BEEN CONVERTED FROM UTM ZONE 15 NORTH BY AN AVERAGE PROJECTION FACTOR AND ALSO CONVERTED FROM METERS TO U.S. SURVEY FEET.

AVERAGE GRID FACTOR = 1.000339495
 PROJECTION FACTOR = 1/gr*ld = 0.999660620

THE BASE POINT FROM WHICH ALL UTM COORDINATES WERE SCALED WAS PRIMARY CONTROL MONUMENT NUMBER 10, LISTED IN APPENDIX A OF THE MRC SURVEY SUMMARY, AVAILABLE FROM THE ENGINEER. EACH VECTOR FROM MONUMENT NUMBER 10 TO ALL OTHER MONUMENTS WAS MULTIPLIED BY THE PROJECTION FACTOR TO CALCULATE A SURFACE VECTOR AND THEN THIS SURFACE VECTOR WAS USED TO CALCULATE THE SURFACE COORDINATES.

THE VERTICAL CONTROL DATUM IS NAVD 1988.

TRAFFIC CONTROL

1. ALL EXCAVATION ADJACENT TO THE EDGE OF PAVEMENT SHALL BE PROTECTED WITH CONTRACTOR SUPPLIED TEMPORARY CONCRETE BARRIERS AND APPROPRIATE LIGHTS.
2. ALL TRAFFIC CONTROL SIGNS SHALL BE POST MOUNTED UNLESS OTHERWISE NOTED.
3. "ROAD CONSTRUCTION AHEAD" SIGNS SHALL BE PLACED AT THE BEGINNING AND END OF THE PROJECT AND ON THE INTERSECTING SIDE ROADS, AND WILL BE INCLUDED IN THE TRAFFIC CONTROL PAY ITEMS. ALL CONSTRUCTION SIGNS SHALL BE FLUORESCENT ORANGE, 48".
4. FLAGMEN SHALL BE PRESENT DURING ALL CLOSURE HOURS, INCLUDING LUNCH HOUR, AND NO ADDITIONAL COMPENSATION SHALL BE ALLOWED.
5. FOR STABILIZATION, ALL TYPE III BARRICADES SHALL REQUIRE A MINIMUM OF SIXTEEN SANDBAGS PER BARRICADE.

COMMITMENTS

1. ALL CONSTRUCTION ACTIVITIES WILL FOLLOW ILLINOIS PROCEDURES DESIGNED TO MINIMIZE CONSTRUCTION IMPACTS ON AIR QUALITY.
2. THE CONSTRUCTION SPECIFICATIONS WILL INCLUDE REQUIREMENTS TO PROHIBIT THE CONTRACTOR FROM DISPOSING OF ANY POLLUTANTS, SUCH AS FUELS, LUBRICANTS, RAW SEWAGE, OR OTHER HARMFUL SUBSTANCES, INAPPROPRIATELY.

FILE NAME = #FILES#

USER NAME = IDOT	DESIGNED - TTB	REVISED -
PLOT SCALE = 1,0000' / IN.	DRAWN - GDO	REVISED -
PLOT DATE = 2/18/2009	CHECKED - JAH	REVISED -
	DATE - 2/18/2009	REVISED -



**STATE OF ILLINOIS
 DEPARTMENT OF TRANSPORTATION**

GENERAL NOTES / COMMITMENTS
 SCALE: NONE SHEET NO. OF SHEETS STA. TO STA.

F.A.I. RTE.	SECTION	COUNTY	TOTAL SHEETS	SHEET NO.
64	82-1T	ST. CLAIR	16	3
D-98-058-08		CONTRACT NO. 76C48		
FED. ROAD DIST. NO. ILLINOIS FED. AID PROJECT				

SUMMARY OF QUANTITIES

CODE NO.	ITEM	UNIT	TOTAL QUANTITY	100% STATE	
				URBAN	1007 ROADWAY
44201377	CLASS C PATCHES, TYPE II, 12 INCH	SQ YD	40	40	
44201789	CLASS D PATCHES, TYPE II, 12 INCH	SQ YD	10		10
44213200	SAW CUTS	FOOT	285	228	57
60258200	MANHOLES TO BE RECONSTRUCTED WITH NEW TYPE 1 FRAME, CLOSED LID	EACH	5	5	
67000400	ENGINEER'S FIELD OFFICE, TYPE A	CAL MO	6	6	
67100100	MOBILIZATION	L SUM	1	1	
70102620	TRAFFIC CONTROL AND PROTECTION, STANDARD 701501	L SUM	1	1	
70102622	TRAFFIC CONTROL AND PROTECTION, STANDARD 701502	L SUM	1	1	
70102630	TRAFFIC CONTROL AND PROTECTION, STANDARD 701601	L SUM	1	1	
70102635	TRAFFIC CONTROL AND PROTECTION, STANDARD 701701	L SUM	1	1	
70102640	TRAFFIC CONTROL AND PROTECTION, STANDARD 701801	L SUM	1	1	
Z0076600	TRAINEES	HOUR			
X0326658	CURED-IN-PLACE PIPE LINER, 10"	FOOT	303	303	
X0326659	CURED-IN-PLACE PIPE LINER, 18"	FOOT	377	377	
X0326660	CURED-IN-PLACE PIPE LINER, 20"	FOOT	126	126	
X0326661	CURED-IN-PLACE PIPE LINER, 21"	FOOT	528	528	
X0326662	CURED-IN-PLACE PIPE LINER, 24"	FOOT	848	848	
X0326663	CURED-IN-PLACE PIPE LINER, 30"	FOOT	741	741	
X0326664	CURED-IN-PLACE PIPE LINER, 36"	FOOT	2790	2790	
X0326665	CURED-IN-PLACE PIPE LINER, 42"	FOOT	940	940	
X0326666	CURED-IN-PLACE PIPE LINER, 72"	FOOT	244	244	
X0326667	MANHOLES TO BE LOCATED	EACH	4	3	1
X0326668	SEWER MANHOLE REHABILITATION, LEVEL B	FOOT	120	120	
X0326669	SEWER MANHOLE REHABILITATION, LEVEL C	FOOT	285	285	

FILE NAME = D8TRI-76C48-sh1-Summary-04.dgn	USER NAME = IDOT	DESIGNED - TTB	REVISED -	STATE OF ILLINOIS DEPARTMENT OF TRANSPORTATION	SUMMARY OF QUANTITIES	F.A.I. RTE.	SECTION	COUNTY	TOTAL SHEETS	SHEET NO.	
PLOT SCALE = 1/8" = 1' IN.	DRAWN - GDO	CHECKED - JAH	REVISED -			64	82-1T	ST. CLAIR	15	4	
PLOT DATE = 6/25/2009	DATE - 6/25/2009	REVISOR -	REVISED -			SCALE: SHEET NO. 1 OF 1 SHEETS STA. TO STA.		CONTRACT NO. 76C48			
						FED. ROAD DIST. NO. 8 ILLINOIS FED. AID PROJECT					

CURED-IN-PLACE PIPE LINER

SHEET NUMBER	EXISTING PIPE LABEL	STREET NAME	FROM MANHOLE	TO MANHOLE	LENGTH (FEET)	AVERAGE DEPTH (FEET)	PIPE SLOPE (%)	DATE TELEVISED	COMMENTS
CURED-IN-PLACE PIPE LINER, 10"									
8	EX-P 150	1ST STREET	MH 101	MH 102	156	9.6	1.0	3/5/2003	
8	EX-P 151	1ST STREET	MH 100	MH 101	147	9.3	0.6	3/5/2003	
				10" TOTAL	303				
CURED-IN-PLACE PIPE LINER, 18"									
13	EX-P 204	9TH STREET	MH 142	MH 143	315	7.0	0.6	4/22/2003	
14	EX-P 79	ST. CLAIR AVE.	MH 127	MH 125	62	6.3	1.0	3/25/2003	
				18" TOTAL	377				
CURED-IN-PLACE PIPE LINER, 20"									
15	EX-P 83	BAUGH AVE.	MH 138	MH 139	126	14.2	0.3	4/15/2003	ASSUMED SLOPE & AVERAGE DEPTH
				20" TOTAL	126				
CURED-IN-PLACE PIPE LINER, 21"									
9 & 10	EX-P 21	BOWMAN AVE.	MH 103	MH 110	528	14.7	0.0	4/25/2003	INSIDE IDOT BOWMAN MAINTENANCE YARD
				21" TOTAL	528				ASSUMED FLAT SLOPE
CURED-IN-PLACE PIPE LINER, 24"									
11	EX-P 208	ST. CLAIR AVE.	MH 113	MH 114	363	11.2	0.1	4/3/2003	
11	EX-P 212	I-55	MH 111	MH 112	252	7.5	0.2	4/4/2003	
15	EX-P 69	ST. CLAIR AVE.	MH 136	MH 137	89	4.6	0.0	3/24/2003	ASSUMED FLAT SLOPE
15	EX-P 1028	18TH STREET	MH 144	MH 145	144	7.4	0.0	N/A	
				24" TOTAL	848				
CURED-IN-PLACE PIPE LINER, 30"									
13	EX-P 200	ST. CLAIR AVE.	MH 123	MH 124	148	6.9	0.3	4/2/2003	
14	EX-P 78	ST. CLAIR AVE.	MH 126	MH 127	206	6.3	0.3	4/10/2003	
15	EX-P 82A	BAUGH AVE.	MH 140	MH 141	387	10.7	0.0	4/11/2003	ASSUMED DOWNSTREAM FLOWLINE ELEVATION
				30" TOTAL	741				
CURED-IN-PLACE PIPE LINER, 36"									
10	EX-P 16	BOWMAN AVE.	MH 107	MH 105	160	10.3	5.0	3/28/2003	INSIDE IDOT BOWMAN MAINTENANCE YARD
10	EX-P 17	BOWMAN AVE.	MH 105	MH 106	85	6.3	-0.1	3/28/2003	INSIDE IDOT BOWMAN MAINTENANCE YARD
11 & 13	EX-P 207	ST. CLAIR AVE.	MH 119	MH 113	511	11.1	0.0	4/3/2003	
13	EX-P 205	ST. CLAIR AVE.	MH 122	MH 121	80	10.2	0.0	4/3/2003	ASSUMED FLAT SLOPE
13	EX-P 205A	ST. CLAIR AVE.	MH 121	MH 120	280	10.0	0.0	4/3/2003	
13	EX-P 206	ST. CLAIR AVE.	MH 120	MH 119	211	10.1	0.7	4/3/2003	
14	EX-P 75	ST. CLAIR AVE.	MH 130	MH 131	143	13.3	0.0	3/20/2003	ASSUMED SLOPE & AVERAGE DEPTH
14	EX-P 76	ST. CLAIR AVE.	MH 132	MH 133	183	8.4	0.0	3/20/2003	ASSUMED FLAT SLOPE
14	EX-P 76A	ST. CLAIR AVE.	MH 131	MH 132	360	10.7	1.6	3/20/2003	ASSUMED SLOPE & AVERAGE DEPTH
14	EX-P 77	ST. CLAIR AVE.	MH 133	MH 134	288	8.7	0.0	3/20/2003	ASSUMED FLAT SLOPE
14 & 15	EX-P 74	ST. CLAIR AVE.	MH 129	MH 130	349	12.7	0.1	3/20/2003	
15	EX-P 73	ST. CLAIR AVE.	MH 128	MH 129	140	12.5	-0.2	3/24/2003	ASSUMED SLOPE & AVERAGE DEPTH
				36" TOTAL	2790				
CURED-IN-PLACE PIPE LINER, 42"									
9	EX-P 14	EXCHANGE AVE	MH 146	MH 147	373	11.6	0.1	3/31/2003	
9 & 12	EX-P 12	I-55	MH 115	MH 116	158	15.5	0.0	3/31/2003	ASSUMED FLAT SLOPE
12	EX-P 10	EXCHANGE AVE	MH 117	MH 118	409	13.1	0.0	3/31/2003	ASSUMED UPSTREAM FLOWLINE ELEVATION
				42" TOTAL	940				
CURED-IN-PLACE PIPE LINER, 72"									
15	EX-P 80	64/ST. CLAIR AVE	MH 128	MH 135	244	14.2	0.1	3/27/2003	ASSUMED SLOPE & AVERAGE DEPTH
				72" TOTAL	244				

FILE NAME = DBTRI-76C48-8ht-Schedule-85.dgn	USER NAME = IDOT	DESIGNED - TTB	REVISED -	STATE OF ILLINOIS DEPARTMENT OF TRANSPORTATION	SCHEDULE OF QUANTITIES			F.A.I. RTE.	SECTION	COUNTY	TOTAL SHEETS	SHEET NO.
PLOT SCALE = 1.0000' / IN.	DRAWN - GDO	REVISED -	64					82-1T	ST. CLAIR	15	5	
PLOT DATE = 6/25/2009	CHECKED - JAH	REVISED -	SCALE: SHEET NO. 1 OF 2 SHEETS STA. TO STA.			FED. ROAD DIST. NO. 8 ILLINOIS FED. AID PROJECT		CONTRACT NO. 76C48				
DATE - 6/25/2009	REVISOR -	REVISED -										

SEWER MANHOLE REHABILITATION

SHEET NUMBER	EXISTING MANHOLE LABEL	STREET NAME	DEPTH (VERT. FOOT)	COMMENTS
SEWER MANHOLE REHABILITATION LEVEL B				
8	MH 100	1ST STREET	9.2	
8	MH 101	1ST STREET	9.5	
8	MH 102	1ST STREET	9.7	
9	MH 103	BOWMAN AVE.	14.7	
11	MH 111	I-55	7.6	
11	MH 112	I-55	7.4	
11	MH 113	ST. CLAIR AVE.	11.8	
11	MH 114	ST. CLAIR AVE.	10.7	
13	MH 142	9TH STREET	6.8	
13	MH 143	9TH STREET	7.2	
14	MH 125	ST. CLAIR AVE.	6.7	
15	MH 137	ST. CLAIR AVE.	4.6	
15	MH 139	BAUGH AVE.	13.8	ESTIMATED DEPTH
		LEVEL B TOTAL:	120	
SEWER MANHOLE REHABILITATION LEVEL C				
9	MH 146	EXCHANGE AVE.	16.8	
9	MH 147	EXCHANGE AVE.	6.4	
10	MH 105	BOWMAN AVE.	8.0	
10	MH 106	BOWMAN AVE.	4.6	
10	MH 107	BOWMAN AVE.	12.7	
12	MH 115	I-55	15.5	ESTIMATED DEPTH
12	MH 117	EXCHANGE AVE.	11.7	
12	MH 118	EXCHANGE AVE.	14.6	ESTIMATED DEPTH
13	MH 119	ST. CLAIR AVE.	10.3	
13	MH 120	ST. CLAIR AVE.	9.9	
13	MH 121	ST. CLAIR AVE.	10.1	
13	MH 122	ST. CLAIR AVE.	10.4	ESTIMATED DEPTH
13	MH 123	ST. CLAIR AVE.	7.0	
13	MH 124	ST. CLAIR AVE.	6.8	
14	MH 126	ST. CLAIR AVE.	6.8	
14	MH 127	ST. CLAIR AVE.	5.9	
14	MH 130	ST. CLAIR AVE.	13.2	
14	MH 131	ST. CLAIR AVE.	13.4	ESTIMATED DEPTH
14	MH 133	ST. CLAIR AVE.	8.9	
15	MH 128	I-64/ST. CLAIR AVE.	15.0	ESTIMATED DEPTH
15	MH 129	ST. CLAIR AVE.	12.2	
15	MH 135	I-64/ST. CLAIR AVE.	13.5	ESTIMATED DEPTH
15	MH 138	BAUGH AVE.	14.6	
15	MH 140	BAUGH AVE.	8.5	ESTIMATED DEPTH
15	MH 141	BAUGH AVE.	12.9	
15	MH 144	18TH STREET	8.5	
15	MH 145	18TH STREET	6.4	
		LEVEL C TOTAL:	285	
MANHOLES TO BE RECONSTRUCTED WITH NEW TYPE 1 FRAME, CLOSED LID				
9	MH 116	I-55	15.5	NOT FOUND
10	MH 110	BOWMAN AVE.	14.7	NOT FOUND
14	MH 132	ST. CLAIR AVE.	8.0	NOT FOUND
14	MH 134	ST. CLAIR AVE.	8.5	NOT FOUND
15	MH 136	ST. CLAIR AVE.	16.0	JUNCTION WITH NO EXISTING STRUCTURE
		TOTAL:	63	

PAVEMENT PATCHING

SHEET NUMBER	EXISTING MANHOLE LABEL	STREET NAME	MANHOLES TO BE LOCATED (EACH)	CLASS C PATCH (SY)	CLASS D PATCH (SY)	SAW CUT (LF)
9	MH 116	I-55	1	10		57
10	MH 110	BOWMAN AVE.	1		10	57
14	MH 132	ST. CLAIR AVE.	1	10		57
14	MH 134	ST. CLAIR AVE.	1	10		57
15	MH 136	ST. CLAIR AVE.	1	10		57
		TOTAL:	4	40	10	285

FILE NAME - DBTRI-76C48-sht-Schedule-06.dgn	USER NAME - IDOT	DESIGNED - TTB	REVISED -	STATE OF ILLINOIS DEPARTMENT OF TRANSPORTATION	SCHEDULE OF QUANTITIES			F.A.I. RTE.	SECTION	COUNTY	TOTAL SHEETS	SHEET NO.
		DRAWN - GDO	REVISED -					64	82-1T	ST. CLAIR	15	6
PLOT SCALE = 1:8000' / IN.		CHECKED - JAH	REVISED -		SCALE: SHEET NO. 2 OF 2 SHEETS STA. TO STA.			FED. ROAD DIST. NO. 8 ILLINOIS FED. AID PROJECT				
PLOT DATE = 6/25/2009		DATE - 6/25/2009	REVISED -		CONTRACT NO. 76C48							

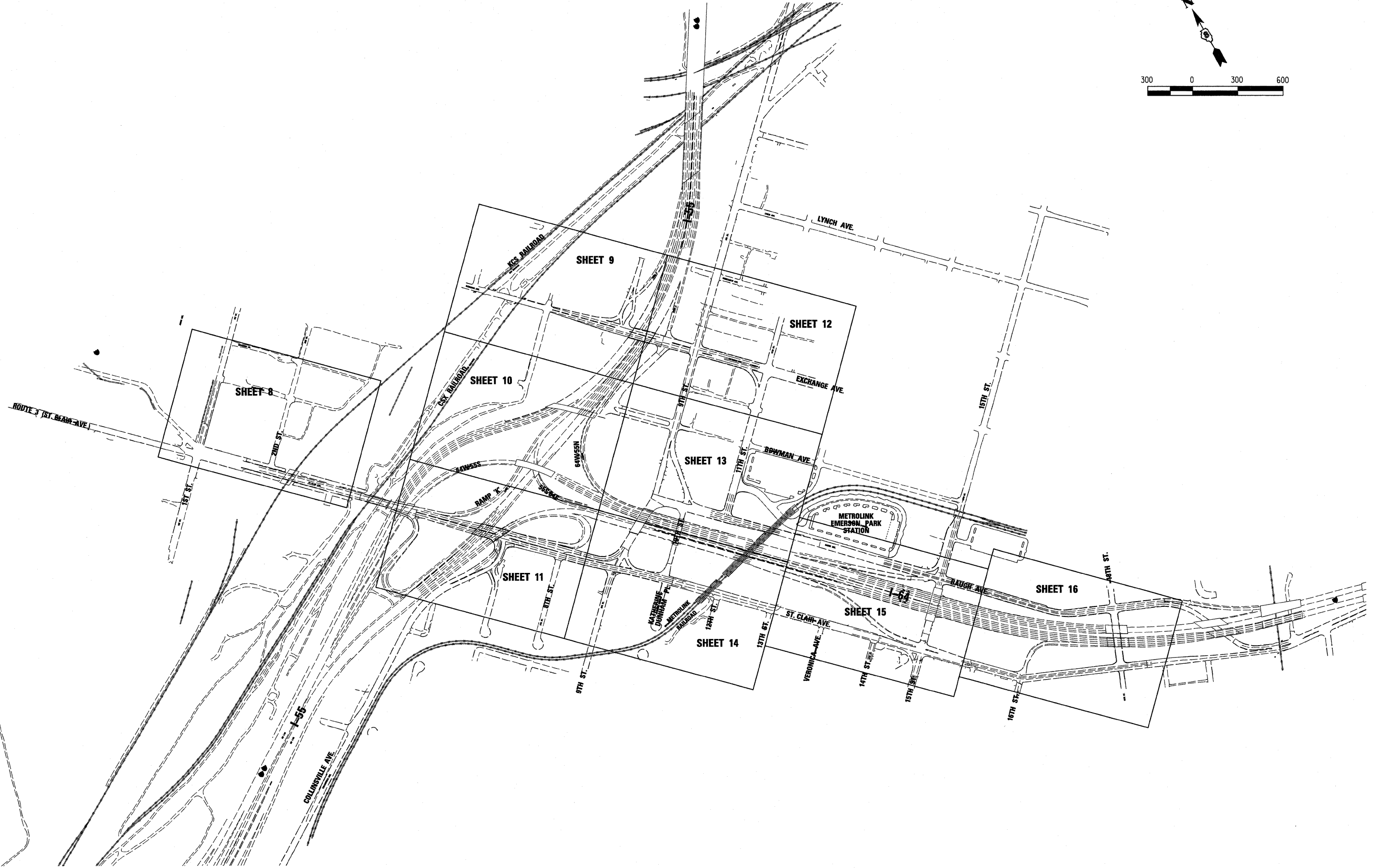
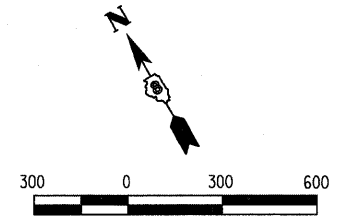

FILE NAME = 8FILES

USER NAME = IDOT	DESIGNED - TTB	REVISED -
	DRAWN - GDO	REVISED -
PLOT SCALE = 300.0000' / IN.	CHECKED - JAH	REVISED -
PLOT DATE = 2/18/2009	DATE - 2/18/2009	REVISED -



**STATE OF ILLINOIS
DEPARTMENT OF TRANSPORTATION**

SEWER LINING KEY PLAN
SCALE: 1"=300' SHEET NO. OF SHEETS STA. TO STA.

F.A.I. RTE.	SECTION	COUNTY	TOTAL SHEETS	SHEET NO.
64	82-1T	ST. CLAIR	16	7
D-98-058-08		CONTRACT NO. 76C48		
FED. ROAD DIST. NO.		ILLINOIS FED. AID PROJECT		

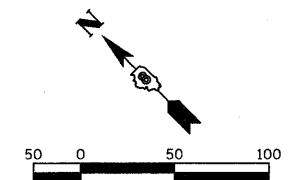
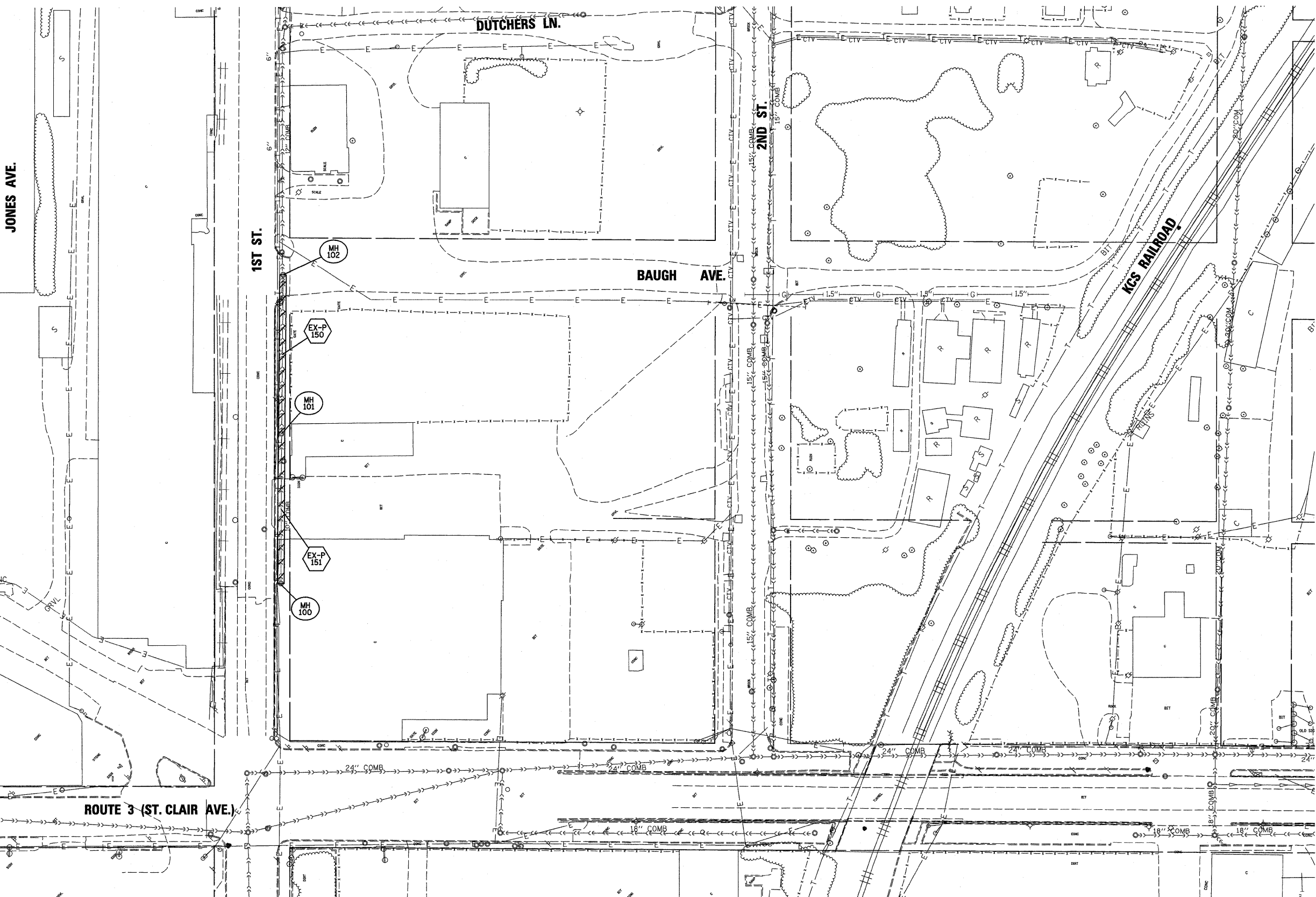

LEGEND

- MANHOLE LABEL
- PIPE LABEL
- PIPE LINER
- JOINT GROUTING

MH NO.	TRAFFIC CONTROL STANDARD	COMMENT
MH 100	701101	
MH 101	701101	
MH 102	701101	

FILE NAME = #FILESS

USER NAME = IDOT	DESIGNED - TTB	REVISED -
PLOT SCALE = 50.0000' / IN.	DRAWN - GDO	REVISED -
PLOT DATE = 2/18/2009	CHECKED - JAH	REVISED -
	DATE - 2/18/2009	REVISED -



**STATE OF ILLINOIS
DEPARTMENT OF TRANSPORTATION**

SEWER LINING PLAN

SCALE: 1"=50' SHEET NO. 1 OF 9 SHEETS STA. TO STA.

F.A.I. RTE.	SECTION	COUNTY	TOTAL SHEETS	SHEET NO.
64	82-1T	ST. CLAIR	16	8
D-98-058-08		CONTRACT NO. 76C48		
FED. ROAD DIST. NO.		ILLINOIS FED. AID PROJECT		

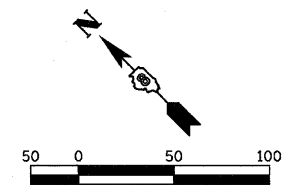
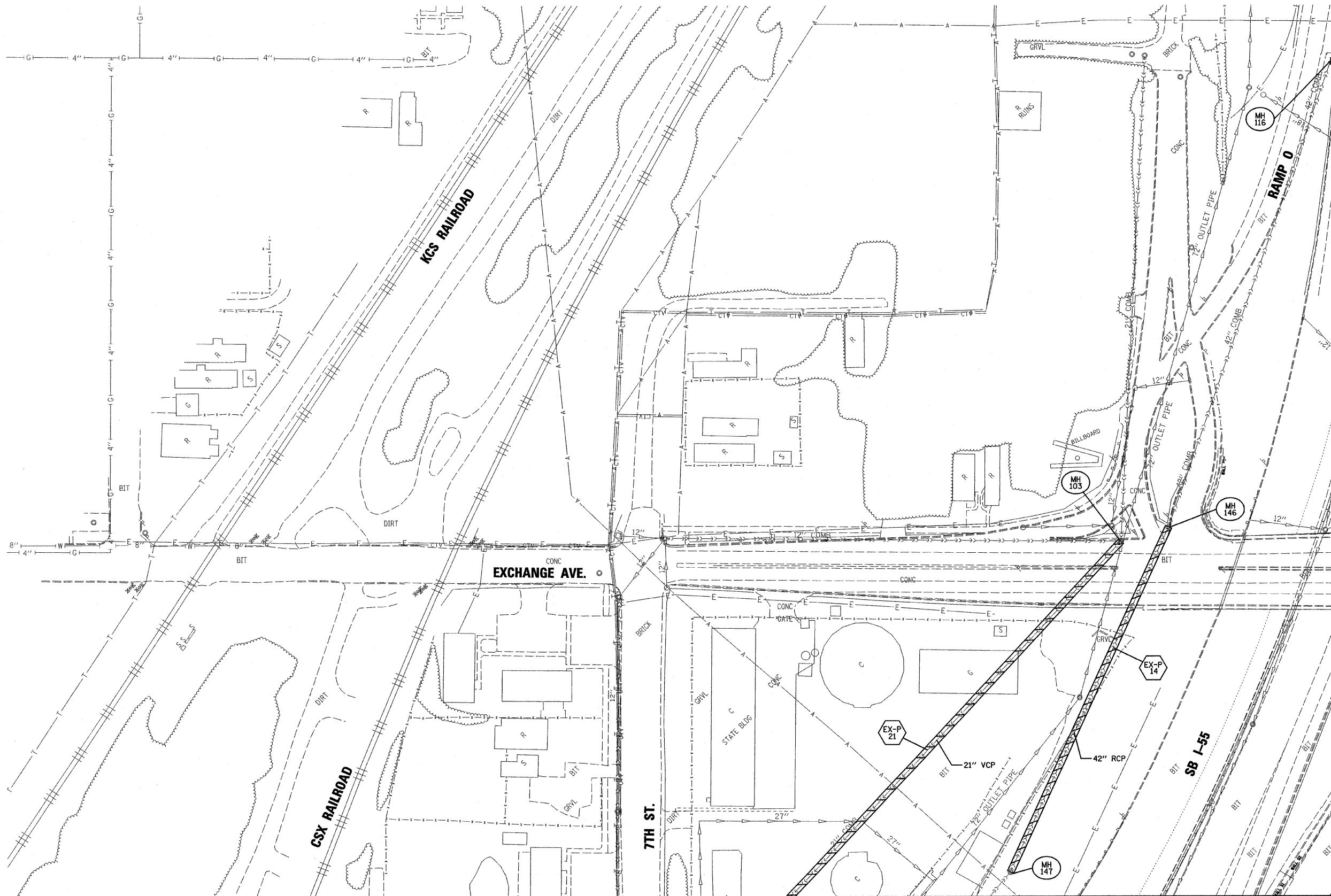

LEGEND

	MANHOLE LABEL
	PIPE LABEL
	PIPE LINER

MATCH LINE SEE SHEET 12

MATCH LINE SEE SHEET 10

MH NO.	MANHOLE REHABILITATION REQUIRED	TRAFFIC CONTROL STANDARD	COMMENT
MH 103	LEVEL B	701601, 701701, & 701801	
MH 116	RECONSTRUCT	701101	MH TO BE LOCATED; CLASS C PATCH NEEDED
MH 146	LEVEL C	701601, 701701, & 701801	
MH 147	LEVEL C	N/A	

FILE NAME = DBTRI-76C48-shr-Plan-09.dgn
 USER NAME = IDOT
 PLOT SCALE = 50.0000' / IN.
 PLOT DATE = 6/25/2009

DESIGNED - TTB
 DRAWN - GDO
 CHECKED - JAH
 DATE - 6/25/2009

REVISED -
 REVISED -
 REVISED -
 REVISED -

STATE OF ILLINOIS
DEPARTMENT OF TRANSPORTATION

SEWER LINING PLAN
 SCALE: 1"=50'
 SHEET NO. 2 OF 8 SHEETS
 STA. TO STA.

F.A.I. RTE. 64	SECTION 82-1T	COUNTY ST. CLAIR	TOTAL SHEETS 15	SHEET NO. 9
FED. ROAD DIST. NO. 8 (ILLINOIS) FED. AID PROJECT			CONTRACT NO. 76C48	

MATCH LINE SEE SHEET 9

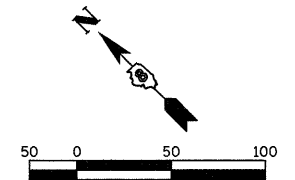

LEGEND

- MH
XXX MANHOLE LABEL
- EX-P
XX PIPE LABEL
- PIPE LINER
- JOINT GROUTING

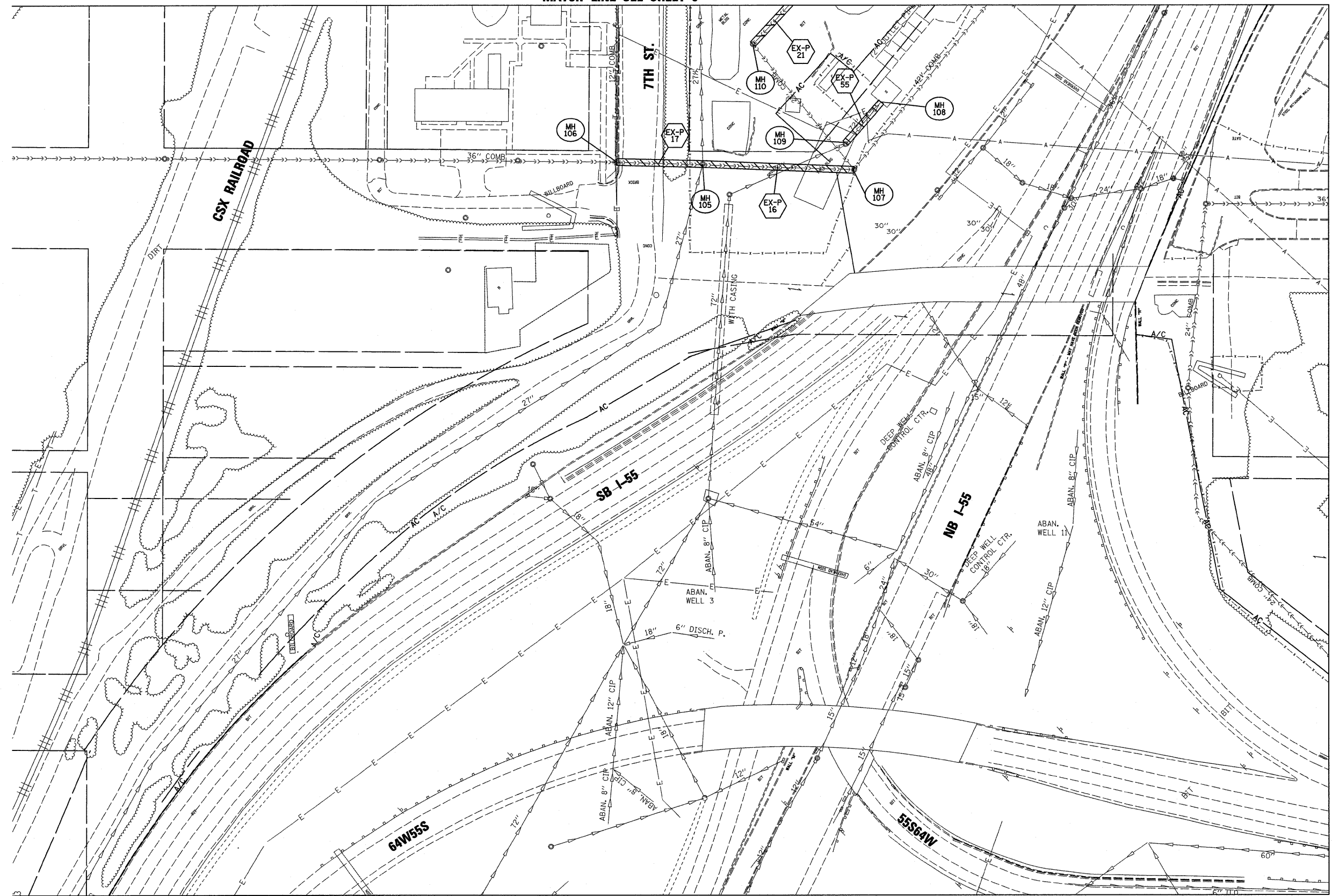

MATCH LINE SEE SHEET 13

MATCH LINE SEE SHEET 11

MH NO.	TRAFFIC CONTROL STANDARD	COMMENT
MH 105	N/A	
MH 106	701006	
MH 107	N/A	
MH 108	N/A	
MH 109	N/A	
MH 110	N/A	MANHOLE TO BE RECONSTRUCTED AND CLASS D PATCH NEEDED

USER NAME = IDOT	DESIGNED - TTB	REVISED -
	DRAWN - GDO	REVISED -
PLOT SCALE = 50.0000' / IN.	CHECKED - JAH	REVISED -
PLOT DATE = 2/18/2009	DATE - 2/18/2009	REVISED -



**STATE OF ILLINOIS
DEPARTMENT OF TRANSPORTATION**

SEWER LINING PLAN

SCALE: 1"=50' SHEET NO. 3 OF 9 SHEETS STA. TO STA.

F.A.I. RTE. 64	SECTION 82-1T	COUNTY ST. CLAIR	TOTAL SHEETS 16	SHEET NO. 10
D-98-058-08		CONTRACT NO. 76C48		
FED. ROAD DIST. NO. ILLINOIS FED. AID PROJECT				

FILE NAME = 8FILES

MATCH LINE SEE SHEET 10

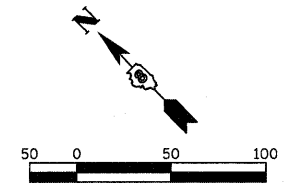

LEGEND

- MANHOLE LABEL
- PIPE LABEL
- PIPE LINER
- JOINT GROUTING

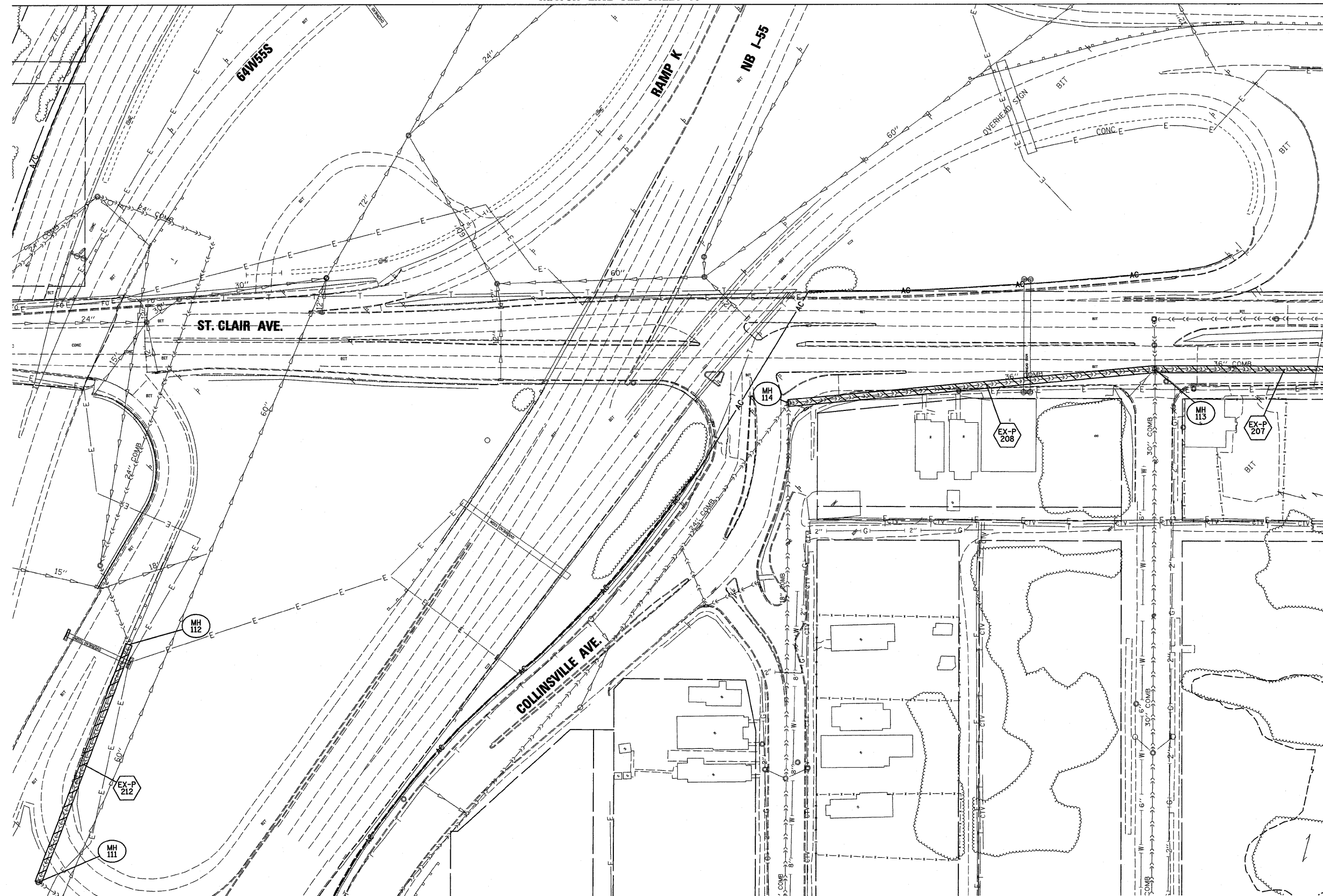

MATCH LINE SEE SHEET 14

MH NO.	TRAFFIC CONTROL STANDARD	COMMENT
MH 111	701106	
MH 112	701101	
MH 113	701501 & 701601	
MH 114	701701	POSSIBLE NEED FOR NON-STANDARD CLOSURE DETAIL

FILE NAME = SFILES

USER NAME = IDOT	DESIGNED - TTB	REVISED -
PLOT SCALE = 50.0000' / IN.	DRAWN - GDO	REVISED -
PLOT DATE = 2/18/2009	CHECKED - JAH	REVISED -
	DATE - 2/18/2009	REVISED -



**STATE OF ILLINOIS
DEPARTMENT OF TRANSPORTATION**

SEWER LINING PLAN

SCALE: 1"=50' SHEET NO. 4 OF 9 SHEETS STA. TO STA.

F.A.I. RTE.	SECTION	COUNTY	TOTAL SHEETS	SHEET NO.
64	82-1T	ST. CLAIR	16	11
D-98-058-08		CONTRACT NO. 76C48		
FED. ROAD DIST. NO.		ILLINOIS FED. AID PROJECT		

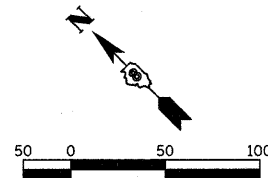

LEGEND

- MANHOLE LABEL
- PIPE LABEL
- PIPE LINER
- JOINT GROUTING

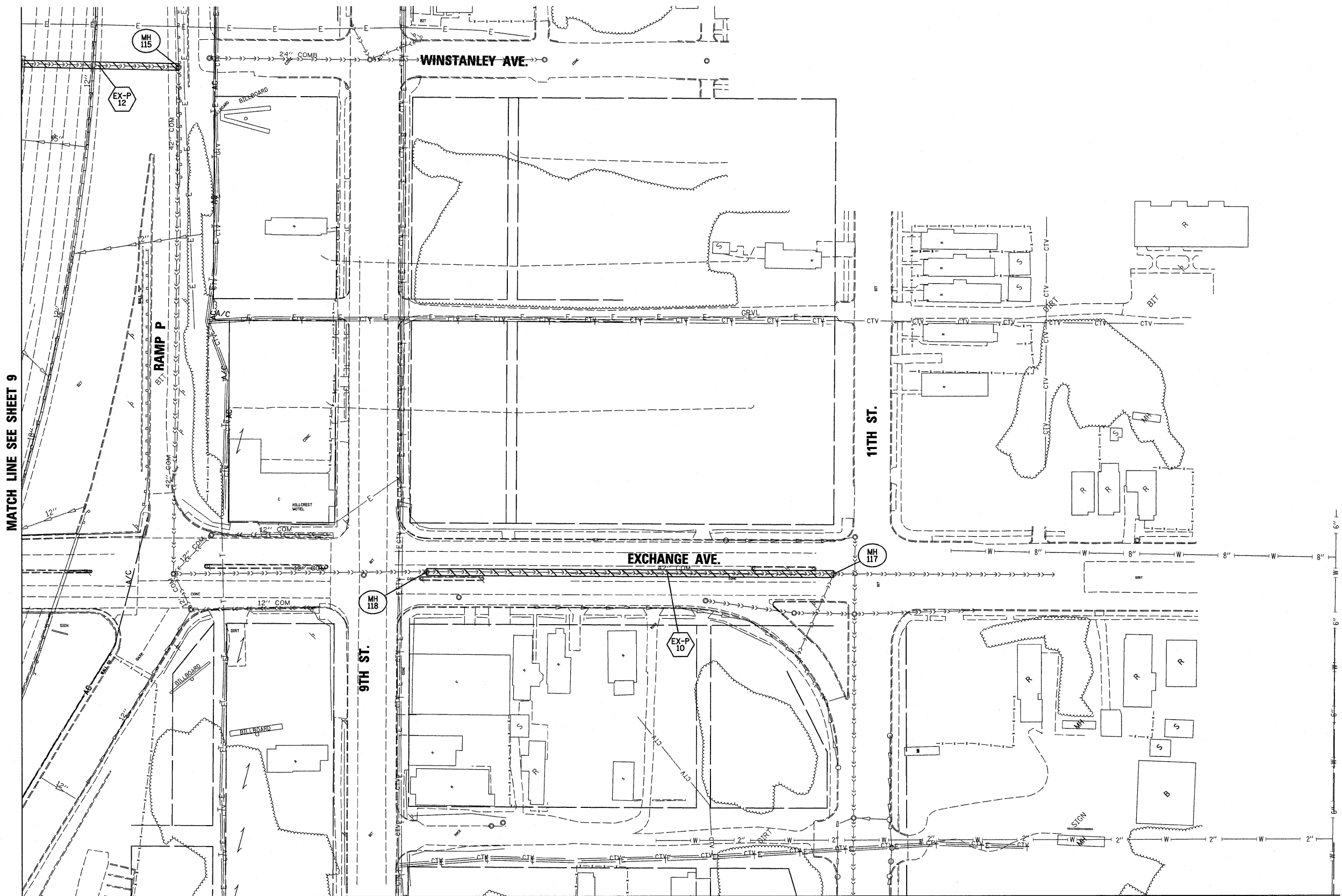

MATCH LINE SEE SHEET 9

MATCH LINE SEE SHEET 13

MH NO.	TRAFFIC CONTROL STANDARD	COMMENT
MH 115	701101	
MH 117	701701	
MH 118	701701	

FILE NAME = #FILES#

USER NAME = IDOT	DESIGNED - TTB	REVISED -
PLOT SCALE = 50.0000' / 1" IN.	DRAWN - GDO	REVISED -
PLOT DATE = 2/18/2009	CHECKED - JAH	REVISED -
	DATE - 2/18/2009	REVISED -



**STATE OF ILLINOIS
DEPARTMENT OF TRANSPORTATION**

SEWER LINING PLAN

SCALE: 1"=50' SHEET NO. 5 OF 9 SHEETS STA. TO STA.

F.A.I. RTE.	SECTION	COUNTY	TOTAL SHEETS	SHEET NO.
64	82-1T	ST. CLAIR	16	12
D-98-058-08		CONTRACT NO. 76C48		
FED. ROAD DIST. NO.		ILLINOIS FED. AID PROJECT		

MATCH LINE SEE SHEET 12

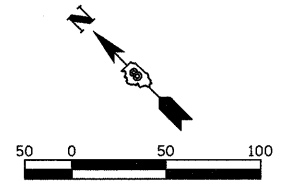

LEGEND

- MANHOLE LABEL
- PIPE LABEL
- PIPE LINER
- JOINT GROUTING

**NO WORK
THIS SHEET**

MATCH LINE SEE SHEET 10

MATCH LINE SEE SHEET 15

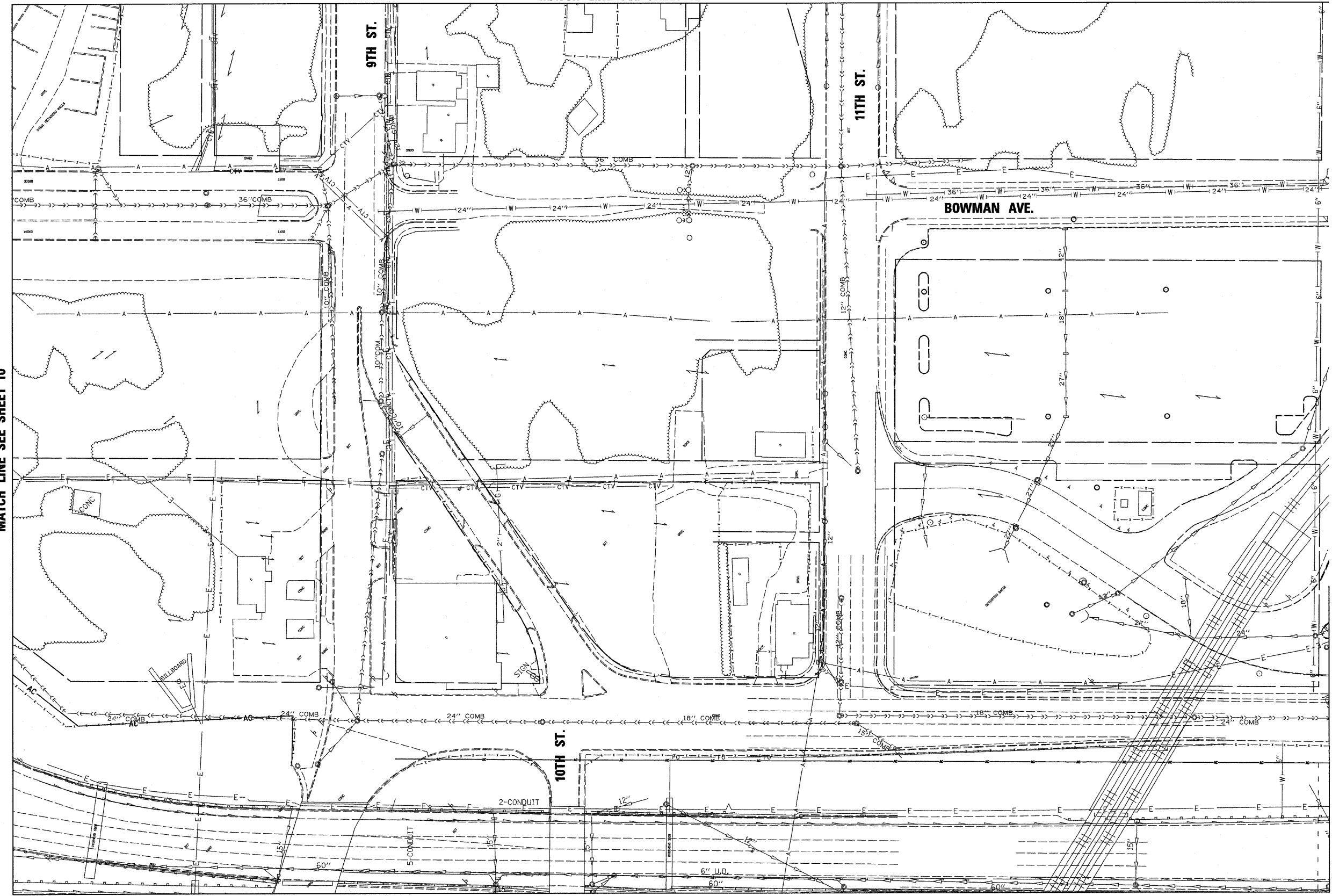

MATCH LINE SEE SHEET 14

MH NO.	TRAFFIC CONTROL STANDARD	COMMENT

FILE NAME = 8FILES*

USER NAME = IDOT	DESIGNED - TTB	REVISED -
PLOT SCALE = 50.0000' / IN.	DRAWN - GDO	REVISED -
PLOT DATE = 2/18/2009	CHECKED - JAH	REVISED -
	DATE - 2/18/2009	REVISED -

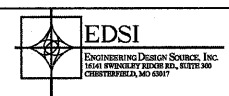

**STATE OF ILLINOIS
DEPARTMENT OF TRANSPORTATION**

SEWER LINING PLAN

SCALE: 1"=50' SHEET NO. 6 OF 9 SHEETS STA. TO STA.

F.A.I. RTE.	SECTION	COUNTY	TOTAL SHEETS	SHEET NO.
64	82-1T	ST. CLAIR	16	13
D-98-058-08		CONTRACT NO. 76C48		
FED. ROAD DIST. NO.		ILLINOIS FED. AID PROJECT		

MATCH LINE SEE SHEET 13

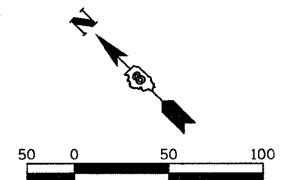

LEGEND

- MANHOLE LABEL
- PIPE LABEL
- PIPE LINER
- JOINT GROUTING

MATCH LINE SEE SHEET 11

MATCH LINE SEE SHEET 15

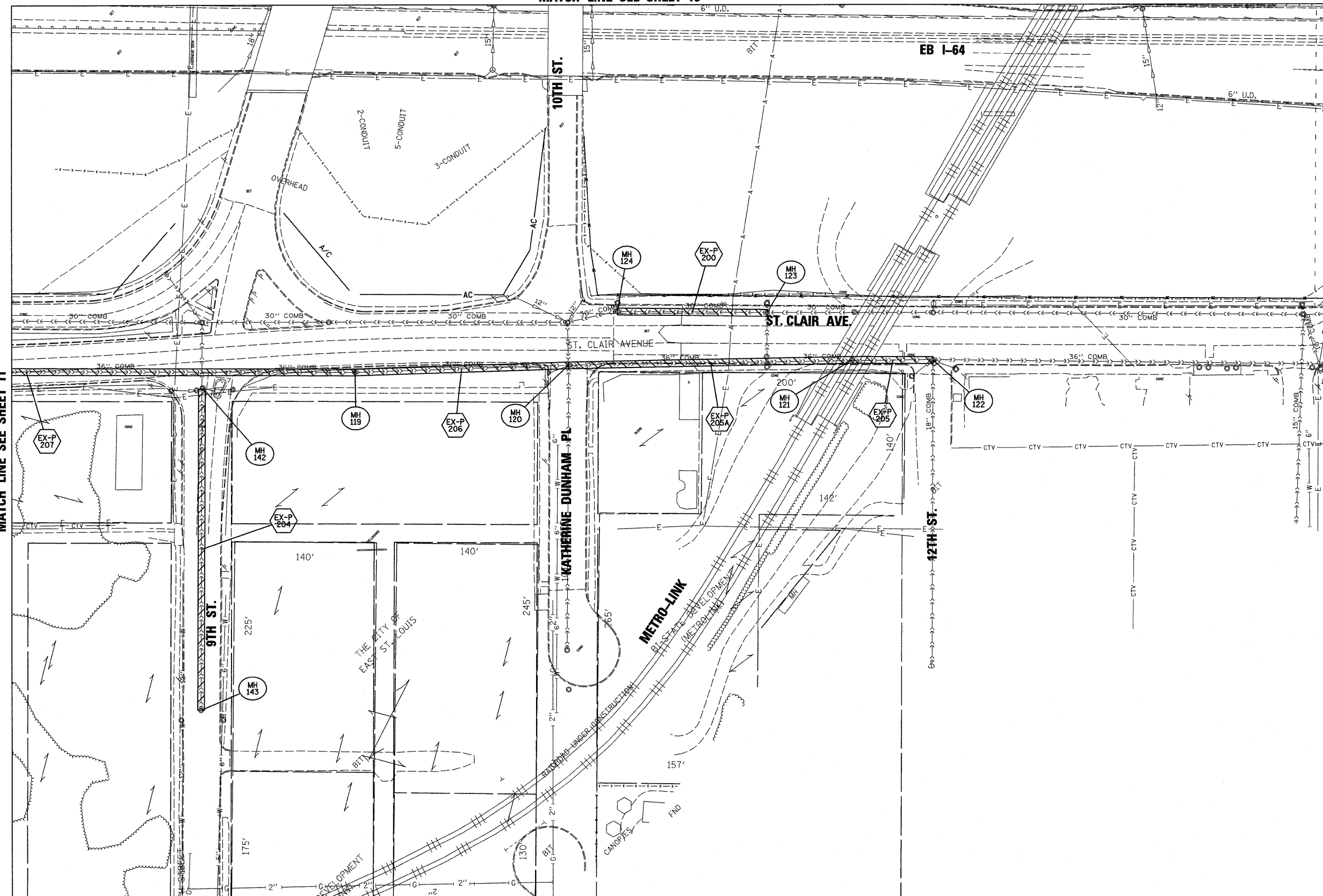

MH NO.	TRAFFIC CONTROL STANDARD	COMMENT
MH 119	701101 & 701801	
MH 120	701601 & 701701	
MH 121	701601 & 701801	
MH 122	701601 & 701801	
MH 123	701601	
MH 124	701601	
MH 142	701701	
MH 143	701601	

USER NAME = IDOT	DESIGNED - TTB	REVISED -
PLOT SCALE = 50,0000' / IN.	DRAWN - GDO	REVISED -
PLOT DATE = 2/18/2009	CHECKED - JAH	REVISED -
	DATE - 2/18/2009	REVISED -



**STATE OF ILLINOIS
DEPARTMENT OF TRANSPORTATION**

SEWER LINING PLAN

SCALE: 1"=50' SHEET NO. 7 OF 9 SHEETS STA. TO STA.

F.A.I. RTE.	SECTION	COUNTY	TOTAL SHEETS	SHEET NO.
64	82-1T	ST. CLAIR	16	14
D-98-058-08		CONTRACT NO. 76C48		
FED. ROAD DIST. NO.		ILLINOIS FED. AID PROJECT		

FILE NAME = #FILES#

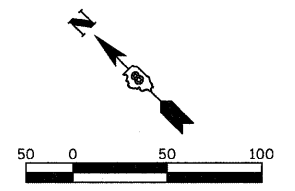

LEGEND

- MANHOLE LABEL
- PIPE LABEL
- PIPE LINER
- JOINT GROUTING

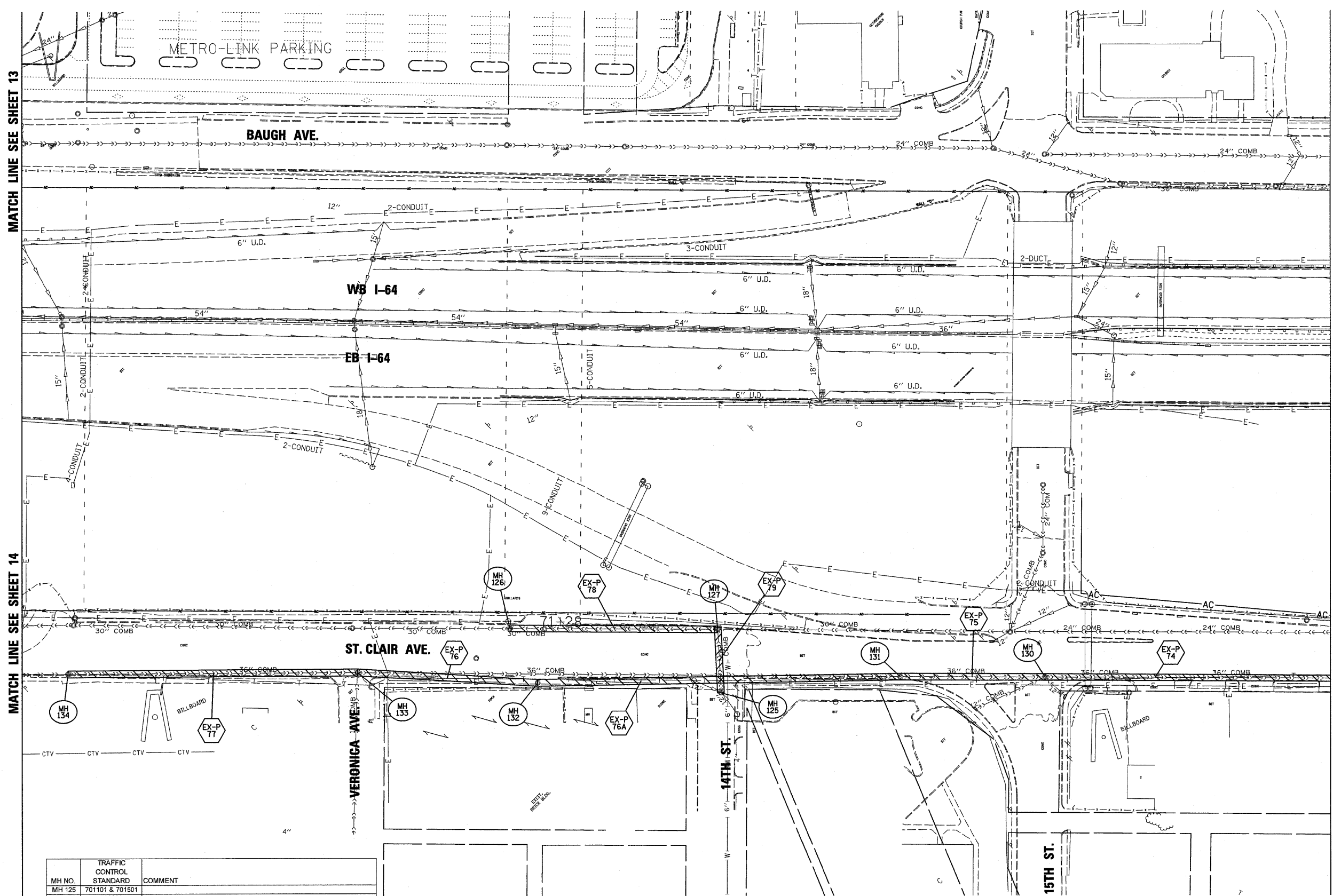

MATCH LINE SEE SHEET 13

MATCH LINE SEE SHEET 14

MATCH LINE SEE SHEET 16

MH NO.	TRAFFIC CONTROL STANDARD	COMMENT
MH 125	701101 & 701501	
MH 126	701601	
MH 127	701601 & 701801	
MH 130	701601 & 701701	POSSIBLE NEED FOR NON-STANDARD CLOSURE DETAIL
MH 131	701701 & 701801	
MH 132	701101 & 701801	MANHOLE TO BE RECONSTRUCTED AND CLASS C PATCH NEEDED
MH 133	701501 & 701601	
MH 134	701601 & 701801	MANHOLE TO BE RECONSTRUCTED AND CLASS C PATCH NEEDED

FILE NAME = BFILES

USER NAME = IDOT	DESIGNED - TTB	REVISED -
	DRAWN - GDD	REVISED -
PLOT SCALE = 50.0000' / IN.	CHECKED - JAH	REVISED -
PLOT DATE = 2/18/2009	DATE - 2/18/2009	REVISED -



**STATE OF ILLINOIS
DEPARTMENT OF TRANSPORTATION**

SEWER LINING PLAN

SCALE: 1"=50' SHEET NO. 8 OF 9 SHEETS STA. TO STA.

F.A.I. RTE.	SECTION	COUNTY	TOTAL SHEETS	SHEET NO.
64	82-1T	ST. CLAIR	16	15
D-98-058-08		CONTRACT NO.	76C48	
FED. ROAD DIST. NO.		ILLINOIS FED. AID PROJECT		

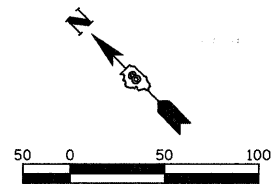

LEGEND

- MANHOLE LABEL
- PIPE LABEL
- PIPE LINER
- JOINT GROUTING

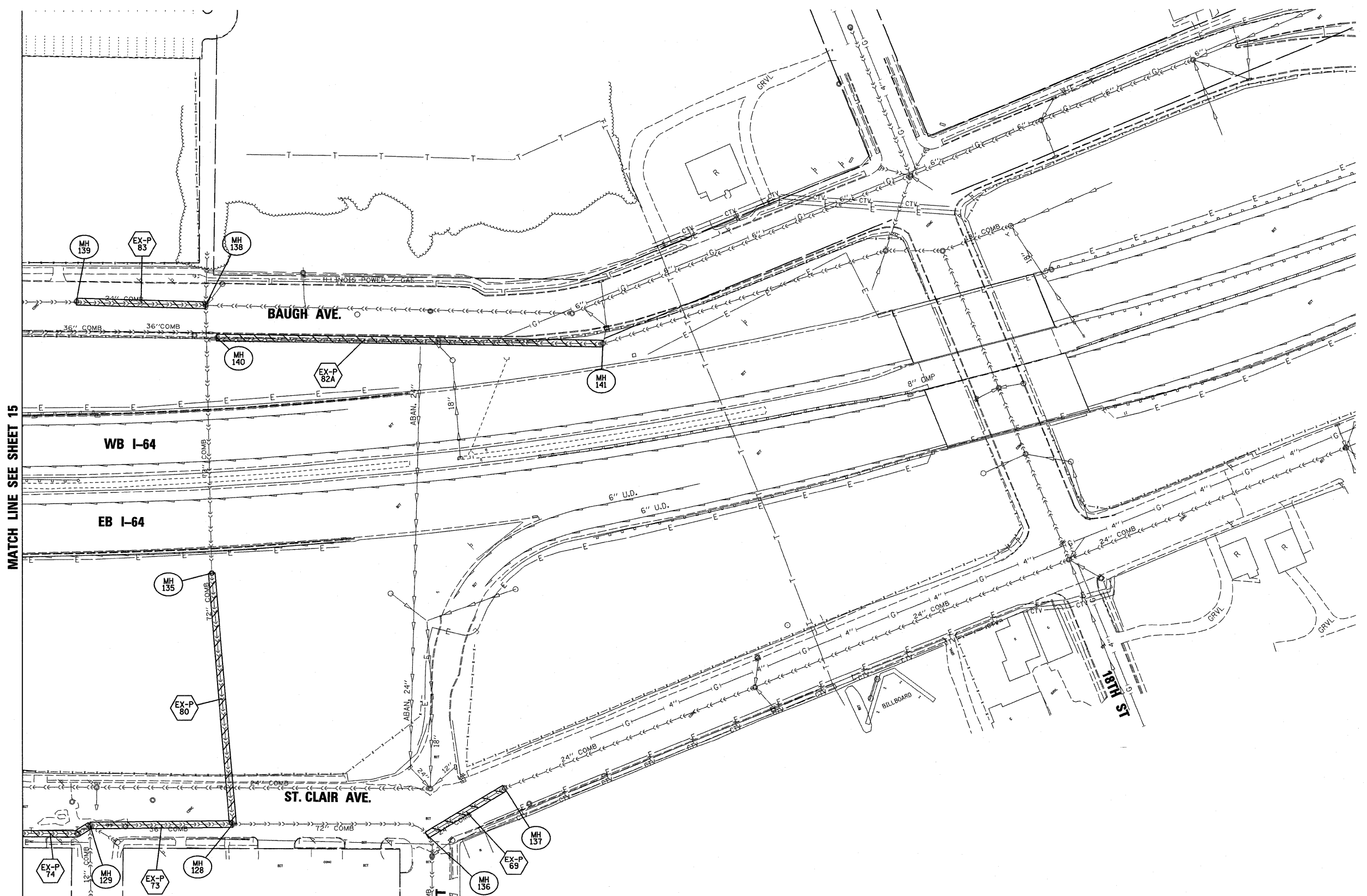

MATCH LINE SEE SHEET 15

MH NO.	TRAFFIC CONTROL STANDARD	COMMENT
MH 128	701601	
MH 129	701501 & 701601	POSSIBLE NEED FOR NON-STANDARD CLOSURE DETAIL
MH 135	701106	
MH 136	701601 & 701701	MANHOLE TO BE RECONSTRUCTED AND CLASS C PATCH NEEDED
MH 137	701601	
MH 138	701601	
MH 139	701601	
MH 140	701101 & 701801	
MH 141	701106	

FILE NAME = #FILES

USER NAME = IDOT	DESIGNED - TTB	REVISED -
	DRAWN - GDO	REVISED -
PLOT SCALE = 50.0000' / IN.	CHECKED - JAH	REVISED -
PLOT DATE = 2/18/2009	DATE - 2/18/2009	REVISED -

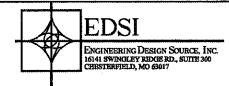

**STATE OF ILLINOIS
DEPARTMENT OF TRANSPORTATION**

SEWER LINING PLAN

SCALE: 1"=50' SHEET NO. 9 OF 9 SHEETS STA. TO STA.

F.A.I. RTE.	SECTION	COUNTY	TOTAL SHEETS	SHEET NO.
64	82-1T	ST. CLAIR	16	16
D-98-058-08		CONTRACT NO. 76C48		
FED. ROAD DIST. NO. ILLINOIS		FED. AID PROJECT		