

NOTE

TRAFFIC CONTROL SHALL BE INSTALLED AS SHOWN IN THE PLANS. THE COST OF THIS TRAFFIC CONTROL SHALL BE INCLUDED IN THE PAY ITEM "TRAFFIC CONTROL AND PROTECTION STANDARD 701411 (SPECIAL)."

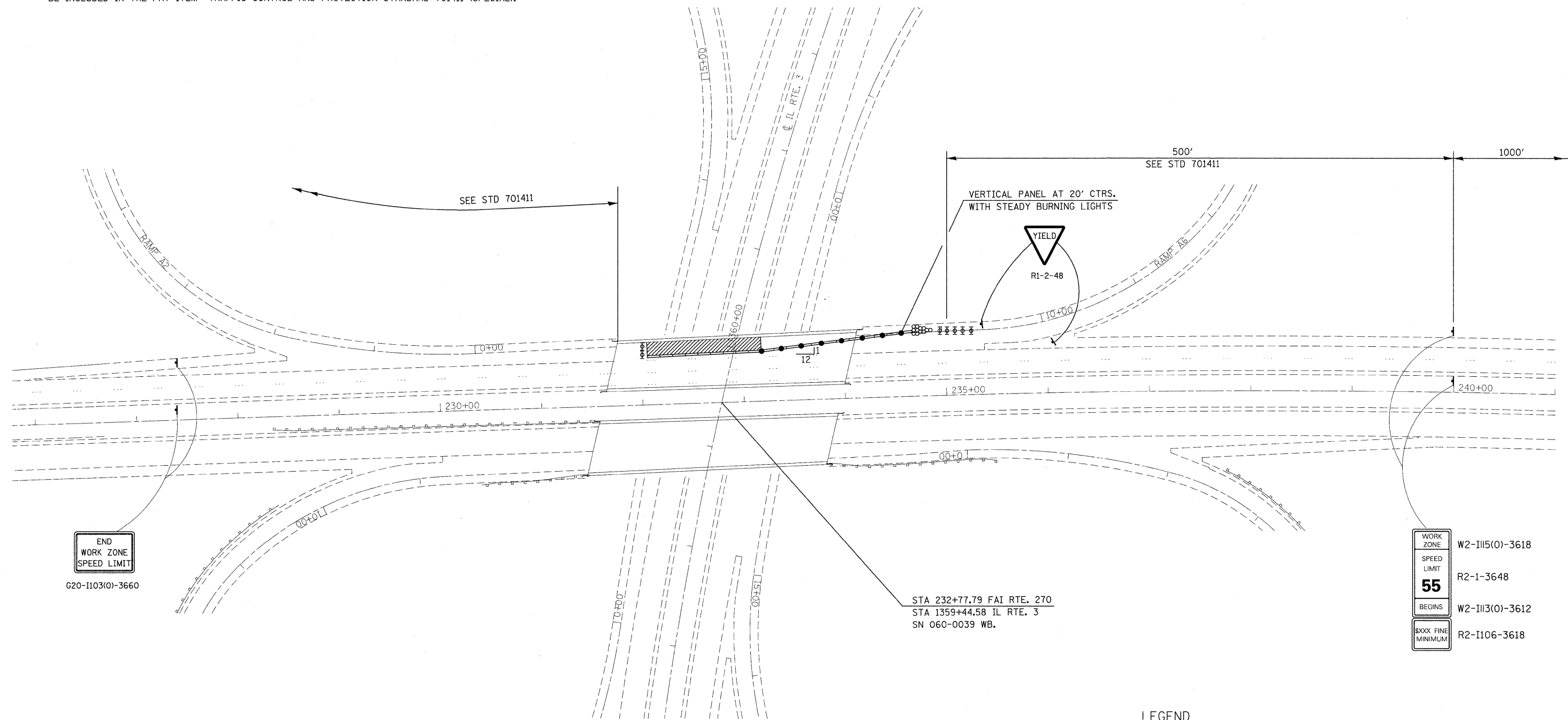

END
WORK ZONE
SPEED LIMIT

G20-1103(0)-3660

WORK ZONE W2-II15(0)-3618
SPEED LIMIT R2-1-3648
55
BEGINS W2-II13(0)-3612
\$XXX FINE MINIMUM R2-II06-3618

STA 232+77.79 FAI RTE. 270
STA 1359+44.58 IL RTE. 3
SN 060-0039 WB.

LEGEND

- NOMODIRECTIONAL BURNING LIGHTS AND VERTICAL PANELS
- ⊕ DRUMS WITH STEADY MONODIRECTIONAL LIGHT
- ⊥ SIGNS
- ▬ TEMPORARY CONCRETE BARRIER
- ⊗ IMPACT ATTENUATORS
- ▨ WORK AREA

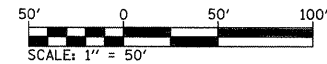

FILE NAME =	USER NAME = gelinh	DESIGNED -	REVISED -	STATE OF ILLINOIS DEPARTMENT OF TRANSPORTATION	TRAFFIC CONTROL & PROTECTION PLAN	F.A.I. RTE.	SECTION	COUNTY	TOTAL SHEETS	SHEET NO.	
es:\pw_work\PWIDOT\GELINH\d0120465\0876095-aht-staging.dgn	PLOT SCALE = 50,0000' / IN.	DRAWN -	REVISED -			270	60-2HB-I-HDF-3	MADISON	8	3	
	PLOT DATE = 6/23/2009	CHECKED -	REVISED -			CONTRACT NO. 76C95					
		DATE -	REVISED -			ILLINOIS FED. AID PROJECT					