

F.A.U. RTE.	SECTION	COUNTY	TOTAL SHEETS	SHEET NO.
3570	00-00116-00-8R	DUPAGE	106	8
STA.		TO STA.		
FED. ROAD DIST. NO.		ILLINOIS FED. AID PROJECT		

<p>EXIST. CURVE C1-2 $\Delta = 19^\circ 59' 15''$ (LT) $D = 3^\circ 22' 03''$ $R = 1,701.40'$ $T = 299.81'$ $L = 593.53'$ $E = 26.21'$ PI STA. = 2+99.81 P.C. STA. = 0+00.00 P.T. STA. = 5+93.53</p>	<p>EXIST. CURVE C3-4 $\Delta = 16^\circ 10' 40''$ (RT) $D = 7^\circ 23' 33''$ $R = 775.05'$ $T = 110.15'$ $L = 218.84'$ $E = 7.79'$ PI STA. = 9+01.06 P.C. STA. = 7+90.91 P.T. STA. = 10+09.75</p>	<p>PROP. CURVE PRC11-15 $\Delta = 16^\circ 48' 37''$ (RT) $D = 2^\circ 08' 02''$ $R = 2,685.00'$ $T = 396.74'$ $L = 787.77'$ $E = 29.15'$ PI STA. = 10+11.15 P.C. STA. = 6+14.41 P.T. STA. = 14+02.18</p>	<p>EXIST. CURVE C5-13 $\Delta = 4^\circ 41' 45''$ (RT) $D = 1^\circ 50' 02''$ $R = 3,124.16'$ $T = 128.10'$ $L = 256.05'$ $E = 2.62'$ PI STA. = 13+04.86 P.C. STA. = 11+76.77 P.T. STA. = 14+32.81</p>	<p>EXIST. CURVE C13-14 $\Delta = 4^\circ 08' 21''$ (RT) $D = 7^\circ 09' 43''$ $R = 800.00'$ $T = 28.91'$ $L = 57.79'$ $E = 0.52'$ PI STA. = 14+61.72 P.C. STA. = 14+32.81 P.T. STA. = 14+90.61</p>	<p>PROP. CURVE C15-14 $\Delta = 6^\circ 01' 05''$ (RT) $D = 7^\circ 09' 43''$ $R = 800.00'$ $T = 42.05'$ $L = 84.03'$ $E = 1.10'$ PI STA. = 14+44.24 P.C. STA. = 14+02.18 P.T. STA. = 14+86.21</p>
---	---	--	---	--	---



STATION	T-1	T-2	T-3
P.T. STA 5+22.84	50.64'	70.74'	104.54'
P.C. STA 6+14.41	103.56'	71.37'	51.30'

STATION	T-1	T-2	T-3	T-4
P.C.C. STA. = 14+02.18	54.57'	68.45'	95.07'	
P.T. STA. = 14+86.21		69.18'	52.87'	33.09'

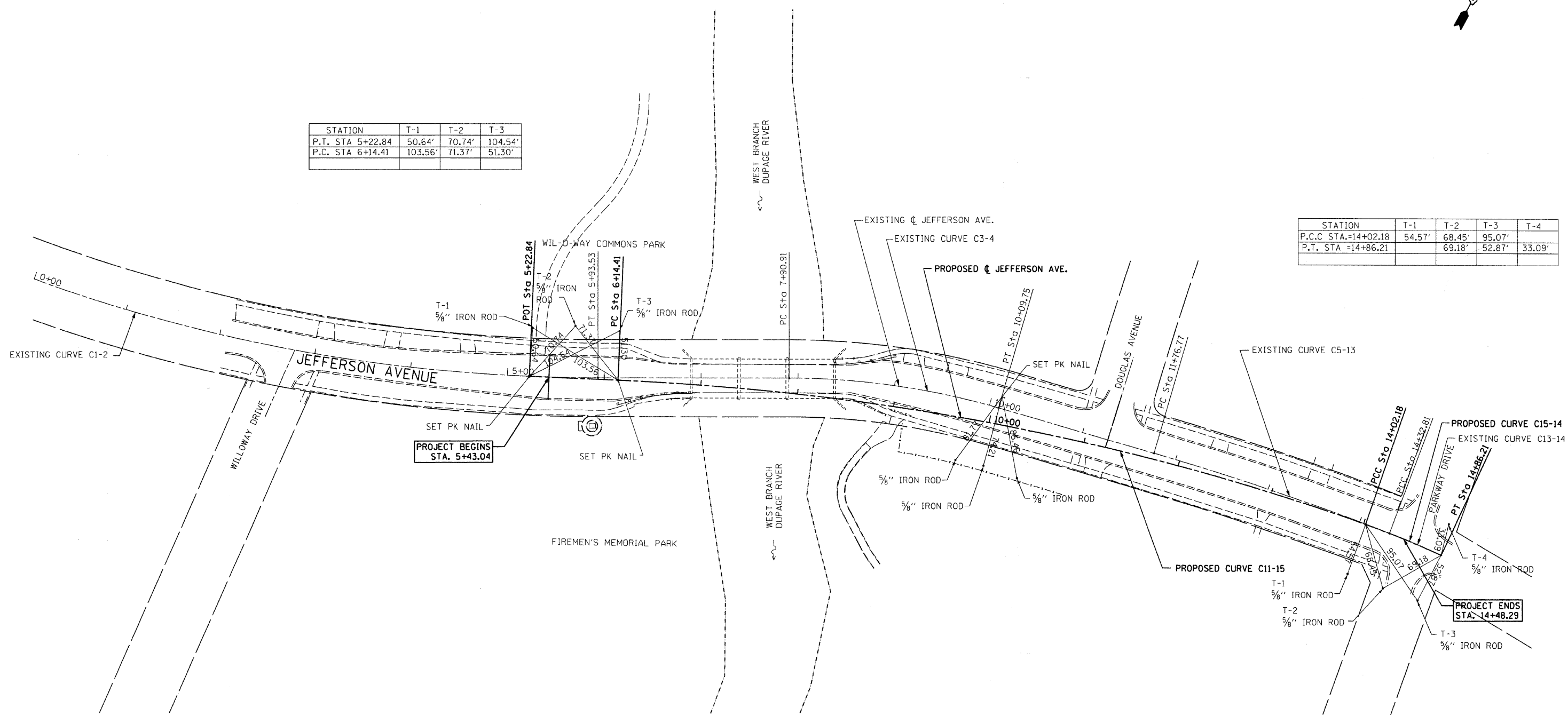

REVISIONS	
NAME	DATE
PER DEC & CLIENT	9/13/05
PER IDOT	11/1/05

ILLINOIS DEPARTMENT OF TRANSPORTATION
ALIGNMENT AND TIES
 JEFFERSON AVENUE OVER WEST BRANCH DUPAGE RIVER
 SCALE: 1" = 100'
 DATE: APRIL 6, 2009
 DRAWN BY: BCD
 CHECKED BY: HRT

M:\065-030 & 068-032 Jefferson Revisions 09\CADD Sheets\Alignment.dgn
 7/15/2009 11:25:59 AM