

CONTRACT NO. 83827				
F.A.U. RTE.	SECTION	COUNTY	TOTAL SHEETS	SHEET NO.
3570	00-00116-00-BR	DUPAGE	106	11
STA.	10+00	TO STA.	14+48.29	
FED. ROAD DIST. NO.	ILLINOIS	FED. AID PROJECT		

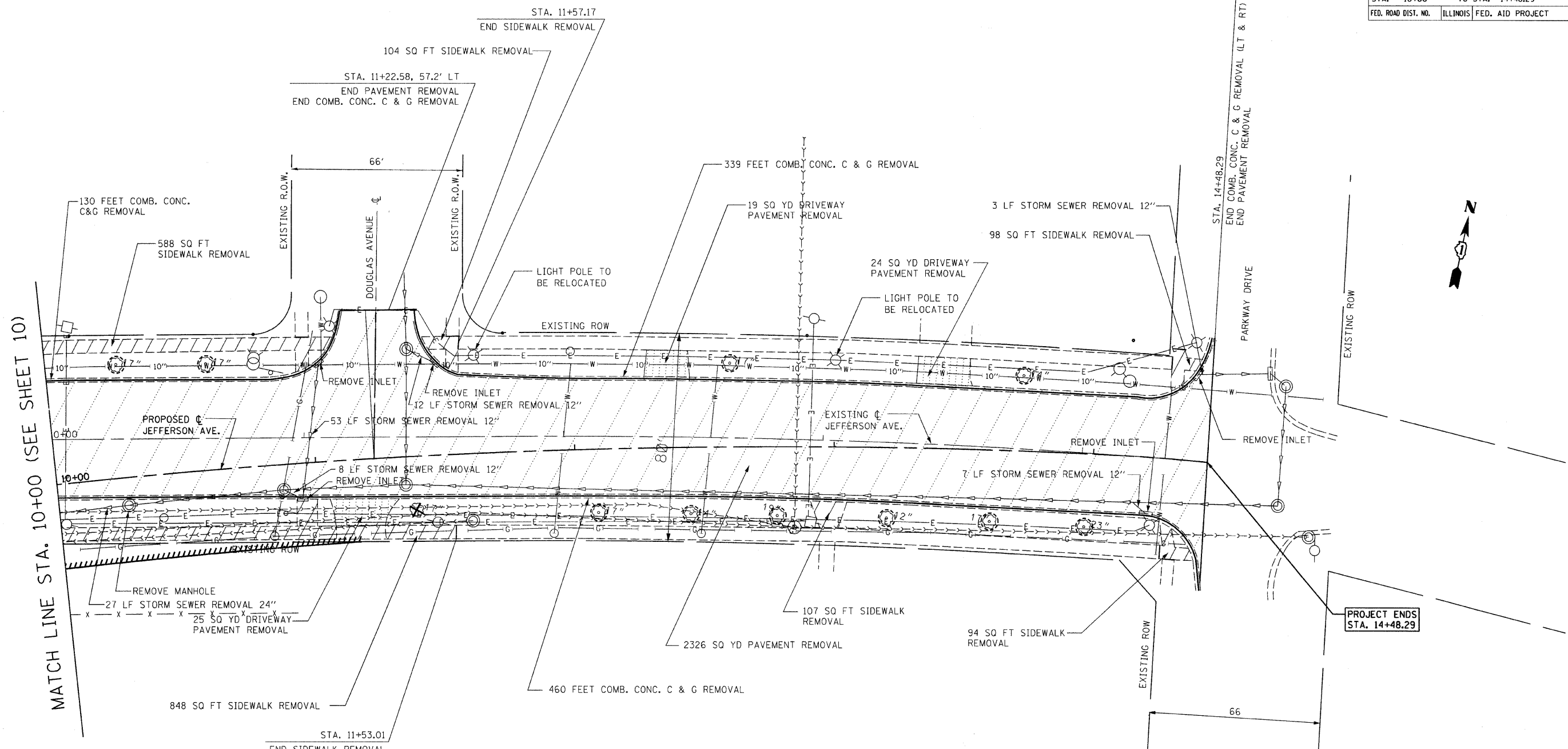

LEGEND

- | | | | |
|--|--|--|---------------------------------|
| | PAVEMENT REMOVAL | | FENCE |
| | DRIVEWAY PAVEMENT REMOVAL | | GAS VALVE |
| | BIT. SURF. REM. BUTT JOINT | | STRUCTURE TO BE ADJUSTED |
| | BIT. SURF. REM. | | STRUCTURE TO BE REMOVED |
| | PCC SIDEWALK REMOVAL | | AMERITECH TELEPHONE BOX |
| | COMB. CONC. CURB & GUTTER REM. OR CONC. GUTTER REMOVAL | | UTILITY POLE |
| | ITEM TO BE REMOVED | | UTILITY POLE WITH LIGHT |
| | WATER LINE | | UTILITY POLE WITH AMERICAST BOX |
| | GAS LINE | | ELECTRIC METER |
| | TELEPHONE BURIED DUCT RUN | | TRAFFIC SIGNAL |
| | STORM SEWER | | TSC HANDHOLE |
| | SANITARY SEWER | | CONTROL BOX |
| | TREE | | |
| | LIGHT POLE | | |
| | MANHOLE | | |
| | CATCH BASIN | | |
| | INLET | | |
| | WATER VALVE | | |
| | SIGN | | |
| | FIRE HYDRANT | | |
| | TREE TO BE REMOVED | | |
| | TREE TO BE PROTECTED | | |

NOTES:

- SIGNS TO BE REMOVED, STORED AND REINSTALLED BY CITY OF NAPERVILLE AT THE END OF PROJECT
- FOR GRADING PLAN SEE SHEETS 14-18
- FOR ALIGNMENT AND TIES SEE SHEET 8
- FOR BRIDGE REMOVAL QUANTITIES SEE STRUCTURAL SHEET S2
- COORDINATE LIMITS OF REMOVAL WITH CITY OF NAPERVILLE DEPT OF PUBLIC UTILITIES SEE SHEETS 56-85
- CONTRACTOR SHALL BE AWARE OF ALL OVERHEAD UTILITY LINES WITHIN PROJECT LIMITS. CONTRACTOR SHALL CONDUCT HIS/HER OPERATIONS TO MAINTAIN SERVICE ON THESE LINES

REVISIONS	
NAME	DATE
PER DEC & CLIENT	9/13/05
PER IDOT	11/1/05

ILLINOIS DEPARTMENT OF TRANSPORTATION

**EXISTING CONDITIONS
JEFFERSON AVENUE OVER
WEST BRANCH DUPAGE RIVER**

SCALE: 1" = 20'
DATE: APRIL 6, 2009

DRAWN BY: GM
CHECKED BY: HRT

W:\068-030 & 068-032 Jefferson Revisions 09\CADD Sheets\Existing-2.dgn
 7/15/2009 11:32:45 AM