

CONTRACT NO. 83827				
F.A.U. RTE.	SECTION	COUNTY	TOTAL SHEETS	SHEET NO.
3570	00-00116-00-BR	DUPAGE	106	15
STA.		TO STA.		
FED. ROAD DIST. NO.		ILLINOIS FED. AID PROJECT		

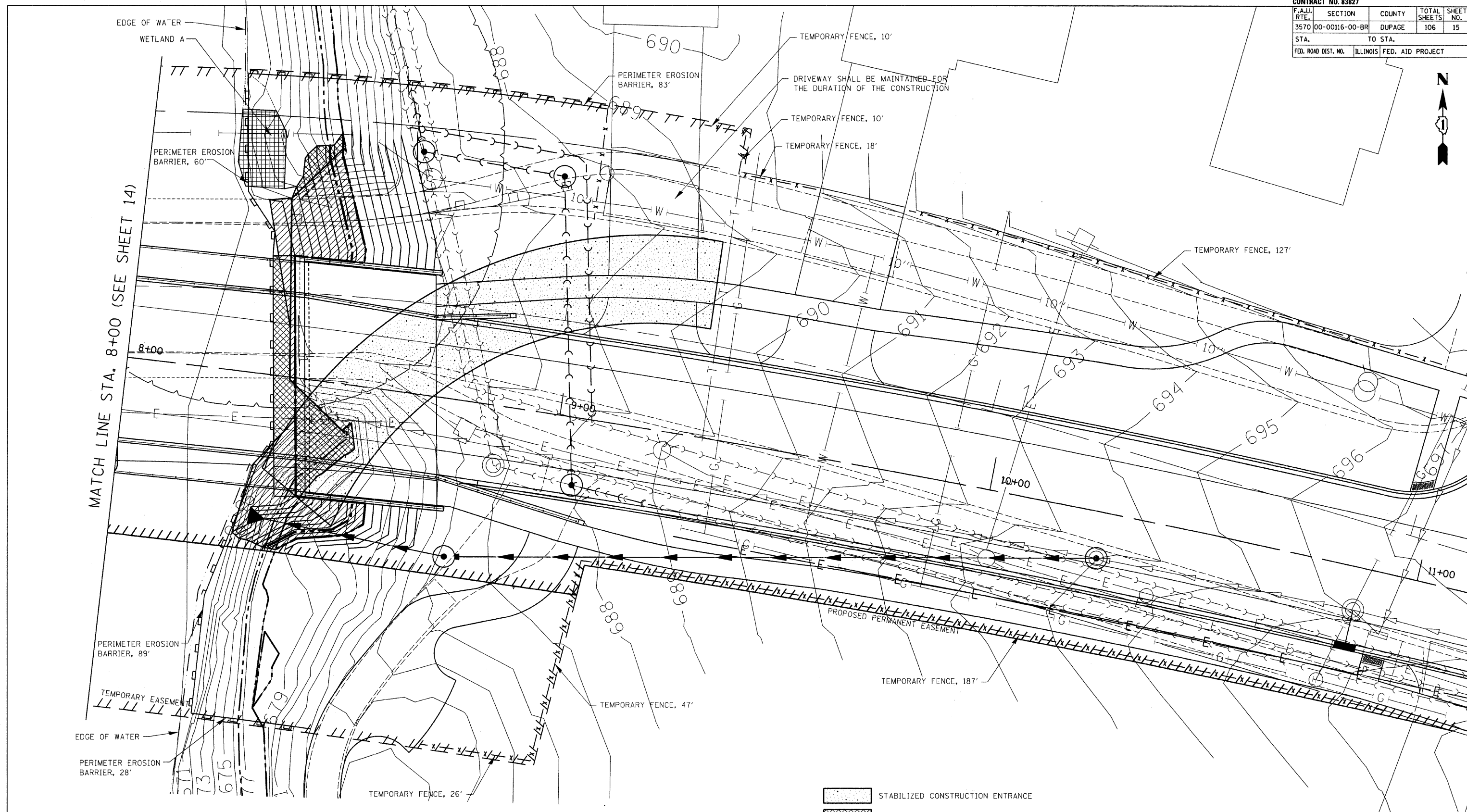

MATCH LINE STA. 8+00 (SEE SHEET 14)

- EDGE OF WATER
- EXISTING 10-YEAR FLOODPLAIN/FLOODWAY (ELEVATION=676.5)
- PROPOSED 10-YEAR FLOODPLAIN/FLOODWAY (ELEVATION=676.5)
- EXISTING 100-YEAR FLOODPLAIN/FLOODWAY (ELEVATION=678.0) AND RIPARIAN ENVIRONMENT

- PROPOSED 100-YEAR FLOODPLAIN/FLOODWAY (ELEVATION=678.0) AND RIPARIAN ENVIRONMENT (0.028 AC RIPARIAN IMPACT)
- WETLAND (TOTAL AREA = 0.005 AC)
- 50-FOOT WETLAND BUFFER
- x - x - x - TEMPORARY FENCE

LEGEND

- STABILIZED CONSTRUCTION ENTRANCE
 - FLOODPLAIN FILL (0.010 AC RIPARIAN IMPACT)
 - COMPENSATORY STORAGE (0.018 AC RIPARIAN IMPACT)
 - TEMPORARY WETLAND IMPACT (0.004 AC)
 - PERIMETER EROSION BARRIER
- SEE STRIPING PLAN FOR SEEDING CLASS 2 AND EROSION CONTROL BLANKET (C500)

REVISIONS	
NAME	DATE
PER DEC & CLIENT	9/13/05
PER IDOT	11/1/05

ILLINOIS DEPARTMENT OF TRANSPORTATION
EROSION CONTROL AND PROPOSED GRADING PLAN
 JEFFERSON AVENUE OVER WEST BRANCH DUPAGE RIVER
 SCALE: 1"=10'
 DATE: APRIL 6, 2009
 DRAWN BY: BCD
 CHECKED BY: HRT

W:\068-030 & 068-032 Jefferson Revisions\09\CADD Sheets\Grading_2.dgn 9/13/05 AM 7/15/2009