

CONTRACT NO. 83827				
F.A.U. RTE.	SECTION	COUNTY	TOTAL SHEETS	SHEET NO.
3570	00-00116-00-BR	DUPAGE	106	19
STA. 5+22.84		TO STA. 10+00		
FED. ROAD DIST. NO.	ILLINOIS	FED. AID PROJECT		

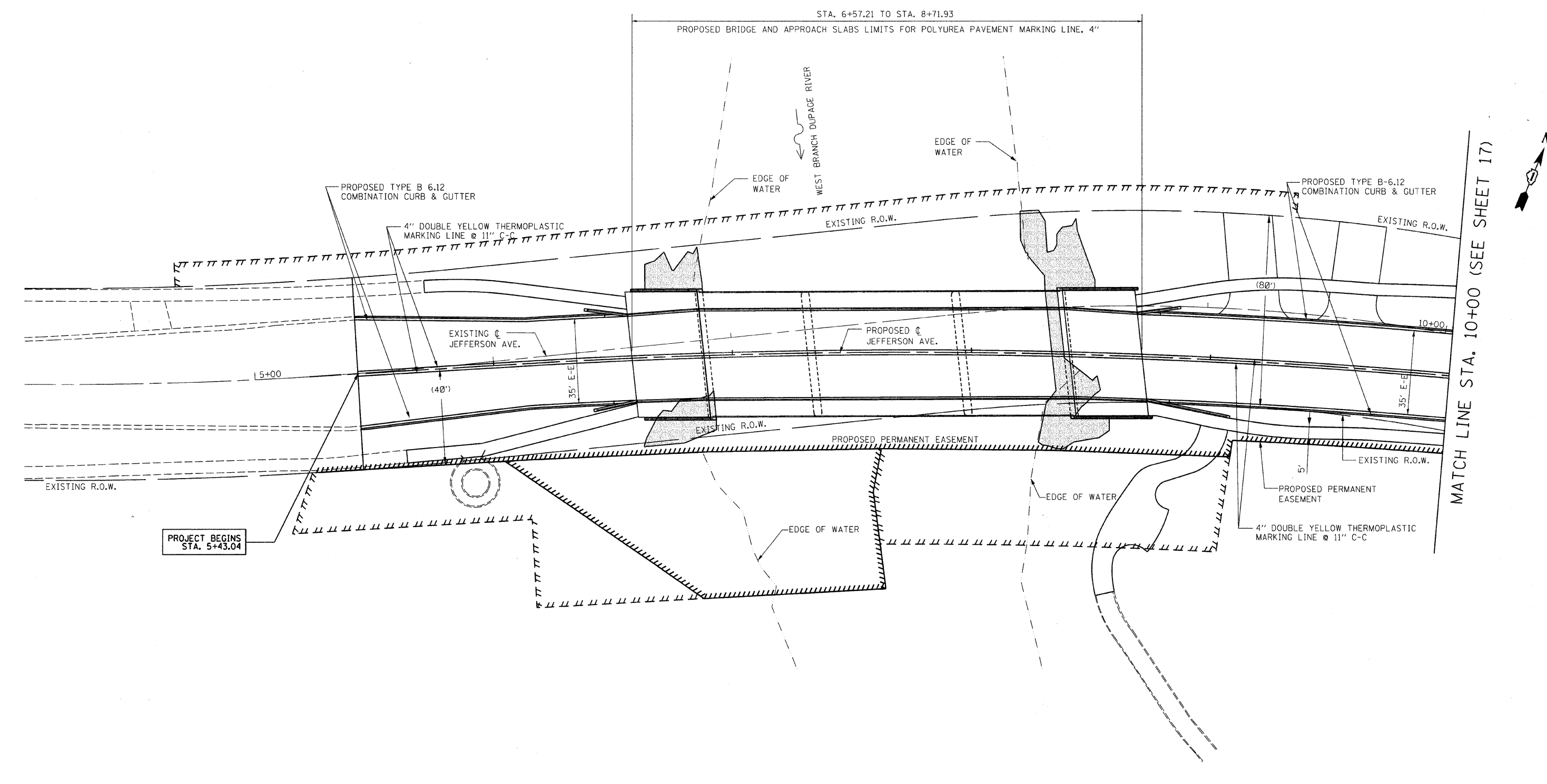

MATCH LINE STA. 10+00 (SEE SHEET 17)



PROJECT BEGINS
STA. 5+43.04

- SEEDING CLASS 2 AND
EROSION CONTROL BLANKET (C500)

REVISIONS	
NAME	DATE
PER DEC & CLIENT	9/13/05
PER IDOT	11/1/05

ILLINOIS DEPARTMENT OF TRANSPORTATION
STRIPING PLAN

JEFFERSON AVENUE OVER
WEST BRANCH DUPAGE RIVER

SCALE: 1"=20'
DATE: APRIL 6, 2009

DRAWN BY: BCD
CHECKED BY: HRT

M:\068-030 & 068-032 Jefferson Revisions\09\CADD Sheets\Striping sh 1.dgn
7/15/2009 11:41:12 AM