

CONTRACT NO. 03827				
F.A.U. RTE.	SECTION	COUNTY	TOTAL SHEETS	SHEET NO.
3570	00-00116-00-BR	DUPAGE	106	103
STA.		TO STA.		
FED. ROAD DIST. NO.		ILLINOIS FED. AID PROJECT		



Land Planning
Landscape Architecture
Environmental Site Design

17 COURT PLACE - NAPERVILLE, IL 60540 - 630.305.3963 Fax 630.305.8994

project:

RIVERWALK JEFFERSON AVE. GATEWAY PLAZA

Brethren Peace Plaza

NAPERVILLE, ILLINOIS

sheet description:

Layout and Grading Plan

SCALE NOTE:
ATTENTION: THE SCALE ON THIS PLAN DRAWING
1/8" = 10' IS DIFFERENT THAN THAT OF THE BRIDGE
RECONSTRUCTION PLANS AND AS SHOWN ON THE
ENGINEERING COVER SHEET. PLAN USERS TAKE NOTICE.

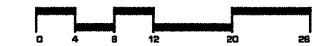

scale: 1/8" = 10'

8/04/2005	Per New Bike Parking Area
8/05/2005	Per RMC Review Comments
10/08/2005	Per IDOT Review
8/19/2005	Per Bollinger, Lach & Associates Preliminary Plan Review Comments
7/19/2005	Per City Review Comments ADA Grading
8/18/2005	Per RW Commission Review 80% Progress Prints

original issue date: 2 MAY 2005

drawn by:

checked by:

project no: 25005

sheet no:

L.2 of 5

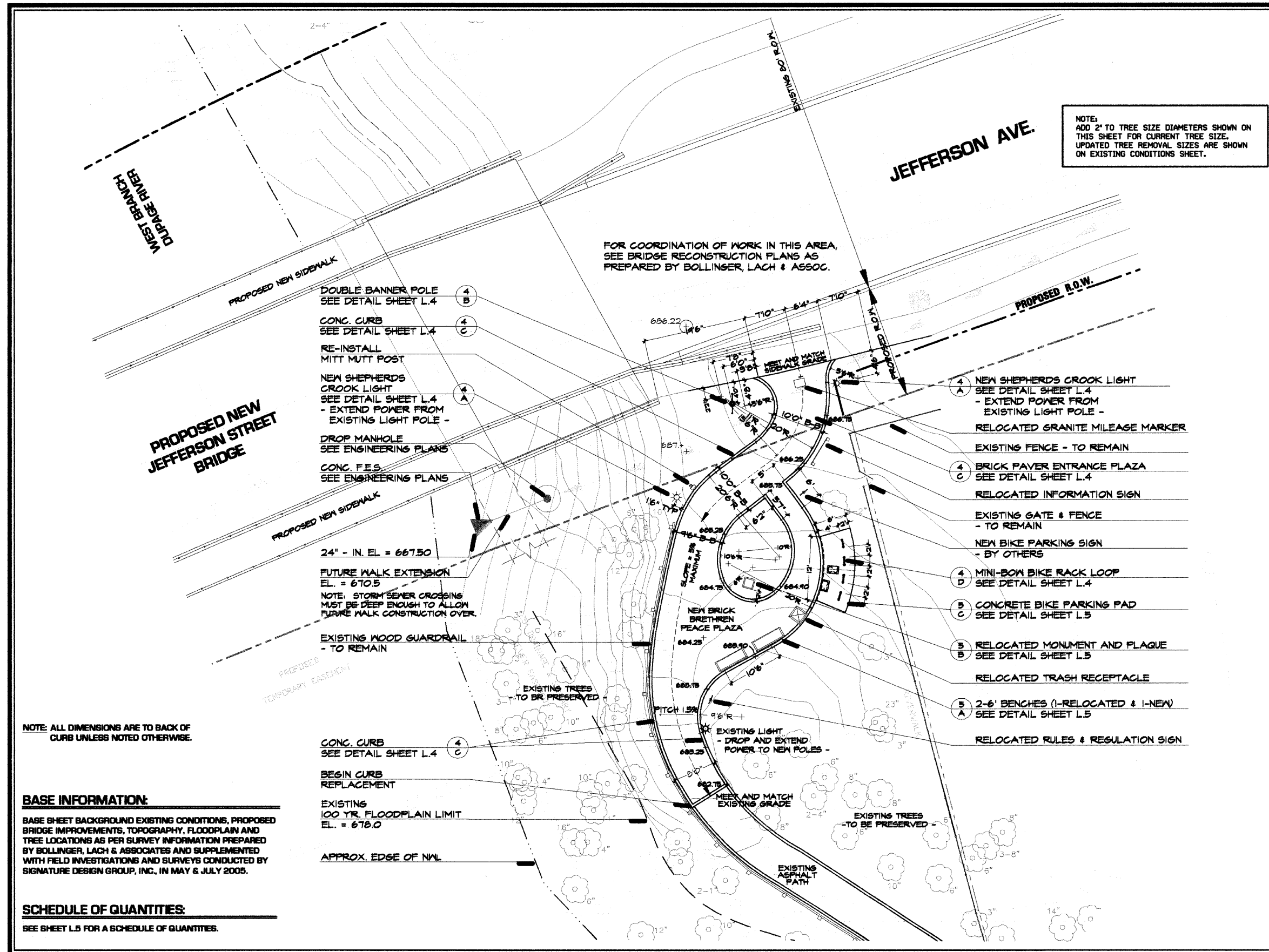

NOTE: ALL DIMENSIONS ARE TO BACK OF CURB UNLESS NOTED OTHERWISE.

BASE INFORMATION:

BASE SHEET BACKGROUND EXISTING CONDITIONS, PROPOSED BRIDGE IMPROVEMENTS, TOPOGRAPHY, FLOODPLAIN AND TREE LOCATIONS AS PER SURVEY INFORMATION PREPARED BY BOLLINGER, LACH & ASSOCIATES AND SUPPLEMENTED WITH FIELD INVESTIGATIONS AND SURVEYS CONDUCTED BY SIGNATURE DESIGN GROUP, INC. IN MAY & JULY 2005.

SCHEDULE OF QUANTITIES:

SEE SHEET L.5 FOR A SCHEDULE OF QUANTITIES.