

ROUTE NO.	SECTION	COUNTY	TOTAL SHEETS	SHEET NO.
C.H. 3	93-00112-00-BR	JoDAVIESS	42	41
		ILLINOIS		

CONTRACT NO. 85462

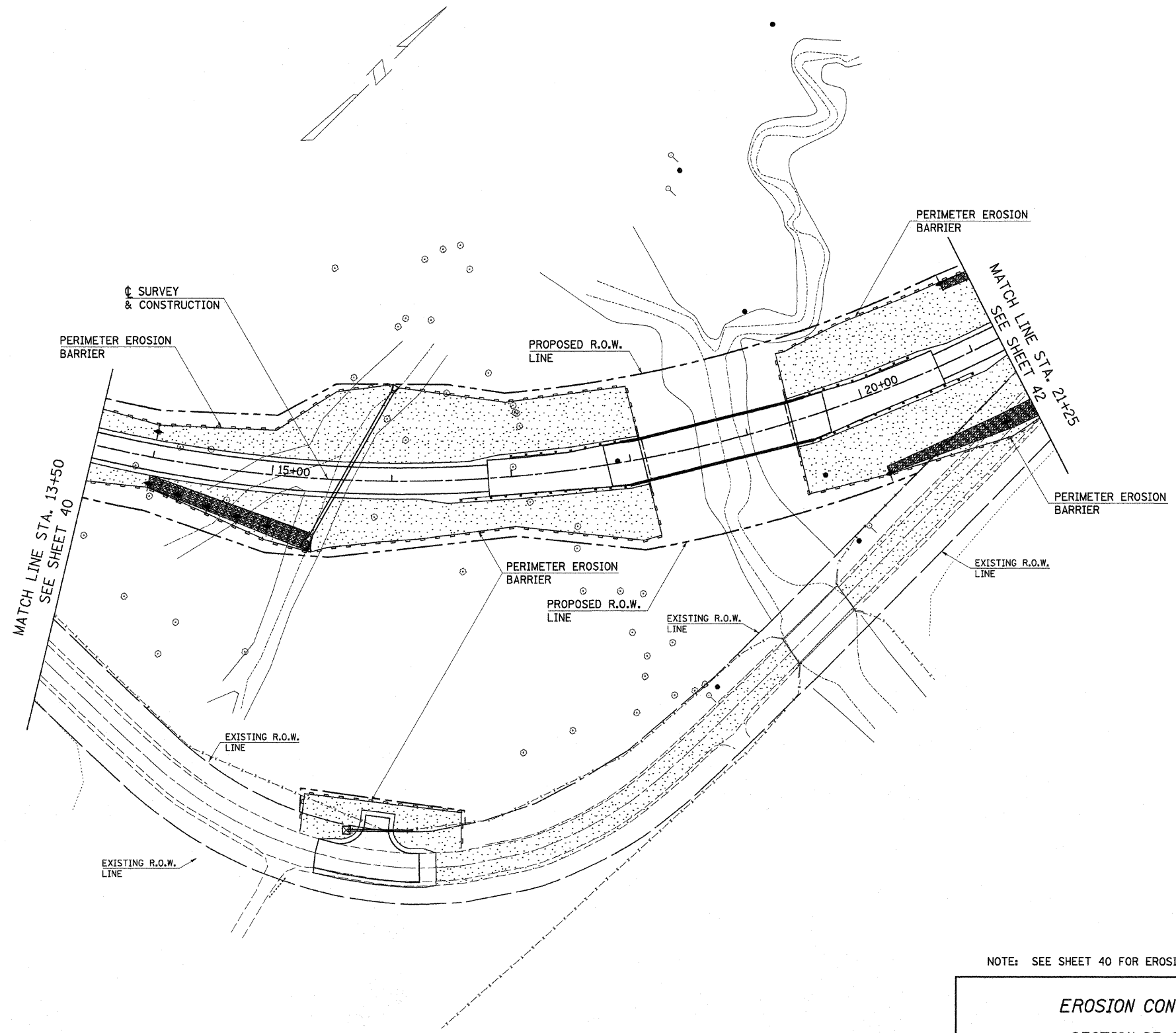

TEMPORARY EROSION CONTROL:	
	PERIMETER EROSION BARRIER
	TEMPORARY DITCH CHECK
	INLET AND PIPE PROTECTION
PERMANENT EROSION CONTROL:	
	SEEDING CLASS 2, FERTILIZERS, & MULCH, METHOD 2
	STONE RIPRAP DITCH

NOTE: SEE SHEET 40 FOR EROSION CONTROL QUANTITIES.

EROSION CONTROL PLAN
SECTION 93-00112-00-BR
JoDAVIESS COUNTY
COUNTY HIGHWAY 3
STATION 18+74.60

4440 ASH GROVE
SPRINGFIELD, IL. 62711
(217) 793-8600
www.fehr-graham.com

FEHR-GRAHAM & ASSOCIATES, LLC
ENGINEERING AND SCIENCE CONSULTANTS
PROFESSIONAL ENGINEERS, ARCHITECTS, SURVEYORS & SCIENTISTS IN SPRINGFIELD, IL

DRAWN: S.A.P.
DATE: 07/16/08

CHECKED: G.J.C.
DATE: 01/12/09

JOB NO.: 46859
FILE: EROSION.DGN
DATE: 03/24/09