

CORE JOINT DETAIL

© Sta. 15+50 & Sta. 24+00 (Mirrored)

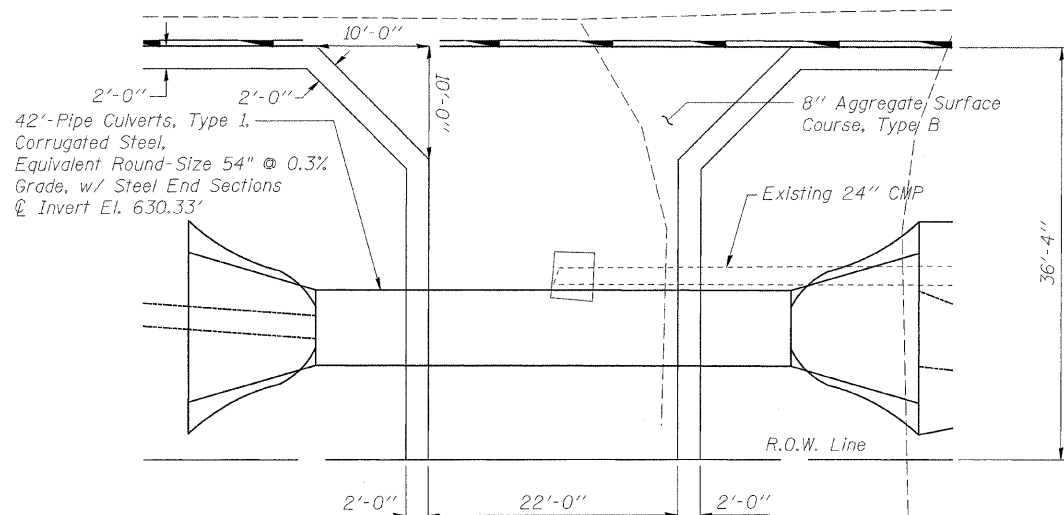

F.E.R. 19+24

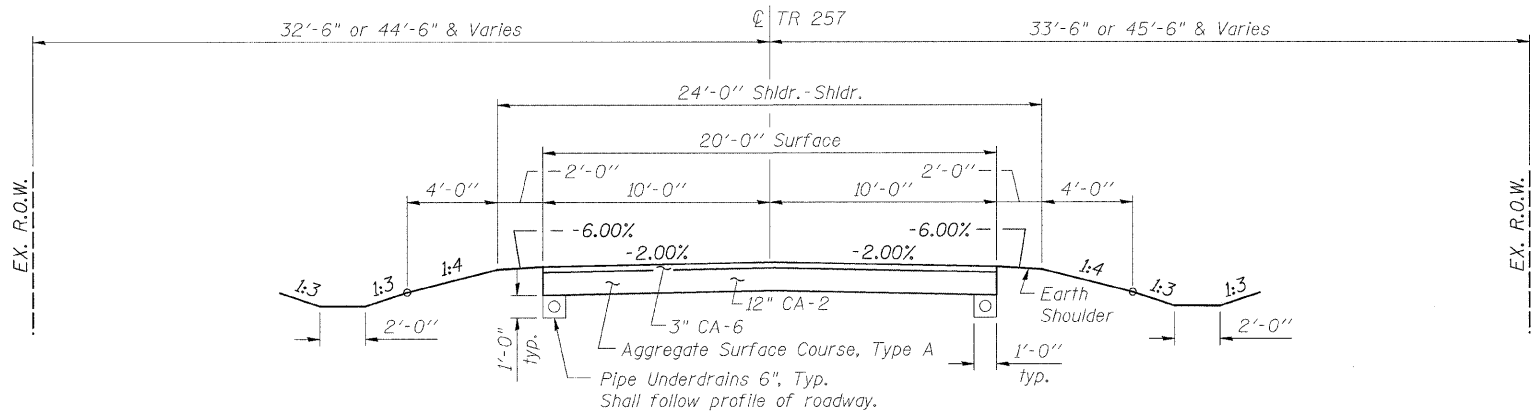

PROPOSED TYPICAL SECTION

Highway Classification: Local Road (Non-Urban)
Design Speed: 30
ADT = 80

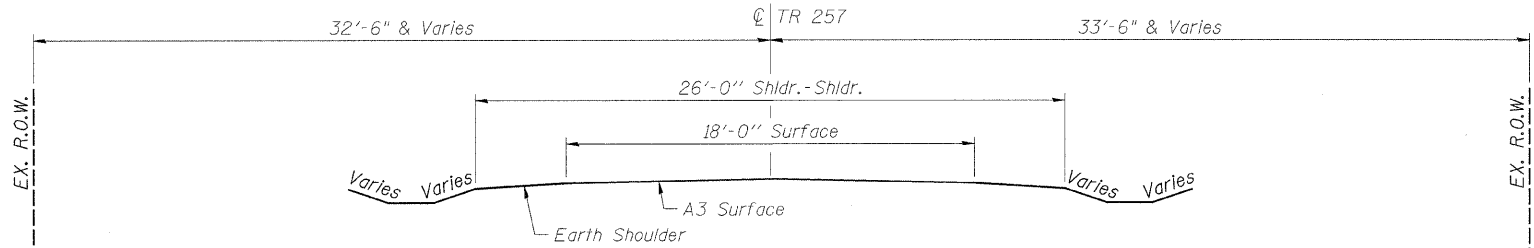

EXISTING TYPICAL SECTION

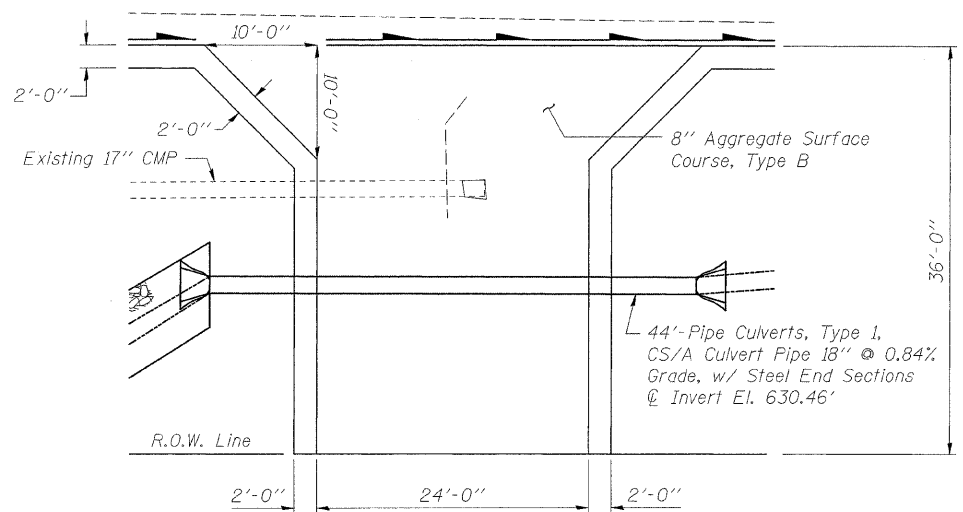

F.E.R. 20+87

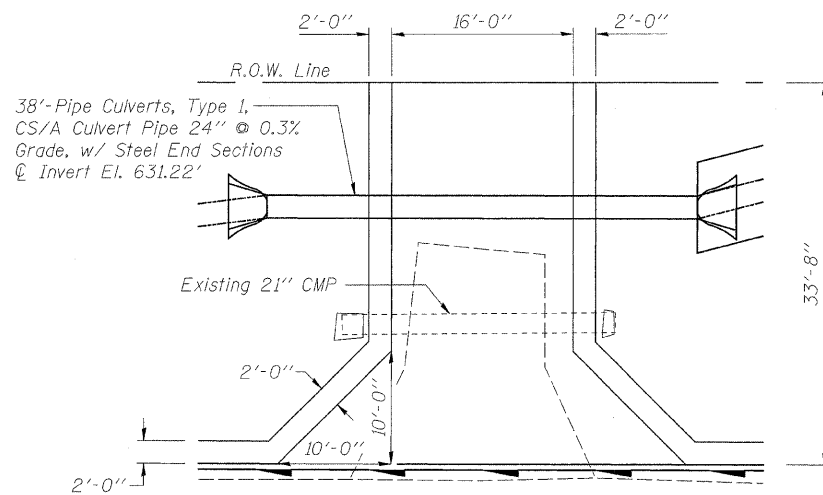

F.E.L. 19+26

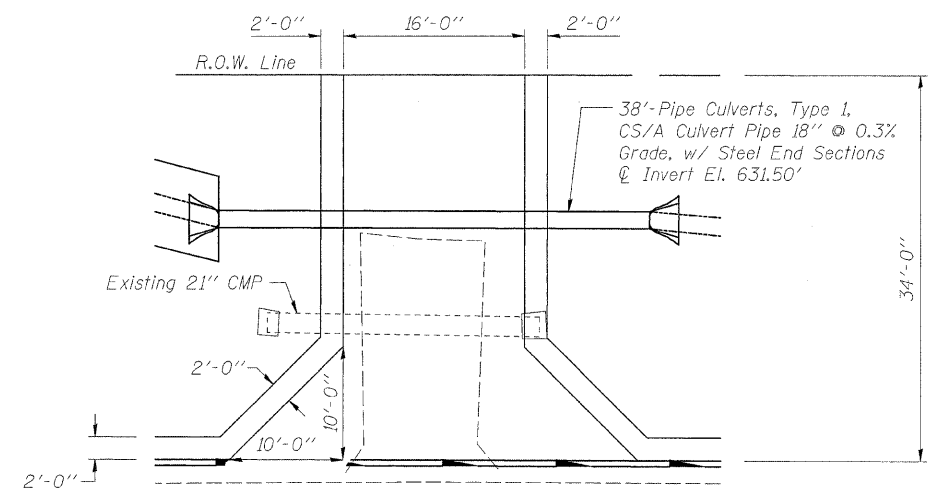

F.E.L. 21+00

FILE NAME: e:\Struct\11152008\Drawings\11152008.dgn

WILLET, HOFMANN & ASSOCIATES, INC.
CONSULTING ENGINEERS
809 East Second Street Dixon, IL 61021
Phone 815.294.3381 Fax 815.294.3385
Design Firm # 184-00918
www.willettthofmann.com

USER NAME =	DESIGNED - MAS	REVISED -
PLOT SCALE =	DRAWN - RDA	REVISED -
PLOT DATE =	CHECKED - BKC	REVISED -
	DATE - 06/09	REVISED -

**BUREAU COUNTY
MINERAL ROAD DISTRICT
TR 257 (N. 1600 AVE.) OVER KING CREEK**

TYPICAL SECTIONS

T.R. RTE.	SECTION	COUNTY	TOTAL SHEETS	SHEET NO.
257	07-17137-00-BR	BUREAU	27	4
			CONTRACT NO. 87381	
FED. ROAD DIST. NO. 7 ILLINOIS FED. AID PROJECT BROS-0011071				