

PLAN	DATE
SURVEYED	BY
PLOTTED	
NOTE BOOK	
NO.	
CADD FILE NAME	

PROFILE	DATE
REVIEWED	BY
PLOTTED	
NOTE BOOK	
NO.	
STRUCTURE NOTATION	

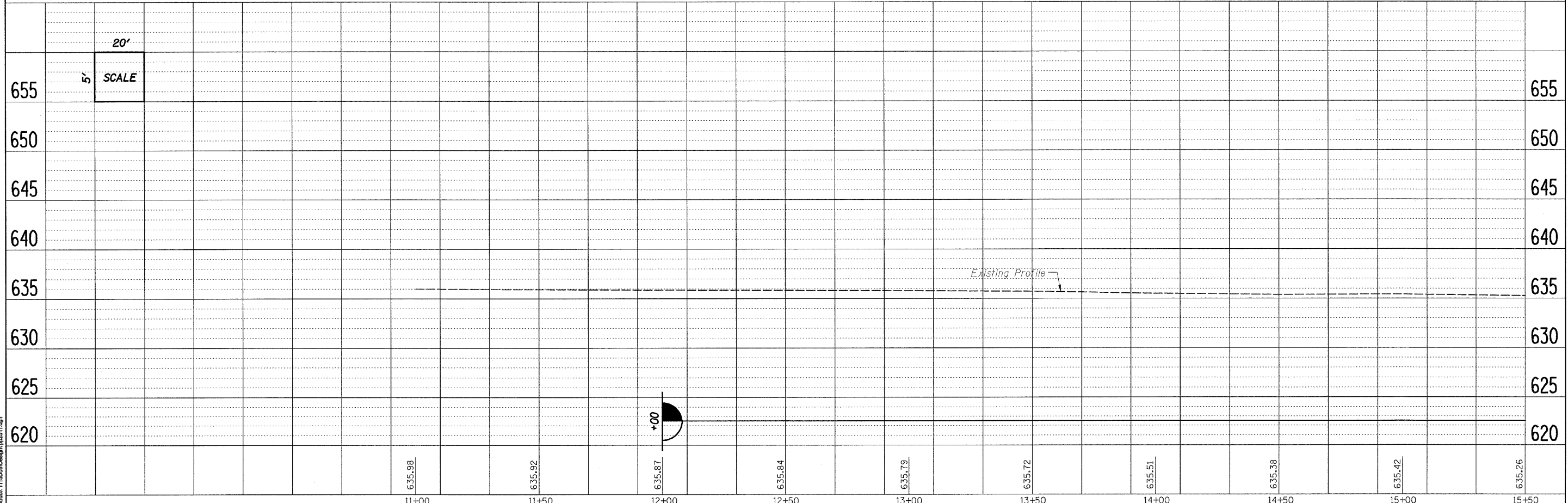
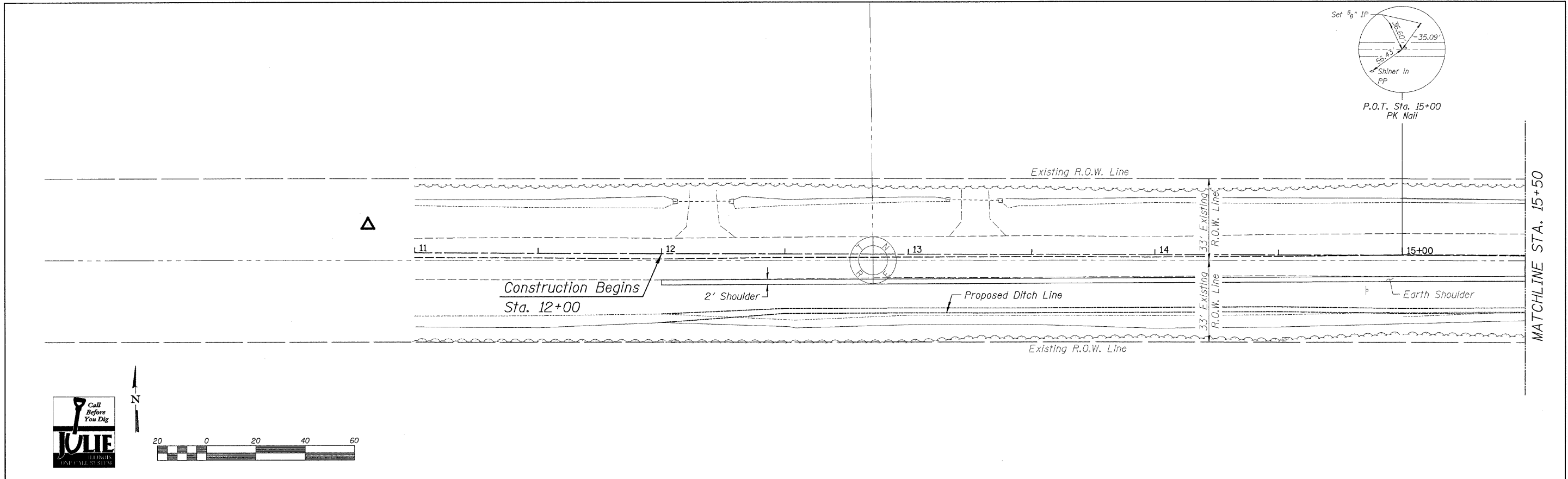

FILE NAME = s:\mch\119000\Design\p22511.dgn

WILLET, HOFMANN & ASSOCIATES, INC.
CONSULTING ENGINEERS
 809 East Second Street Dixon, IL 61021
 Phone 815.294.3381 Fax 815.294.3385
 Design Firm # 184-00818
 www.willett-hofmann.com

USER NAME =	DESIGNED - MAS	REVISED -
PLOT SCALE =	DRAWN - RDA	REVISED -
PLOT DATE =	CHECKED - BKC	REVISED -
	DATE - 06/09	REVISED -

BUREAU COUNTY
MINERAL ROAD DISTRICT
TR 257 (N 1600 AVE.) OVER KING CREEK

PLAN & PROFILE
 SCALE: SHEET NO. 1 OF SHEETS STA. 11+00 TO STA. 15+50

T.R. RTE.	SECTION	COUNTY	TOTAL SHEETS	SHEET NO.
257	07-17137-00-BR	BUREAU	27	5
CONTRACT NO. 87381			FED. ROAD DIST. NO. 7 (ILLINOIS) FED. AID PROJECT BR05-0011071	