

DATE	
BY	
REVISIONS	
NO.	
DATE	
BY	
REVISIONS	
NO.	
DATE	
BY	
REVISIONS	
NO.	

DATE	
BY	
REVISIONS	
NO.	
DATE	
BY	
REVISIONS	
NO.	
DATE	
BY	
REVISIONS	
NO.	

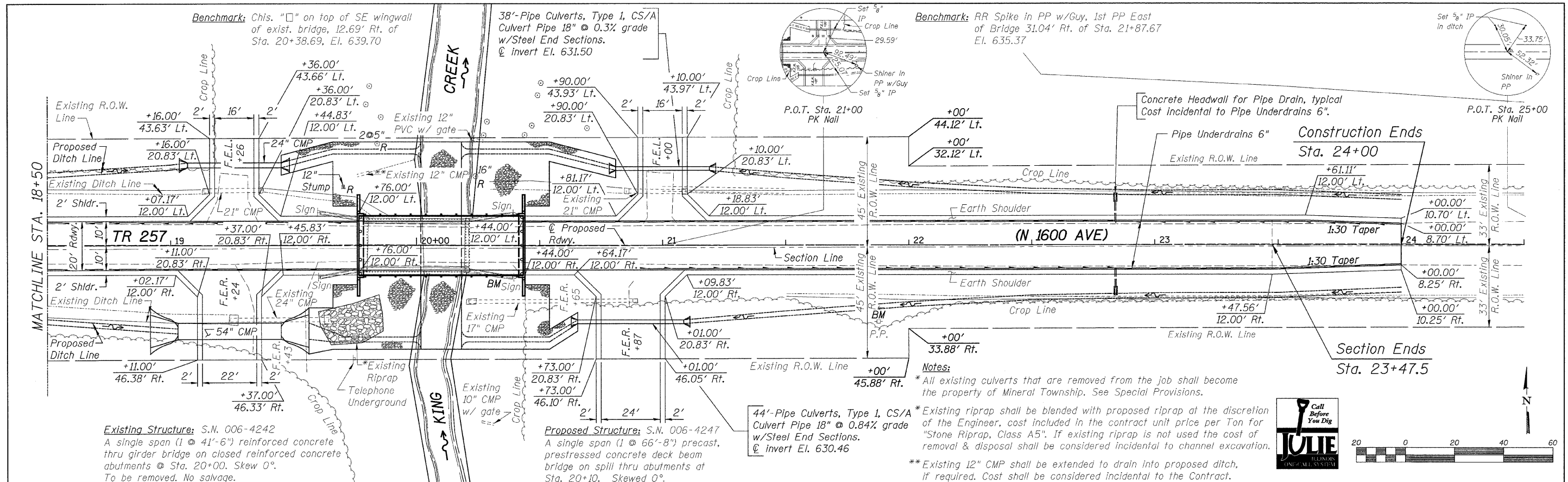

Existing Structure: S.N. 006-4242
A single span (1 @ 41'-6") reinforced concrete thru girder bridge on closed reinforced concrete abutments @ Sta. 20+00. Skew 0°. To be removed. No salvage.

Proposed Structure: S.N. 006-4247
A single span (1 @ 66'-8") precast, prestressed concrete deck beam bridge on spill thru abutments at Sta. 20+10. Skewed 0°.

Notes:
* All existing culverts that are removed from the job shall become the property of Mineral Township. See Special Provisions.
* Existing riprap shall be blended with proposed riprap at the discretion of the Engineer, cost included in the contract unit price per Ton for "Stone Riprap, Class A5". If existing riprap is not used the cost of removal & disposal shall be considered incidental to channel excavation.
** Existing 12" CMP shall be extended to drain into proposed ditch, if required. Cost shall be considered incidental to the Contract.

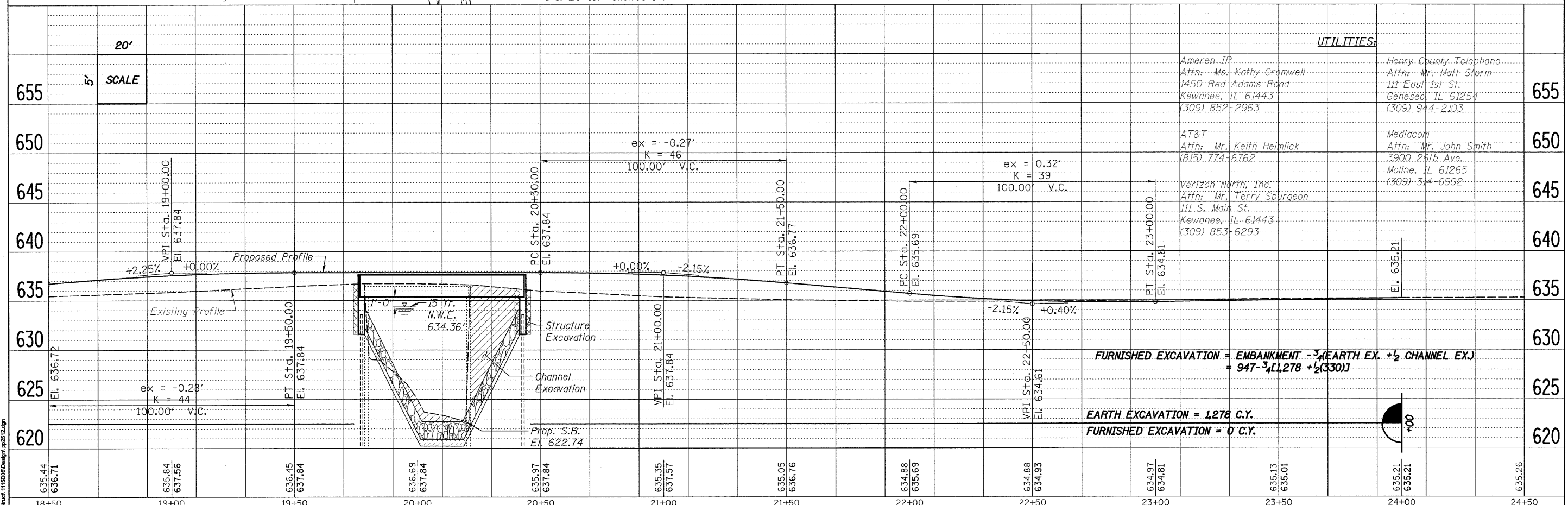
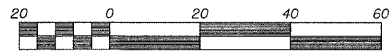

FURNISHED EXCAVATION = EMBANKMENT - 3/4 (EARTH EX. + 1/2 CHANNEL EX.) = 947 - 3/4 (1,278 + 1/2 (330))
EARTH EXCAVATION = 1,278 C.Y.
FURNISHED EXCAVATION = 0 C.Y.

	USER NAME =	DESIGNED - MAS	REVISED -	BUREAU COUNTY MINERAL ROAD DISTRICT TR 257 (N 1600 AVE.) OVER KING CREEK	PLAN & PROFILE	T.R. RTE.	SECTION	COUNTY	TOTAL SHEETS	SHEET NO.
	PLOT SCALE =	CHECKED - BKC	REVISED -			257	07-17137-00-BR	BUREAU	27	7
	PLOT DATE =	DATE - 06/09	REVISED -	SCALE:	SHEET NO. 3 OF SHEETS	STA. 18+50 TO STA. 24+50	FED. ROAD DIST. NO. 7 ILLINOIS FED. AID PROJECT BR05-001107D			