

PLAN	SURVEYED	BY	DATE
	PLOTTED		
	CHECKED		
	BY		
	DATE		
	NO. OF MAY CHECKED		
	CADD FILE NAME		
	NO.		

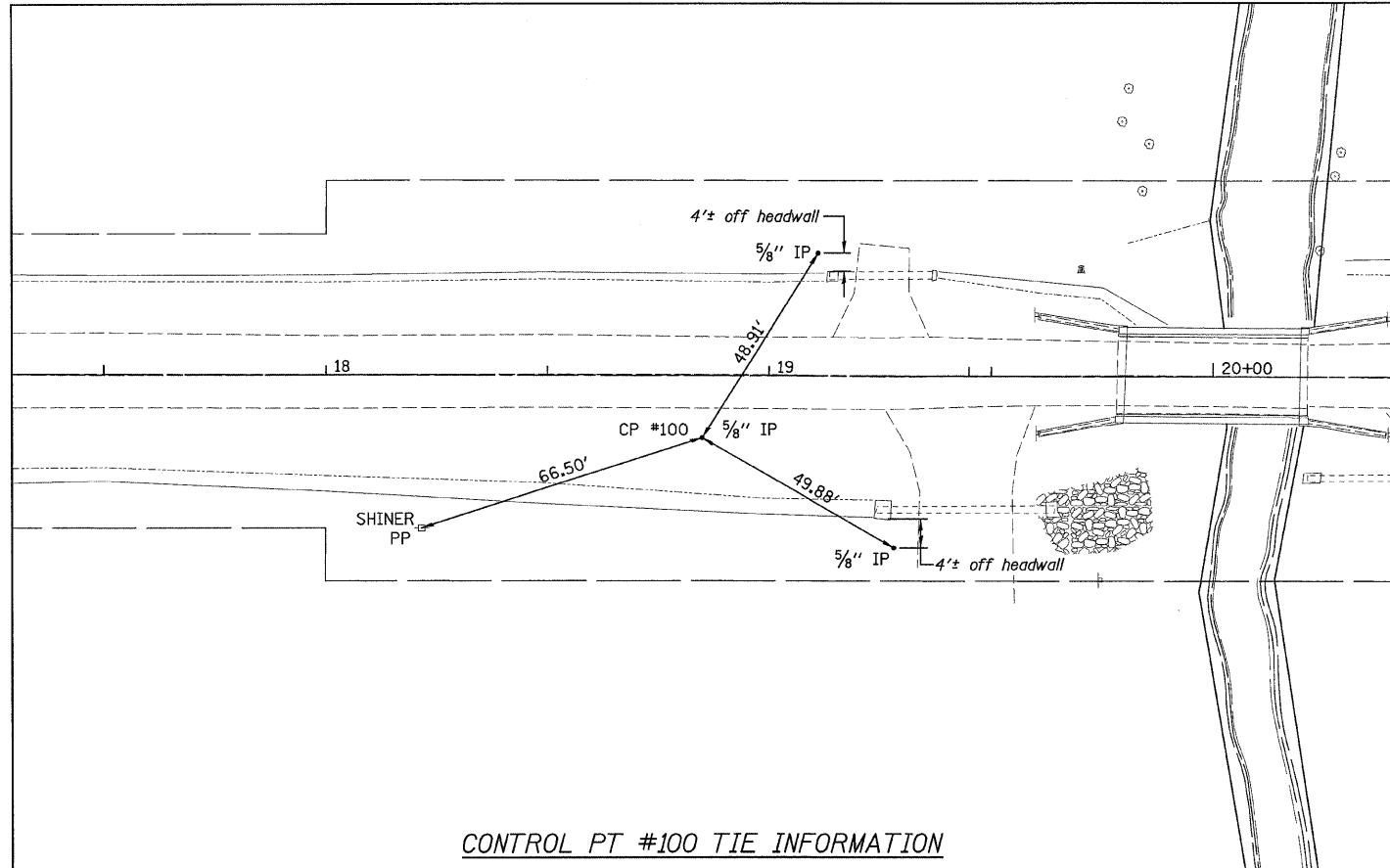

CONTROL PT #100 TIE INFORMATION

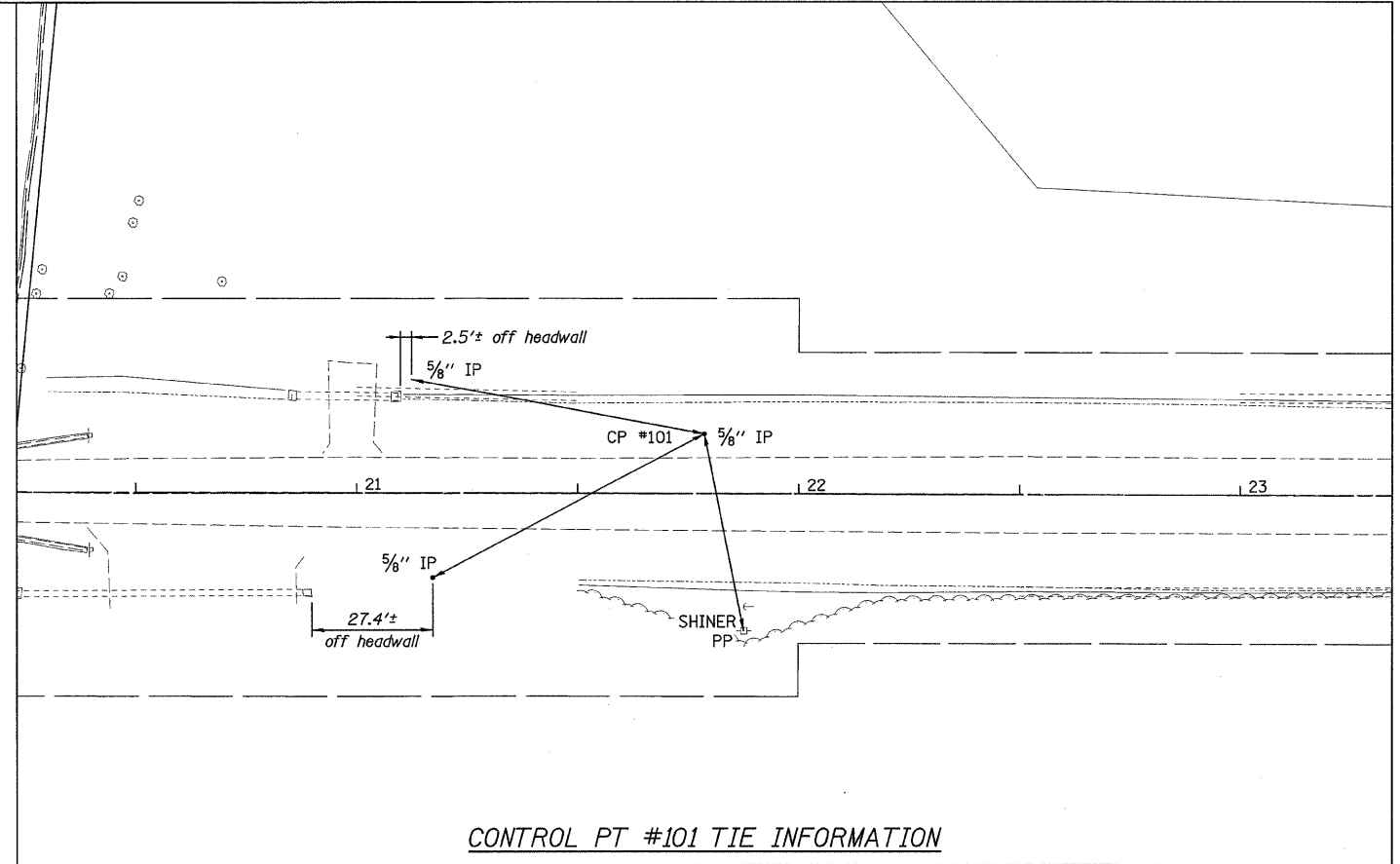

CONTROL PT #101 TIE INFORMATION

PROFILE	SURVEYED	BY	DATE
	PLOTTED		
	CHECKED		
	BY		
	DATE		
	NO. OF MAY CHECKED		
	STRUCTURE NOTATION CHNO		
	NO.		

T.R. 257 - HORIZONTAL CONTROL POINTS					
PT #	STA.	N	E	EL.	DESCRIPTION
100	14.0' RT 18+84.8	1716497.67	2384577.72	634.98	IP
101	13.6' LT 21+78.7	1716524.23	2384871.63	634.67	IP

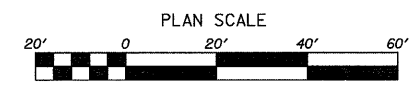

**WILLET, HOFMANN & ASSOCIATES, INC.**  
**CONSULTING ENGINEERS**  
 809 East Second Street Dixon, IL 61021  
 Phone 815.294.3381 Fax 815.294.3385  
 Design Firm # 184-00818  
 www.willett-hofmann.com

USER NAME =	DESIGNED - MAS	REVISED -
	DRAWN - RDA	REVISED -
PLOT SCALE =	CHECKED - BKC	REVISED -
PLOT DATE =	DATE - 06/09	REVISED -

**BUREAU COUNTY**  
**MINERAL ROAD DISTRICT**  
**TR 257 (N 1600 AVE.) OVER KING CREEK**

**ALIGNMENT & CONTROL POINT DETAILS**  
 SCALE: SHEET NO. 1 OF SHEETS STA. 15+00 TO STA. 21+00

T.R. RTE.	SECTION	COUNTY	TOTAL SHEETS	SHEET NO.
257	07-17137-00-BR	BUREAU	27	8
CONTRACT NO. 87381			FED. ROAD DIST. NO. 7 ILLINOIS FED. AID PROJECT BROS-00116711	

FILE NAME = s:\s\257\11150000\Design\pp2811.dgn