

DATE	
BY	
FINISHED SURVEY	
NOTED SURVEY	
NOTE BOOK	
AREAS CHECKED	
NO.	

DATE	
BY	
ORIGINAL SURVEY	
NOTED SURVEY	
NOTE BOOK	
AREAS CHECKED	
NO.	

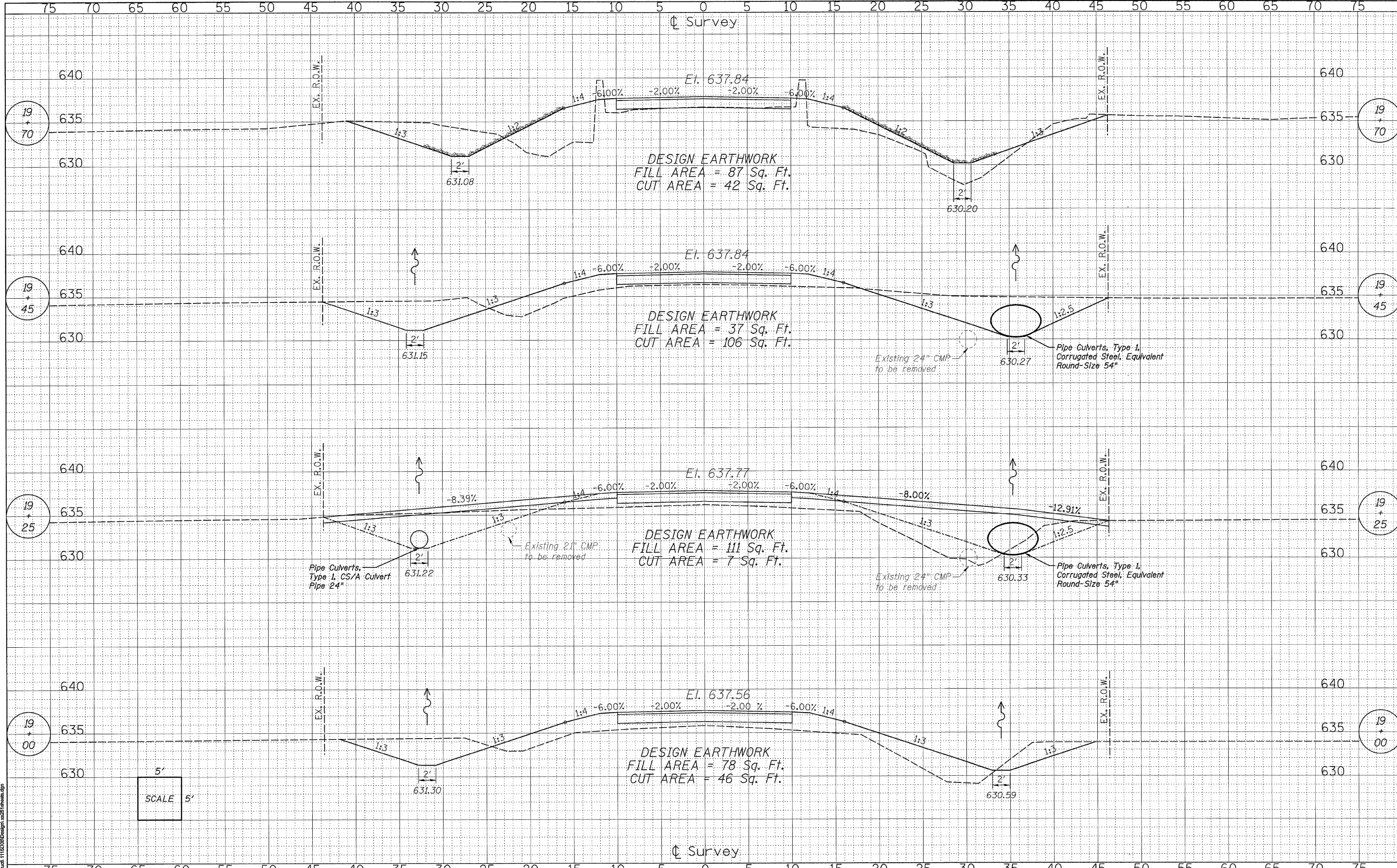

FILE NAME = s:\bent\11100000\Design\251shws.dgn

**WILLETT, HOFMANN & ASSOCIATES, INC.**  
 CONSULTING ENGINEERS  
 800 East Second Street, Dixon, IL 61021  
 Phone 815.284.3381 Fax 815.284.3385  
 Design Firm # 184-00918  
 www.willetthofmann.com

USER NAME =	DESIGNED - MAS	REVISED -
PLOT SCALE =	DRAWN - RDA	REVISED -
PLOT DATE =	CHECKED - BKC	REVISED -
	DATE - 06/09	REVISED -

**BUREAU COUNTY**  
**MINERAL ROAD DISTRICT**  
**TR 257 (N. 1600 AVE.) OVER KING CREEK**

**CROSS SECTIONS**

T.R. RTE.	SECTION	COUNTY	TOTAL SHEETS	SHEET NO.
257	07-17137-00-BR	BUREAU	27	24
STA. 19+00.00 TO STA. 19+70.00			CONTRACT NO. 87381	
FED. ROAD DIST. NO. 7 (ILLINOIS) FED. AID PROJECT BROS-001107J				