

DATE	
BY	
NO.	
FINAL SURVEY	
NO. OF SHEETS	
NO. OF PAGES	
NO. OF PLATES	
NO. OF AREAS CHECKED	

DATE	
BY	
NO.	
ORIGINAL SURVEY	
NO. OF SHEETS	
NO. OF PAGES	
NO. OF PLATES	
NO. OF AREAS CHECKED	

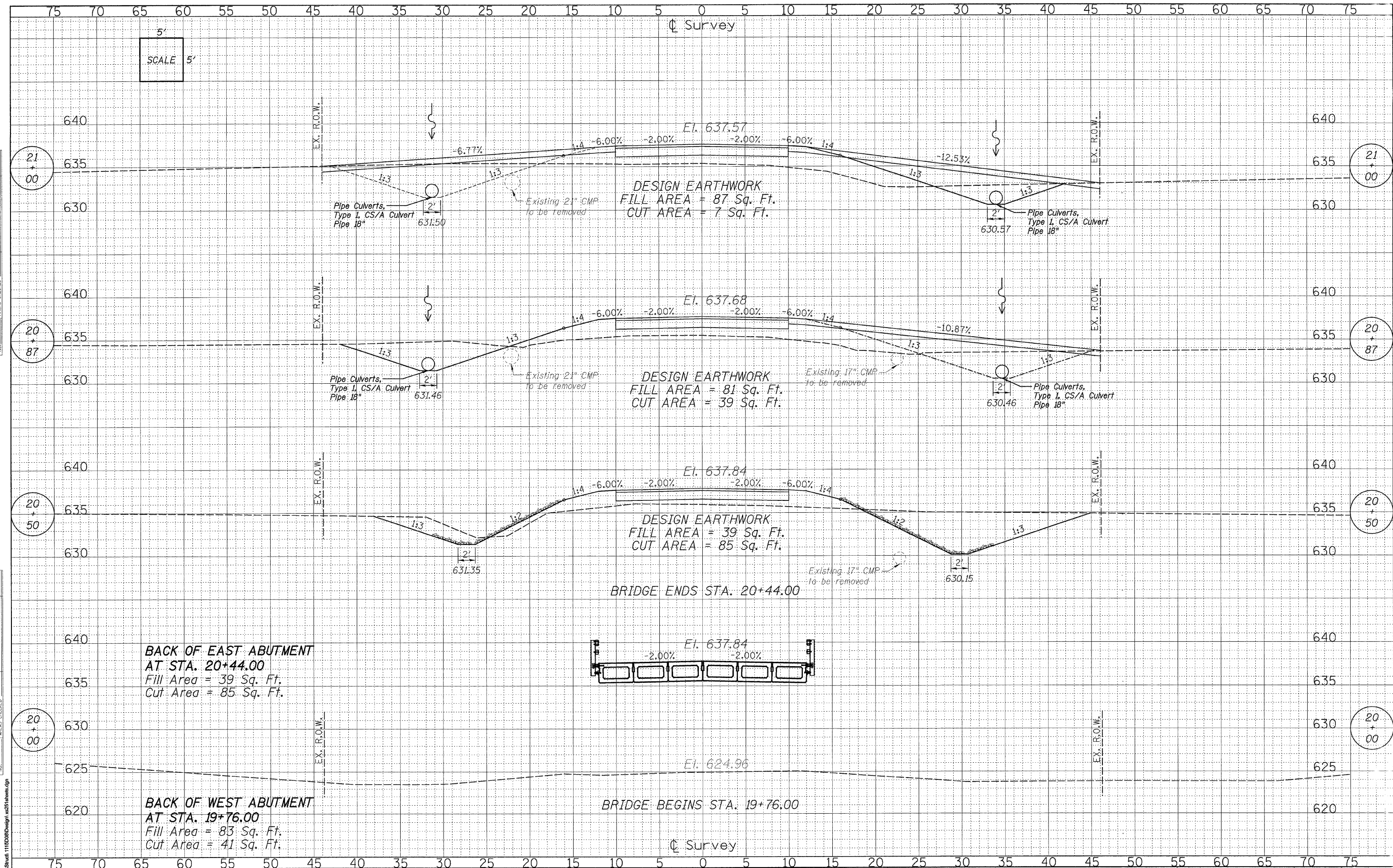

FILE NAME = a:\shw\111000\Design\2051shw.dgn

WILLETT, HOFMANN & ASSOCIATES, INC.
 CONSULTING ENGINEERS
 800 East Second Street, Dixon, IL 61021
 Phone 815.284.3381 Fax 815.284.3385
 Design Firm # 184-00918
 www.willett-hofmann.com

USER NAME =	DESIGNED - MAS	REVISED -
PLOT SCALE =	DRAWN - RDA	REVISED -
PLOT DATE =	CHECKED - BKC	REVISED -
	DATE - 06/09	REVISED -

BUREAU COUNTY
MINERAL ROAD DISTRICT
TR 257 (N. 1600 AVE.) OVER KING CREEK

CROSS SECTIONS

T.R. RTE.	SECTION	COUNTY	TOTAL SHEETS	SHEET NO.
257	07-17137-00-BR	BUREAU	27	25
STA. 20+00.00 TO STA. 21+00.00		CONTRACT NO. 87381		
FED. ROAD DIST. NO. 7 ILLINOIS FED. AID PROJECT BRCS-00110711				