

FAU 6784  
 ENGINEERING DIVISION  
 CITY OF GALESBURG, ILLINOIS  
 PLANS FOR PROPOSED

CONTRACT #	ROUTE #	SECTION #	TOTAL SHEETS	SHEET NO.
89502	FAU 6784	08-02201-22-SW	3	1

KNOX COUNTY

CALL J.U.L.I.E.  
 BEFORE DIGGING  
 800-892-0123

# SAFE ROUTES TO SCHOOL SIDEWALK PROJECT

PROJECT LIMITS: DAYTON STREET, FROM SILVER STREAK BLVD. TO DAYTON DR.

FEDERAL PROJECT # SRTS-5025(042)

JOB #: C-40-031-08

SECTION 08-02201-22-SW

TOWNSHIP 11 N, RANGE 1 E, SE 1/4 SECTION 4

## SUMMARY OF QUANTITIES

20200100	EARTH EXCAVATION	30.0	CU YD
35101400	AGGREGATE BASE COURSE, TYPE B	19.0	TDN
42400100	PORTLAND CEMENT CONCRETE SIDEWALK 4"	1293.0	SQ FT
42400300	PORTLAND CEMENT CONCRETE SIDEWALK 6"	100.0	SQ FT
42400410	PORTLAND CEMENT CONCRETE SIDEWALK 8"	81.0	SQ FT
42400800	DETECTABLE WARNINGS	24.0	SQ FT
44000500	COMBINATION CONCRETE CURB & GUTTER REMOVAL	19.0	FT
60603900	COMBINATION CONCRETE CURB & GUTTER, TYPE B-6.12 (ADJOINING EXISTING PAVEMENT)	19.0	FT
67100100	MOBILIZATION	1.0	LS
70101700	TRAFFIC CONTROL & PROTECTION	1.0	LS

## INDEX OF SHEETS

SHEET NO. 1	TITLE SHEET
SHEET NO. 2	TYPICALS & SCHEDULE OF QUANTITIES
SHEET NO. 3-4	PLAN SHEETS

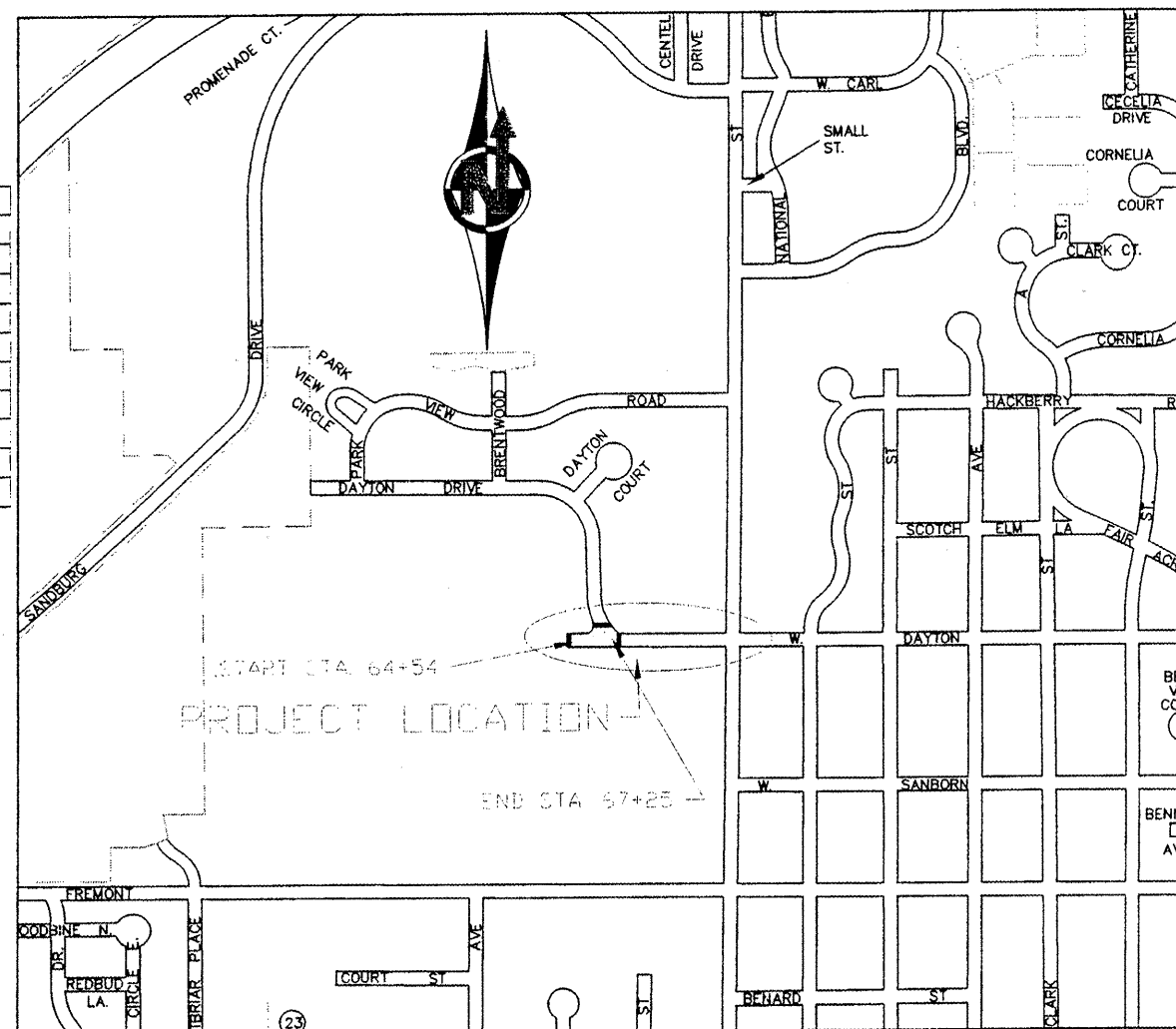

GENERAL LOCATION MAP  
 NOT TO SCALE

TOTAL GROSS LENGTH OF PROJECT = 271.0 FEET = 0.051 MILES  
 TOTAL NET LENGTH OF PROJECT = 271.0 FEET = 0.051 MILES

### PROJECT DESCRIPTION:

THIS PROJECT CONSISTS OF PLACEMENT OF NEW SIDEWALK, CURB REMOVAL AND REPLACEMENT FOR ADA COMPLIANCY AND OTHER RELATED WORK.

## HIGHWAY STANDARDS

STD. NO.	DESCRIPTION
000001-05	STANDARD SYMBOLS ABBREVIATIONS & PATTERNS
424001-05	CURB RAMPS FOR SIDEWALK
606001-04	CONCRETE CURB TYPE B & COMBINATION CONCRETE C&G
701501-05	URBAN LANE CLOSURE, 2L, 2W, UNDIVIDED
701801-04	LANE CLOSURE MULTILANE 1W2W WITH CROSSWALK OR SIDEWALK CLOSURE
701901-01	TRAFFIC CONTROL DEVICES

ENGINEERING DIVISION  
 CITY OF GALESBURG ILLINOIS

APPROVED *[Signature]* 2009  
 LOCAL AGENCY REPRESENTATIVE

PASSED *[Signature]* 2009  
 DISTRICT 4 ENGINEER OF LOCAL ROADS & STREETS

RELEASING FOR BID  
 BASED ON LIMITED REVIEW *[Signature]* 2/10/09 2009  
 DEPUTY DIRECTOR OF HIGHWAYS, REGION 4 ENGINEER  
 STATE OF ILLINOIS  
 DEPARTMENT OF TRANSPORTATION

TITLE SHEET  
 SAFE ROUTES TO SCHOOL SW PROJ.  
 SECTION # 08-02201-22-SW  
 FAU ROUTE 6784  
 JOB # C-40-031-08  
 CONTRACT # 89502

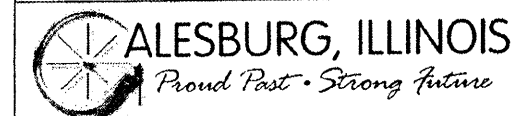

CONTRACT #	SECTION #	TOTAL SHEETS	SHEET NO.
89502	08-02201-22-SW	3	2

Knox County

# TYPICALS

# SCHEDULE OF QUANTITIES

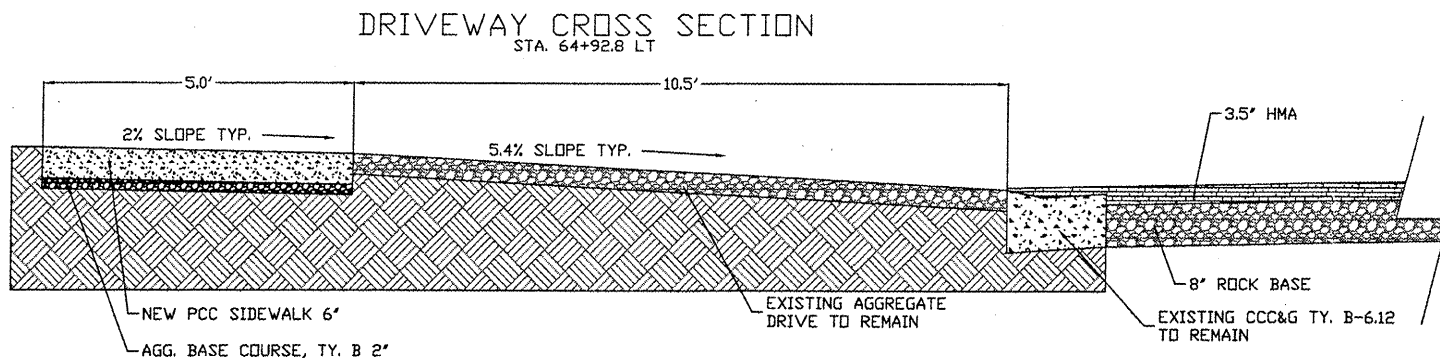
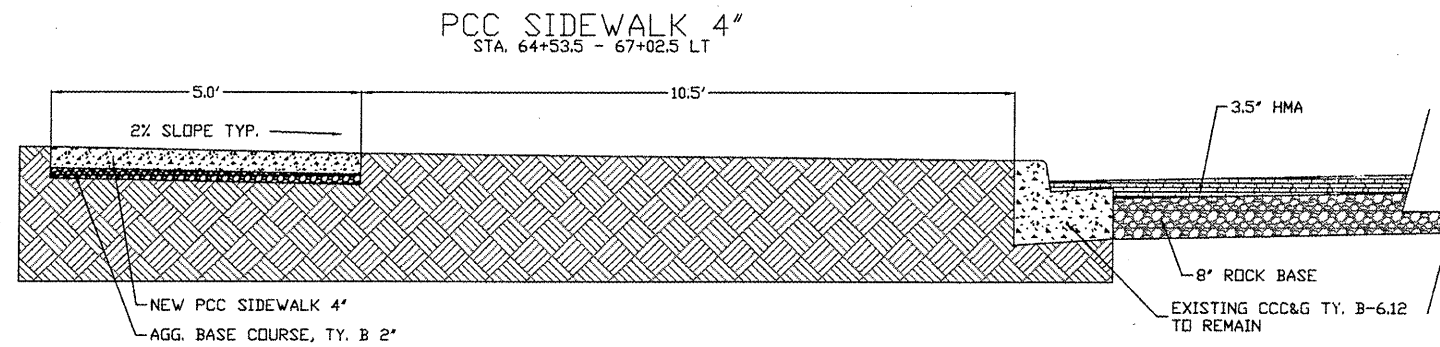

### 20200100 EARTH EX.

64+53.5 LT	2.6 CU YD
64+82.8 LT	2.4 CU YD
65+02.8 LT	19.4 CU YD
67+11.6 RT	0.6 CU YD
67+12.1 LT	1.3 CU YD
67+12.1 RT	1.3 CU YD
67+12.5 LT	1.2 CU YD
67+18.9 LT	1.1 CU YD
<b>TOTAL</b>	<b>30.0 CU YD</b>

### 42400800 DET. WARNINGS

67+12.1 RT	8.0 SQ FT
67+12.5 LT	8.0 SQ FT
67+18.9 LT	8.0 SQ FT
<b>TOTAL</b>	<b>24.0 SQ FT</b>

### 35101400 AGG. BASE CRSE., TY. B

64+53.5 LT	1.8 TON
64+82.8 LT	1.3 TON
65+02.8 LT	13.3 TON
67+11.6 RT	0.4 TON
67+12.1 LT	0.9 TON
67+12.1 RT	0.3 TON
67+12.5 LT	0.4 TON
67+18.9 LT	0.3 TON
<b>TOTAL</b>	<b>19.0 TON</b>

### 44000500 CCC&G REM.

67+11.6 RT	6.0 FT
67+12.1 LT	7.2 FT
67+24.6 LT	6.2 FT
<b>TOTAL</b>	<b>19.0 FT</b>

### 60603900 CCC&G, TY. B-6.12 (AEP)

67+11.6 RT	6.0 FT
67+12.1 LT	7.2 FT
67+24.6 LT	6.2 FT
<b>TOTAL</b>	<b>19.0 FT</b>

### 42400100 PCC SIDEWALK 4"

64+53.5 LT	140.5 SQ FT
65+02.8 LT	1049.5 SQ FT
67+11.6 RT	30.5 SQ FT
67+12.1 LT	72.5 SQ FT
<b>TOTAL</b>	<b>1293.0 SQ FT</b>

### 67100100 MOBILIZATION

ENTIRE JOBSITE	1.0 LS
<b>TOTAL</b>	<b>1.0 LS</b>

### 42400300 PCC SIDEWALK 6"

64+82.8 LT	100.0 SQ FT
<b>TOTAL</b>	<b>100.0 SQ FT</b>

### 70101700 TRAF. CONT. & PROT.

ENTIRE JOBSITE	1.0 LS
<b>TOTAL</b>	<b>1.0 LS</b>

### 42400410 PCC SIDEWALK 8"

67+12.1 RT	25.0 SQ FT
67+12.5 LT	30.5 SQ FT
67+18.9 LT	25.0 SQ FT
<b>TOTAL</b>	<b>81.0 SQ FT</b>

### TYPICALS/ SCHEDULE

SAFE ROUTES TO SCHOOL SW PROJ.  
SECTION # 08-02201-22-SW



EXISTING GROUND PROFILE ON N. ROW LINE  
 PROPOSED SIDEWALK TO MATCH EXISTING GROUND PROFILE

CONTRACT #	SECTION #	TOTAL SHEETS	SHEET NO.
89502	08-02201-22-SW	3	3

KNOX COUNTY

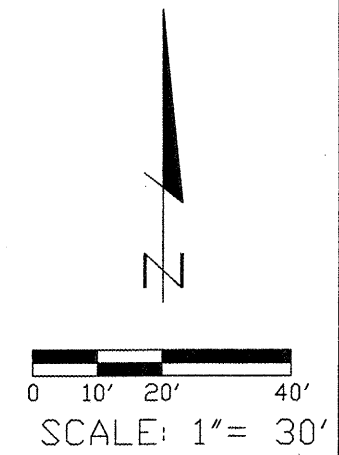
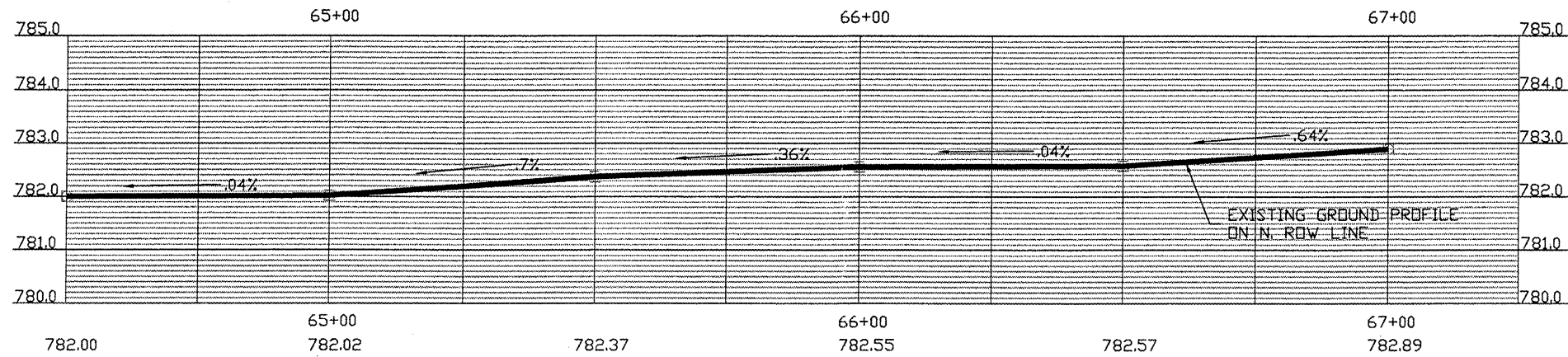

- PCC SIDEWALK 4'
- PCC SIDEWALK 6'
- PCC SIDEWALK 8'
- DETECTABLE WARNINGS
- CCC&G TY.B6-12 (AEP) REMOVAL & REPLACEMENT

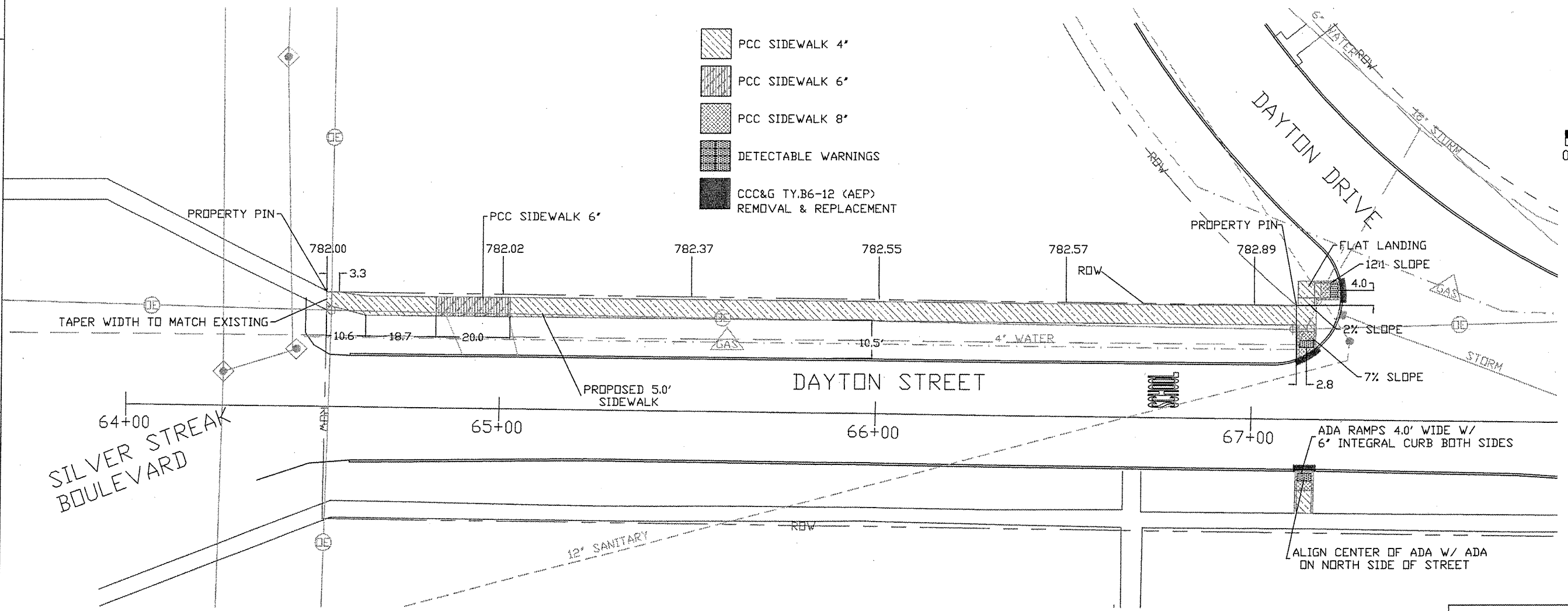

PLANS  
 SAFE ROUTES TO SCHOOL SW PROJ.  
 SECTION # 08-02201-22-SW

