

F.A.P. RTE.	SECTION	COUNTY	TOTAL SHEETS	SHEET NO.
	06-00216-00-SW	ST. CLAIR	31	7
STA. 10+00.00		TO STA. 15+00.00		
FED. ROAD DIST. NO. 1		ILLINOIS		
EAST ST. LOUIS		FED. AID PROJECT		
PLAN AND PROFILE				

PLAN	DATE	BY
SUBMITTED		
APPROVED		
REVISIONS		
NO. 1		
NO. 2		
NO. 3		
NO. 4		
NO. 5		
NO. 6		
NO. 7		
NO. 8		
NO. 9		
NO. 10		

PROFILE	DATE	BY
SUBMITTED		
APPROVED		
REVISIONS		
NO. 1		
NO. 2		
NO. 3		
NO. 4		
NO. 5		
NO. 6		
NO. 7		
NO. 8		
NO. 9		
NO. 10		

PLOT DATE = \$DATE\$
 FILE NAME = \$FILE\$
 PLOT SCALE = \$SCALE\$
 USER NAME = \$USER\$

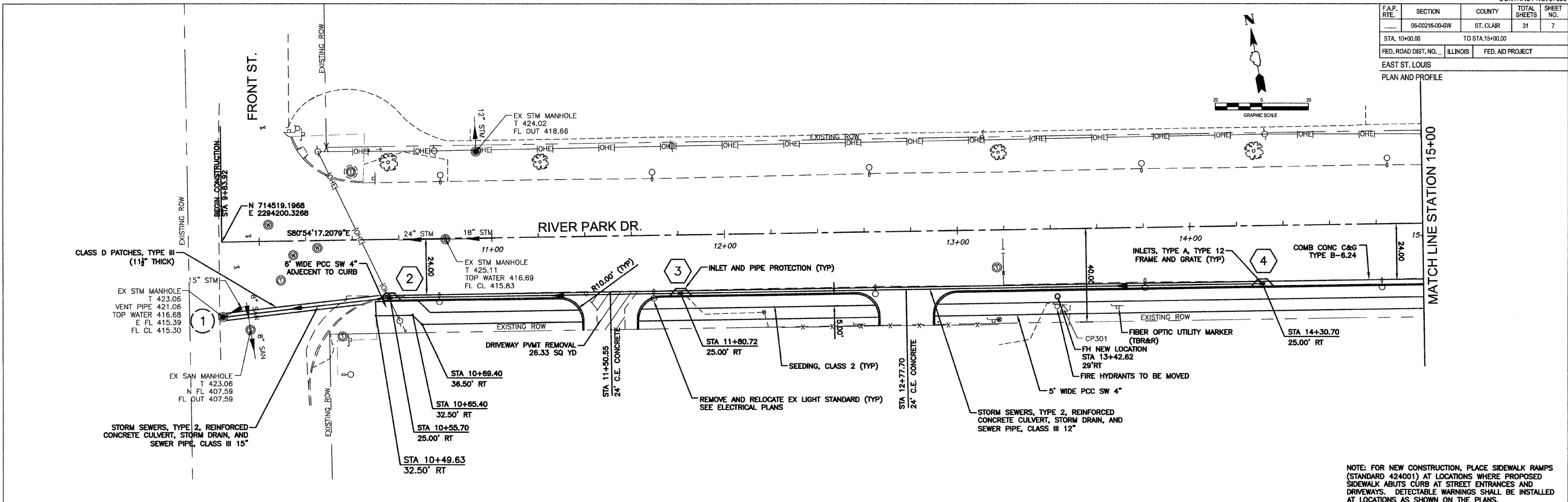

NOTE: FOR NEW CONSTRUCTION, PLACE SIDEWALK RAMPS (STANDARD 424001) AT LOCATIONS WHERE PROPOSED SIDEWALK ABUTS CURB AT STREET ENTRANCES AND DRIVEWAYS. DETECTABLE WARNINGS SHALL BE INSTALLED AT LOCATIONS AS SHOWN ON THE PLANS.

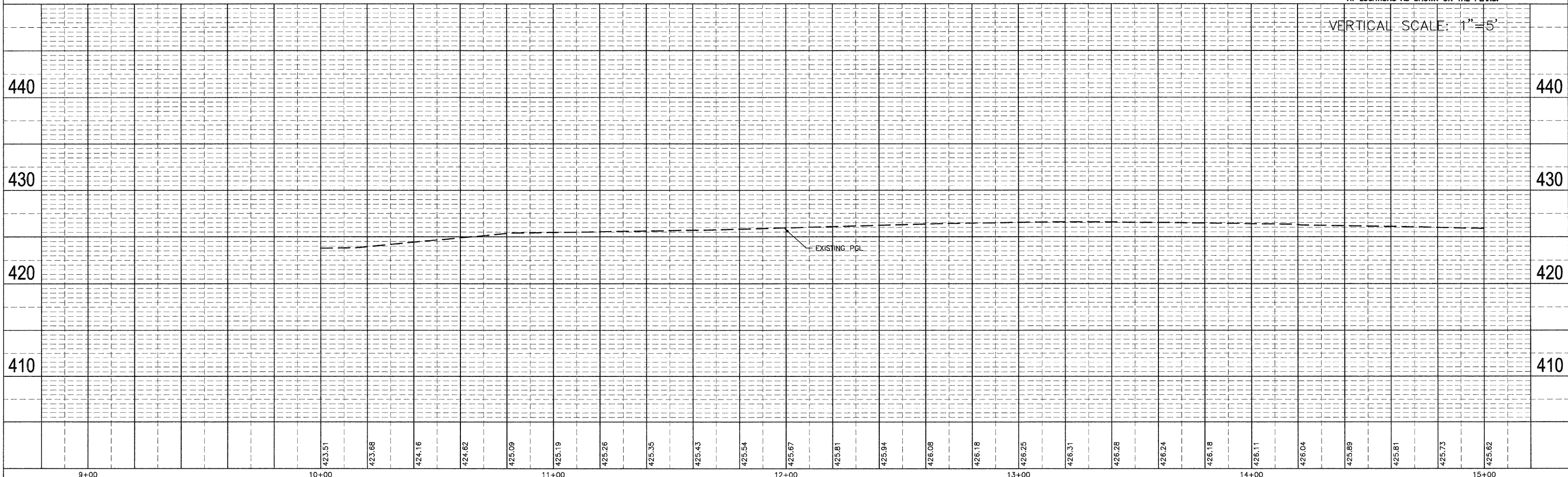

Plan and Profile