

F.A.P. RTE.	SECTION	COUNTY	TOTAL SHEETS	SHEET NO.
06-00216-00-SW	ST. CLAIR	ILLINOIS	31	30
FED. ROAD DIST. NO.		FED. AID PROJECT		

EAST ST. LOUIS

CROSS SECTIONS

DATE	
BY	
DESIGNED	
PLOTTED	
CHECKED	
NOTED	
STRUCTURE	
NOTATION	
NO.	

DATE	
BY	
DESIGNED	
PLOTTED	
CHECKED	
NOTED	
STRUCTURE	
NOTATION	
NO.	

PLOT DATE = \$DATE\$
 PLOT SCALE = \$SCALE\$
 USER NAME = \$USER\$

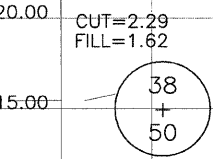
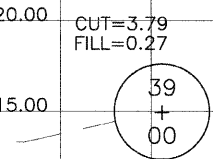
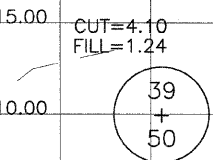
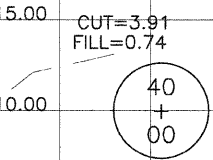
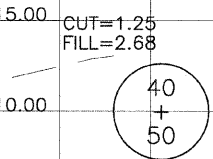
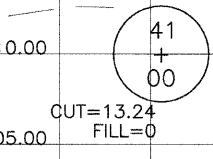
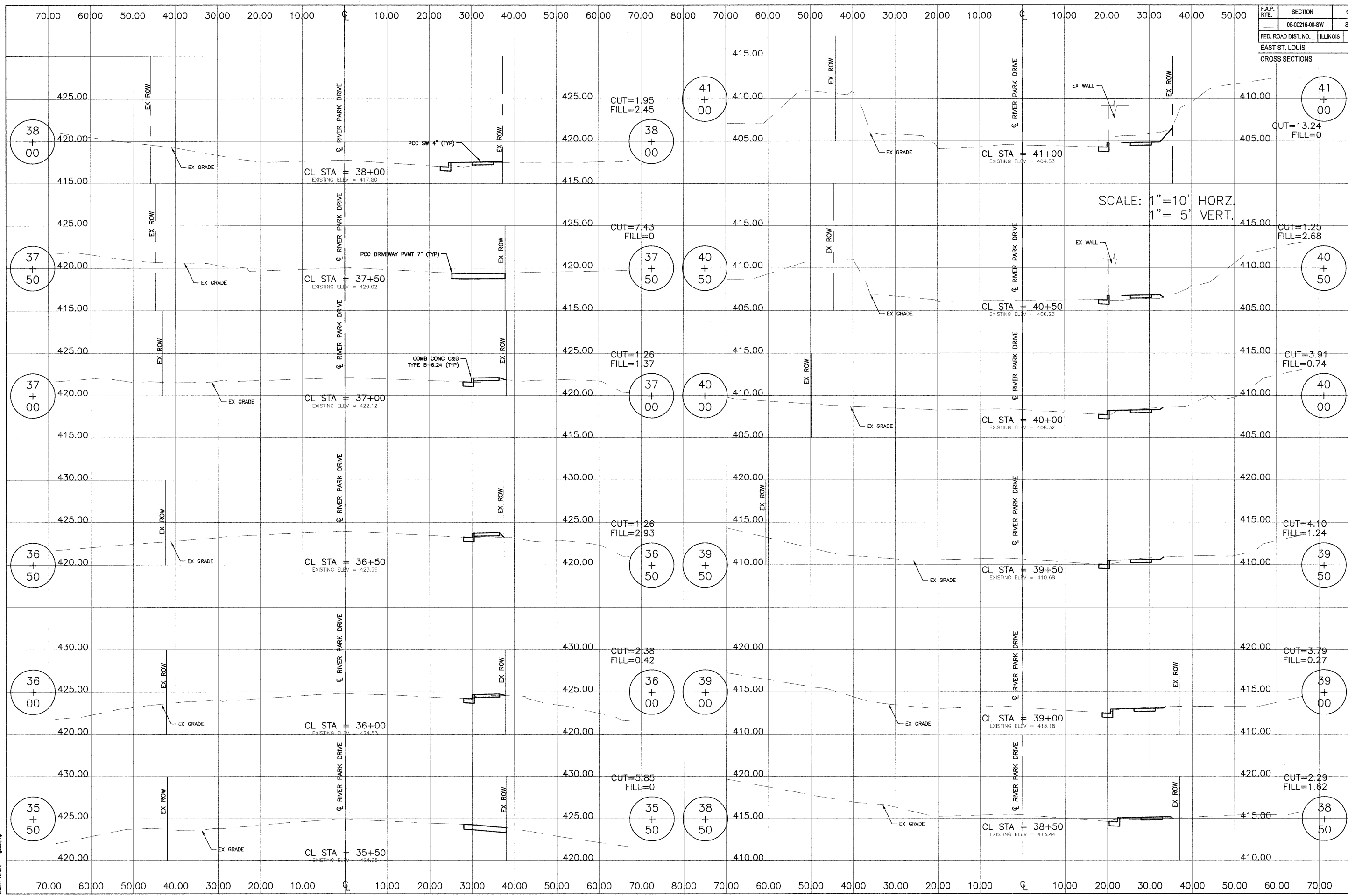

CL STA = 38+00
EXISTING ELEV = 417.80

CL STA = 37+50
EXISTING ELEV = 420.02

CL STA = 37+00
EXISTING ELEV = 422.12

CL STA = 36+50
EXISTING ELEV = 423.99

CL STA = 36+00
EXISTING ELEV = 424.83

CL STA = 35+50
EXISTING ELEV = 424.96

CL STA = 41+00
EXISTING ELEV = 404.53

CL STA = 40+50
EXISTING ELEV = 406.23

CL STA = 40+00
EXISTING ELEV = 408.32

CL STA = 39+50
EXISTING ELEV = 410.68

CL STA = 39+00
EXISTING ELEV = 413.16

CL STA = 38+50
EXISTING ELEV = 415.44

PCC SW 4" (TYP)

PCC DRIVEWAY PAVT 7" (TYP)

COMB CONC C&G
TYPE B-6.24" (TYP)

SCALE: 1" = 10' HORZ.
1" = 5' VERT.