

HORIZONTAL CONTROL TABLE				
POINT	NORTHING	EASTING	DESCRIPTION	STATION/OFFSET
3	1983296.6194	618668.0646	RUNWAY 12/30 AND TAXIWAY ALPHA	STA. 386+63.27 @ RUNWAY 12/30 AND STA. 35+25.55 @ TAXIWAY A
4	1983421.8225	618945.9924	TAXIWAY ECHO AND TAXIWAY ALPHA	STA. 184+75.26 @ TAXIWAY E AND STA. 38+30.38 @ TAXIWAY A
5	1984674.9034	618972.6174	BASELINE A AND RUNWAY 6/24	STA. 619+98.38 @ BASELINE A AND STA. 219+56.10 @ RUNWAY 6/24
6	1983112.5319	619712.1413	SOUTHEAST CORNER OF APRON	STA. 602+69.83 @ BASELINE A
7	1983998.3965	619292.8313	NORTHEAST CORNER OF APRON	STA. 612+49.92 @ BASELINE A
8	1983780.9848	617744.9280	RUNWAY 12/30 AND TAXIWAY BRAVO	STA. 397+05.76 @ RUNWAY 12/30 AND STA. 1201+70.23 @ TAXIWAY B
9	1983914.4149	618007.1762	TAXIWAY ECHO AND TAXIWAY BRAVO	STA. 195+35.46 @ TAXIWAY E AND STA. 1204+64.47 @ TAXIWAY B
10	1984051.1259	617746.6232	TAXIWAY ECHO AND RUNWAY 6/24	STA. 198+29.70 @ TAXIWAY E AND STA. 205+80.54 @ RUNWAY 6/24
11	1983495.0406	619243.4317	35' RADIUS TO EDGE OF PAVEMENT	STA. 508+16.09, 60' LT. BASELINE F
12	1983593.7527	619196.1738	35' RADIUS TO EDGE OF PAVEMENT	STA. 509+25.53, 60' LT. BASELINE F
BM#861	1983705.8500	618661.5760	IRON PIN	STA. 188+59.08, 119.36' RT. @ TAXIWAY ECHO
BM#79	1982713.3210	619935.4790	CHISELED "X"	STA. 372+69.94, 71.40' RT. @ RUNWAY 12/30
14	1982783.0756	619646.8111	BASELINE F AND RUNWAY 12/30	STA. 500+00.00 @ BASELINE F AND STA. 375+57.97 @ RUNWAY 12/30
16	1984584.1719	618794.2905	BASELINE F AND RUNWAY 6/24	STA. 519+92.67 @ BASELINE F AND STA. 217+56.02 @ RUNWAY 6/24
17	1983965.8456	619142.2535	35' RADIUS TO EDGE OF PAVEMENT	STA. 512+84.92, 50' RT. @ TAXIWAY FOXTROT
18	1983922.2059	619037.1056	50' RADIUS TO EDGE OF PAVEMENT	STA. 512+90.46, 63.74' LT. @ TAXIWAY FOXTROT

VERTICAL CONTROL TABLE			
BM #	ELEVATION	LOCATION	DESCRIPTION
22	639.09	STA. 506+41.62, 182.84' LT. @ TAXIWAY FOXTROT	NOAA BRASS DISC
79	639.87	STA. 372+69.94, 71.40' RT. @ RUNWAY 12/30	CHISELED "X"
861	639.98	STA. 188+59.08, 119.36' RT. @ TAXIWAY ECHO	IRON PIN

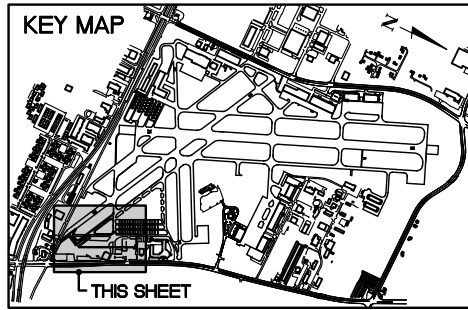

- LEGEND**
- NEW BITUMINOUS PAVEMENT
  - BITUMINOUS PAVEMENT TO BE REMOVED
  - NEW 10" P.C.C. PAVEMENT
  - P.C.C. PAVEMENT TO BE REMOVED
  - NEW WATERMAIN
  - NEW STORM SEWER
  - NEW TRENCH DRAIN
  - NEW STORM/SANITARY MANHOLE
  - NEW SANITARY SEWER
  - RELOCATED FIRE HYDRANT
  - EXISTING BENCHMARK
  - EXISTING BUILDING
  - EXISTING AIRFIELD FENCE
  - AIRPORT PROPERTY LINE

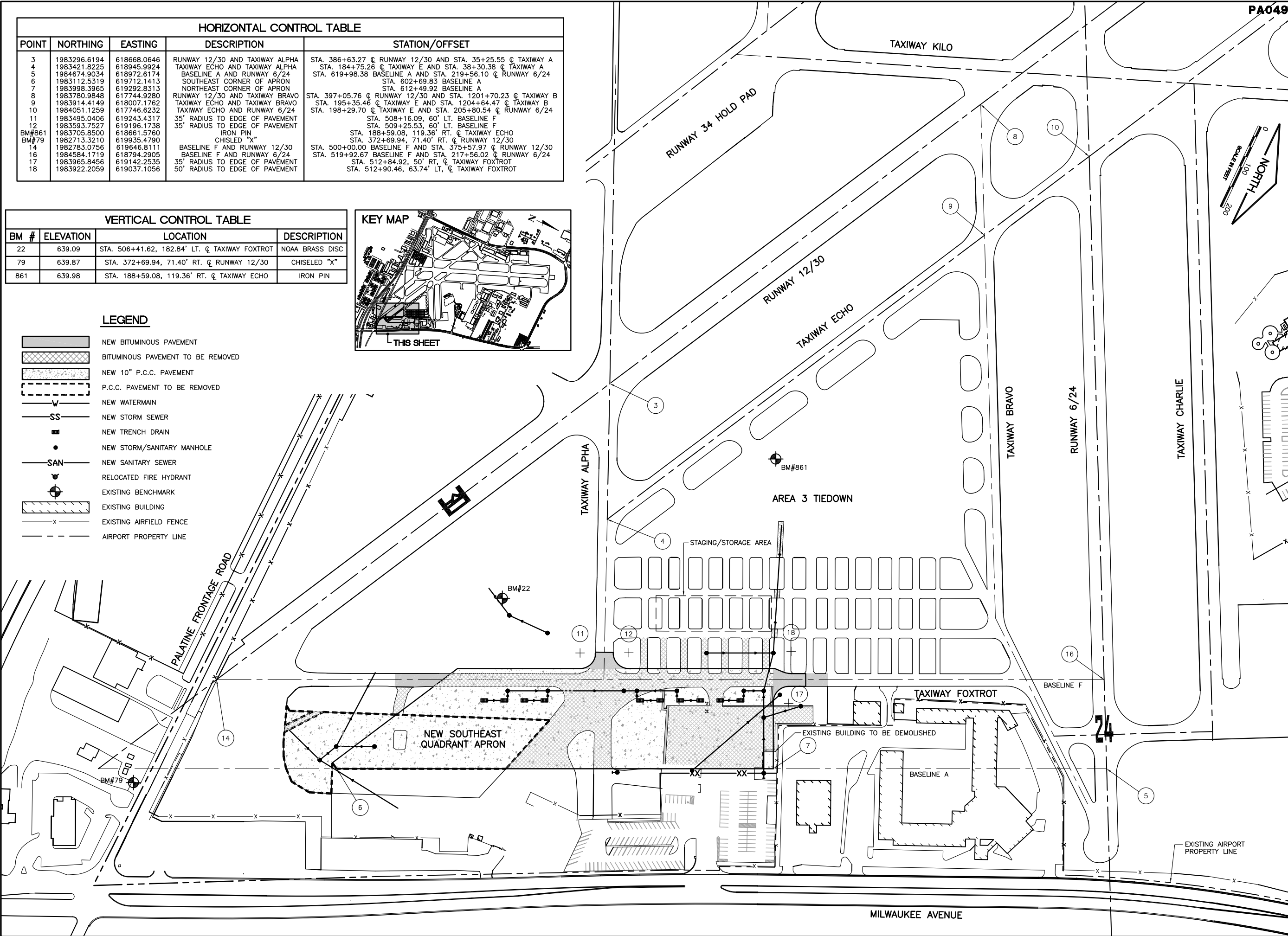

REVISIONS		
NUMBER	BY	DATE

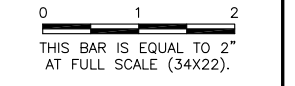

**CHICAGO EXECUTIVE AIRPORT  
 WHEELING/PROSPECT HEIGHTS, ILLINOIS  
 CONSTRUCT SOUTHEAST QUADRANT APRON**

**SITE PLAN/PROJECT CONTROL PLAN**

© Copyright CMT, Inc.  
  
**CMT**  
 CRAWFORD, MURPHY & TILLY, INC.  
 CONSULTING ENGINEERS  
 License No. 184-000613

**CHICAGO EXECUTIVE AIRPORT**

DESIGN BY:	MLK
DRAWN BY:	JRO
CHECKED BY:	
APPROVED BY:	
DATE:	07/24/09
JOB No:	09290-04
ILLINOIS PROJECT:	PWK-3581
A.I.P. PROJECT:	3-17-0018-B37
SHEET	3 OF 35 SHEETS