

**EDGE MARKINGS**  
 CONTINUOUS  
 NO SCALE

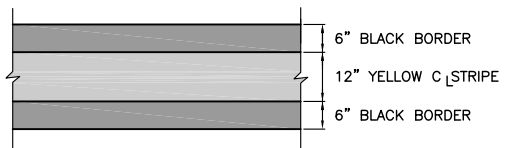

**CENTERLINE MARKING DETAIL**  
 NOT TO SCALE

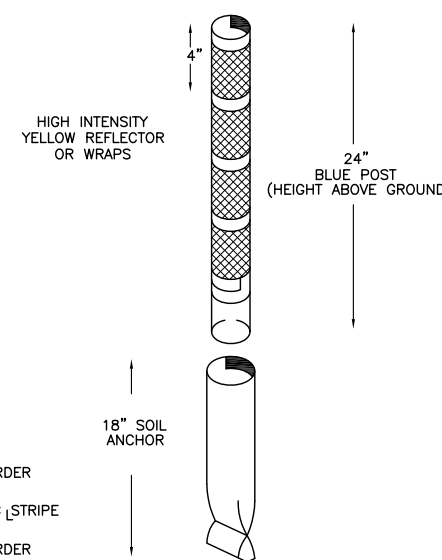

**TAXIWAY RETROREFLECTIVE MARKER DETAIL**  
 NOT TO SCALE

NOTE: RETROREFLECTIVE MARKER SHALL BE UNIPAR, INC. EVAFLEX OR APPROVED EQUAL.

**NOTES:**

- ALL EXISTING TAXIWAY AND RUNWAY AIRFIELD LIGHTING CIRCUITS, FAA CABLES AND OTHER AIRPORT ELECTRICAL CABLES SHALL REMAIN IN SERVICE UNTIL REPLACED AS DIRECTED BY THE ENGINEER. ALL TEMPORARY CABLING AND SPLICING SHALL BE CONSIDERED INCIDENTAL TO CONTRACT.
- AT ANY LOCATION WHERE THE NEW DUCT OR CABLE ROUTE CROSSES AN EXISTING UTILITY, THE CONTRACTOR SHALL HAND DIG AND LOCATE THE EXISTING UTILITY PRIOR TO TRENCHING. COST OF LOCATING ALL EXISTING UTILITIES SHALL BE INCIDENTAL TO THE CONTRACT.
- THE LOCATION OF EXISTING UTILITIES ARE APPROXIMATE. THE CONTRACTOR SHALL OPEN THE ENTIRE TRENCH BETWEEN MANHOLES BEFORE ANY CONDUIT IS LAID TO ASCERTAIN THE EXISTENCE AND POSITION OF ANY OBSTRUCTIONS.
- CONTRACTOR SHALL COORDINATE THE LOCATION OF THE EXISTING AND NEW UTILITIES PRIOR TO INSTALLATION OF THE PROPOSED UNIT DUCTS, CONDUITS AND DUCT BANKS. ANY DAMAGES TO EXISTING UTILITIES SHALL BE REPAIRED IMMEDIATELY AT THE CONTRACTOR'S EXPENSE.
- CONTRACTOR SHALL PROVIDE PULL WIRE FOR ALL DUCT BANKS AND CAP THE UNUSED DUCT BANKS FOR FUTURE USE.
- CONTRACTOR SHALL CONNECT EXISTING CABLE TO NEW CABLE IN SIGN/LIGHT/MANHOLE/HANDHOLE/SPLICE CAN. COST OF CONNECTION INCIDENTAL TO CABLE.
- NO 90 DEGREE BENDS WILL BE ALLOWED IN CONDUIT.
- CONTRACTOR SHALL CORE HOLES INTO EXISTING MANHOLES/HANDHOLES. THE COST OF CORING AND GROUTING SHALL BE INCIDENTAL TO THE INSTALLATION OF THE NEW CABLE.
- ALL LIGHTS AND SIGNS SHALL HAVE QUARTZ BULBS.
- AT EXISTING DUCT BANKS THAT FALL WITHIN THE NEW P.C.C. PAVEMENT, THE CONTRACTOR SHALL STAMP THE DUCT LOCATION, AS DIRECTED BY THE ENGINEER, IN THE NEW P.C.C.

**LEGEND**

- EXISTING BASE MOUNTED MEDIUM INTENSITY TAXIWAY LIGHT
- EXISTING BASE MOUNTED HIGH INTENSITY RUNWAY LIGHT
- EXISTING RUNWAY END IDENTIFIER LIGHT (REIL)
- EXISTING AIRFIELD GUIDANCE SIGN
- EXISTING ELECTRICAL MANHOLE
- EXISTING ELECTRICAL HANDHOLE
- EXISTING CONDUIT/DUCT BANK
- EXISTING RUNWAY 12/30 CIRCUIT
- NEW PAVEMENT MARKING
- NEW 1/2" #8, 5KV, L-B24, TYPE C CABLE IN 2" PVC CONDUIT, DIRECT BURIED. NUMBER OF TICK MARKS INDICATES NUMBER OF CABLES (TYPICAL FOR ALL AIRFIELD LIGHTING CIRCUITS)
- NEW ELEVATED RETRO REFLECTIVE MARKER

**REVISIONS**

NUMBER	BY	DATE

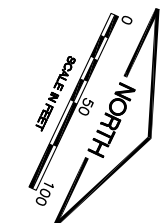
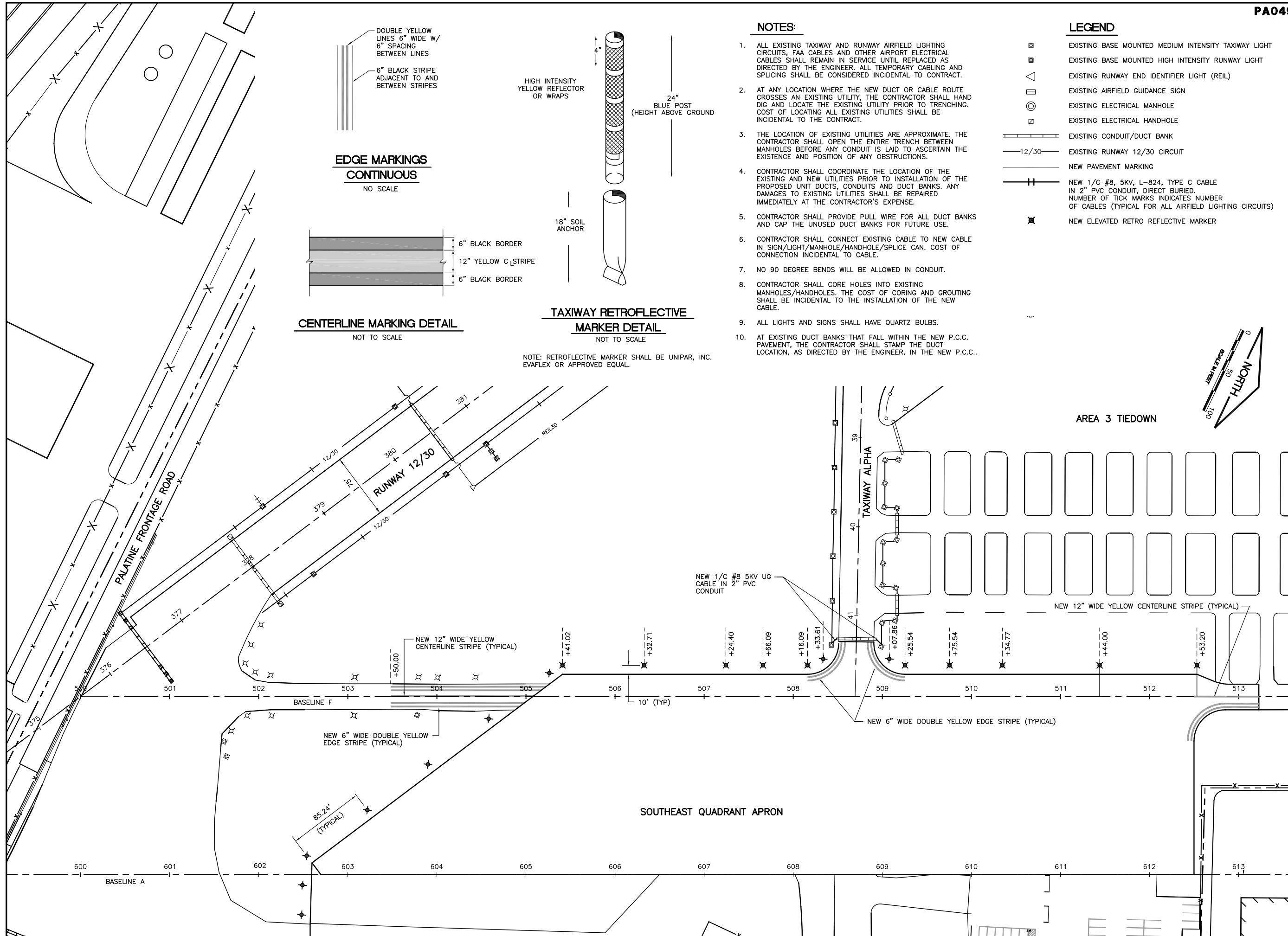
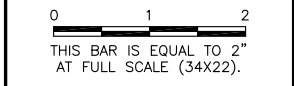

**CHICAGO EXECUTIVE AIRPORT  
 WHEELING/PROSPECT HEIGHTS, ILLINOIS  
 CONSTRUCT SOUTHEAST QUADRANT APRON  
 LIGHTING AND PAVEMENT MARKING PLAN**

© Copyright GMT, Inc.  
**GMT**  
 CRAWFORD, MURPHY & TILLY, INC.  
 CONSULTING ENGINEERS  
 License No. 184-000613

DESIGN BY:	MLK
DRAWN BY:	MJW
CHECKED BY:	
APPROVED BY:	
DATE:	07/24/09
JOB No:	09290-04
ILLINOIS PROJECT:	PWK-3581
A.I.P. PROJECT:	3-17-0018-B37
SHEET	23 OF 35 SHEETS