

TORRENCE AVE. CLOSED AT GRAND CALUMET RIVER FOLLOW DETOUR

1
108X42
"CUSTOM"

TORRENCE AVE.

2
30X9
"CUSTOM"

SOUTH

3
M3-3
24X12

NORTH

4
M3-1
24X12

DETOUR

5
M4-9L
30X24

DETOUR

6
M4-9
30X24

DETOUR

7
M4-9R
30X24

DETOUR

8
M4-9R
30X24

DETOUR

9
M4-9L
30X24

END DETOUR

10
M4-8a
24X18

ROAD CLOSED

11
R11-2
48X30

12
2-TYPE III BARRICADES WITH 2 FLASHERS EACH

13
W20-2
48X48

DETOUR AHEAD

14
W20-3
48X48

ROAD CLOSED AHEAD

BRIDGE OUT 1 MILE AHEAD LOCAL TRAFFIC ONLY

15
60X30
R11-3b

DETOUR

16
M4-10L
48X18

BRIDGE OUT 1 1/2 MILES AHEAD LOCAL TRAFFIC ONLY

17
60X30
R11-13b

DETOUR

18
M4-10R
48X18

19
W20-3
48X48

ROAD CLOSED 500 FT

20
R9-9
24X12

SIDEWALK CLOSED

SOUTH TORRENCE AVE. DETOUR

TYPICAL SIGN ASSEMBLY

DETOUR LEGEND

- PROPOSED DETOUR GUIDE SIGN ASSEMBLY
- EXISTING DETOUR GUIDE SIGN ASSEMBLY
- PROPOSED SIGN PLAQUE
- EXISTING SIGN PLAQUE
- TYPE III BARRICADE WITH FLASHING LIGHTS AND ROAD CLOSED SIGN
- S. TORRENCE AVE. DETOUR
- DETOUR TRAFFIC FLOW DIRECTION

• 100' STAGGER FOR TYPE III BARRICADES

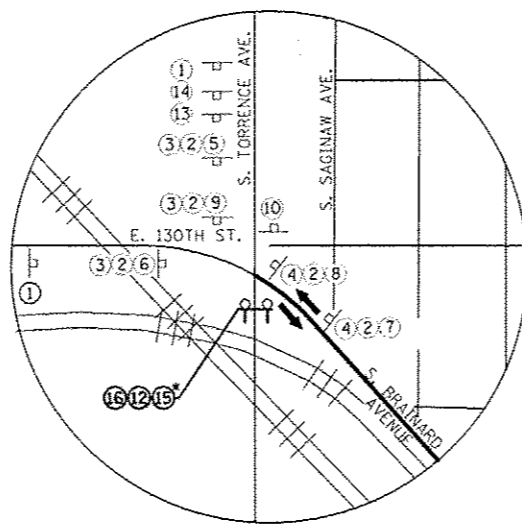

DETOUR NOTES

1. THE EXISTING TRAFFIC CONTROL DEVICES ALONG THE DETOUR ROUTE HAVE BEEN PREVIOUSLY FURNISHED AND ERECTED BY THE DEPARTMENT. CONTRACTOR WILL BE REQUIRED TO INSTALL PROPOSED TRAFFIC CONTROL DEVICES SHOWN ON THIS DETOUR PLAN. THROUGHOUT THE DURATION OF THE PROJECT, THE CONTRACTOR SHALL PROVIDE SURVEILLANCE OF THE EXISTING DETOUR (DEPARTMENT-OWNED SIGNS AND PROPOSED TRAFFIC CONTROL DEVICES SHOWN ON THIS DETOUR PLAN).
2. CDOT TRAFFIC TEL. NO 312-744-0330 MUST BE NOTIFIED IMMEDIATELY AFTER THE ROADS HAVE BEEN REOPENED.
3. THE CONTRACTOR SHALL CONTACT IDOT DISTRICT ONE TRAFFIC CONTROL SUPERVISOR AT (847) 705-4470 A MINIMUM OF 72 HOURS IN ADVANCE OF BEGINNING WORK.
4. THE CONTRACTOR MUST MAINTAIN AND REMOVE ALL TEMPORARY SIGN SUPPORTS.
5. AFTER REMOVING THE SUPPORTS, THE CONTRACTOR MUST FILL HOLES (IF ANY) AND RESTORE THE GROUND TO ITS ORIGINAL CONDITION AND ELEVATION. THE COST OF PLACING GRAVEL, SOD OR SEED MUST BE INCLUDED IN THE UNIT BID PRICE FOR "TRAFFIC CONTROL SURVEILLANCE (SPECIAL)".
6. ALL SIGNS, SUPPORTS AND POSITIONING MUST BE IN ACCORDANCE WITH THE MANUAL ON UNIFORM TRAFFIC CONTROL DEVICES, LATEST EDITION.
7. SIGNING SHALL BE PLACED AT LOCATIONS THAT WILL BE COMPATIBLE WITH EXISTING SIGNING.
8. ALL EXISTING SIGNS THAT CONFLICT WITH THE DETOUR MUST BE COVERED. IF THE DETOUR CONFLICTS WITH OTHER DETOUR SIGNS THEN THE CONTRACT SHALL COORDINATE SIGNAGE FOR THE DETOUR TO ELIMINATE CONFLICTING SIGNAGE.
9. DETOUR SIGNING AND SPACING SHALL FOLLOW IDOT DISTRICT ONE DETAIL TC-21.
10. CONTRACTOR SHALL COORDINATE WITH IDOT DISTRICT 1 RAILROAD UNIT IN REGARD TO ADJACENT IDOT RAILROAD SIGNAL INTERCONNECT PROJECT AT BRAINARD AVENUE AND BURNHAM AVENUE WHICH IS LOCATED ALONG THE APPROVED DETOUR ROUTE FOR THIS PROJECT.

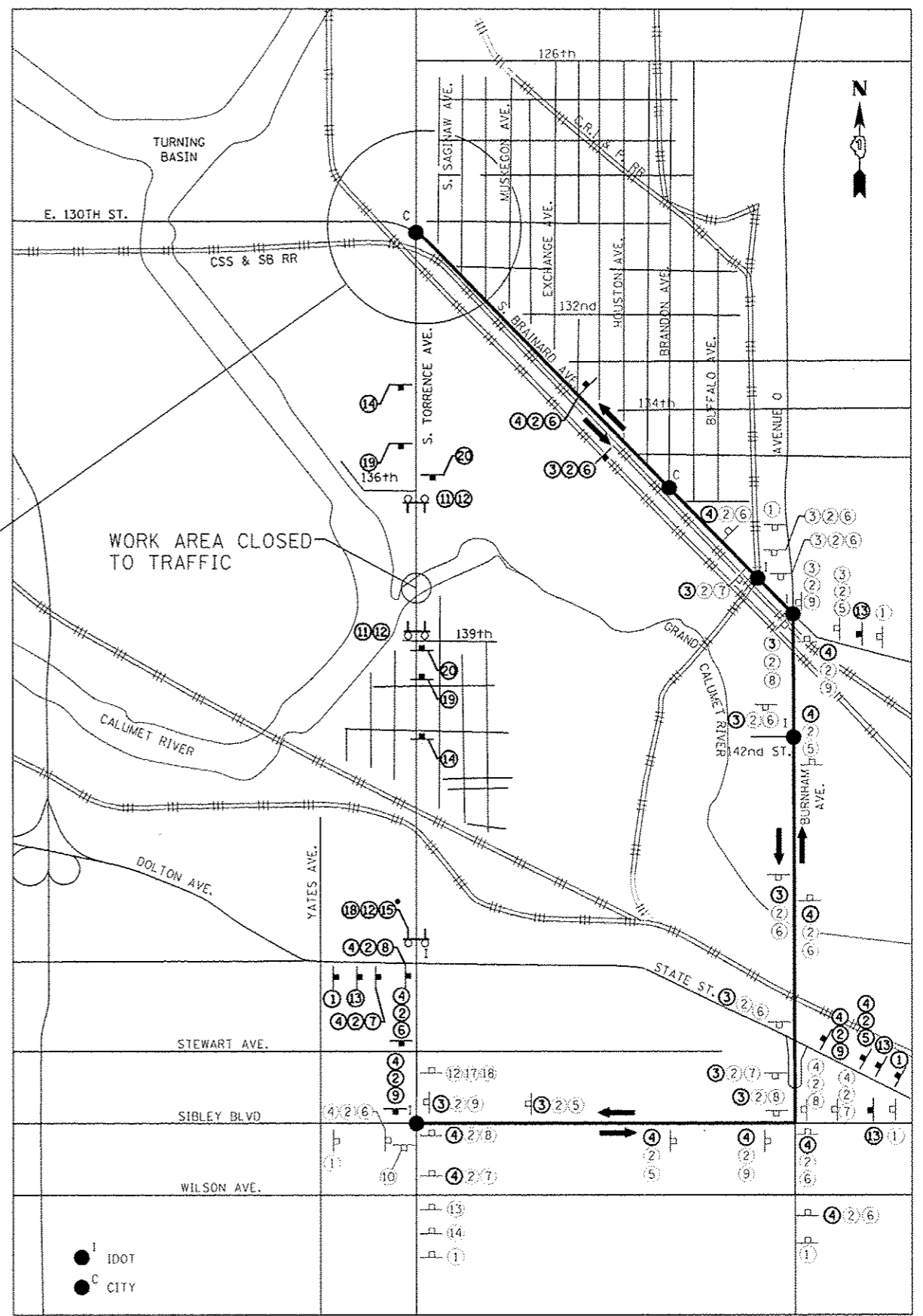

SIGNAGE LEGEND

FLASHING MONO-DIRECTIONAL LIGHTS

FILE NAME: WFILES

USER NAME: #USER#	DESIGNED: SMS	REVISED: 1 9/11/15
DRAWN: SMS	CHECKED: DCW	REVISED: -
PLOT SCALE: #SCALE#	DATE: 6-15-2015	REVISED: -
PLOT DATE: #DATE#		

STATE OF ILLINOIS
DEPARTMENT OF TRANSPORTATION

**TORRENCE AVENUE
DETOUR PLAN**

SCALE: N.T.S. SHEET 40 OF 40 TOTAL SHEETS STA. TO STA.

F.A.P. RTE. 358	SECTION 1112.1B-R	COUNTY COOK	TOTAL SHEETS 152	SHEET NO. 20
ILLINOIS FED. AID PROJECT			CONTRACT NO. 60R95	