

STATE OF ILLINOIS
DEPARTMENT OF TRANSPORTATION

DIVISION OF HIGHWAYS

**PROPOSED
HIGHWAY PLANS**

**COUNTY HIGHWAY 2 (FAS ROUTE 452)
SECTION 14-00130-15-DR
PROJECT ER-0057(039)
EMBANKMENT EMERGENCY REPAIR
FULTON COUNTY**

F.A.S. RTE.	SECTION	COUNTY	TOTAL SHEETS	SHEET NO.
452	14-00130-15-DR	FULTON	8	1
		ILLINOIS	CONTRACT NO. 89669	

INDEX OF SHEETS

- 1 COVER SHEET
- 2 SUMMARY & SCHEDULES OF QUANTITIES
- 3 TYPICAL SECTION & GENERAL NOTES
- 4 PLAN & EROSION CONTROL PLAN
- 5 DETOUR PLAN
- 6-8 CROSS SECTIONS

LIST OF HIGHWAY STANDARDS

- 000001-06 STANDARD SYMBOLS, ABBREVIATIONS AND PATTERNS
- 280001-07 TEMPORARY EROSION CONTROL SYSTEMS
- 601101-01 CONCRETE HEADWALL FOR PIPE DRAIN
- 630301-06 SHOULDER WIDENING FOR TYPE 1 (SPECIAL) GUARDRAIL TERMINALS
- 701901-04 TRAFFIC CONTROL DEVICES
- BLR 26-3 STEEL PLATE BEAM GUARDRAIL 29" HEIGHT
- BLR 21-9 TYPICAL APPLICATION OF TRAFFIC CONTROL DEVICES FOR CONSTRUCTION ON RURAL LOCAL HIGHWAYS

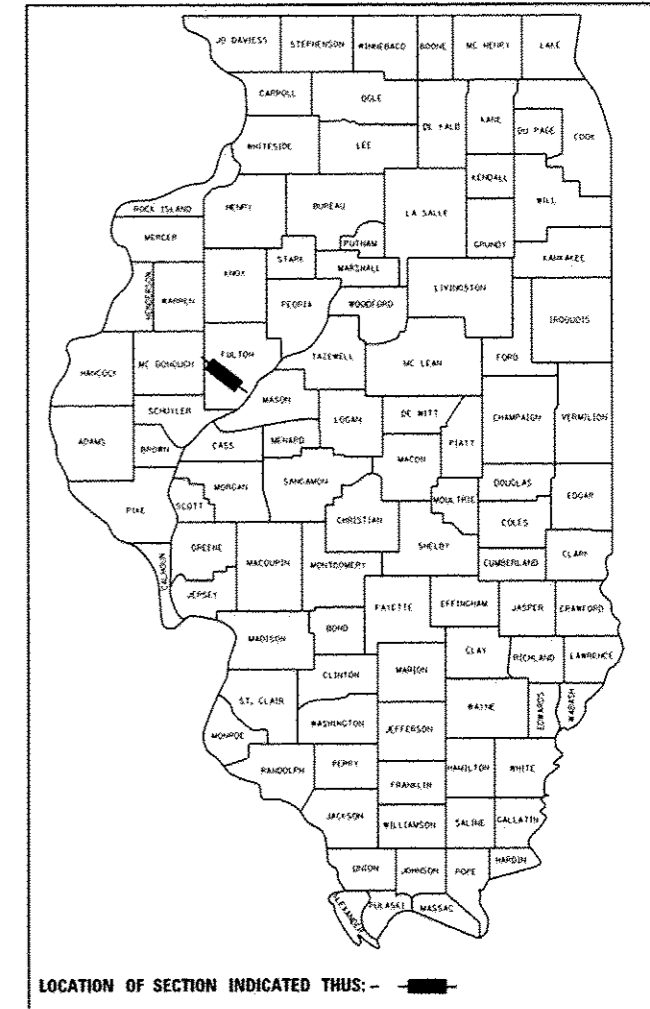

C-94-055-14

T 5 N, R 2 E, 4TH PM

**PROJECT
LOCATION**

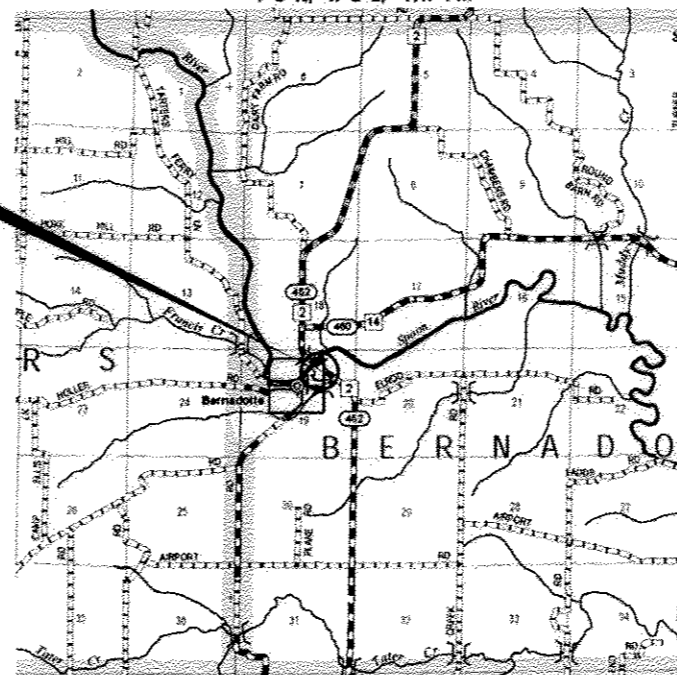

LOCATION MAP
NOT TO SCALE

PROJECT LENGTH = 377.00 FT. = 0.071 MILE

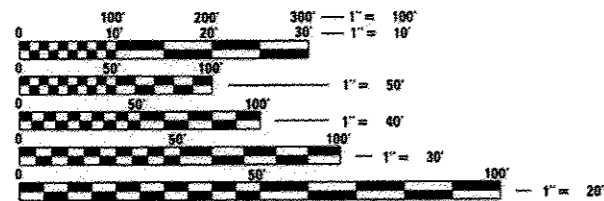

FULL SIZE PLANS HAVE BEEN PREPARED USING STANDARD ENGINEERING SCALES. REDUCED SIZED PLANS WILL NOT CONFORM TO STANDARD SCALES. IN MAKING MEASUREMENTS ON REDUCED PLANS, THE ABOVE SCALES MAY BE USED.

J.U.L.I.E.
JOINT UTILITY LOCATION INFORMATION FOR EXCAVATION
1-800-892-0123
OR 811

PROJECT MANAGER: SHANE LARSON, P.E.
PROJECT ENGINEER: BEN NEBEL, S.E.
CATALOG #035068-00
CONTRACT NO. 89669

Hutchison Engineering, Inc.
Jacksonville - Peoria - Shorewood
Since 1945
2015 JOB #3715

SHANE LARSON
062-051722
REGISTERED PROFESSIONAL ENGINEER OF THE STATE OF ILLINOIS
EXPIRES: 11/30/15
SIGNATURE
ENGINEER'S SEAL

FUNCTIONAL CLASSIFICATION
RURAL MAJOR COLLECTOR
2012 ADT = 500
DESIGN SPEED = 50 MPH
PV = 88% SU = 7% MU = 5%

STATE OF ILLINOIS
DEPARTMENT OF TRANSPORTATION
DIVISION OF HIGHWAYS

APPROVED *[Signature]* June 18, 2015
COUNTY ENGINEER

PASSED *[Signature]* June 30, 2015
DISTRICT FOUR ENGINEER OF LOCAL ROADS AND STREETS

RELEASED FOR BID BASED ON LIMITED REVIEW *[Signature]* June 30, 2015
DEPUTY DIRECTOR OF HIGHWAYS, REGION THREE ENGINEER

**PRINTED BY THE AUTHORITY
OF THE STATE OF ILLINOIS**

SUMMARY OF QUANTITIES

SPECIAL PROVISION	CODE NO.	DESCRIPTION	UNIT	TOTAL QUANTITY
	25000400	NITROGEN FERTILIZER NUTRIENT	POUND	45
	25000500	PHOSPHORUS FERTILIZER NUTRIENT	POUND	45
	25000600	POTASSIUM FERTILIZER NUTRIENT	POUND	45
SP	20200100	EARTH EXCAVATION	CU YD	4100
SP	20400800	FURNISHED EXCAVATION	CU YD	2035
	21101615	TOPSOIL FURNISH AND PLACE, 4"	SQ YD	2001
	25000300	SEEDING, CLASS 3	ACRE	0.50
	25100635	HEAVY DUTY EROSION CONTROL BLANKET	SQ YD	2001
	26200200	FILTER FABRIC	SQ YD	558
	48101200	AGGREGATE SHOULDERS, TYPE B	TON	71
	60100060	CONCRETE HEADWALLS FOR PIPE DRAINS	EACH	1
	60100915	PIPE DRAINS 6"	FOOT	72
SP	60107600	PIPE UNDERDRAINS 4"	FOOT	606
▲	63000001	STEEL PLATE BEAM GUARDRAIL, TYPE A, 6 FOOT POSTS	FOOT	25
▲	63100167	TRAFFIC BARRIER TERMINAL, TYPE 1 (SPECIAL) TANGENT	EACH	1
▲	63200310	GUARDRAIL REMOVAL	FOOT	55.5
▲ SP	63301210	REMOVE AND REERECT STEEL PLATE BEAM GUARDRAIL, TYPE A	FOOT	262.5
	67100100	MOBILIZATION	L SUM	1
▲ SP	78201000	TERMINAL MARKER - DIRECT APPLIED	EACH	1
SP	X7010216	TRAFFIC CONTROL AND PROTECTION, (SPECIAL)	L SUM	1
SP	XX008550	REMOVE AND REPLACE STONE RIPRAP	SQ YD	558
SP	Z0013798	CONSTRUCTION LAYOUT	L SUM	1

▲ SPECIALTY ITEMS

STATION	TO	STATION	SIDE	FOOT
13+50	TO	15+25	RT	176
13+50	TO	15+30	RT	180
13+50	TO	16+00	RT	250
TOTAL				606

STATION	TO	STATION	SIDE	STEEL PLATE BEAM GUARDRAIL, TYPE A, 6 FOOT POSTS	TRAFFIC BARRIER TERMINAL, TYPE 1 (SPECIAL) TANGENT	TERMINAL MARKER - DIRECT APPLIED	REMOVE AND REERECT STEEL PLATE BEAM GUARDRAIL, TYPE A	GUARDRAIL REMOVAL
				FOOT	EACH	EACH	FOOT	FOOT
13+25.0	TO	15+87.5	RT				262.5	
15+87.5	TO	16+12.5	RT	25				
15+87.5	TO	16+43.0	RT					55.5
16+12.5	TO	16+62.5	RT		1	1		
TOTAL				25	1	1	262.5	55.5

EARTHWORK

1		2		3		4		5		6	
LOCATION		EARTH EXCAVATION		SUITABLE EXCAVATION ADJUSTED FOR SHRINKAGE		EMBANKMENT		EARTH BALANCE WASTE (+) OR SHORTAGE (-)		TOPSOIL FURNISH AND PLACE, 4"	
STATION	TO	STATION	CU YD	CU YD	CU YD	CU YD	CU YD	CU YD	CU YD	SQ YD	SQ YD
13+25	TO	17+02	4098	3073	5106			-2033			2001
TOTAL			4098	3073	5106			-2033			2001
USE			4100	3073	5106			-2035			2001

SHRINKAGE FACTORS: 25%
 EARTH EXCAVATION:
 COLUMN 1, 2 & 4 - LOCATION AND QUANTITIES FROM CROSS SECTIONS.
 CUT = EARTH EXCAVATION AND FILL = EMBANKMENT
 COLUMN 3 = COLUMN 2 x (1 - EARTH EXCAVATION SHRINKAGE FACTOR)
 COLUMN 5 = COLUMN 3 - COLUMN 4
 PAY ITEMS ARE EARTH EXCAVATION (COLUMN 2), FURNISHED EXCAVATION (COLUMN 5) & TOPSOIL FURNISH AND PLACE, 4" (COLUMN 6).

SEEDING & NUTRIENTS

LOCATION		SEEDING, CLASS 3	NITROGEN FERTILIZER NUTRIENT	PHOSPHORUS FERTILIZER NUTRIENT	POTASSIUM FERTILIZER NUTRIENT
STATION +/-	TO	ACRE	POUND	POUND	POUND
13+25	TO	17+02	0.50	45	45
TOTAL		0.50	45	45	45

SEEDING NUTRIENTS RATE OF APPLICATION = 90 LBS/ACRE

HEAVY DUTY EROSION CONTROL BLANKET

LOCATION		AREA
STATION +/-	TO	SQ YD
13+25	TO	17+02
TOTAL		2001

RIPRAP

STATION	TO	STATION	SIDE	STONE RIPRAP, SPECIAL	FILTER FABRIC
				SQ YD	
13+25	TO	16+76	RT	558	558
TOTAL				558	558

AGGREGATE SHOULDERS

STATION	TO	STATION	SIDE	AGGREGATE SHOULDERS, TYPE B
				TON
13+25	TO	17+02	RT	71
TOTAL				71

PIPE DRAIN

STATION	TO	STATION	SIDE	PIPE DRAINS 6"	CONCRETE HEADWALLS FOR PIPE DRAINS
				FOOT	EACH
13+25		13+50	RT	72	
		13+28	RT		1
TOTAL				72	1

FILE NAME >	USER NAME >	DESIGNED -	REVISED -
W:\3715 - Fulton Cnty - Slope Failure - P	Stughes	BAN	
	D:\CADD\C400 Sheets\043715-sh1-500.dgn	DRAWN -	REVISED -
		SRH	
	PLT SCALE = 2.000' / 1"	CHECKED -	REVISED -
		WSL	
	PLT DATE = 6/29/2015	DATE -	REVISED -
		5/5/15	

FULTON COUNTY HIGHWAY DEPARTMENT

CH 2 (FAS RTE 452) SUMMARY & SCHEDULES OF QUANTITIES

SCALE: N/A	SHEET NO. 1 OF 1 SHEETS	STA. N/A	TO STA. N/A	F.A.S. RTE. 452	SECTION 14-00130-15-DR	COUNTY FULTON	TOTAL SHEETS 8	SHEET NO. 2	CONTRACT NO. 89669	ILLINOIS FED. AID PROJECT
------------	-------------------------	----------	-------------	-----------------	------------------------	---------------	----------------	-------------	--------------------	---------------------------

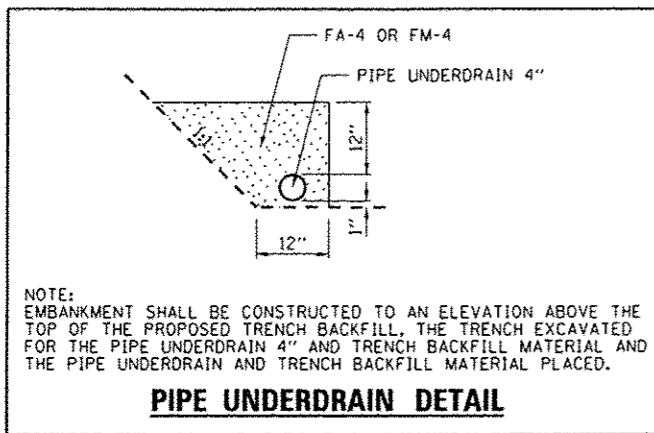
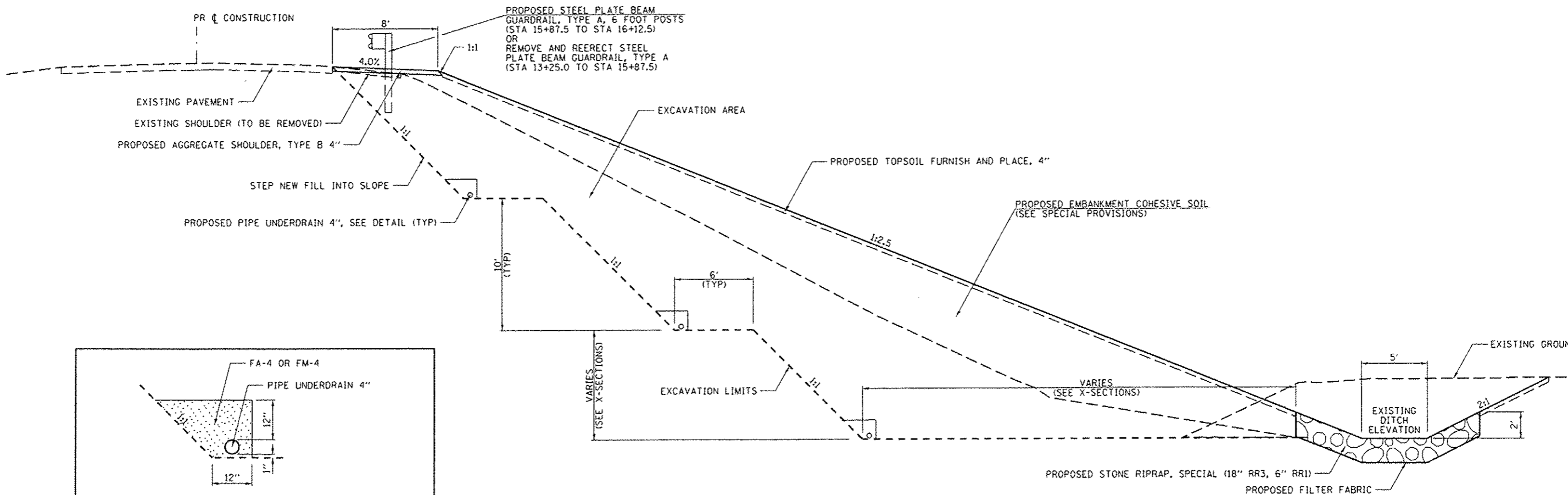

NOTE:
 EMBANKMENT SHALL BE CONSTRUCTED TO AN ELEVATION ABOVE THE TOP OF THE PROPOSED TRENCH BACKFILL, THE TRENCH EXCAVATED FOR THE PIPE UNDERDRAIN 4" AND TRENCH BACKFILL MATERIAL AND THE PIPE UNDERDRAIN AND TRENCH BACKFILL MATERIAL PLACED.

PIPE UNDERDRAIN DETAIL

PROPOSED TYPICAL SECTION
CH 2 (FAS RTE 452)
 STA 13+25 TO STA 17+02

GENERAL NOTES

THE REMOVAL OF EXISTING HOT-MIX ASPHALT SURFACE AND GRAVEL OR CRUSHED STONE BASE COURSE WHICH MAY BE NECESSARY FOR THE CONSTRUCTION OF THE IMPROVEMENT, EXCEPT AS NOTED, SHALL BE REMOVED AS EARTH EXCAVATION AND NO COMPENSATION WILL BE ALLOWED FOR ADDITIONAL LABOR OR EQUIPMENT REQUIRED.

ALL WASTE OR UNDESIRABLE MATERIAL AS IDENTIFIED BY THE ENGINEER SHALL BE DISPOSED OF OUTSIDE THE LIMITS OF THE RIGHT-OF-WAY AT THE CONTRACTOR'S EXPENSE.

SOIL REPORT AVAILABILITY

THE SOILS REPORT AND ALL SOILS DATA COLLECTED AND PROCESSED IN CONJUNCTION WITH THE DESIGN OF IMPROVEMENT IS ON FILE AT HUTCHISON ENGINEERING'S OFFICE WHERE IT IS AVAILABLE FOR INSPECTION BY CONTRACTORS OR PROSPECTIVE BIDDERS. BY SUBMITTING A BID, THE CONTRACTOR ACKNOWLEDGES THAT THE SOILS REPORT AND DATA HAVE BEEN MADE AVAILABLE, THAT THE CONTRACTOR IS AWARE OF THE REPORT CONTENTS AND APPENDICES AND THAT THE SOILS REPORT IS PART OF THE CONTRACT DOCUMENTS.

AVAILABILITY OF ELECTRONIC FILES

MICROSTATION AND GEOPAK FILES OF THIS PROJECT WILL BE MADE AVAILABLE TO THE CONTRACTOR AFTER CONTRACT AWARD. IF THERE IS A CONFLICT BETWEEN THE ELECTRONIC FILES AND THE PRINTED CONTRACT PLANS AND DOCUMENTS, THE PRINTED CONTRACT PLANS AND DOCUMENTS SHALL TAKE PRECEDENCE OVER THE ELECTRONIC FILES AND SHALL HOLD HUTCHISON ENGINEERING & WOODFORD COUNTY HARMLESS FOR ANY ERRORS OR OMISSIONS IN THE ELECTRONIC FILES AND THE DATA CONTAINED THEREIN. ERRORS OR DELAYS RESULTING FROM THE USE OF THE ELECTRONIC FILES BY THE CONTRACTOR SHALL NOT RESULT IN AN EXTENSION OF TIME FOR ANY INTERIM OR FINAL COMPLETION DATE OR SHALL NOT BE CONSIDERED CAUSE FOR ADDITIONAL COMPENSATION. THE CONTRACTOR SHALL NOT USE, SHARE OR DISTRIBUTE THESE ELECTRONIC FILES EXCEPT FOR THE PURPOSE OF CONSTRUCTING THIS CONTRACT. ANY CLAIMS BY THIRD PARTIES DUE TO USE OR ERRORS SHALL BE THE SOLE RESPONSIBILITY OF THE CONTRACTOR. THE CONTRACTOR SHALL INCLUDE THIS DISCLAIMER WITH THE TRANSFER OF THESE ELECTRONIC FILES TO ANY OTHER PARTIES AND SHALL INCLUDE APPROPRIATE LANGUAGE BINDING THEM TO SIMILAR RESPONSIBILITIES.

PLAN ELEVATIONS - U.S.G.S. MEAN SEA LEVEL DATUM

ALL ELEVATIONS SHOWN REFER TO U.S.G.S. DATUM AT MEAN SEA LEVEL UNLESS OTHERWISE NOTED.

CLEARING

AT LOCATIONS WHERE CLEARING IS INDICATED ON THE PLANS BEYOND THE LIMITS OF THE PROPOSED EXCAVATION OR EMBANKMENT, THE CONTRACTOR SHALL RESTORE THE DISTURBED EARTH BY BLADING AND SHAPING TO BLEND WITH THE ADJACENT GROUND. THE CLEARING WILL NOT BE PAID FOR SEPARATELY BUT SHALL BE INCLUDED IN THE COST OF THE EXCAVATION PAY ITEMS IN THE PLANS. PAYMENT FOR RESEEDING OR RESODDING WILL BE AS PROVIDED IN THE PLANS.

ENVIRONMENTAL REVIEWS

PRIOR TO THE USE OF ANY PROPOSED BORROW AREAS, USE AREAS (TEMPORARY ACCESS ROADS, DETOURS RUN-AROUNDS, ETC.) AND/OR WASTE AREAS, THE CONTRACTOR SHALL FILE THE REQUIRED ENVIRONMENTAL RESOURCE REQUEST SURVEYS ACCORDING TO SECTION 107.22 OF THE STANDARD SPECIFICATIONS. THESE SURVEYS ARE REQUIRED IN ORDER FOR THE DEPARTMENT TO CONDUCT CULTURAL AND BIOLOGICAL RESOURCE SURVEYS FOR THE PROPOSED SITE.

THE REQUIRED ENVIRONMENTAL RESOURCE DOCUMENTATION SHALL INCLUDE THE FOLLOWING:

- BDE FORM 2289 (CULTURAL AND NATURAL RESOURCES REVIEW OF BORROW AREAS)
- BDE FORM 2290 (WASTE/USE AREA REVIEW)
- A LOCATION MAP SHOWING THE SIZE LIMITS AND LOCATION OF THE USE AREA
- COLOR PHOTOGRAPHS DEPICTING THE USE AREA
- BORROW AREA ENTRY AGREEMENT FORM - D4 P10101

PRIOR TO ANY WASTE MATERIALS BEING REMOVED FROM THE CONSTRUCTION SITE THE REQUIRED ENVIRONMENTAL RESOURCE SURVEYS WILL NEED TO BE OBTAINED AND FILED BY THE CONTRACTOR. EXCESS WASTE PRODUCTS REMOVED FROM THE CONSTRUCTION SITE SHALL BE DISPOSED OF AS REQUIRED IN SECTION 202.03 OF THE STANDARD SPECIFICATIONS.

ANY PROTRUDING METAL BARS SHALL BE REMOVED PRIOR TO THE DISPOSAL OF BROKEN CONCRETE AT APPROVED DISPOSAL SITES.

PLEASE NOTE THAT A MINIMUM OF FOUR WEEKS SHALL BE ALLOWED FOR I.D.O.T. DISTRICT 4 TO OBTAIN THE REQUIRED WASTE SITE ENVIRONMENTAL CLEARANCES AND FIVE WEEKS FOR THE REQUIRED BORROW SITE ENVIRONMENTAL CLEARANCES.

SEEDING - SIDESLOPE RIPPING

ALL SLOPES STEEPER THAN 3 TO 1 AND OVER 15 FT. IN HEIGHT SHALL BE RIPPED. THIS SHALL CONSIST OF RIPPING BETWEEN 18 INCHES TO 24 INCHES DEEP NORMAL TO THE SLOPE. THE INTERVAL OF RIPPING ALONG THE SLOPE SHALL BE 12 FT. THIS WORK SHALL BE DONE AFTER THE SEED BED HAS BEEN PREPARED BUT BEFORE ANY FERTILIZER OR SEED HAS BEEN APPLIED. THE FERTILIZER AND SEED SHALL BE APPLIED WITHIN 24-HOUR PERIOD AFTER THE RIPPING HAS BEEN DONE. THIS WORK WILL NOT BE PAID FOR SEPARATELY BUT WILL BE INCLUDED IN THE COST OF THE VARIOUS ITEMS OF SEEDING INVOLVED.

ORDERING LENGTH CONFIRMATION - DRAINAGE ITEMS

THE CONTRACTOR SHALL CONSULT WITH THE ENGINEER IN REGARD TO THE EXACT LENGTH OF THE BOX/PIPE CULVERTS, STORM SEWERS AND/OR PIPE DRAIN REQUIRED PRIOR TO ORDERING THESE ITEMS.

FILE NAME : Y:\3715 - Fulton Cnty - Slope Failure - PH	USER NAME : Shughes I:\CADD\CADD Sheets\3715-shh-typical.dgn	DESIGNED - BAN	REVISED -	FULTON COUNTY HIGHWAY DEPARTMENT	CH 2 (FAS RTE 452) TYPICAL SECTION & GENERAL NOTES			F.A.S. RTE. 452	SECTION 14-00130-15-DR	COUNTY FULTON	TOTAL SHEETS 8	SHEET NO. 3
	PLOT SCALE : 8,000' / 1" =	DRAWN - SRH	REVISED -		SCALE: N/A	SHEET NO. 1 OF 1 SHEETS	STA. N/A	TO STA. N/A	CONTRACT NO. 89669			
	PLOT DATE : 6/15/2015	CHECKED - WSL	REVISED -		ILLINOIS FED. AID PROJECT							
		DATE - 4/24/15	REVISED -									

SEC 19, T 5 N, R 2 E, 4th PM

NOTES:
 PIPE UNDERDRAIN 4" SHALL BE CONNECTED TO THE PIPE DRAIN 6" WITH A 45° WYE OR TEE CONNECTOR. THE COST OF THE CONNECTOR SHALL BE INCLUDED IN THE COST OF PIPE UNDERDRAIN 4" AND PIPE DRAIN 6".
 SEE SCHEDULE OF QUANTITIES FOR LIMITS OF GUARDRAIL ITEMS.
 SHOULDER SHALL TRANSITION FROM EXISTING WIDTH AT STA. 13+25 TO 8' WIDE AT STA. 14+25.
 GUARDRAIL OFFSET FROM CENTERLINE SHALL TRANSITION FROM EXISTING OFFSET AT STA. 13+25 TO 15' FROM CENTERLINE AT STA. 14+25.
 GUARDRAIL HEIGHT SHALL TRANSITION FROM EXISTING HEIGHT AT STA. 13+25 TO 29" AT TOP OF RAIL PER HIGHWAY STANDARD BLR 26-3 AT STA. 16+12.5.

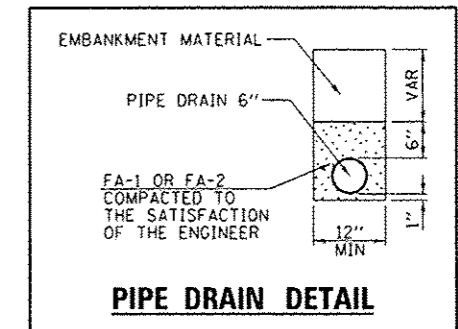
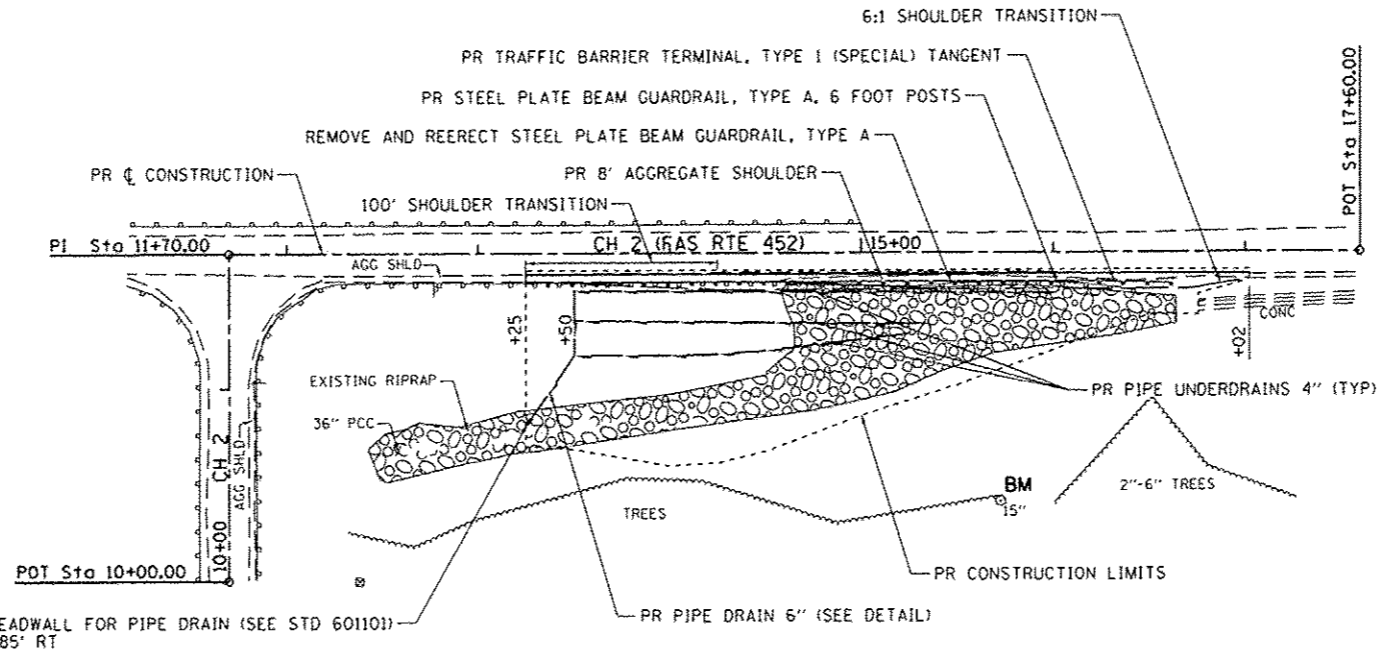

PLAN

BM - RAILROAD SPIKE SET IN 15" TREE
 STA 15+72.6± 129.1'± RT ELEV 552.66

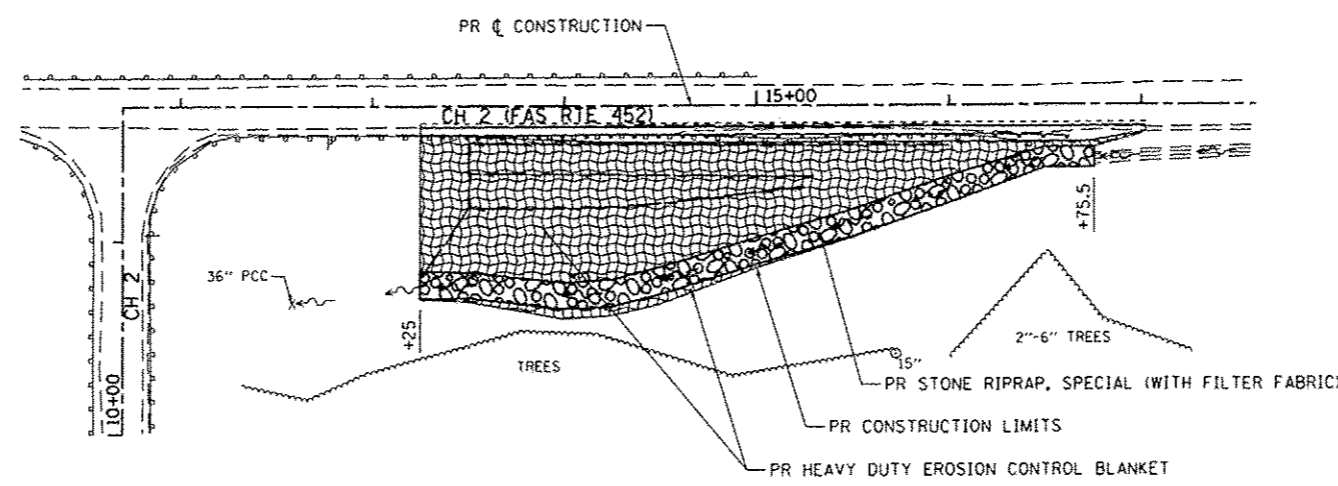
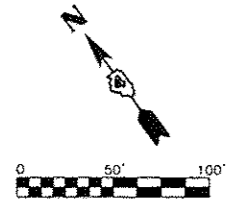

EROSION CONTROL PLAN

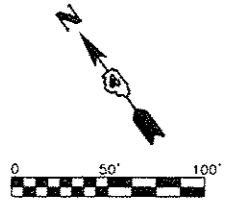

FILE NAME =	USER NAME = Shughes	DESIGNED - BAN	REVISED -	FULTON COUNTY HIGHWAY DEPARTMENT	CH 2 (FAS RTE 452) PLAN & EROSION CONTROL PLAN			F.A.S. RTE. 452	SECTION 14-00130-15-DR	COUNTY FULTON	TOTAL SHEETS 8	SHEET NO. 4
V:\3715 - Fulton Cnty - Slope Failure - PH	F:\CADD\CADD Sheets\043715-sht-plan.dgn	DRAWN - SRH	REVISED -		SCALE: 1"=50'	SHEET 1 OF 1 SHEETS	STA. 10+00	TO STA. 17+60	CONTRACT NO. 89669			
Default	PLOT SCALE = 100.0000' / 1"	CHECKED - WSL	REVISED -		ILLINOIS FED. AID PROJECT							
	PLOT DATE = 6/15/2015	DATE - 3/23/15	REVISED -									

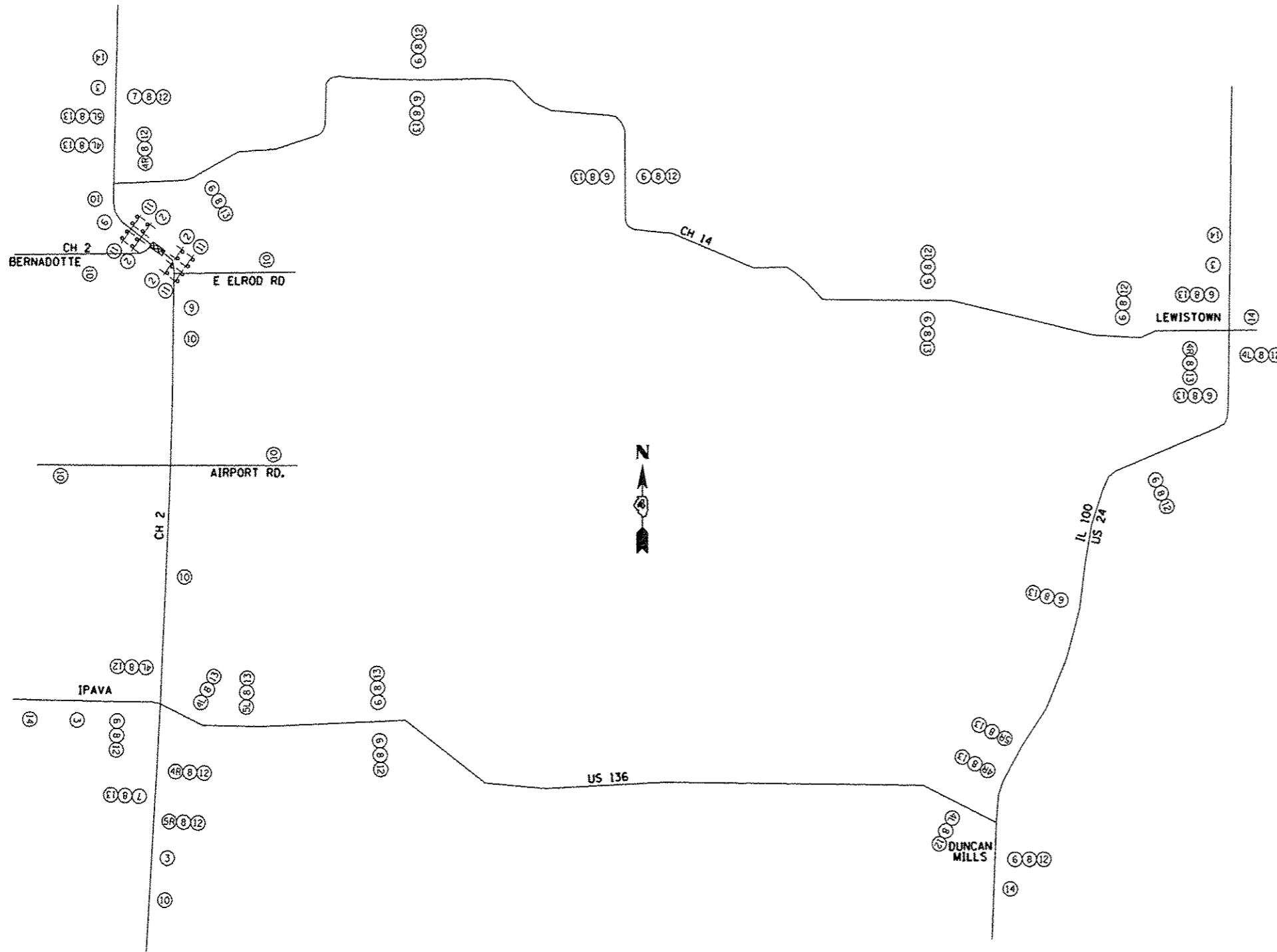

SIGN KEY

- 1 M4-10-4818 B/O
- 2 R11-2-4830 B/W
- 3 W20-2-4848 B/O
- 4 L/R M4-9-3024 B/O
- 5 L/R M4-9-2430 B/O
- 6 M4-9-2430 B/O
- 7 M4-BA-1824 B/O
- 8 30"x12" B/O W/ 6" LETTERING
- 9 W20-3-4848 B/O
- 10 W20-3-4848 B/O
- 11 R11-4-6030 B/W
- 12 M3-1-2412 B/W
- 13 M3-3-2412 B/W
- 14 40"x40" B/O W/ 6" LETTERING

TYPICAL DETOUR SIGN ASSEMBLY PANEL

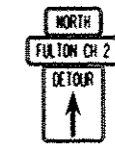

LEGEND

- TYPE III BARRICADE WITH FLASHERS (AS MANY AS DIRECTED BY THE ENGINEER)
- ROAD CLOSURE LOCATION

NOTES

MULTIPLE SIGNS AT ANY ONE LOCATION SHALL BE MOUNTED ON A COMMON POST OR STRUCTURE WHEN POSSIBLE. SIGNS MAY BE MOUNTED ON STREET LIGHT STANDARDS WHERE AVAILABLE. SIGN SPACING SHALL BE ACCORDING TO IDOT DISTRICT DETAIL TC-21.

ALL DETOUR SIGNS SHALL BE MOUNTED A MINIMUM OF 7 FEET ABOVE THE EXISTING SURFACE ON POSTS DRIVEN INTO THE GROUND PER STATE STANDARD 701901.

B/O - BLACK LEGEND ON ORANGE BACKGROUND.
B/W - BLACK LEGEND ON WHITE BACKGROUND.

SIGN SPACING MAY BE ADJUSTED TO SUIT FIELD CONDITIONS.

L/R INDICATES LEFT OR RIGHT.

SIGNS NOT IN USE TO BE DROPPED OR BAGGED.

SIGNAGE SHOWN IS A SUGGESTED MINIMUM. COUNTY HAS THE RIGHT TO REQUEST ADDITIONAL SIGNAGE WITH NO ADDITIONAL COMPENSATION FOR CONTRACTOR.

SIGN SPACING ON CH 2 BETWEEN CH 14 AND AIRPORT RD. SHALL BE IN ACCORDANCE WITH BLR 21-9.

TYPE III BARRICADES AND R11-4-6030 SIGNS SHALL BE POSITIONED AS SHOWN IN THE "ROAD CLOSED TO ALL TRAFFIC" DETAIL ON HIGHWAY STANDARD 701901. IF THE DISTANCE "D" EXCEEDS 2000', AN ADDITIONAL SET OF BARRICADES AND R11-4-6030 SHALL BE PLACED AT EACH END OF THE WORK AREA.

TWO TYPE A LOW INTENSITY FLASHING LIGHTS SHALL BE USED ON EACH APPROACH IN ADVANCE OF THE WORK AREA. ONE LIGHT SHALL BE INSTALLED ABOVE EACH BARRICADE. IF ONLY ONE BARRICADE IS REQUIRED, THE OTHER LIGHT SHALL BE INSTALLED ABOVE THE FIRST ADVANCE WARNING SIGN.

ALL WARNING SIGNS SHALL HAVE MINIMUM DIMENSIONS OF 36"x36" AND HAVE A BLACK LEGEND ON AN ORANGE REFLECTORIZED BACKGROUND.

WHEN FLUORESCENT SIGNS ARE USED, ORANGE FLAGS ARE NOT REQUIRED.

LONGITUDINAL DIMENSIONS MAY BE ADJUSTED TO FIT FIELD CONDITIONS.

FILE NAME *	USER NAME * Sflughes	DESIGNED - BAN	REVISED -	FULTON COUNTY HIGHWAY DEPARTMENT	CH 2 (FAS RTE 452) DETOUR PLAN	SCALE: N/A	SHEET NO. 1 OF 1 SHEETS	STA. N/A	TO STA. N/A	F.A.S. RTE. 452	SECTION 14-00130-15-DR	COUNTY FULTON	TOTAL SHEETS 8	SHEET NO. 5	
V:\3715 - Fulton Cnty - Slope Failure - PH	H:\CADD\CADD Sheets\043715-shr-staging.dgn	DRAWN - SRH	REVISED -			CONTRACT NO. 89669									
	PLDT SCALE * 2,000' / in.	CHECKED - WSL	REVISED -			ILLINOIS FED. AID PROJECT									
	PLDT DATE * 6/15/2015	DATE - 5/5/15	REVISED -												

DATE	
BY	
FINAL SURVEY	
PLOTTED	
NOTE BOOK	
NO.	

DATE	
BY	
ORIGINAL SURVEY	
PLOTTED	
NOTE BOOK	
NO.	

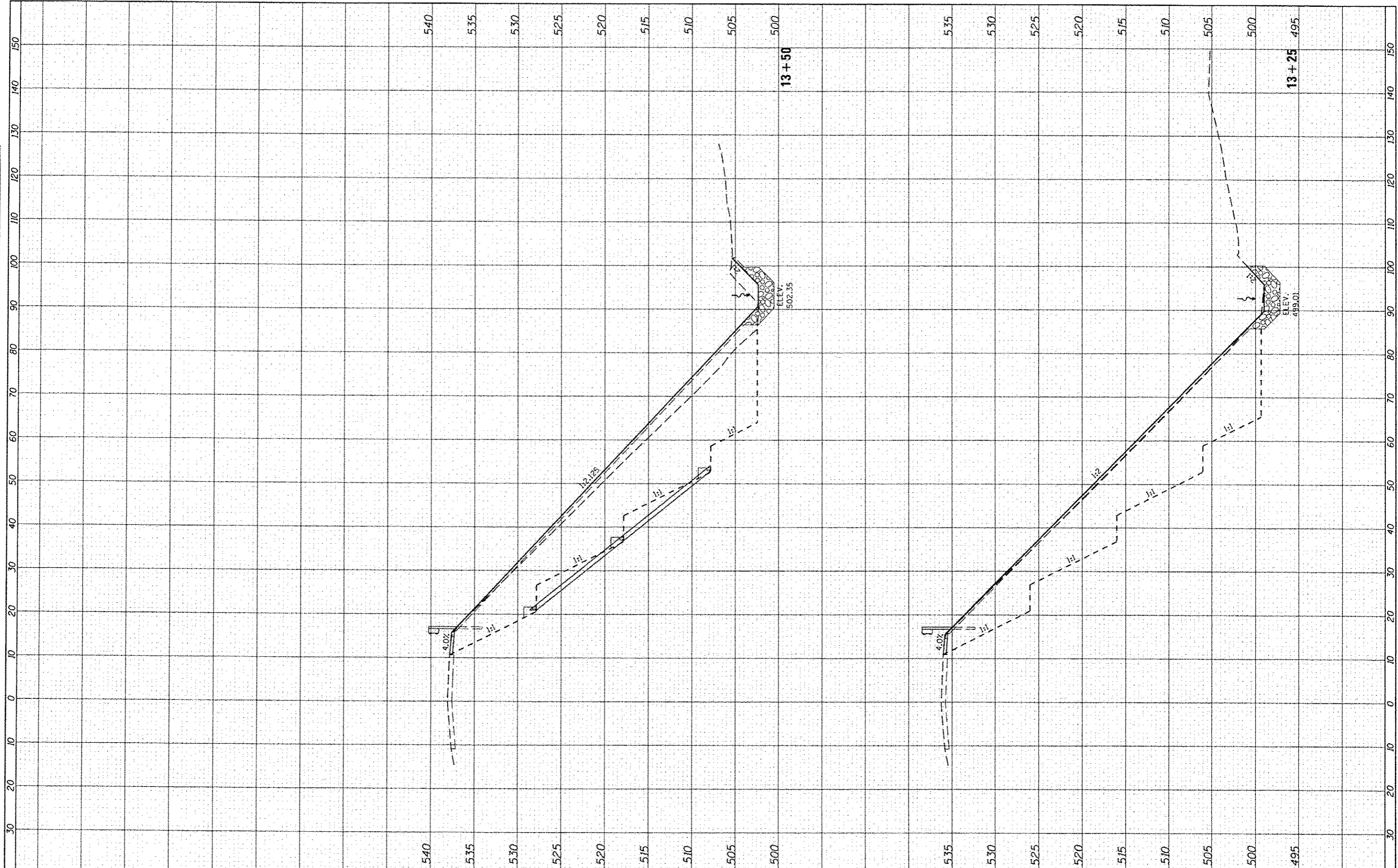

FILE NAME V:\3715 - Fulton Cnty - Slope Failure - PH 11\CA00\CA00 Sheets\143715-shf-wash-Edgn	USER NAME Shughes	DESIGNED BAN	REVISED	FULTON COUNTY HIGHWAY DEPARTMENT	CH 2 (FAS RTE 452) CROSS SECTIONS	F.A.S. RTE. 452	SECTION 14-00130-15-DR	COUNTY FULTON	TOTAL SHEETS 8	SHEET NO. 6	
Default	PLT SCALE 20:800 @ 1/8" = 1'	DRAWN SRH	REVISED			SCALE: H=10 V=5	SHEET 1 OF 3 SHEETS	STA. 13+25 TO STA. 13+50	CONTRACT NO. 89669		
	PLT DATE 6/15/2015	CHECKED WSL	REVISED						ILLINOIS FED. AID PROJECT		
		DATE 5/8/15	REVISED								

FINAL SURVEY	CHECKED
NOTE BOOK	PLOTTED
NO.	AREAS
	CHECKED

ORIGINAL SURVEY	CHECKED
NOTE BOOK	PLOTTED
NO.	AREAS
	CHECKED

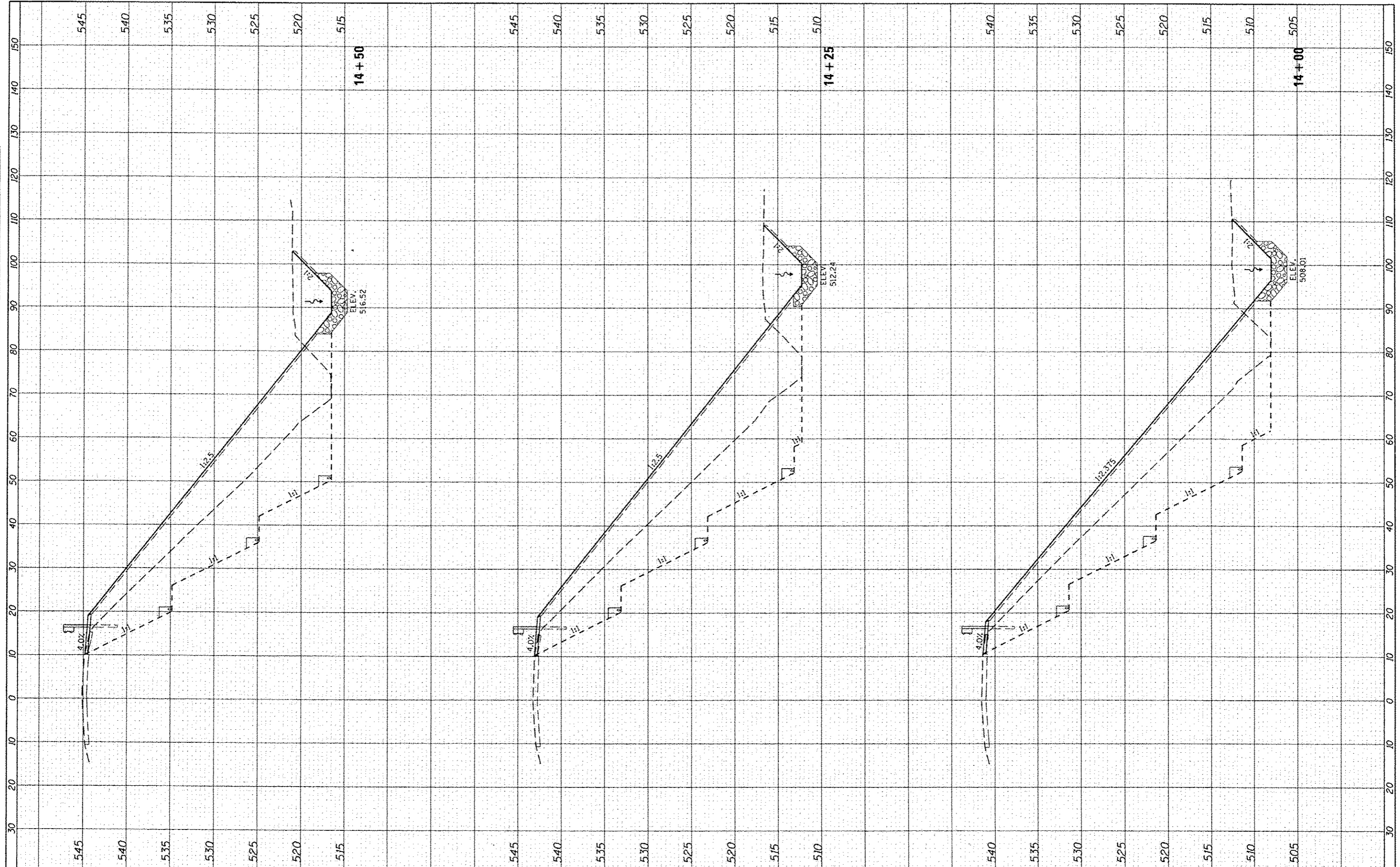

FILE NAME : V:\3715 - Fulton Cnty - Slope Failure - PH I\ACAD\CADD Sheets\043715-shf-xash.dgn	USER NAME : Shughes	DESIGNED - BAN	REVISED -	FULTON COUNTY HIGHWAY DEPARTMENT	CH 2 (FAS RTE 452) CROSS SECTIONS	F.A.S. RTE. 452	SECTION 14-00130-15-DR	COUNTY FULTON	TOTAL SHEETS 8	SHEET NO. 7		
Default	PLOT SCALE : 28,8000 / 1"	CHECKED - WSL	REVISED -			SCALE: H=10 V=5	SHEET 2	OF 3	SHEETS	STA. 14+00	TO STA. 14+50	CONTRACT NO. 89669
	PLOT DATE : 6/15/2015	DATE - 5/8/15	REVISED -			ILLINOIS FED. AID PROJECT						

FINAL SURVEY	DATE
SURVEYED	BY
PLOTTED	
NOTE BOOK	
AREAS CHECKED	
NO.	

ORIGINAL SURVEY	DATE
SURVEYED	BY
PLOTTED	
NOTE BOOK	
AREAS CHECKED	
NO.	

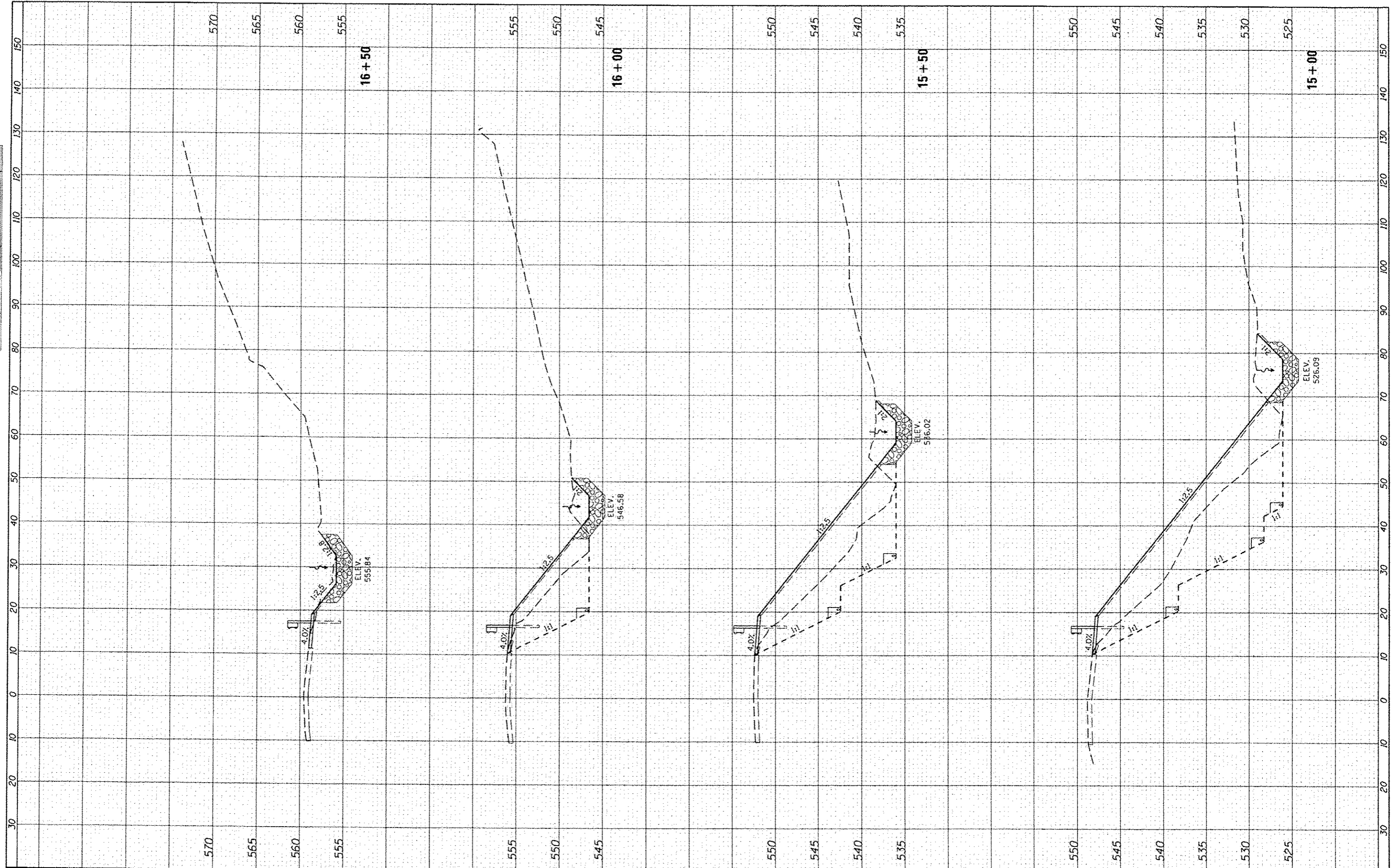

FILE NAME :
 V:\3715 - Fulton Cnty - Slope Failure - PH I\GADD\GADD Sheets\043715-ahf-ssht.dgn
 Default

USER NAME : Shughes
 PLOT SCALE : 20,0000' / 1" =
 PLOT DATE : 6/15/2015

DESIGNED - BAN
 DRAWN - SRH
 CHECKED - WSL
 DATE - 5/8/18

REVISED -
 REVISED -
 REVISED -
 REVISED -

**FULTON COUNTY
 HIGHWAY DEPARTMENT**

**CH 2 (FAS RTE 452)
 CROSS SECTIONS**

SCALE: H=10 V=5 SHEET 3 OF 3 SHEETS STA. 15+00 TO STA. 16+50

F.A.S. RTE.	SECTION	COUNTY	TOTAL SHEETS	SHEET NO.
452	14-00130-15-DR	FULTON	8	8
CONTRACT NO. 89669			ILLINOIS FED. AID PROJECT	