

INDEX OF SHEETS

SHEET NO.	TITLE
1	COVER SHEET
2	SUMMARY OF QUANTITIES, GENERAL NOTES, & TYPICAL SECTION
3	PLAN AND PROFILE
4	BOX CULVERT DETAILS
5 - 8	CROSS SECTIONS

STATE OF ILLINOIS
DEPARTMENT OF TRANSPORTATION
DIVISION OF HIGHWAYS

PLANS FOR PROPOSED
SURFACE TRANSPORTATION/RURAL PROGRAM
HANCOCK COUNTY
F.A.S. 1423
SECTION 14-00073-00-BR
JOB NO. C-96-215-14
PROJECT NO. BRS-1423(104)

ROUTE NO.	SECTION	COUNTY	TOTAL SHEETS	SHEET NO.
F.A.S. 1423	14-00073-00-BR	HANCOCK	8	1
ILLINOIS				

CONTRACT: 93656



LOCATION OF SECTION INDICATED THIS: —

UTILITIES

FRONTIER COMM. 217-243-0259

TOLL FREE JOINT UTILITY LOCATING INFORMATION FOR EXCAVATORS (J.U.L.I.E.) TELEPHONE NUMBER 1-800-892-0123

STA. 703+16 - PRECAST CONCRETE BOX CULVERT, SINGLE BARREL 11' X 8' X 50', 0° SKEW EXISTING S.N. 034-3030 PROPOSED S.N. NONE

HIGHWAY STANDARDS

280001-07 TEMPORARY EROSION CONTROL SYSTEMS
701901-04 TRAFFIC CONTROL DEVICES
BLR 21-9 TYPICAL APPLICATION OF TRAFFIC CONTROL DEVICES FOR CONSTRUCTION ON RURAL LOCAL HIGHWAYS

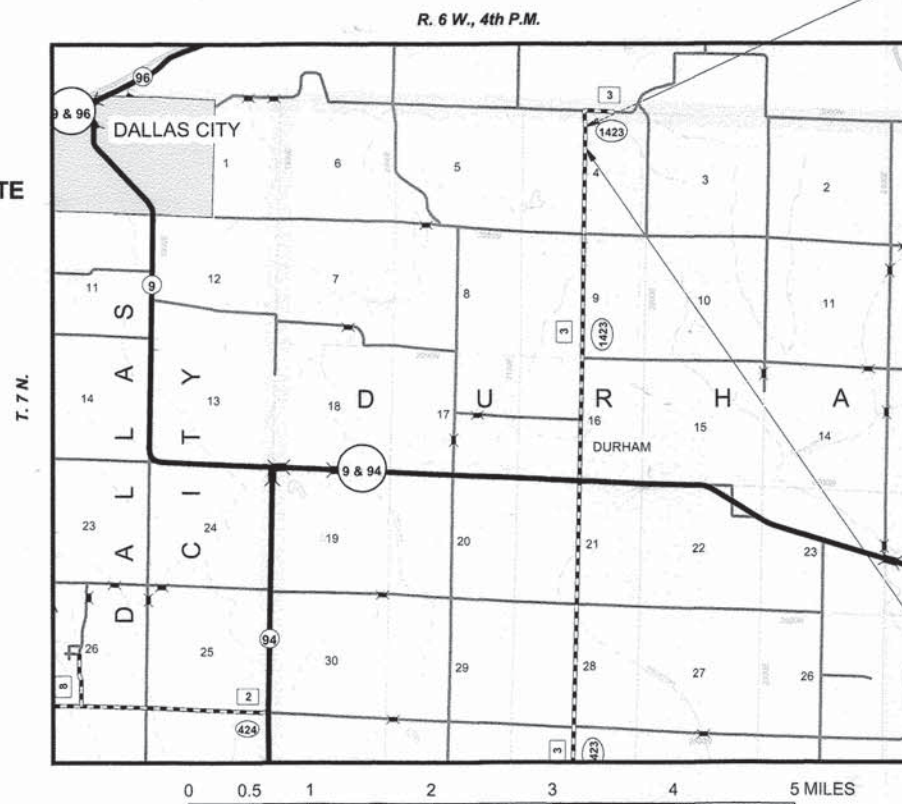

LOCATION PLAN

IMPROVEMENT ENDS STA. 703+50

IMPROVEMENT BEGINS STA. 702+00

SCALES



GROSS & NET LENGTH OF SECTION = 0.028 MI.
HIGHWAY CLASS: MAJOR COLLECTOR (NON-URBAN)

DESIGN GUIDELINES: 3R
DESIGN SPEED: 30 MPH
CURRENT ADT: 50

I HEREBY CERTIFY THAT THESE PLANS WERE PREPARED BY ME OR UNDER MY DIRECT PERSONAL SUPERVISION AND THAT I AM A DULY LICENSED PROFESSIONAL ENGINEER IN ACCORDANCE WITH THE LAWS OF THE STATE OF ILLINOIS.
Elgin L. Berry 5/18/2015
ELGIN L. BERRY LICENSE # 062-057924 EXPIRES 11/30/2015

APPROVED 5/18 20 15
Elgin Berry
COUNTY ENGINEER

PASSED June 13, 2015 20
Susan Anderson
DISTRICT SIX ENGINEER OF LOCAL ROADS & STREETS

PASSED July 13 20 15
Ron Wehman
DISTRICT SIX ENGINEER OF CONSTRUCTION

Releasing For Bid Based on Limited Review June 13 20 15
Roger A. Orskell
DEPUTY DIRECTOR OF HIGHWAYS, REGION FOUR ENGINEER
STATE OF ILLINOIS
DEPARTMENT OF TRANSPORTATION

CONTRACT: _____

ROUTE NO.	SECTION	COUNTY	TOTAL SHEETS	SHEET NO.
F.A.S 1423	14-00073-00-BR	HANCOCK	8	2
		ILLINOIS		

SUMMARY OF QUANTITIES

CODE	ITEM	UNIT	QUANTITY
20200100	EARTH EXCAVATION	CU. YD.	27
20400800	FURNISHED EXCAVATION	CU YD	155
20700110	POROUS GRANULAR EMBANKMENT	TON	285
* X2501000	SEEDING, CLASS 2 (SPECIAL)	ACRE	0.1
28000250	TEMPORARY EROSION CONTROL SEEDING	POUND	12
28000400	PERIMETER EROSION BARRIER	FOOT	260
28100807	STONE DUMPED RIPRAP, CLASS A4	TON	230
40200800	AGGREGATE SURFACE COURSE, TYPE B	TON	152
50100100	REMOVAL OF EXISTING STRUCTURES	EACH	1
50200100	STRUCTURE EXCAVATION	CU YD	229
50300225	CONCRETE STRUCTURES	CU YD	3
54001001	BOX CULVERT END SECTION CULVERT #1	EACH	2
54011108	PRECAST CONCRETE BOX CULVERT, 11 X 8	FOOT	50
63200310	GUARDRAIL REMOVAL	FOOT	250
67100100	MOBILIZATION	L SUM	1
* X2070304	POROUS GRANULAR EMBANKMENT, (SPECIAL)	CU YD	117
* X7010216	TRAFFIC CONTROL AND PROTECTION, (SPECIAL)	L SUM	1

* SEE SPECIAL PROVISIONS

CONSTRUCTION TYPE CODE:

GENERAL NOTES

WHERE SECTION OR SUBSECTION MONUMENTS ARE ENCOUNTERED, THE ENGINEER SHALL BE NOTIFIED BEFORE SUCH MONUMENTS ARE REMOVED. THE CONTRACTOR SHALL PROTECT AND CAREFULLY PRESERVE ALL PROPERTY MARKERS AND MONUMENTS UNTIL THE OWNER, AN AUTHORIZED SURVEYOR, OR AGENT, HAS WITNESSED OR OTHERWISE REFERENCED THEIR LOCATION.

ALL EROSION PROTECTION TO BE PLACED AS DIRECTED BY THE ENGINEER.

ALL ELEVATIONS SHOWN REFER TO AN U.S.G.S MEAN SEA LEVEL DATUM.

ALL EXISTING ROAD SIGNS THAT CONFLICT WITH THE PROPOSED WORK ZONE TRAFFIC CONTROL MEASURES SHALL BE REMOVED OR COVERED AS DIRECTED BY THE ENGINEER.

ALL EXISTING UTILITIES REQUIRING ADJUSTMENT WILL BE MADE BY THE UTILITY COMPANY INVOLVED. THE LOCATION OF THE UNDERGROUND UTILITIES SHOWN ON THE PLANS REPRESENTS THE BEST KNOWLEDGE OF THE COUNTY. IT SHALL BE THE CONTRACTOR'S RESPONSIBILITY TO VERIFY LOCATIONS OF UNDERGROUND INSTALLATIONS BEFORE STARTING CONSTRUCTION OPERATIONS.

THE NOTED APPLICATION RATES ARE FOR QUANTITY CALCULATIONS ONLY. THE APPLICATION RATE TO BE APPLIED WILL BE DETERMINED BY THE ENGINEER AT THE TIME OF PLACEMENT.

ALL WASTE OR UNDESIRABLE MATERIALS AS IDENTIFIED BY THE ENGINEER SHALL BE DISPOSED OF OUTSIDE THE LIMITS OF THE RIGHT OF WAY AT THE CONTRACTORS EXPENSE IN ACCORDANCE WITH ALL APPLICABLE FEDERAL, STATE AND LOCAL LAWS, RULES, REGULATIONS AND ORDINANCES PERTAINING TO WASTE DISPOSAL.

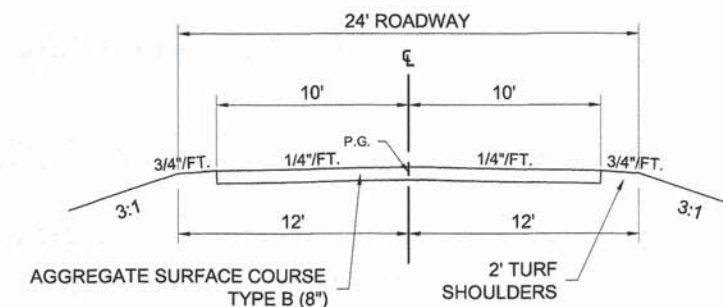
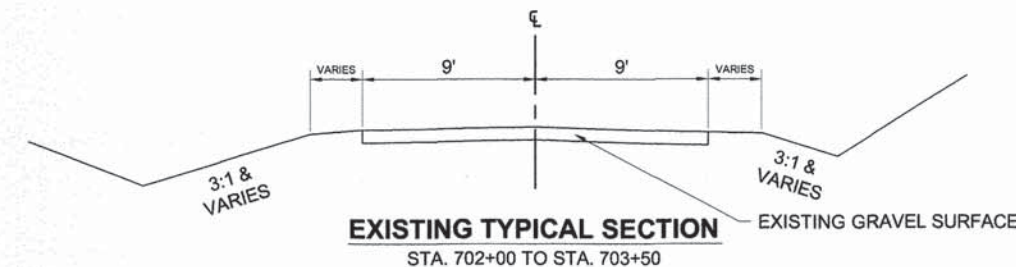

PROPOSED TYPICAL SECTION

STA. 702+00 TO STA. 702+75

TRANSITION: STA. 702+50 - 702+75

EARTHWORK SCHEDULE

STATION TO STATION	EXCAVATION QUANTITY (CU. YD.)	SHRINKAGE (%)	EXCAVATION AVAILABLE (CU. YD.)	EMABANKMENT (CU. YD.)	WASTE (+) SHORT (-)
702+00 -702+75	7	25	6	34	-28
703+00 -703+50	20	25	15	314	-299
TOTAL	27			348	-327
STRUC. EXC.	229	25	172		-155
FURN. EXC.					155

EARTHWORK NOTES

PRIOR TO REMOVING THE EXISTING STRUCTURE, A 35' LONG X 18' WIDE X 5' DEEP SECTION OF THE EXISTING ROADWAY SURFACE SHALL BE REMOVED FROM STATION 703+00 - 703+35 AND STOCKPILED ON SITE. THIS MATERIAL SHALL BE CLASSIFIED AS POROUS GRANULAR EMBANKMENT (SPECIAL) AND SHALL BE USED AS BACKFILL IN THE AREA BENEATH THE PROPOSED ROADWAY.

AFTER THE EXISTING STRUCTURE IS REMOVED, ALL REMAINING EXCAVATION REQUIRED TO CONSTRUCT THE PROPOSED CULVERT TO THE LINES AND GRADES SHOWN ON THE PLANS SHALL BE CONSIDERED STRUCTURE EXCAVATION. THE STRUCTURE EXCAVATION MATERIAL SHALL BE USED AS BACKFILL BENEATH THE TURF SHOULDERS AND DITCH FORESLOPES.

POROUS GRANULAR EMBANKMENT (P.G.E) THAT MEETS THE REQUIREMENTS OF SECTION 207 OF THE STANDARD SPECIFICATIONS SHALL BE PLACED AS BEDDING BENEATH THE PROPOSED BOX CULVERT AND AS BACKFILL IN THE REMAINING LIMITS OF THE BACKFILL AREA BENEATH THE PROPOSED ROADWAY, INCLUDING THE EXCAVATION LIMITS FROM REMOVING THE EXISTING BRIDGE.

FURNISHED EXCAVATION SHALL BE A SUITABLE CLAY MATERIAL TO CONSTRUCT THE TURF SHOULDERS AND SEAL THE DITCH FORESLOPES ALONG BOTH ENDS OF THE PROPOSED BOX CULVERT.

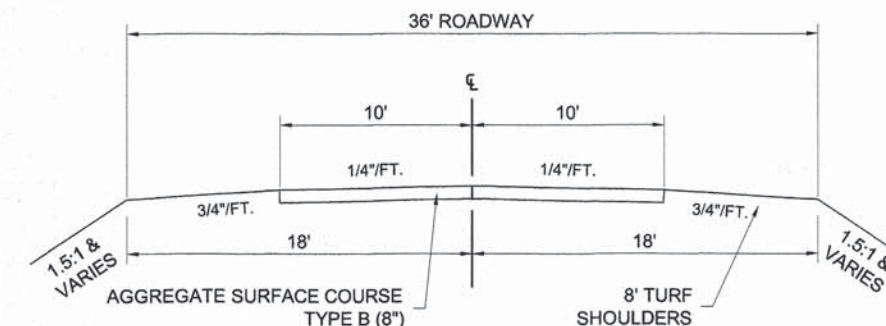

PROPOSED TYPICAL SECTION

STA. 702+75 TO STA. 703+50

TRANSITION: STA. 702+50 - 702+75

APPLICATION RATES USED IN QUANTITY CALCULATIONS

STONE RIPRAP, CLASS A4 = 1.65 TON / CY
 AGGREGATE BASE AND SURFACE COURSES = 2.05 TON / CY
 POROUS GRANULAR EMBANKMENT = 2.05 TON / CY

TOTAL VOLUME TABLE

Station	Cut Area	Fill Area	Cut Vol	Fill Vol	Cum Cut Vol	Cum Fill Vol
702+00	0	0	0	0	0	0
702+25	4	6	2	3	2	3
702+50	1	24	2	14	4	17
702+71	3	14	2	15	6	32
702+75	12	20	1	3	7	34
703+00	17	41	13	28	20	63
703+16	2	314	5	105	26	168
703+25	2	204	1	86	26	254
703+50	0	0	1	95	27	348

SUMMARY OF QUANTITIES, GENERAL NOTES, & TYPICAL SECTIONS
 SECTION 14-00073-00-BR
 F.A.S. 1423 (C.H. 30)
 AT WEAVER CREEK
 HANCOCK COUNTY

101 S. FIRST ST. (P.O. BOX 379)
 CARTHAGE, IL 62321
 (217) 357-3155

HANCOCK COUNTY
 HIGHWAY DEPARTMENT

ROUTE NO.	SECTION	COUNTY	TOTAL SHEETS	SHEET NO.
F.A.S. 1423	14-00073-00-BR	HANCOCK	8	3
		ILLINOIS		

NW 1/4, SEC. 4, T.7N., R.6W., 4th P.M.
 RUBY BURKHART
 & KATHARINA HOEMMEN

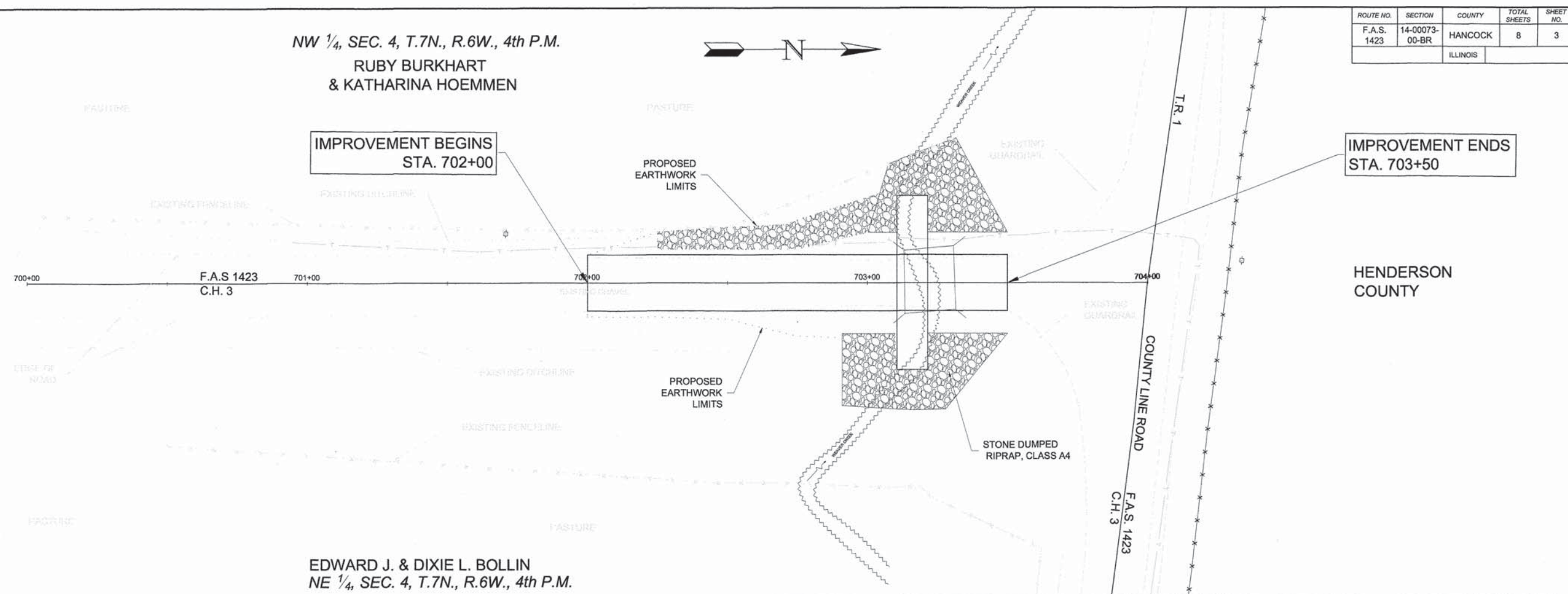

IMPROVEMENT ENDS
 STA. 703+50

HENDERSON
 COUNTY

EXISTING STRUCTURE
 STA. 703+22
 STR. NO. 034-3030
 SINGLE SPAN REINFORCED
 CONCRETE SLAB
 ON CLOSED CONCRETE
 ABUTMENTS
 20' BK. TO BK. OF ABUTMENTS
 SKEW=0°
 REMOVAL OF EXISTING
 STRUCTURES = 1 EACH.

PROPOSED STRUCTURE
 STA. 703+16
 CULVERT #1
 PRECAST CONCRETE
 BOX CULVERT
 SINGLE BARREL
 11' X 8' X 50'
 SKEW=0°
 PRECAST CONCRETE
 BOX CULVERT END SECTIONS
 FOR CULVERT #1
 2 EACH

EDWARD J. & DIXIE L. BOLLIN
 NE 1/4, SEC. 4, T.7N., R.6W., 4th P.M.

B.M. #1
 NAIL IN POWER POLE
 STA. 699+04, 19' LT.
 ELEV. 628.28'

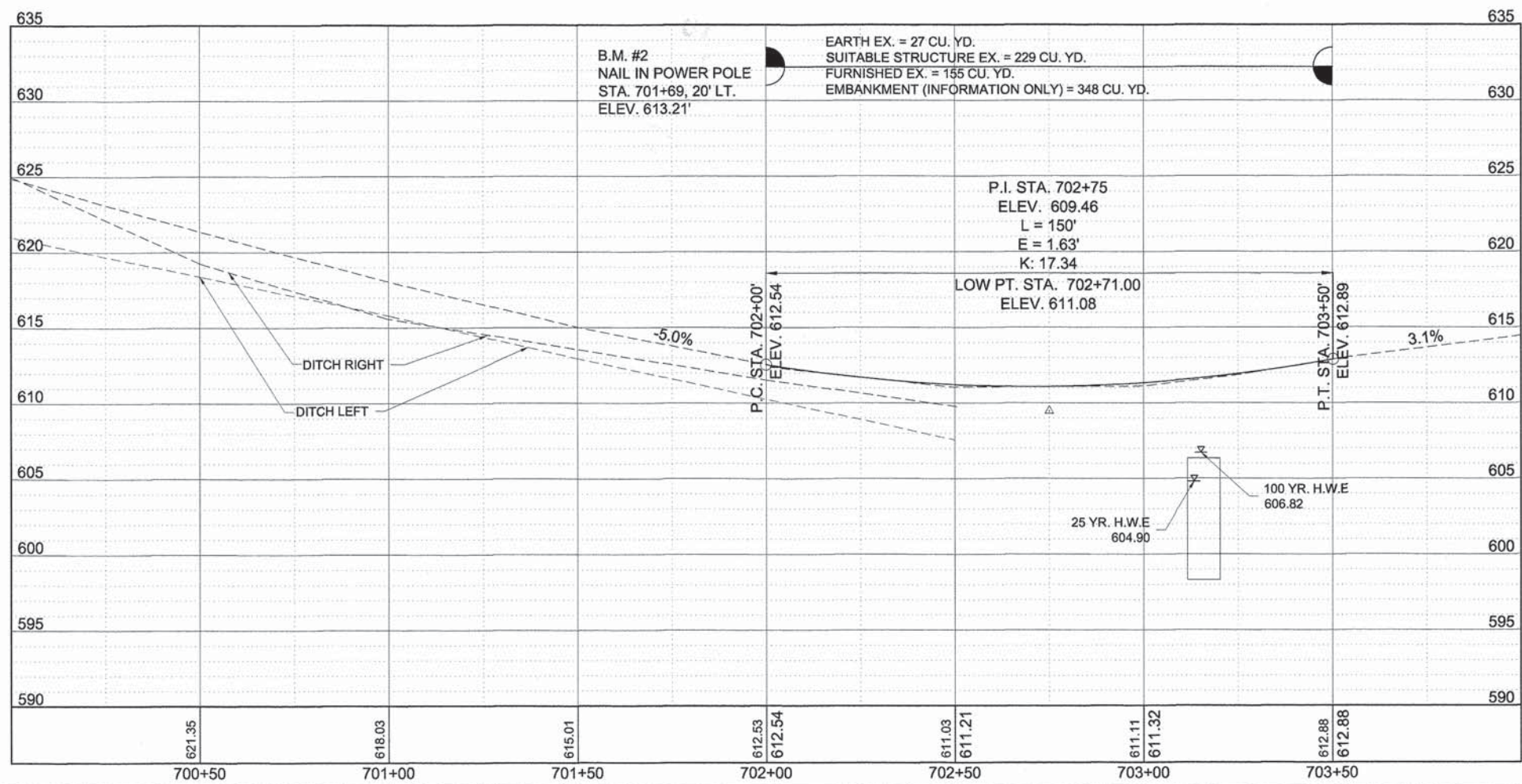

B.M. #2
 NAIL IN POWER POLE
 STA. 701+69, 20' LT.
 ELEV. 613.21'

EARTH EX. = 27 CU. YD.
 SUITABLE STRUCTURE EX. = 229 CU. YD.
 FURNISHED EX. = 155 CU. YD.
 EMBANKMENT (INFORMATION ONLY) = 348 CU. YD.

B.M. #3
 NAIL IN POWER POLE
 STA. 704+32, 11' LT.
 ELEV. 616.71'

CONTROL POINT #1
 IRON PIN (FLUSH)
 STA. 696+74
 N: 1,446,288.550
 E: 2,040,562.710

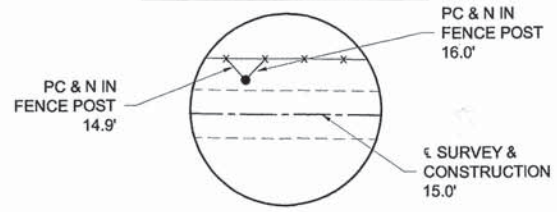

CONTROL POINT #14
 IRON PIN (FLUSH)
 STA. 704+15
 N: 1,447,027.715
 E: 2,040,520.979

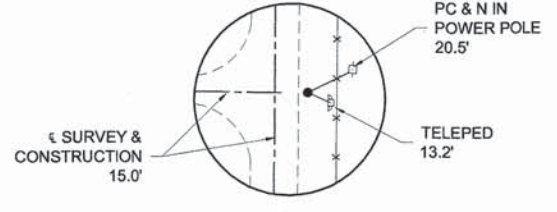

ELEVATION CULVERT #1

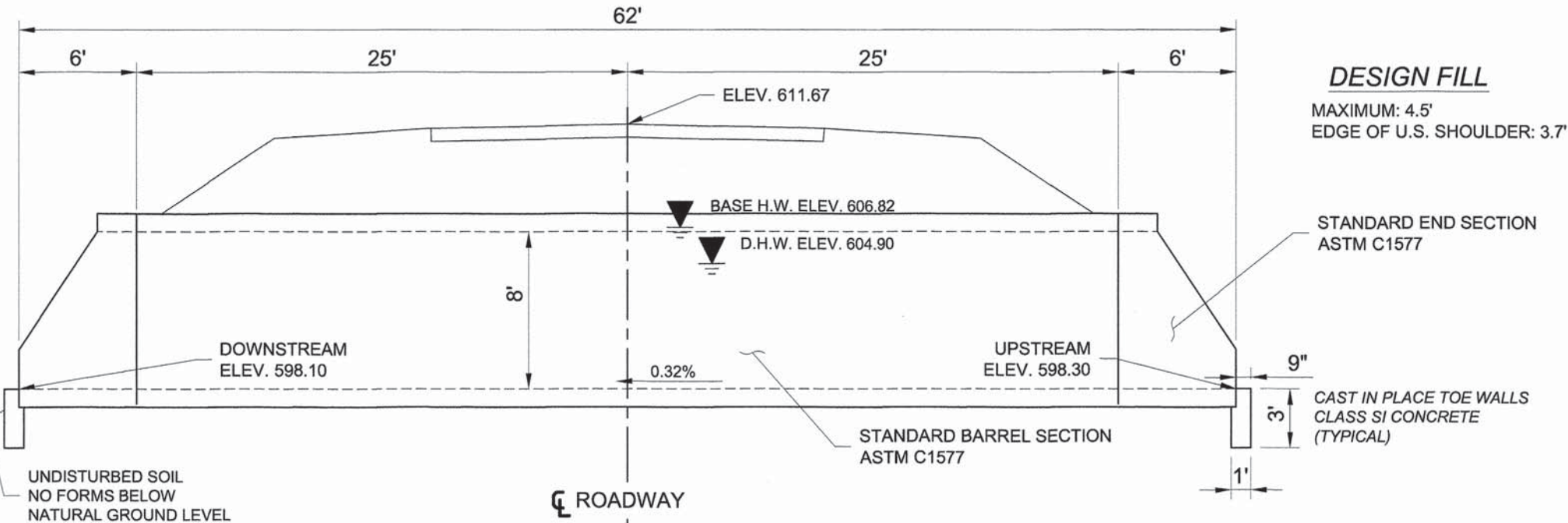

GENERAL NOTES

REINFORCEMENT BARS SHALL CONFORM TO THE REQUIREMENTS OF ASTM A 706, GR. 60.

CLASS SI CONCRETE SHALL BE USED FOR THE CONCRETE TOE WALLS CAST IN THE FIELD.

LAYOUT OF SLOPE PROTECTION SYSTEM MAY BE VARIED TO SUIT GROUND CONDITIONS IN THE FIELD AS DIRECTED BY THE ENGINEER.

EXISTING STRUCTURE REMOVAL CONSISTS OF APPROXIMATELY 70 CUBIC YARDS OF REINFORCED CONCRETE DECK, PARAPETS, ABUTMENTS, AND WINGWALLS. THE NORTH ABUTMENT AND WINGWALLS MAY BE ABANDONED IN PLACE WHEREVER THERE WILL BE AT LEAST 3 FEET OF EARTH COVER WHEN THE FINAL GRADE IS ESTABLISHED.

SECTION THRU BARREL CULVERT #1

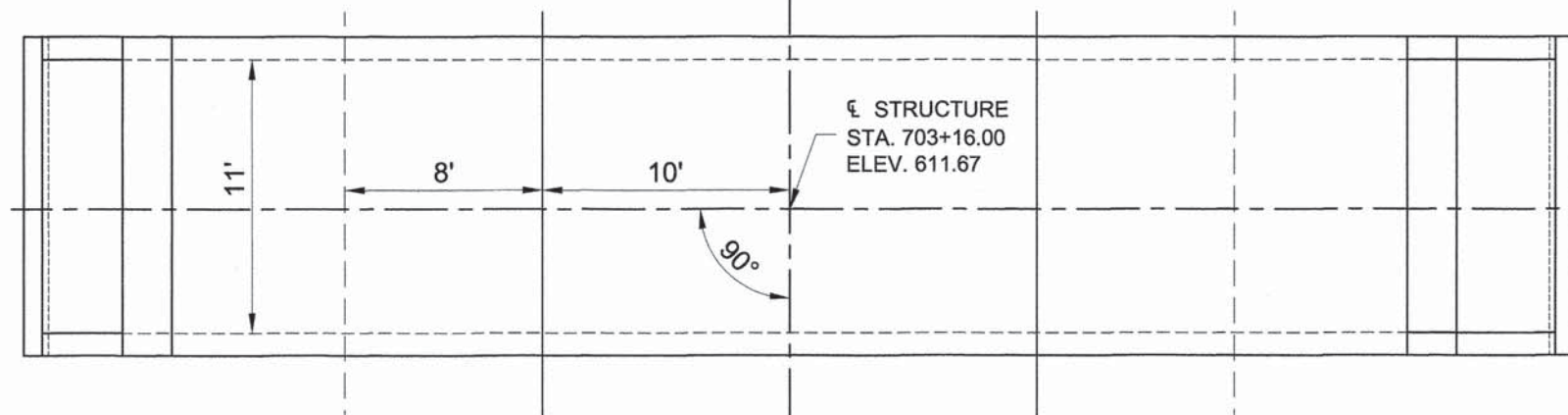
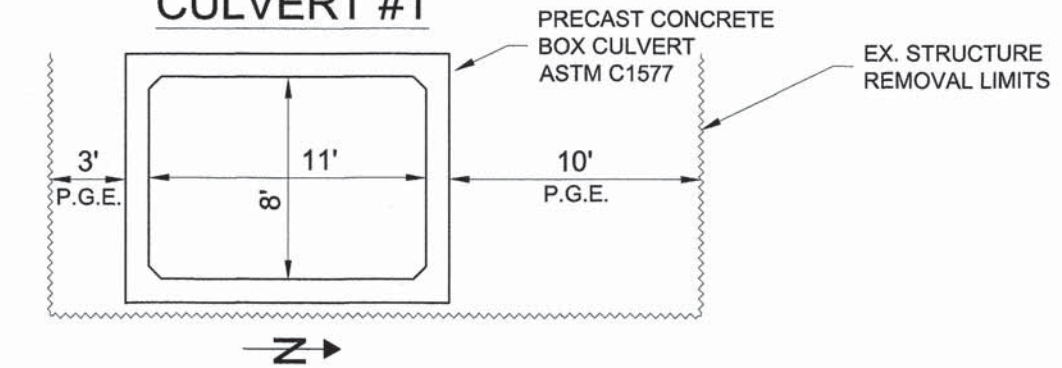

DESIGN SCOUR ELEVATION TABLE

DESIGN SCOUR ELEVATION (FT.)	DOWNSTREAM	UPSTREAM
		595.10

WATERWAY INFORMATION

DRAINAGE AREA = 0.59 SQ. MI.			EXISTING OVERTOPPING ELEVATION: 610.8 AT 702+75		PROPOSED OVERTOPPING ELEVATION: 611.08 AT 702+71				
FLOOD	FREQUENCY YEAR	DISCHARGE CFS	WATERWAY OPENING (SQ. FT.)		NATURAL H.W.E	HEAD (FT)		HEADWATER ELEV. FT.	
			EXISTING	PROPOSED		EXISTING	PROPOSED	EXISTING	PROPOSED
	10	370	40.31	57.97	604.05	0.62	0.00	604.67	603.57
DESIGN	25	505	51.14	72.60	604.87	0.63	0.03	605.50	604.90
BASE	100	724	65.47	88.00	606.02	1.42	0.80	607.44	606.82
OVT (E)	>500	UNK.	N/A	N/A	N/A	NOT CALC.	NOT CALC.	NOT CALC.	NOT CALC.
OVT (P)	>500	UNK.	N/A	N/A	N/A	NOT CALC.	NOT CALC.	NOT CALC.	NOT CALC.
MAX CALC.	500	1000	80.46	88.00	607.25	0.48	2.92	607.73	610.17

BILL OF MATERIALS

POROUS GRANULAR EMBANKMENT	TON	285
POROUS GRANULAR EMBANKMENT (SP.)	CU. YD.	117
STONE DUMPED RIPRAP, CLASS A4	TON	230
REMOVE EXISTING STRUCTURE #1	EACH	1
STRUCTURE EXCAVATION	CU. YD.	229
PRECAST CONCRETE BOX CULVERT 11' X 8'	FOOT	50
BOX CULVERT END SEC., #1	EACH	2
CLASS SI CONCRETE STRUCTURES	CU. YD.	3

GENERAL PLAN & ELEVATIONS

SECTION 14-00073-00-BR
 PRECAST CONCRETE BOX CULVERT
 F.A.S. ROUTE 1423 (C.H. 30)
 AT WEAVER CREEK
 HANCOCK COUNTY

ROUTE NO.	SECTION	COUNTY	TOTAL SHEETS	SHEET NO.
F.A.S. 1423	14-00073- 00-BR	HANCOCK	8	5
		ILLINOIS		

702+25

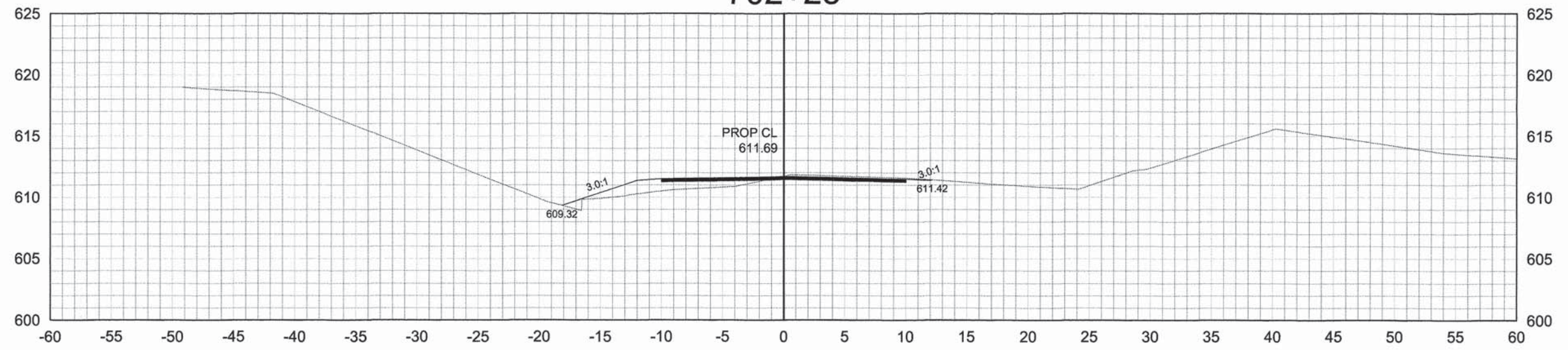

702+00

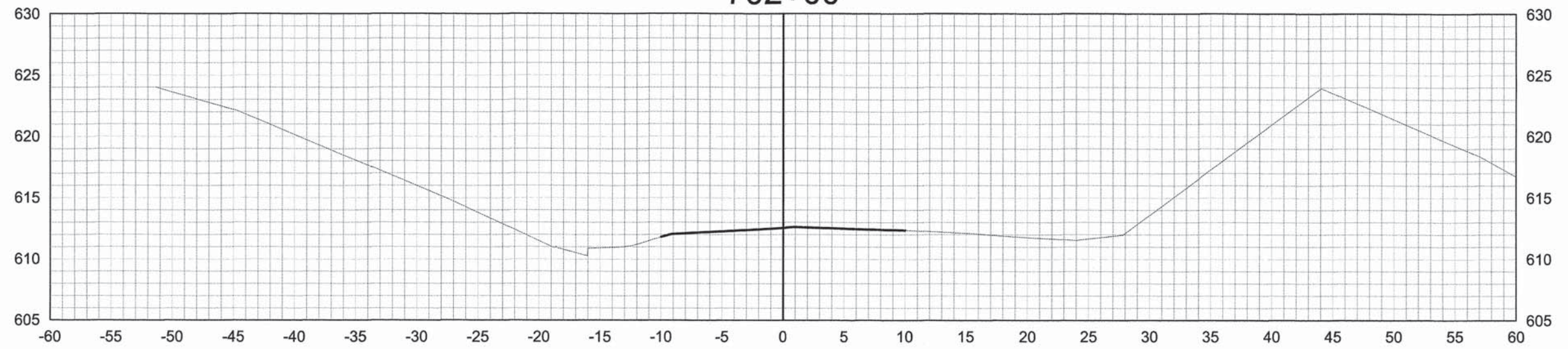

ROUTE NO.	SECTION	COUNTY	TOTAL SHEETS	SHEET NO.
F.A.S. 1423	14-00073-00-BR	HANCOCK	8	6
		ILLINOIS		

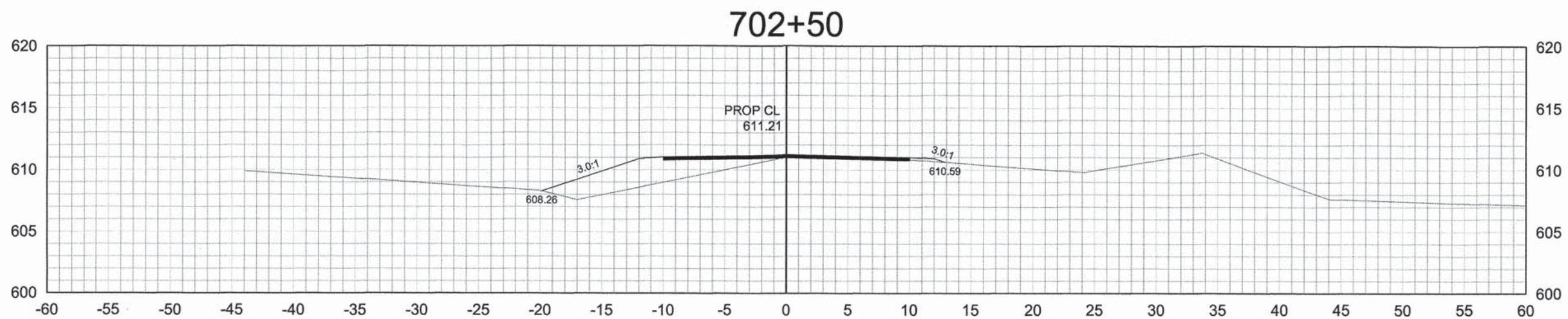
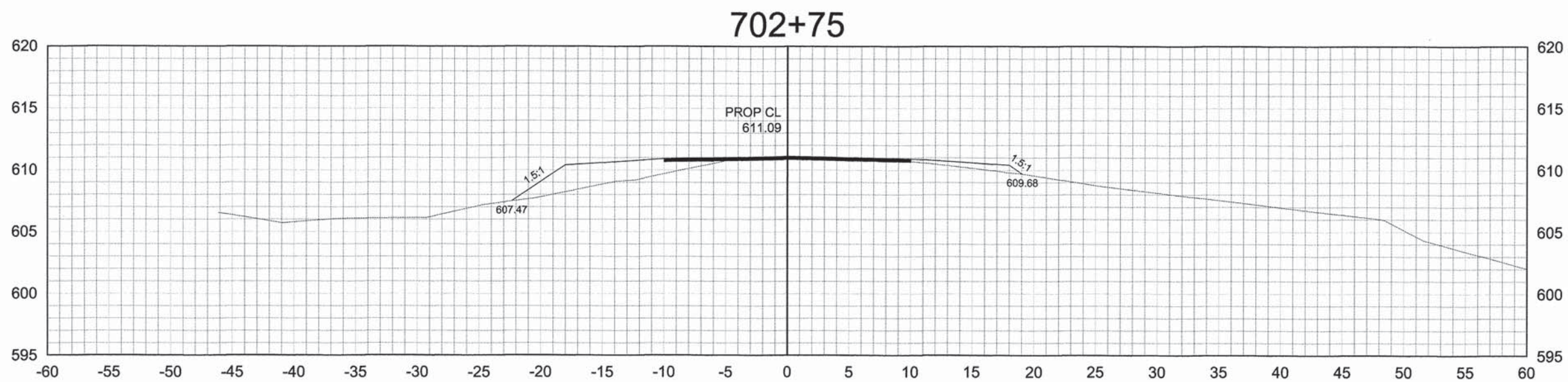

ROUTE NO.	SECTION	COUNTY	TOTAL SHEETS	SHEET NO.
F.A.S. 1423	14-00073-00-BR	HANCOCK	8	7
		ILLINOIS		

703+16

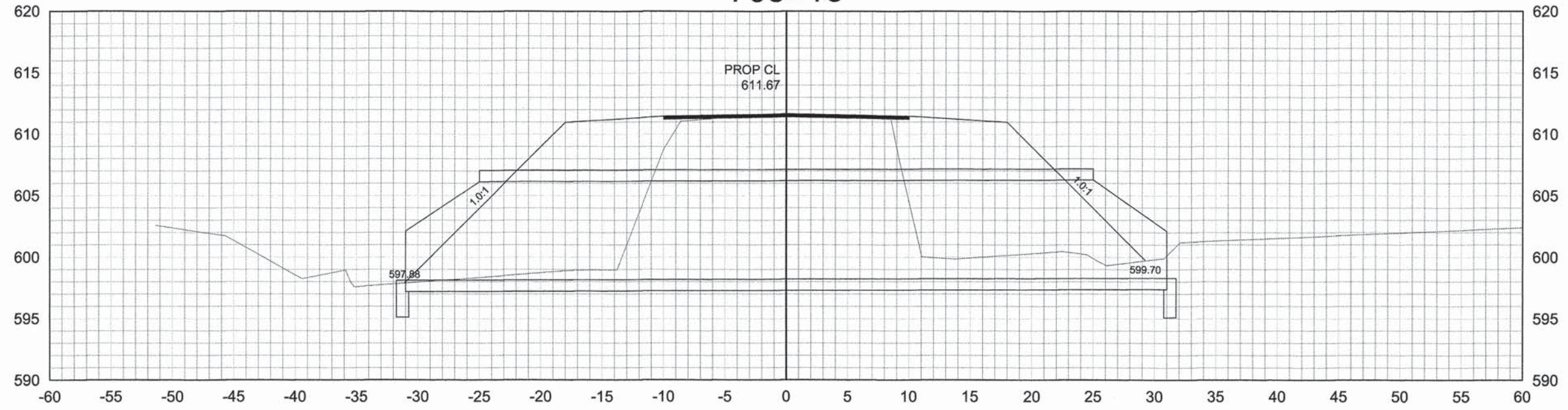

703+00

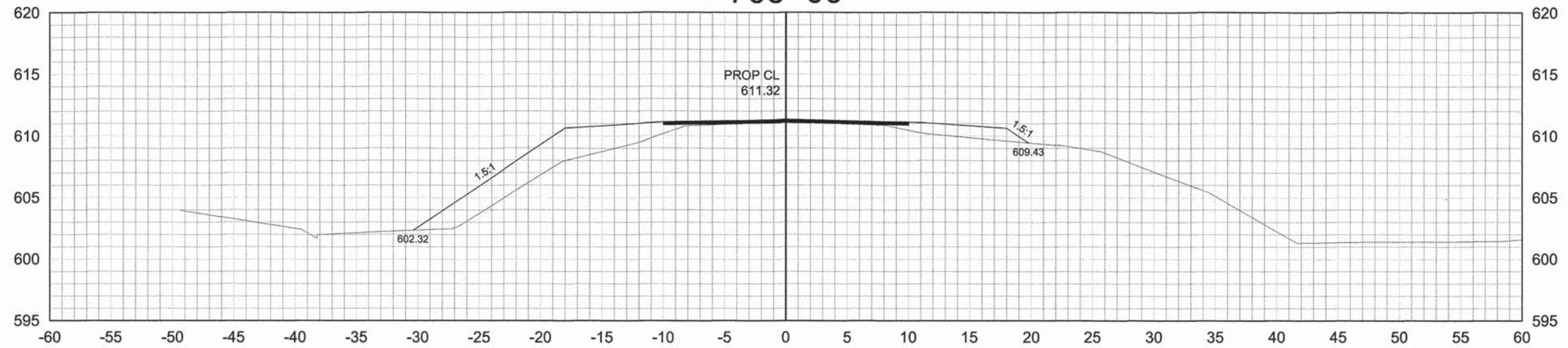

ROUTE NO.	SECTION	COUNTY	TOTAL SHEETS	SHEET NO.
F.A.S. 1423	14-00073- 00-BR	HANCOCK	8	8
		ILLINOIS		

703+50

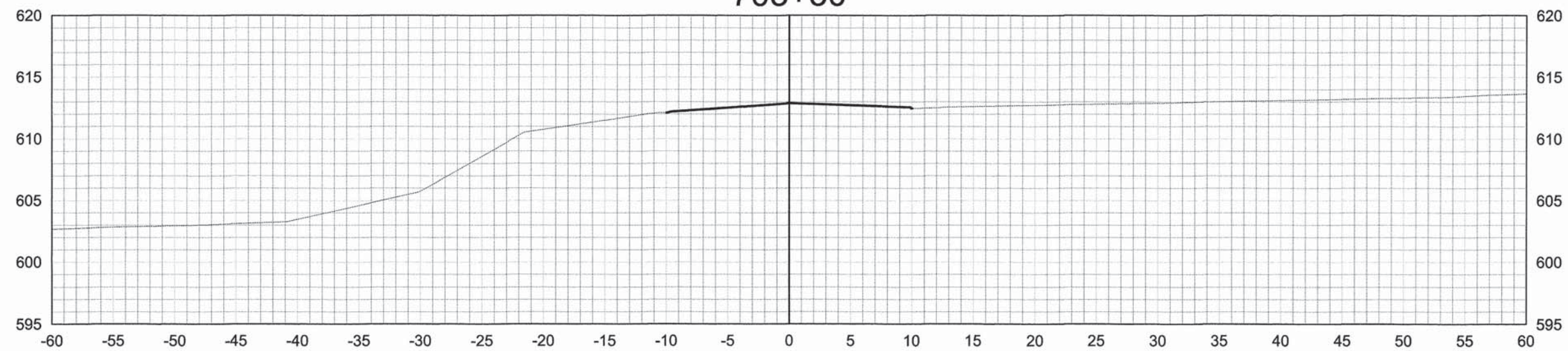

703+25

