

NOTES
 ALL SIGN PANELS ARE TYPE 1 UNLESS OTHERWISE NOTED. REFER TO PAVEMENT MARKING AND SIGNING PLANS FOR RELOCATION INFORMATION.
 THE CONTRACTOR SHALL BE RESPONSIBLE FOR THE REMOVAL AND PROPER DISPOSAL OF EXISTING ROADWAY SIGNS.
 REMOVAL OF EXISTING AGGREGATE SHOULDERS SHALL BE INCLUDED IN THE PAY QUANTITY FOR EARTH EXCAVATION.
 REMOVE EXISTING FLASHING BEACON OVER INTERSECTION WHEN STOP SIGNS AT INTERSECTION ARE REMOVED.

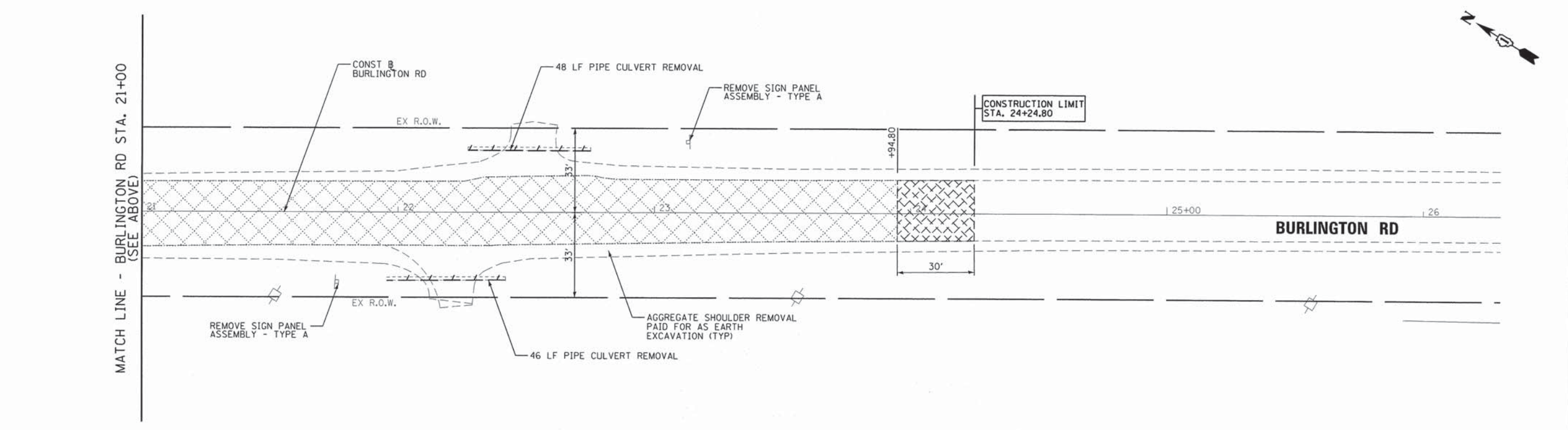
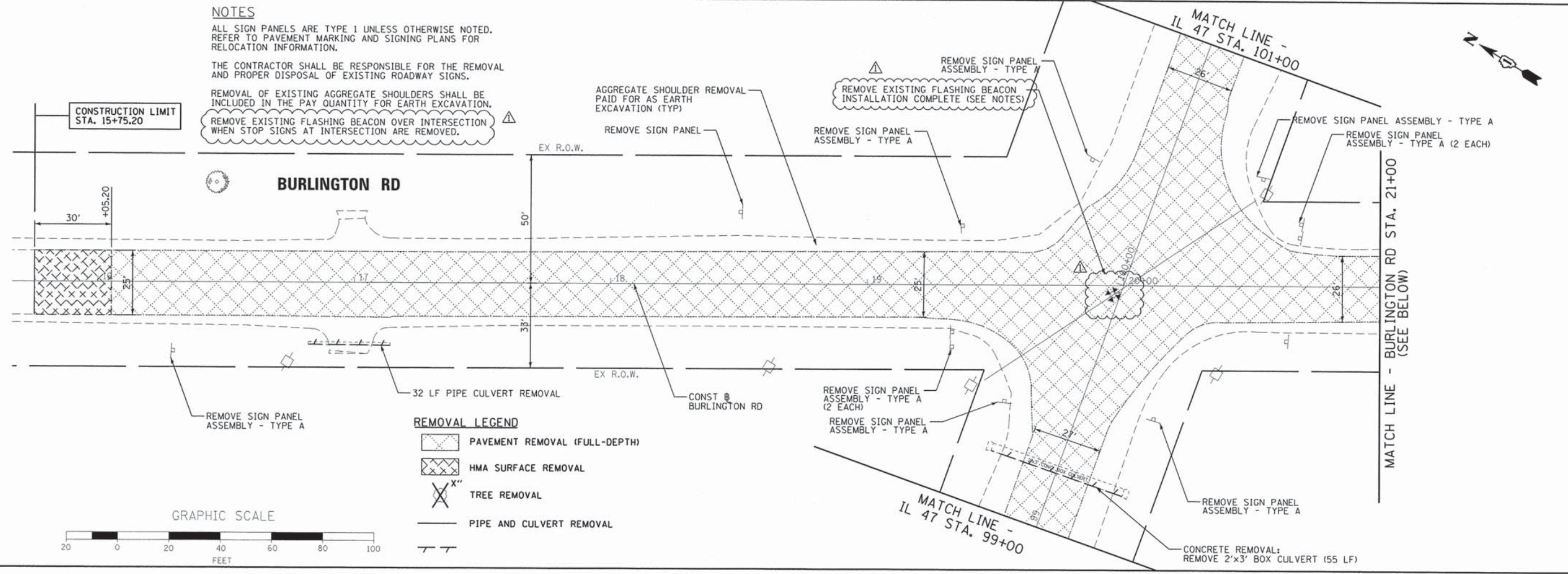

FILE NAME = 66343_rembur.dgn	USER NAME = mpapirnsk	DESIGNED - MAP	REVISED - 9/3/2015	STATE OF ILLINOIS DEPARTMENT OF TRANSPORTATION	REMOVAL PLAN - BURLINGTON ROAD		F.A.P. RTE.	SECTION	COUNTY	TOTAL SHEETS	SHEET NO.
	PLOT SCALE = 40.0000' / 1" =	CHECKED - MAP	REVISED -				326	07-00357-00-CH	KANE	80	13
	PLOT DATE = 9/2/2015	DATE - 6/17/2015	REVISED -				CONTRACT NO. 63779				

ELECTRICAL GENERAL NOTES

1. MATERIALS AND INSTALLATION METHODS SHALL COMPLY WITH CODES AND ORDINANCES OF FEDERAL, STATE AND LOCAL GOVERNING BODIES HAVING JURISDICTION.
2. MATERIAL QUANTITIES ARE APPROXIMATIONS ONLY. IT IS THE CONTRACTOR'S RESPONSIBILITY TO FIELD VERIFY ALL QUANTITIES PRIOR TO ORDERING MATERIAL.
3. GROUNDING ELECTRODE CONNECTIONS SHALL BE EXOTHERMICALLY WELDED AND SHALL BE INSPECTED AND APPROVED BY THE ENGINEER PRIOR TO BURIAL.
4. ALL CABLE AND CONDUIT SHALL BE INSTALLED MINIMUM 30 INCHES BELOW FINISHED GRADE (UNLESS DIRECTED OTHERWISE) COMPLETE WITH WARNING TAPE AT 12 INCHES BELOW GRADE.
5. CONTRACTOR TO VERIFY FOUNDATION BOLT PATTERN PRIOR TO CONSTRUCTING FOUNDATIONS. ANCHOR BOLTS SHALL BE HELD IN POSITION WITH TEMPLATES UNTIL CONCRETE IS SET.
6. CONDUCTORS SHALL BE SPLICED IN LIGHTING CONTROLLER AND LIGHT POLE BASES ONLY. NO SPLICES SHALL BE LOCATED BELOW GRADE.
7. CONDUIT SLEEVES INSTALLED UNDER ROADWAY SHALL EXTEND NO LESS THAN 5 FEET FROM OUTSIDE EDGE OF PAVED SHOULDER ON EITHER SIDE OF THE CROSSING.
8. CONDUIT RACEWAYS IN CONCRETE FOUNDATIONS SHALL BE NON-METALLIC AND SHALL EXTEND A MINIMUM OF 2 INCHES ABOVE THE TOP OF THE FOUNDATION.

[NOTE REMOVED]

PLAN DRAWING NOTES

1. EXACT LOCATION OF UTILITY POLE TO BE FIELD VERIFIED.
2. EACH FLASHING BEACON SHALL BE CONNECTED TO A DEDICATED 120V BREAKER IN THE LIGHTING CONTROLLER FOR 24-HOUR OPERATION.
3. STATION AND OFFSET GIVEN IS TO THE CENTER OF THE POLE. ALL STATIONING IS FROM THE IL 47 OR BURLINGTON ROAD CONSTRUCTION BASELINE UNLESS OTHERWISE NOTED.

SUMMARY OF LIGHTING QUANTITIES

ELECTRIC SERVICE INSTALLATION	EACH	1
ELECTRIC UTILITY SERVICE CONNECTION	L SUM	1
UNDERGROUND CONDUIT, GALVANIZED STEEL, 2 1/2" DIA.	FOOT	40
UNDERGROUND CONDUIT, GALVANIZED STEEL, 4" DIA.	FOOT	300
UNIT DUCT, 600V, 3-1C NO.8, 1/2" NO.10 GROUND, (XLP-TYPE USE), 1" DIA. POLYETHYLENE	FOOT	2,470
UNIT DUCT, 600V, 2-1C NO.8, 1/2" NO.8 GROUND, (XLP-TYPE USE), 1 1/4" DIA. POLYETHYLENE	FOOT	1,780
ELECTRIC CABLE IN CONDUIT, 600V (XLP-TYPE USE) 3-1/2" NO. 6	FOOT	70
LUMINAIRE, SODIUM VAPOR, HORIZONTAL MOUNT, 400 WATT	EACH	16
LIGHT POLE, ALUMINUM, 47.5 FT. M.H., 15 FT. MAST ARM	EACH	16
LIGHT POLE FOUNDATION, 24" DIAMETER	FOOT	152
BREAKAWAY DEVICE, TRANSFORMER BASE, 15 INCH BOLT CIRCLE	EACH	16
LIGHTING CONTROLLER, SPECIAL	EACH	1
LUMINAIRE SAFETY CABLE ASSEMBLY	EACH	16

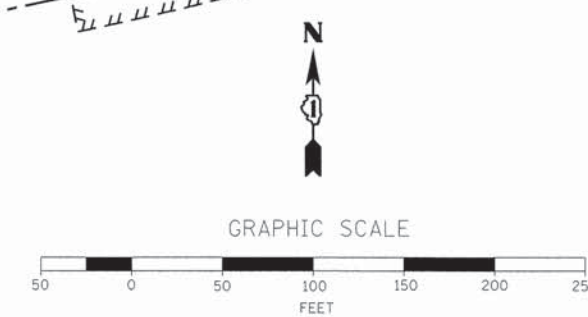
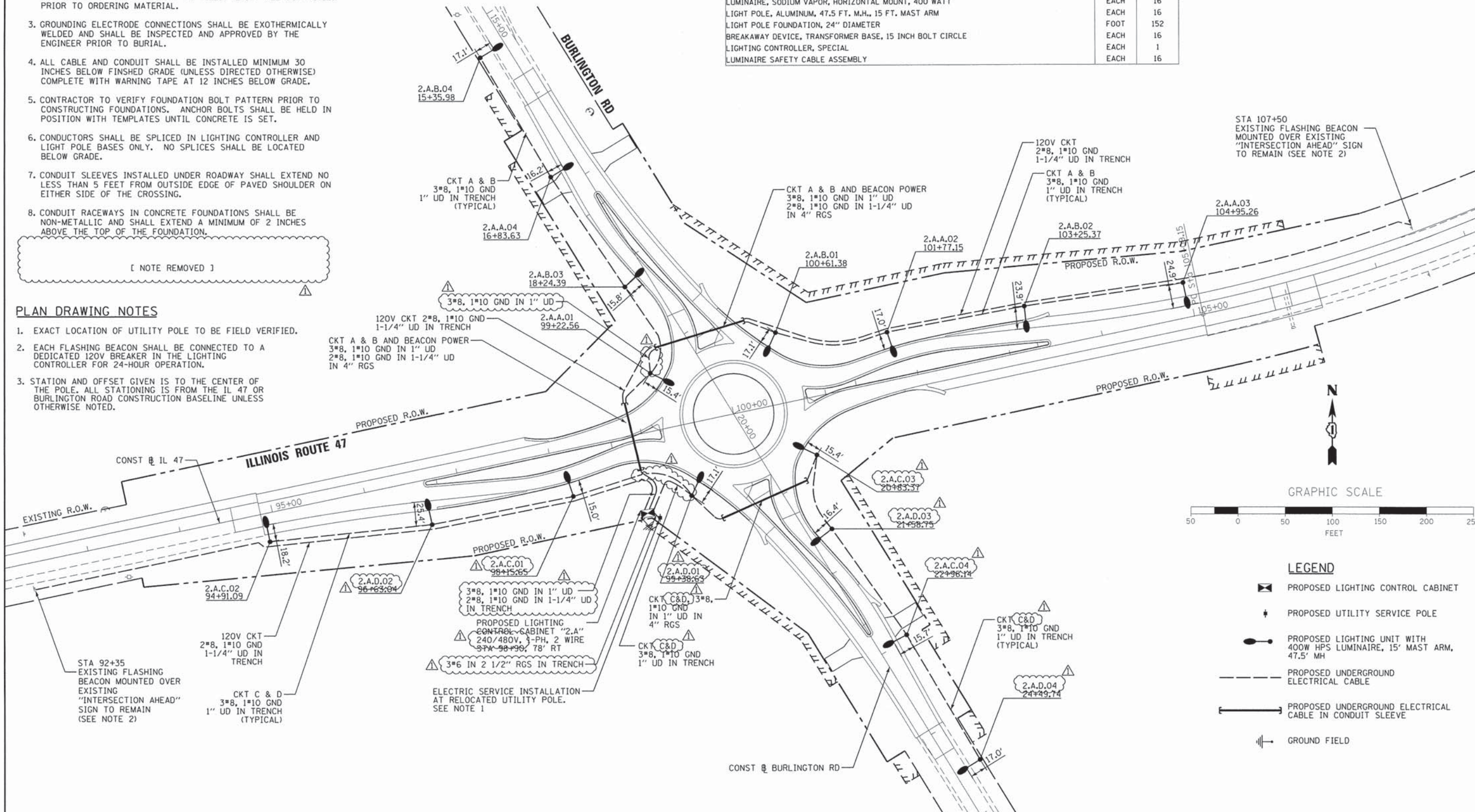

LEGEND

- ☒ PROPOSED LIGHTING CONTROL CABINET
- ⚡ PROPOSED UTILITY SERVICE POLE
- ☪ PROPOSED LIGHTING UNIT WITH 400W HPS LUMINAIRE, 15' MAST ARM, 47.5' MH
- PROPOSED UNDERGROUND ELECTRICAL CABLE
- PROPOSED UNDERGROUND ELECTRICAL CABLE IN CONDUIT SLEEVE
- ⊕ GROUND FIELD

FILE NAME = 66343.1gtp1en.dgn	USER NAME = mpapirnk	DESIGNED - EE	REVISED - 9/4/15	STATE OF ILLINOIS DEPARTMENT OF TRANSPORTATION		PROPOSED LIGHTING PLAN AND GENERAL NOTES LIGHTING SUMMARY OF QUANTITIES				F.A.P. RTE. 326	SECTION 07-00357-00-CH	COUNTY KANE	TOTAL SHEETS 80	SHEET NO. 48
PLOT SCALE = 100.0000' / 1" =	DATE - 6/17/2015	DRAWN - MAP	REVISIONS -							SCALE: 1"=50'		SHEET OF SHEETS STA. TO STA.		CONTRACT NO. 63779

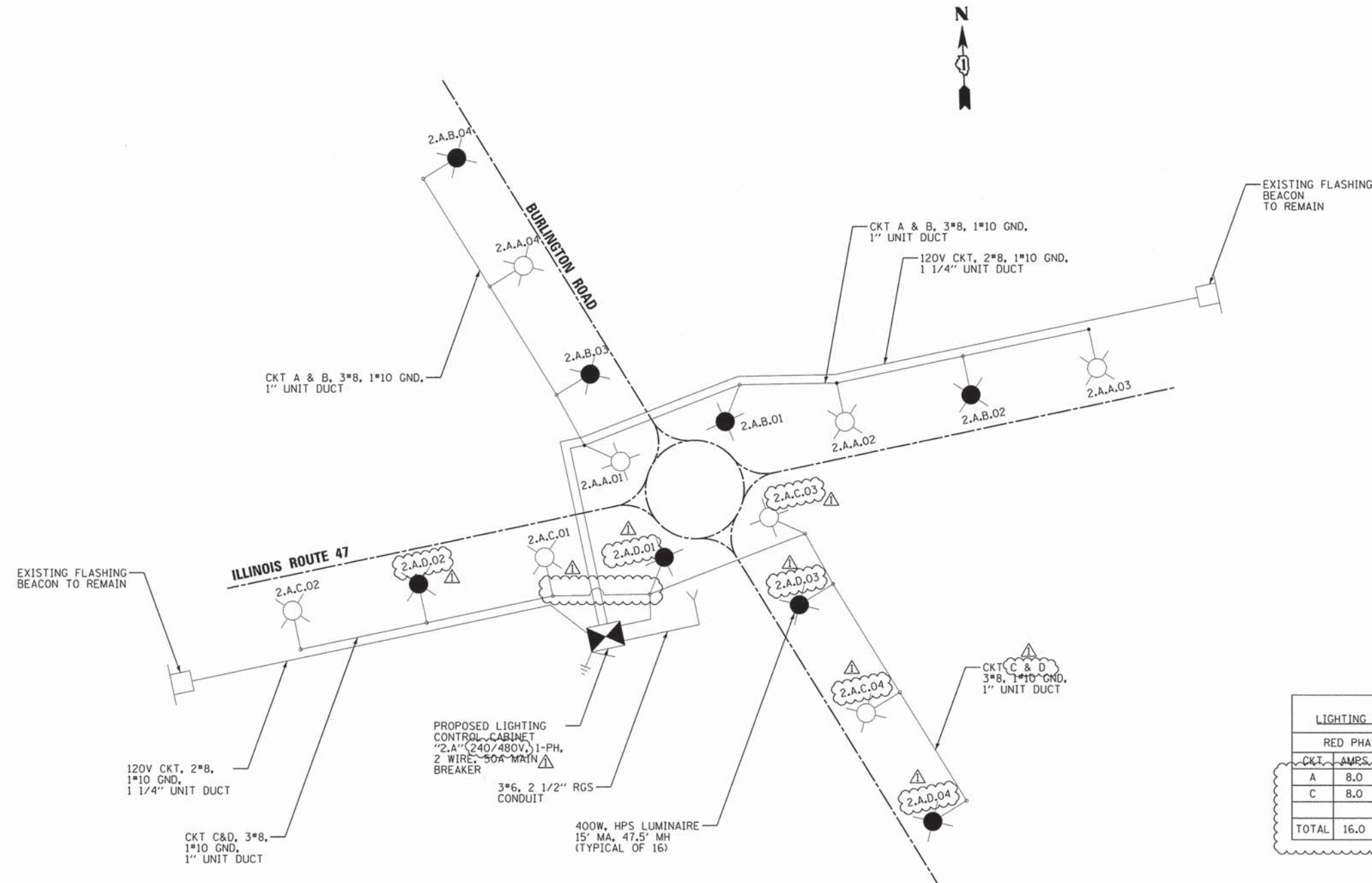

LEGEND

- PROPOSED LIGHTING CONTROL CABINET
- PROPOSED ELECTRIC UTILITY SERVICE
- GROUND FIELD
- PROPOSED LIGHTING UNIT WITH HPS LUMINAIRE RED PHASE - OPEN SYMBOL
- PROPOSED LIGHTING UNIT WITH HPS LUMINAIRE BLACK PHASE - SOLID SYMBOL
- EXISTING FLASHING BEACON SIGN
- PROPOSED UNDERGROUND ELECTRICAL CABLE

RED PHASE		BLACK PHASE	
CKT	AMPS VA	CKT	AMPS VA
A	8.0 960	B	8.0 960
C	8.0 960	D	8.0 960
TOTAL	16.0 1,920		16.0 1,920

PROPOSED LIGHTING SINGLE-LINE DIAGRAM

