

09-18-2015 LETTING ITEM 065

FOR INDEX OF SHEETS, SEE SHEET NO. 2

FOR LIST OF STATE AND LOCAL STANDARDS, SEE SHEET NO. 2

PROJECT LOCATED WITHIN THE VILLAGE OF BURR RIDGE

TRAFFIC DATA - GERMAN CHURCH ROAD
POSTED SPEED: 40 MPH
CURRENT ADT (2010): 4,400 VPD
FUNCTIONAL CLASS: MINOR ARTERIAL

DESIGN DESIGNATION
SIDEWALK

STATE OF ILLINOIS
DEPARTMENT OF TRANSPORTATION
DIVISION OF HIGHWAYS

PLANS FOR PROPOSED FEDERAL AID PROJECT

FAU ROUTE 1552 (GERMAN CHURCH ROAD)
S COUNTY LINE ROAD TO GREYSTONE COURT
PEDESTRIAN IMPROVEMENTS PROJECT
SECTION NO.: 14-00050-00-SW
PROJECT NO.: M-4003 (422)
VILLAGE OF BURR RIDGE
COOK COUNTY

JOB NO.: C-91-139-15

F.A.U. RTE.	SECTION	COUNTY	TOTAL SHEETS	SHEET NO.
1552	14-00050-00-SW	COOK	23	1
FEDERAL RD. DIST. NO.	ILLINOIS	CONTRACT NO. 61B38		

23+4 = 27



LOCATION OF SECTION INDICATED THUS: - [rectangle] -

STATE OF ILLINOIS
DEPARTMENT OF TRANSPORTATION
DIVISION OF HIGHWAYS

Approved PAUL D. MAY P.E. 2/20/15
Village of Burr Ridge, Director of Public Works

Passed APRIL 1, 2015
C. Hill CHRISTOPHER HOLT
District 1 Engineer of Local Roads & Streets

Releasing for Bid Based on Limited Review
APRIL 1, 2015
J. Kistner
Deputy Director of Highways, Region 1 Engineer



ANTHONY J. BRYANT, P.E.
NO. 062-056612
EXP. DATE: 11/30/2015
ALL SHEETS EXCEPT NO. 17

JEFFREY A. RUHDE, S.E.
NO. 081-005613
EXP. DATE: 11/30/2016
SHEET NO. 17

PRINTED BY THE AUTHORITY
OF THE STATE OF ILLINOIS

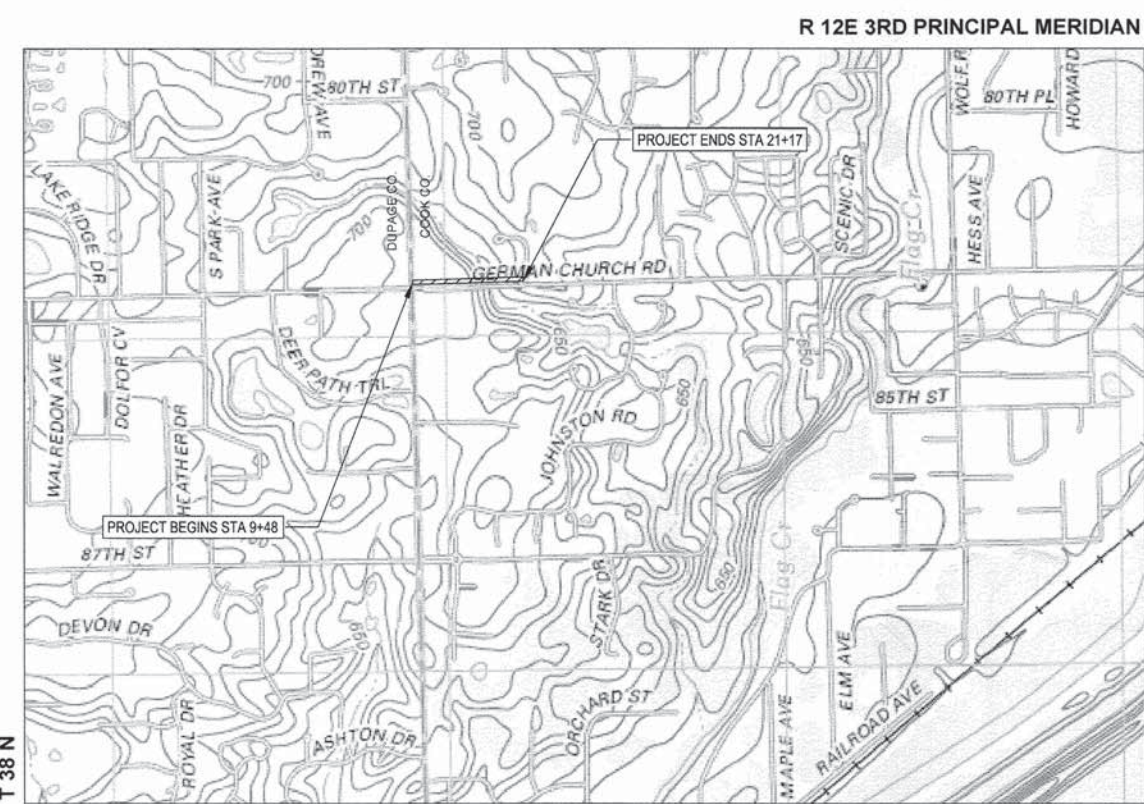

LOCATION MAP

LYONS TOWNSHIP
TOWNSHIP: 38N
RANGE: 12E

GROSS LENGTH OF PROJECT = 1200 FEET (0.23 MILES)
NET LENGTH OF PROJECT = 1200 FEET (0.23 MILES)

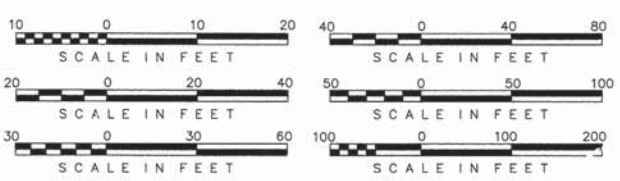

FULL SIZE PLANS HAVE BEEN PREPARED USING STANDARD ENGINEERING SCALES, REDUCED SIZED PLANS WILL NOT CONFORM TO STANDARD SCALES, IN MAKING MEASUREMENTS ON REDUCED PLANS, THE ABOVE SCALES MAY BE USED.

J.U.L.I.E.
JOINT UTILITY LOCATION INFORMATION FOR EXCAVATION
1-800-892-0123
OR 811

FEDERAL AID PROGRAM ENGINEER: FAWAD AQUEEL PE, PTDE (847) 705-4021 - SCHAUMBURG, IL

CONTRACT NO. 61B38

INDEX OF SHEETS

FROM	TO	SHEET TYPE / TITLE
1		COVER SHEET
2		INDEX OF SHEETS, STANDARDS, AND GENERAL NOTES
3		SUMMARY OF QUANTITIES
4		TYPICAL SECTIONS
5		SCHEDULE OF QUANTITIES
6		ALIGNMENT, TIES AND BENCHMARKS
7	8	REMOVAL PLAN
9	11	PROPOSED PLAN AND PROFILE
12		MAINTENANCE OF TRAFFIC PLANS
13		EROSION AND SEDIMENT CONTROL PLAN
14		LANDSCAPING PLAN
15	17	DETAILS
18	20	DISTRICT 1 STANDARDS
21	23	CROSS SECTIONS

DISTRICT 1 STANDARDS

DRAWING NUMBER	TITLE
TC-10	TRAFFIC CONTROL AND PROTECTION FOR SIDE ROADS, INTERSECTIONS, AND DRIVEWAYS
TC-13	DISTRICT ONE TYPICAL PAVEMENT MARKINGS
TC-22	ARTERIAL ROAD INFORMATION SIGN

HIGHWAY STANDARDS

DRAWING NUMBER	TITLE
424001-08	PERPENDICULAR CURB RAMPS
701301-04	URBAN LANE CLOSURE, 2L, 2W, UNDIVIDED
701501-06	LANE CLOSURE 2L, 2W, SHORT TIME OPERATIONS
701701-09	URBAN LANE CLOSURE, MULTILANE INTERSECTION
701801-05	SIDEWALK, CORNER, OR CROSSWALK CLOSURE
701901-04	TRAFFIC CONTROL DEVICES
701006-05	OFF-ROAD OPERATIONS, 2L, 2W
701311-03	LANE CLOSURE 2L, 2W MOVING OPERATIONS - DAY ONLY

GENERAL NOTES:

- THE VILLAGE OF BURR RIDGE SHALL BE NOTIFIED AT LEAST SEVEN (7) WORKING DAYS PRIOR TO COMMENCEMENT OF CONSTRUCTION AND 72 HOURS PRIOR TO DEMOLITION WORK.
- PRIOR TO COMMENCEMENT OF ANY EXCAVATION, THE CONTRACTOR SHALL CALL "JULIE" AT 1-800-892-0123 FOR FIELD LOCATIONS OF BURIED ELECTRIC, TELEPHONE, GAS, WATER, SEWER, AND CABLE TELEVISION FACILITIES (48 HOURS NOTIFICATION REQUIRED).
- THE CONTRACTOR IS RESPONSIBLE FOR CONTACTING ALL UTILITY OWNERS INCLUDING THE VILLAGE SO THAT THEIR FACILITIES MAY BE LOCATED AND ADJUSTED OR MOVED PRIOR TO COMMENCEMENT OF ANY SUBSURFACE WORK. THE CONTRACTOR SHALL BE RESPONSIBLE FOR DETERMINING THE EXACT LOCATION OF THESE UTILITY LINES IN THE FIELD AND THE PROTECTION OF THEM FROM DAMAGE DUE TO CONSTRUCTION OPERATIONS.
- THE LOCATION OF PUBLIC OR PRIVATE UTILITIES SHOWN ON THE PLANS ARE APPROXIMATE AND THE VILLAGE AND ENGINEER DOES NOT GUARANTEE THEIR ACCURACY, THE CONTRACTOR SHALL BE RESPONSIBLE FOR THE PROTECTION OF ALL ABOVE AND BELOW GROUND UTILITIES EVEN THOUGH THEY MAY NOT BE SHOWN ON THE PLAN. ANY UTILITY THAT IS DAMAGED DURING CONSTRUCTION SHALL BE REPAIRED OR REPLACED TO THE SATISFACTION OF THE ENGINEER. THIS WORK SHALL BE AT THE EXPENSE OF THE CONTRACTOR.
- IF EXISTING UTILITY LINES OF ANY NATURE ARE ENCOUNTERED WHICH CONFLICT WITH NEW CONSTRUCTION, THE CONTRACTOR SHALL NOTIFY THE OWNER'S REPRESENTATIVE IMMEDIATELY SO THAT THE CONFLICT MAY BE RESOLVED.
- THE CONTRACTOR SHALL MAKE ARRANGEMENT FOR THE PROPER BRACING, SHORING, AND OTHER REQUIRED PROTECTION OF ALL UTILITIES PRIOR TO CONSTRUCTION. THE CONTRACTOR SHALL BE RESPONSIBLE FOR ANY DAMAGE TO THE UTILITIES AND ASSOCIATED STRUCTURES AND SHALL MAKE REPAIRS AS NECESSARY TO THE SATISFACTION OF THE UTILITY OWNER.
- EXCEPT WHERE MODIFIED BY THE CONTRACT DOCUMENTS, ALL WORK PROPOSED HEREIN SHALL BE IN ACCORDANCE WITH THE FOLLOWING SPECIFICATIONS, WHICH ARE HEREBY MADE A PART HEREOF:
 - (A) "STANDARD SPECIFICATIONS FOR ROAD AND BRIDGE CONSTRUCTION IN ILLINOIS," AS PREPARED BY IDOT, LATEST EDITION.
 - (B) "STANDARD SPECIFICATIONS FOR WATER AND SEWER MAIN CONSTRUCTION IN ILLINOIS," LATEST EDITION.
 - (C) "ILLINOIS RECOMMENDED STANDARDS FOR SEWAGE WORKS," AS PUBLISHED BY THE IEPA, LATEST EDITION.

- THE STANDARD SPECIFICATIONS LISTED ON THESE CONSTRUCTION DRAWINGS AND SUBSEQUENT DETAILS ARE ALL TO BE CONSIDERED AS PART OF THE CONTRACT DOCUMENTS. INCIDENTAL ITEMS OR ACCESSORIES NECESSARY TO COMPLETE THIS WORK MAY NOT BE SPECIFICALLY NOTED BUT ARE TO BE CONSIDERED A PART OF THE CONTRACT.
- NO CONSTRUCTION DRAWINGS SHALL BE USED FOR CONSTRUCTION UNLESS SPECIFICALLY MARKED "FOR CONSTRUCTION". PRIOR TO COMMENCEMENT OF CONSTRUCTION, THE CONTRACTOR SHALL VERIFY ALL DIMENSIONS AND CONDITIONS AFFECTING THEIR WORK WITH THE ACTUAL CONDITIONS AT THE JOB SITE. IF THERE ARE ANY DISCREPANCIES FROM WHAT IS SHOWN ON THE CONSTRUCTION DRAWINGS, CONTRACTOR MUST IMMEDIATELY REPORT SAME TO THE OWNER'S REPRESENTATIVE BEFORE DOING ANY WORK, OTHERWISE THE CONTRACTOR ASSUMES FULL RESPONSIBILITY. IN THE EVENT OF DISAGREEMENT BETWEEN THE CONSTRUCTION DRAWINGS, STANDARD SPECIFICATIONS AND/OR SPECIAL DETAILS, THE CONTRACTOR SHALL SECURE WRITTEN INSTRUCTIONS FROM THE ENGINEER PRIOR TO PROCEEDING WITH ANY PART OF THE WORK AFFECTED BY OMISSIONS OR DISCREPANCIES. FAILING TO SECURE SUCH INSTRUCTION, THE CONTRACTOR WILL BE CONSIDERED TO HAVE PROCEEDED AT ITS OWN RISK AND EXPENSE.
 - THE ENGINEER AND OWNER ARE NOT RESPONSIBLE FOR THE CONSTRUCTION MEANS, METHODS, TECHNIQUES, SEQUENCES OR PROCEDURES, TIME OF PERFORMANCE, PROGRAMS OR FOR ANY SAFETY PRECAUTIONS USED BY THE CONTRACTOR. THE CONTRACTOR IS SOLELY RESPONSIBLE FOR EXECUTION OF THE WORK IN ACCORDANCE WITH THE CONTRACT DOCUMENTS AND SPECIFICATIONS.
 - CONSTRUCTION INGRESS/EGRESS SHALL BE RESTRICTED TO PUBLIC ROADWAYS. CONSTRUCTION ENTRANCES/EXITS SHALL BE CLEANED DAILY AS NEEDED OR AS DIRECTED BY THE ENGINEER.
 - EXISTING DRAINAGE ROUTES SHALL BE MAINTAINED THROUGHOUT THE DURATION OF CONSTRUCTION. LOOSE MATERIALS DEPOSITED IN THE FLOW LINE OF GUTTERS, DRAINAGE STRUCTURES, DITCHES, ETC. SUCH THAT THE NATURAL FLOW LINE IS OBSTRUCTED, SHALL BE REMOVED BY THE CLOSE OF EACH WORKING DAY.
 - THE CONTRACTOR SHALL PROVIDE DUST CONTROL MEASURES AS DIRECTED BY THE ENGINEER.
 - THE CONTRACTOR SHALL BE RESPONSIBLE FOR THE INSTALLATION AND MAINTENANCE OF ADEQUATE TRAFFIC CONTROL SIGNS AND DEVICES. BARRICADES AND WARNING SIGNS SHALL BE PROVIDED IN ACCORDANCE WITH I.D.O.T. STANDARD SPECIFICATIONS AND "MANUAL ON UNIFORM TRAFFIC CONTROL DEVICES."
 - PRIOR TO CONSTRUCTION, ALL EXISTING TRAFFIC/STREET SIGNS SHALL BE REMOVED AND RETURNED TO THE VILLAGE OF BURR RIDGE. THE VILLAGE WILL REPLACE STREET SIGNS AT THE CONCLUSION OF THE PROJECT.
 - THE CONTRACTOR SHALL KEEP A SET OF "APPROVED" CONSTRUCTION DRAWINGS ON THE JOB SITE, AND SHALL MAINTAIN A RECORD ON SAID DRAWINGS OF ANY UNANTICIPATED UTILITIES ENCOUNTERED, ANY MODIFICATIONS/ALTERATIONS TO ALIGNMENT AND/OR TO DRAWINGS AND SPECIFICATIONS OF PROPOSED IMPROVEMENTS. UPON COMPLETION OF THE CONTRACTOR'S WORK, SAID DRAWINGS AND INFORMATION SHALL BE PROVIDED TO THE OWNER'S REPRESENTATIVE.
 - THE CONTRACTOR SHALL BE RESPONSIBLE FOR CONSTRUCTION SURVEY AND STAKEOUT.
 - THE CONTRACTOR SHALL PERFORM A PRE-CONSTRUCTION VIDEO TAPING OF THE PROJECT SITE AND SURROUNDING AREA. THE VIDEO TAPE(S) MUST BE APPROVED BY THE ENGINEER PRIOR TO COMMENCEMENT OF CONSTRUCTION.
 - THE CONTRACTOR SHALL USE INLET FILTER BASKETS, SILT FENCE AND ANY OTHER EROSION CONTROL MEASURES AS DIRECTED BY THE ENGINEER.
 - THE CONTRACTOR SHALL BE RESPONSIBLE FOR MAKING ALL ARRANGEMENTS AND PAYING FOR ALL COSTS ASSOCIATED WITH ANY TEMPORARY UTILITIES THAT MAY BE NECESSARY FOR THE PROJECT.
 - WATER REQUIRED FOR CONSTRUCTION OPERATIONS MAY BE OBTAINED FROM VILLAGE FIRE HYDRANTS IN THE AREA. THE CONTRACTOR IS RESPONSIBLE FOR OBTAINING A WATER METER AND BACKFLOW PREVENTER FROM THE VILLAGE AND PURCHASING WATER AT THE APPLICABLE RATE.
 - THE CONTRACTOR SHALL PROVIDE PORTABLE SANITARY FACILITIES FOR THEIR USE THROUGHOUT THE DURATION OF THE PROJECT.
 - ALL DISTURBED GRASS AREAS SHALL BE RESTORED WITH SOD. SUPPLEMENTAL WATERING SHALL BE APPLIED AS DIRECTED BY THE ENGINEER, IN ACCORDANCE WITH IDOT STANDARD SPECIFICATIONS AND SPECIAL PROVISIONS.
 - THE CONTRACTOR SHALL TEMPORARILY RELOCATE AND PERMANENTLY RESET MAILBOXES AS DIRECTED BY THE LOCAL POSTMASTER. PER IDOT SPECIFICATION, SECTION 107.20, THIS WORK SHALL BE CONSIDERED INCLUDED IN THE COST OF THE CONTRACT.

- THE CONTRACTOR SHALL USE FLAT TOP SLABS IN LIEU OF CONICALLY TAPERED TOPS FOR MANHOLES AND CATCH BASINS WHEREVER NECESSARY TO AVOID CONFLICTS WITH EXISTING UTILITIES. FLAT SLAB TOPS WILL NOT BE MEASURED FOR PAYMENT, BUT INCLUDED IN THE UNIT COST OF THE ASSOCIATED DRAINAGE STRUCTURE(S).
- THE CONTRACTOR IS RESPONSIBLE FOR SECURING AND POSTING A BOND WITH THE COOK COUNTY DEPARTMENT OF TRANSPORTATION AND HIGHWAYS BEFORE COMMENCING WORK.
- THE CONTRACTOR IS RESPONSIBLE FOR PROVIDING TRAFFIC CONTROL IN ACCORDANCE WITH ALL IDOT STANDARDS. WORK IN THE NORTH LANE OF GERMAN CHURCH ROAD SHALL BE DONE UNDER FLAGGERS BETWEEN 9:00AM AND 3:00PM.
- NO TRAFFIC SIGNAL APPARATUS SHALL BE IMPACTED BY THE PROPOSED WORK. THE TRAFFIC SIGNAL APPARATUS NEAR THE CORNER OF COUNTY LINE ROAD AND GERMAN CHURCH ROAD SHALL IN NO WAY BE IMPACTED. ANY DAMAGE TO TRAFFIC SIGNAL EQUIPMENT SHALL BE REPAIRED TO THE SATISFACTION OF THE COOK COUNTY DEPARTMENT OF TRANSPORTATION AND HIGHWAYS, AT THE CONTRACTOR'S EXPENSE.
- SPECIAL ATTENTION IS CALLED TO ARTICLE 107.30 OF THE STANDARD SPECIFICATIONS. ANY DEFACED WORK SHALL BE CORRECTED OR REPLACED BY THE CONTRACTOR AT HIS SOLE EXPENSE PRIOR TO FINAL PAYMENT.

COOK COUNTY DEPARTMENT OF TRANSPORTATION AND HIGHWAYS NOTES:

- CARE IS TO BE TAKEN AS NOT TO DAMAGE ANY OF THE EXISTING TRAFFIC SIGNAL CONDUITS, AND EQUIPMENT. IF ANY OF THE TRAFFIC SIGNAL CONDUITS, CABLES AND/OR EQUIPMENT IS DAMAGED, THE CONTRACTOR SHALL REPAIR AND/OR REPLACE THE CONDUITS, CABLES AND/OR EQUIPMENT AT NO COST TO THE COUNTY.
- THE COUNTY IS NOT PART OF JULIE FOR LOCATION OF TRAFFIC SIGNAL EQUIPMENT, CONTACT THE MECHANICAL, ELECTRICAL, ARCHITECTURAL AND LANDSCAPING DIVISION AT 312-603-1730.
- FOR THE LOCATION OF UNDERGROUND COUNTY MAINTAINED FACILITIES, SEE COUNTY SPECIAL PROVISION "TRAFFIC SIGNAL WORK GENERAL".

COMMITMENTS:

NONE, 01-22-2015

LEGEND

EXISTING

	GAS VALVE
	DECORATIVE LIGHT
	BOULDER
	TEMPORARY SIGN
	SIGN
	TELEPHONE CABINET
	TELEPHONE PEDESTAL
	CONTROL POINT
	CONTROL POINT (CHIS "X")
	CATV PEDESTAL
	BUFFALO BOX
	WATER VALVE
	CATCH BASIN
	CATV LINE
	OVERHEAD LINE
	SANITARY SEWER
	STORM SEWER
	COMBINED SEWER

FILE NAME	USER NAME	DESIGNED	REVISIONS
		AJB	
		TRD	
		MAP	
		01/28/2015	

**STATE OF ILLINOIS
DEPARTMENT OF TRANSPORTATION**

INDEX OF SHEETS, STANDARDS, AND GENERAL NOTES

SCALE: NONE SHEET 1 OF 1 SHEETS STA. TO STA.

F.A.U. R.T.E.	SECTION	COUNTY	TOTAL SHEETS	SHEET NO.
1552	14-00050-00-SW	COOK	23	2
GERMAN CHURCH ROAD PED IMPROVEMENT		CONTRACT NO. 61B38		
FED. ROAD DIST. NO. 1 ILLINOIS FED. AID PROJECT				

CODE NO.	ITEM	UNIT	TOTAL QUANTITY	CONSTRUCTION CODE	
				STP FUNDS	
				75% FED. 25% LOCAL (BURR RIDGE)	
20100110	TREE REMOVAL (6 TO 15 UNITS DIAMETER)	UNIT	380	380	
20100210	TREE REMOVAL (OVER 15 UNITS DIAMETER)	UNIT	182	182	
* Δ 20101200	TREE ROOT PRUNING	EACH	15	15	
Δ 20101300	TREE PRUNING (1 TO 10 INCH DIAMETER)	EACH	9	9	
Δ 20101350	TREE PRUNING (OVER 10 INCH DIAMETER)	EACH	6	6	
20200100	EARTH EXCAVATION	CU YD	1258	1258	
20201200	REMOVAL AND DISPOSAL OF UNSUITABLE MATERIAL	CU YD	197	197	
20400800	FURNISHED EXCAVATION	CU YD	318	318	
20900110	POROUS GRANULAR BACKFILL	CU YD	165	165	
21101615	TOPSOIL FURNISH AND PLACE, 4"	SQ YD	2278	2278	
Δ 25000400	NITROGEN FERTILIZER NUTRIENT	POUND	42	42	
Δ 25000500	PHOSPHORUS FERTILIZER NUTRIENT	POUND	42	42	
Δ 25000600	POTASSIUM FERTILIZER NUTRIENT	POUND	42	42	
Δ 25100630	EROSION CONTROL BLANKET	SQ YD	2014	2014	
Δ 25200110	SODDING, SALT TOLERANT	SQ YD	2278	2278	
28000400	PERIMETER EROSION BARRIER	FOOT	342	342	
28000510	INLET FILTERS	EACH	6	6	
28100127	STONE RIPRAP, CLASS B4	SQ YD	40	40	
35101600	AGGREGATE BASE COURSE, TYPE B 4"	SQ YD	590	590	
* 42400200	PORTLAND CEMENT CONCRETE SIDEWALK 5 INCH	SQ FT	5310	5310	
* 42400800	DETECTABLE WARNING	SQ FT	32	32	
44000100	PAVEMENT REMOVAL	SQ YD	37	37	
44000200	DRIVEWAY PAVEMENT REMOVAL	SQ YD	41	41	
44000500	COMBINATION CURB & GUTTER REMOVAL	FOOT	20	20	
44000600	SIDEWALK REMOVAL	SQ FT	50	50	
44201765	CLASS D PATCHES, TYPE II, 10 INCH	SQ YD	37	37	
50200100	STRUCTURE EXCAVATION	CU YD	414	414	
50300225	CONCRETE STRUCTURES	CU YD	112	112	
50800205	REINFORCEMENT BARS, EPOXY COATED	POUND	14741	14741	
54213657	PRECAST REINFORCED CONCRETE FLARED END SECTIONS 12"	EACH	2	2	
550A0340	STORM SEWERS, CLASS A, TYPE 2, 12"	FOOT	497	497	
59100100	GEOCOMPOSITE WALL DRAIN	SQ YD	200	200	

CODE NO.	ITEM	UNIT	TOTAL QUANTITY	CONSTRUCTION CODE	
				STP FUNDS	
				75% FED. 25% LOCAL (BURR RIDGE)	
* 60200105	CATCH BASINS, TYPE A, 4' DIAMETER, TYPE 1 FRAME, OPEN LID	EACH	2	2	
60234200	INLETS, TYPE A, TYPE 1 FRAME, OPEN LID	EACH	2	2	
* 60600605	CONCRETE CURB, TYPE B	FOOT	125	125	
60603800	COMBINATION CONCRETE CURB AND GUTTER, TYPE B-8.12	FOOT	20	20	
63200310	GUARDRAIL REMOVAL	FOOT	137	137	
67100100	MOBILIZATION	L SUM	1	1	
Δ 78001110	PAINT PAVEMENT MARKING - LINE 4"	FOOT	18	18	
Δ 78001130	PAINT PAVEMENT MARKING - LINE 6"	FOOT	90	90	
Δ 78001150	PAINT PAVEMENT MARKING - LINE 12"	FOOT	96	96	
Δ 78001180	PAINT PAVEMENT MARKING - LINE 24"	FOOT	15	15	
Δ 85000200	MAINTENANCE OF EXISTING TRAFFIC SIGNAL INSTALLATION	EACH	1	1	
Δ 89002376	REBUILD EXISTING HANDHOLE	EACH	1	1	
Δ A2C02501	TREE, CERCIIS CANADENSIS (REDBUD), 1" CALIPER, CONTAINER GROWN	EACH	7	7	
Δ B2002222	TREE, CRATAEGUS VIRDIS WINTER KING (WINTER KING GREEN HAWTHORN), 3" CALIPER, BALLED AND BURLAPPED	EACH	4	4	
Δ C2005815	SHRUB, RHUS AROMATICA GRO-LOW (GRO-LOW FRAGRANT SUMAC), 15" WIDTH, BALLED AND BURLAPPED	EACH	100	100	
Δ F30098Y2	SEEDLING-OSTRYA VIRGINIANA (AMERICAN HOPHORNBEAM), 2-YEAR OLD, BARE ROOT	Unit	0.01	0.01	
Δ F30130G3	SEEDLING-QUERCUS BICOLOR (SWAMP WHITE OAK), 3-GALLON CONTAINER	EACH	4	4	
Δ F30160Y2	SEEDLING-QUERCUS RUBRA (RED OAK), 2-YEAR OLD, BARE ROOT	Unit	0.04	0.04	
* X0324450	SEGMENTAL CONCRETE BLOCK WALL, SPECIAL	SQ FT	1059	1059	
* Δ X5090810	PEDESTRIAN RAIL (SPECIAL)	FOOT	195	195	
* X7010216	TRAFFIC CONTROL AND PROTECTION, (SPECIAL)	L SUM	1	1	
* Δ XX008858	RAILING	FOOT	118	118	
20013788	CONSTRUCTION LAYOUT	L SUM	1	1	
* 20046304	PIPE UNDERDRAINS FOR STRUCTURES 4"	FOOT	200	200	
20073002	TEMPORARY SOIL RETENTION SYSTEM	SQ FT	1755	1755	
* X1003608	PRECONSTRUCTION VIDEOTAPING **	L SUM	1		

* SPECIAL PROVISION
** 100% Local Funds Δ SPECIALTY ITEMS

DESIGNED - AJB	REVISED - 06/02/2015
DRAWN - TRD	REVISED -
CHECKED - MAP	REVISED -
DATE - 01/28/2015	REVISED -

STATE OF ILLINOIS
DEPARTMENT OF TRANSPORTATION

SUMMARY OF QUANTITIES

SCALE: NONE SHEET 1 OF 1 SHEETS STA. TO STA.

F.A.U. RTE. 1552	SECTION 14-00050-00-SW	COUNTY COOK	TOTAL SHEETS 23	SHEET NO. 3
GERMAN CHURCH ROAD PED IMPROVEMENT			CONTRACT NO. 61B38	
FED. ROAD DIST. NO. 1 ILLINOIS FED. AID PROJECT				

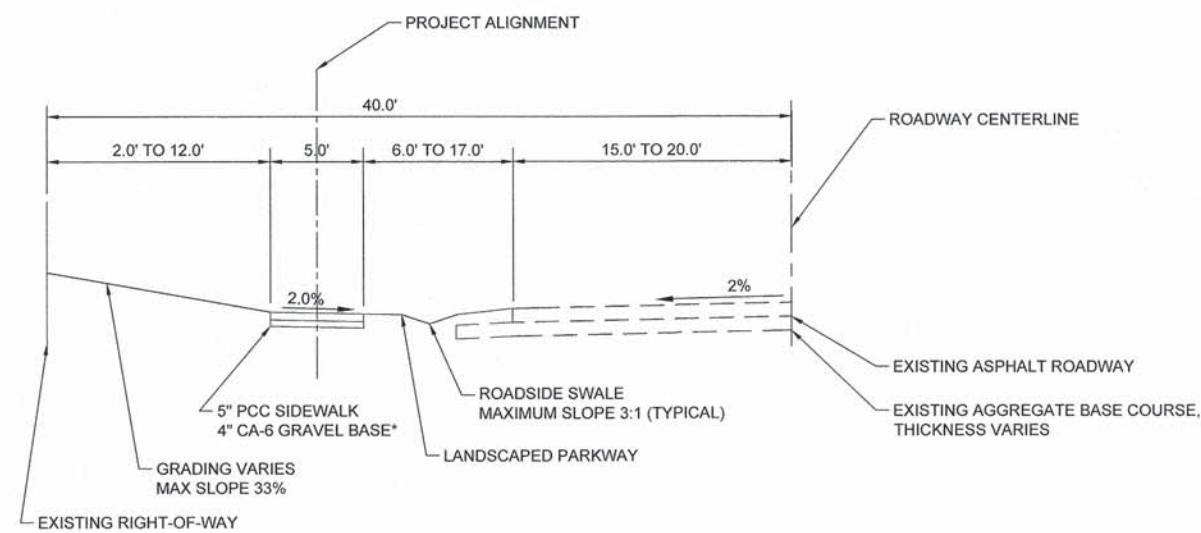
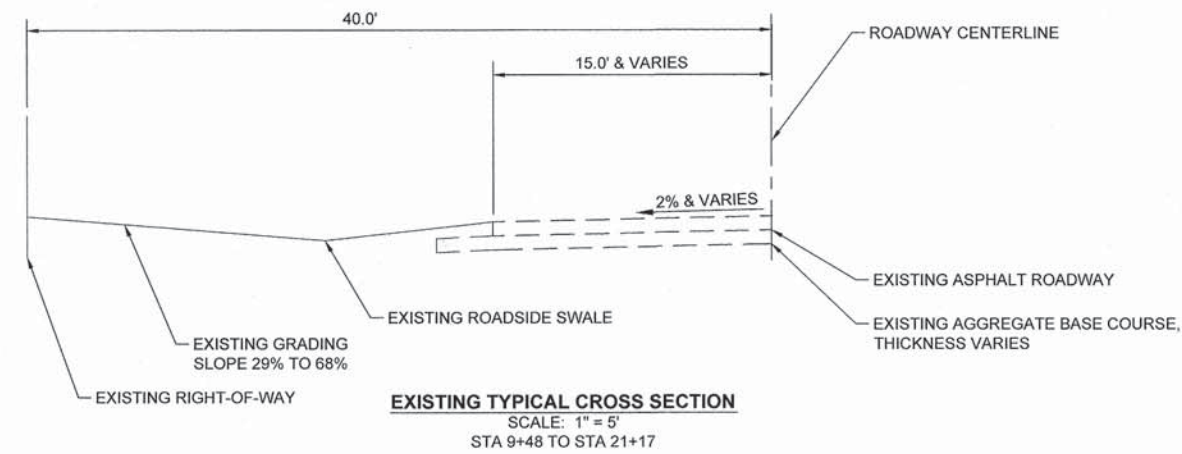

PROPOSED SIDEWALK 7' WIDE WHEN LOCATED STA. 17+04 TO STA. 18+11

CLASS D PATCH, 8", 5.5' WIDE LOCATED STA. 16+75 TO STA. 16+92

CLASS D PATCH, 8", 2' WIDE LOCATED STA. 16+92 TO STA. 17+04

8" WIDE RETAINING WALL LOCATED STA. 14+25 TO STA. 18+71

*AGGREGATE BASE COURSE, TY. B, 4" THICK, (CA-6) (INCLUDED IN THE COST OF PCC SIDEWALK, 5 INCH)

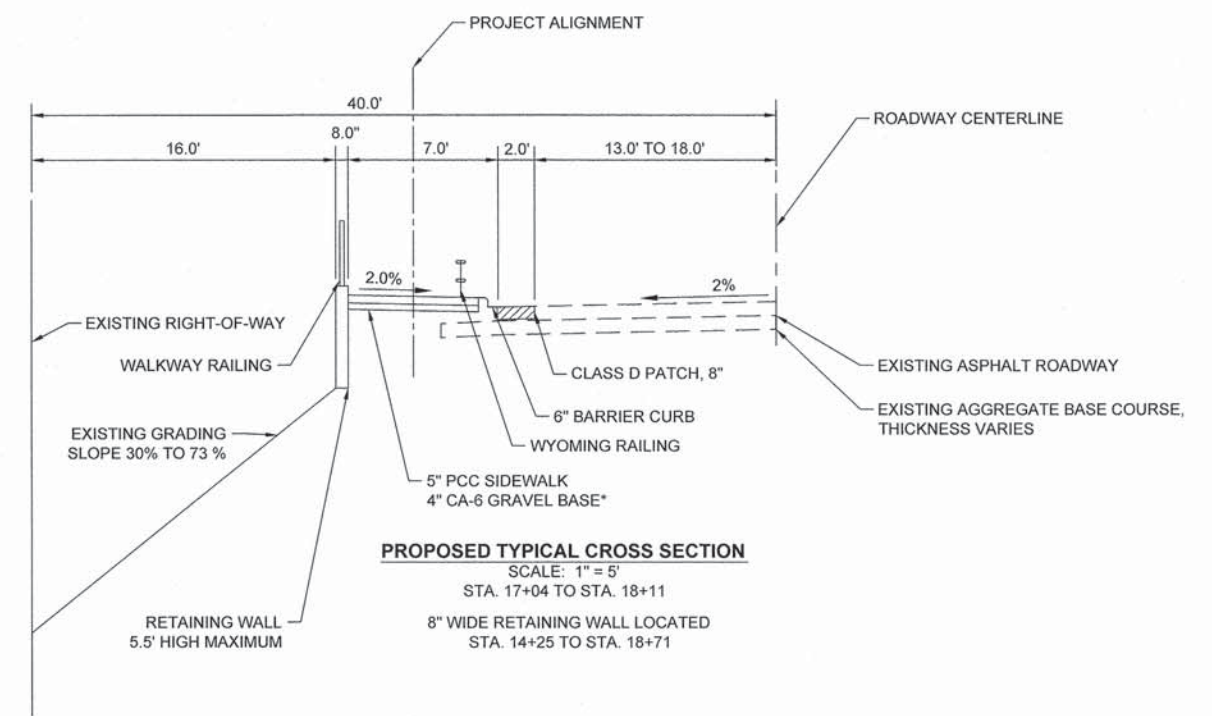
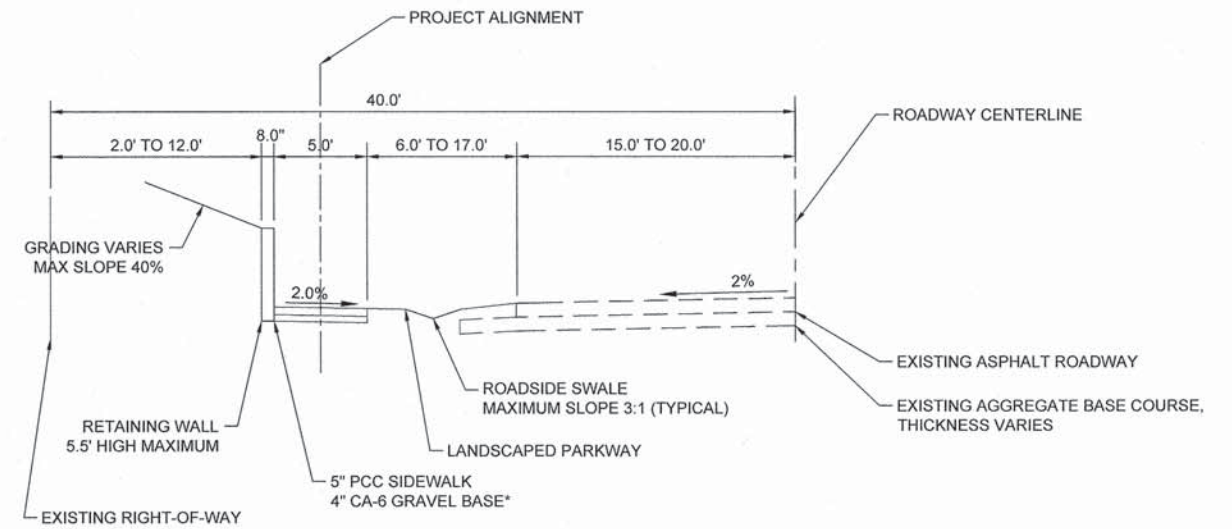

HOT-MIX ASPHALT MIXTURE REQUIREMENTS	
MIXTURE TYPE	AIR VOIDS @Ndes
PATCHING CLASS D PATCHES (HMA BINDER IL-19 MM)	4% @ 70 Gyr.

THE "AC TYPE" FOR POLYMERIZED HMA MIXES SHALL BE "SBS/SBR PG 76-22" AND FOR NON-POLYMERIZED HMA THE "AC TYPE" SHALL BE "PG 64-22" UNLESS MODIFIED BY DISTRICT ONE SPECIAL PROVISIONS. FOR HMA FULL DEPTH "AC TYPE" SEE SPECIAL PROVISIONS. FOR USE OF RECYCLED MATERIALS SEE SPECIAL PROVISIONS.

FILE NAME =	USER NAME =	DESIGNED --	AJB	REVISED --		STATE OF ILLINOIS DEPARTMENT OF TRANSPORTATION	TYPICAL SECTIONS		F.A.U. RTE.	SECTION	COUNTY	TOTAL SHEETS	SHEET NO.	
		DRAWN --	TRD	REVISED --			SCALE: 1" = 5'	SHEET 1 OF 1 SHEETS	STA. TO STA.	1552	14-00050-00-SW	COOK	23	4
		CHECKED --	MAP	REVISED --						GERMAN CHURCH ROAD PED IMPROVEMENT CONTRACT NO. 61B38				
		DATE --	01/28/2015	REVISED --						FED. ROAD DIST. NO. 1 ILLINOIS FED. AID PROJECT				

GERMAN CHURCH ROAD STA 9+48 TO 15+00			
DIAMETER (INCHES)	STATION	OFFSET	TREE REMOVAL
24	11+57	3.21 R	Y
10	11+69	3.06 L	Y
10	12+63	0.31 L	Y
9	12+89	0	Y
6	12+91	2.09 L	Y
9	13+48	3.65 L	Y
8	13+57	2.83 L	Y
8	13+64	5.58 L	Y
8	13+78	5.83 L	Y
6	13+81	4.46 L	Y
9	13+87	5.48 L	Y
8	13+91	10.44 L	Y
15	14+20	7.64 L	Y
12	14+29	7.40 L	Y
18	14+32	10.37 L	Y
18	14+42	5.30 L	Y
7	14+68	2.31 L	Y
7	14+78	3.33 L	Y
7	14+87	0.14 R	Y
9	14+89	5.25 L	Y
9	14+96	3.82 L	Y
8	14+95	1.53 L	Y

GERMAN CHURCH ROAD STA 15+00 TO 18+50			
DIAMETER (INCHES)	STATION	OFFSET	TREE REMOVAL
6	15+08	0.92 L	Y
6	15+09	3.08 L	Y
7	15+23	1.74 R	Y
7	15+39	1.03 L	Y
7	15+51	0.67 L	Y
9	15+51	9.28 L	Y
6	15+66	0.62 L	Y
14	15+68	8.42 L	Y
6	15+82	2.69 L	Y
7	15+86	7.48 L	Y
6	15+86	0.81 R	Y
6	16+04	1.48 R	Y
6	16+16	1.02 R	Y
6	16+19	1.81 L	Y
6	16+23	3.60 L	Y
18	16+36	4.57 L	Y
8	16+39	2.33 L	Y
10	16+50	9.24 L	Y
7	16+54	2.47 L	Y
7	16+57	1.21 L	Y
7	16+58	3.28 L	Y
6	16+62	6.02 L	Y

EARTHWORK SCHEDULE			
LOCATION (GERMAN CHURCH ROAD)	EARTH EXCAVATION (CU. YD.) 20200100	FURNISHED EXCAVATION (CU. YD.) 20400800	TOPSOIL FURNISH AND PLACE, 4" (SQ. YD.) 21101615
9+48 to 14+00	158	6	737
14+00 to 18+50	938	31	1026
18+50 to 21+17	162	135	515
TOTAL	1258	172	2278

GERMAN CHURCH ROAD STA 18+50 TO 21+17			
DIAMETER (INCHES)	STATION	OFFSET	TREE REMOVAL
24	18+68	6.13 R	Y
9	18+84	16.64 R	Y
6	18+86	12.20 R	Y
9	18+91	15.33 R	Y
6	19+06	16.74 R	Y
18	19+06	8.18 R	Y
6	19+14	12.14 R	Y
6	19+21	10.62 R	Y
7	19+37	5.03 R	Y
6	19+47	10.94 R	Y
30	19+53	12.77 R	Y
16	19+84	1.95 L	Y
16	19+99	1.30 R	Y
10	20+03	3.67 R	Y
6	20+10	3.88 R	Y

GERMAN CHURCH ROAD TREE SCHEDULE				
NO.	CODED PAY ITEM	DESCRIPTION	STATION	OFFSET
1	F30130G3	SEEDLING-QUERCUS BICOLOR (SWAMP WHITE OAK), 3-GALLON CONTAINER	11+80	5L
2	F30130G3	SEEDLING-QUERCUS BICOLOR (SWAMP WHITE OAK), 3-GALLON CONTAINER	12+18	5R
3	F30130G3	SEEDLING-QUERCUS BICOLOR (SWAMP WHITE OAK), 3-GALLON CONTAINER	12+68	5R
4	F30098Y2	SEEDLING-OSTRYA VIRGINIANA (AMERICANHOPHORNBEAM), 2-YEAR OLD, BARE ROOT	13+26	5R
5	A2C02501	TREE, CERCIS CANADENSIS (REDBUD), 1" CALIPER, CONTAINER GROWN	13+65	5L
6	A2C02501	TREE, CERCIS CANADENSIS (REDBUD), 1" CALIPER, CONTAINER GROWN	13+75	6L
7	A2C02501	TREE, CERCIS CANADENSIS (REDBUD), 1" CALIPER, CONTAINER GROWN	13+80	7L
8	A2C02501	TREE, CERCIS CANADENSIS (REDBUD), 1" CALIPER, CONTAINER GROWN	13+88	8L
9	F30130G3	SEEDLING-QUERCUS BICOLOR (SWAMP WHITE OAK), 3-GALLON CONTAINER	14+30	8L
10	A2C02501	TREE, CERCIS CANADENSIS (REDBUD), 1" CALIPER, CONTAINER GROWN	14+67	8L
11	A2C02501	TREE, CERCIS CANADENSIS (REDBUD), 1" CALIPER, CONTAINER GROWN	14+82	8L
12	A2C02501	TREE, CERCIS CANADENSIS (REDBUD), 1" CALIPER, CONTAINER GROWN	14+94	8L
13	B2002222	TREE, CRATAEGUS VIRDIS WINTER KING (WINTER KING GREEN HAWTHORN), 3" CALIPER, BALLED AND BURLAPPED	16+20	10L
14	B2002222	TREE, CRATAEGUS VIRDIS WINTER KING (WINTER KING GREEN HAWTHORN), 3" CALIPER, BALLED AND BURLAPPED	16+32	10L
15	B2002222	TREE, CRATAEGUS VIRDIS WINTER KING (WINTER KING GREEN HAWTHORN), 3" CALIPER, BALLED AND BURLAPPED	16+43	10L
16	F30160Y2	SEEDLING-QUERCUS RUBRA (RED OAK), 2-YEAR OLD, BARE ROOT	18+35	5L
17	B2002222	TREE, CRATAEGUS VIRDIS WINTER KING (WINTER KING GREEN HAWTHORN), 3" CALIPER, BALLED AND BURLAPPED	18+63	10R
18	F30160Y2	SEEDLING-QUERCUS RUBRA (RED OAK), 2-YEAR OLD, BARE ROOT	19+17	10R
19	F30160Y2	SEEDLING-QUERCUS RUBRA (RED OAK), 2-YEAR OLD, BARE ROOT	19+46	10R
20	F30160Y2	SEEDLING-QUERCUS RUBRA (RED OAK), 2-YEAR OLD, BARE ROOT	19+85	8R

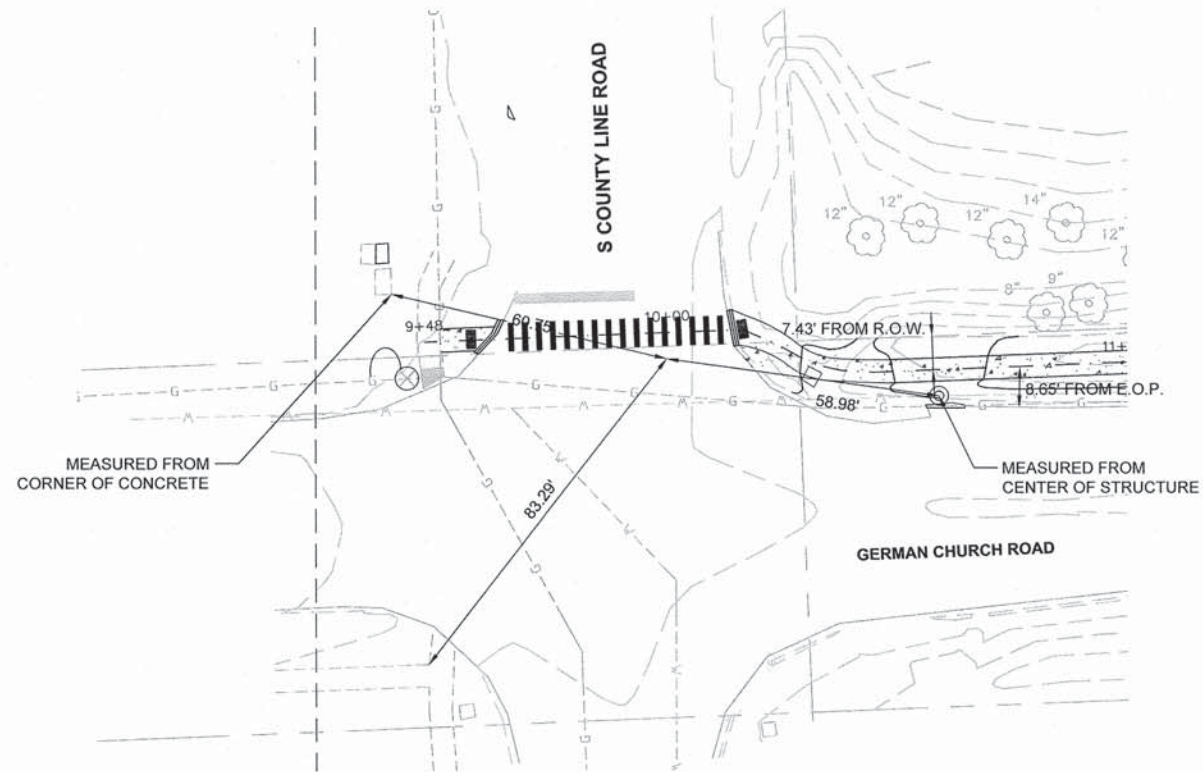
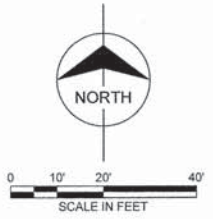

GERMAN CHURCH ROAD AND COUNTRY LINE ROAD
HORIZONTAL TIE - SIDEWALK CENTERLINE
STA 10+00.00

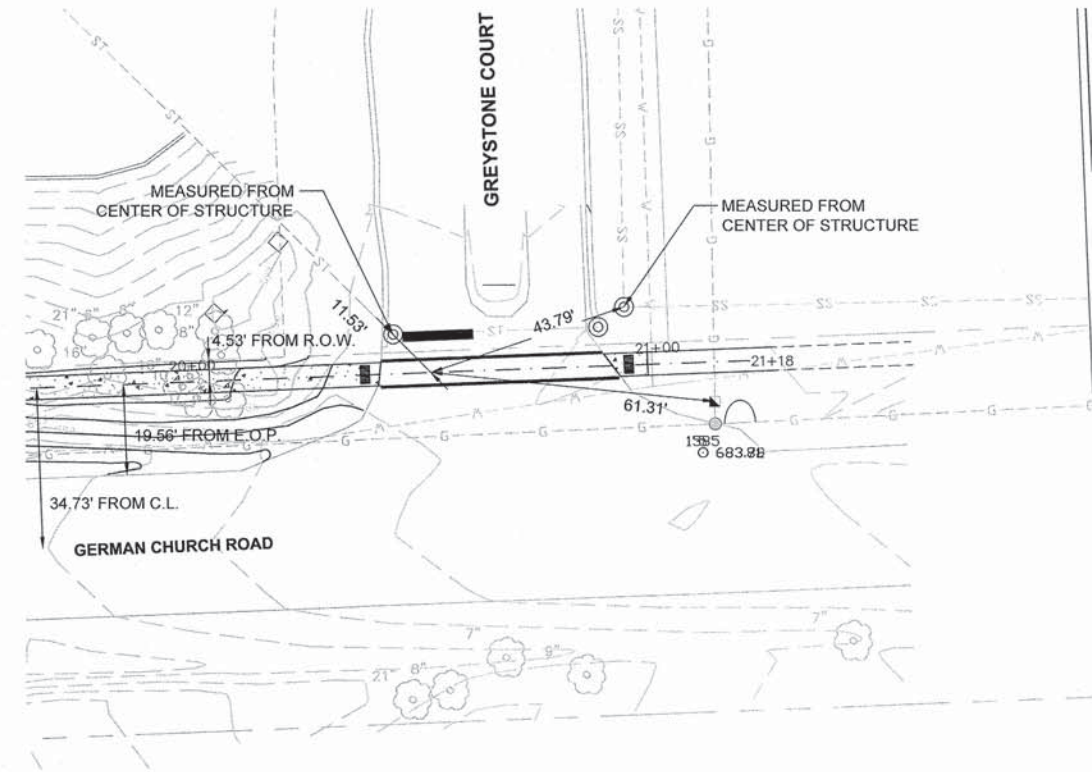

GERMAN CHURCH ROAD AND GREYSTONE COURT
HORIZONTAL TIE - SIDEWALK CENTERLINE
STA 20+50.00

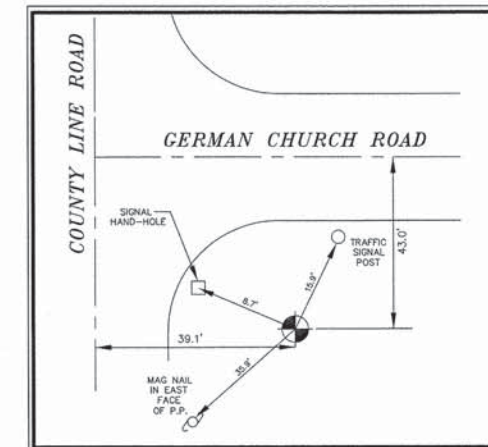

BENCHMARK

VILLAGE BENCHMARK #107
LOCATED AT THE SOUTHEAST CORNER OF COUNTY
LINE ROAD AND GERMAN CHURCH ROAD
BERNTSEN MONUMENT, 9/16" DIA. STEEL ROD INSIDE
1" DIA. GRESE FILLED PVC
ELEVATION: 696.35
NORTHING: 1847514.62
EASTING: 1098431.16

FILE NAME =	USER NAME =	DESIGNED -- A.J.B.	REVISED --	STATE OF ILLINOIS DEPARTMENT OF TRANSPORTATION	ALIGNMENT, TIES AND BENCHMARK	F.A.U. RTE.	SECTION	COUNTY	TOTAL SHEETS	SHEET NO.
	DRAWN -- TRD	REVISED --	1552			14-00050-00-SW	COOK	23	6	
	CHECKED -- MAP	REVISED --	GERMAN CHURCH ROAD PED IMPROVEMENT			CONTRACT NO. 61B38				
	DATE -- 01/28/2015	REVISED --	FED. ROAD DIST. NO. 1 ILLINOIS FED. AID PROJECT							
	PLOT SCALE =			SCALE: 1"=20'	SHEET 1 OF 1 SHEETS	STA. TO STA.				

EXISTING UTILITY POLE TO BE RELOCATED (BY OTHERS) UNDER THE DIRECTION OF THE CONTRACTOR

S COUNTY LINE ROAD

EXISTING HANDHOLE TO BE REBUILT BY CCDOTH UNDER THE DIRECTION OF THE CONTRACTOR

TRAFFIC SIGNAL POST

EXISTING VALVE VAULT

TREE REMOVAL (15+ UNITS), 78 UNITS (THIS SHEET)

DRIVEWAY PAVEMENT REMOVAL, 41 SQ YD

TREE REMOVAL (6-15 UNITS), 309 UNITS (THIS SHEET)

FIRE HYDRANT TO BE RELOCATED, 1 EACH

EX R.O.W.

COMBINATION CURB & GUTTER REMOVAL, 20 FOOT (THIS SHEET)

EXISTING WATER MAIN (TYP)

EXISTING GAS MAIN (TYP)

EXISTING HANDHOLE

GERMAN CHURCH ROAD

MATCH LINE STA 14+00
SEE BELOW



REMOVALS LEGEND

- EXISTING ASPHALT PAVEMENT TO BE REMOVED
- EXISTING DRIVEWAY APRON TO BE REMOVED
- EXISTING CURB & GUTTER TO BE REMOVED
- EXISTING SIDEWALK TO BE REMOVED
- EXISTING TREE TO BE REMOVED (OVER 15 UNITS DIAMETER)
- EXISTING TREE TO BE REMOVED (6 TO 15 UNITS DIAMETER)

MATCH LINE STA 14+00
SEE ABOVE

EX R.O.W.

MATCH LINE STA 18+50
SEE SHEET NO. 8

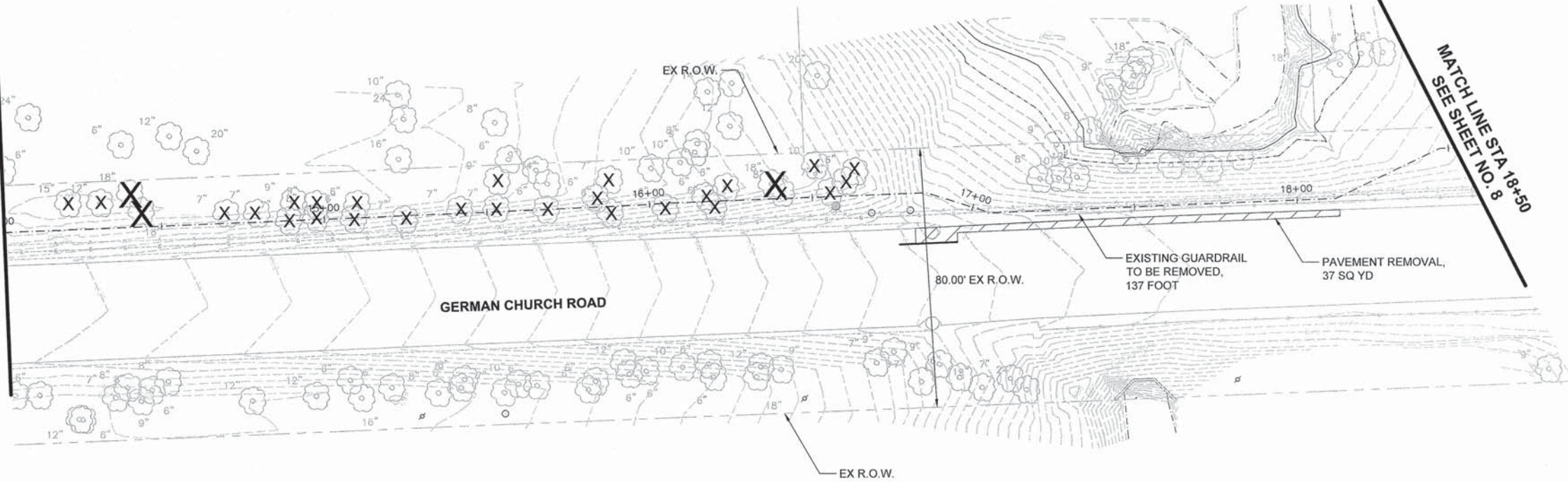



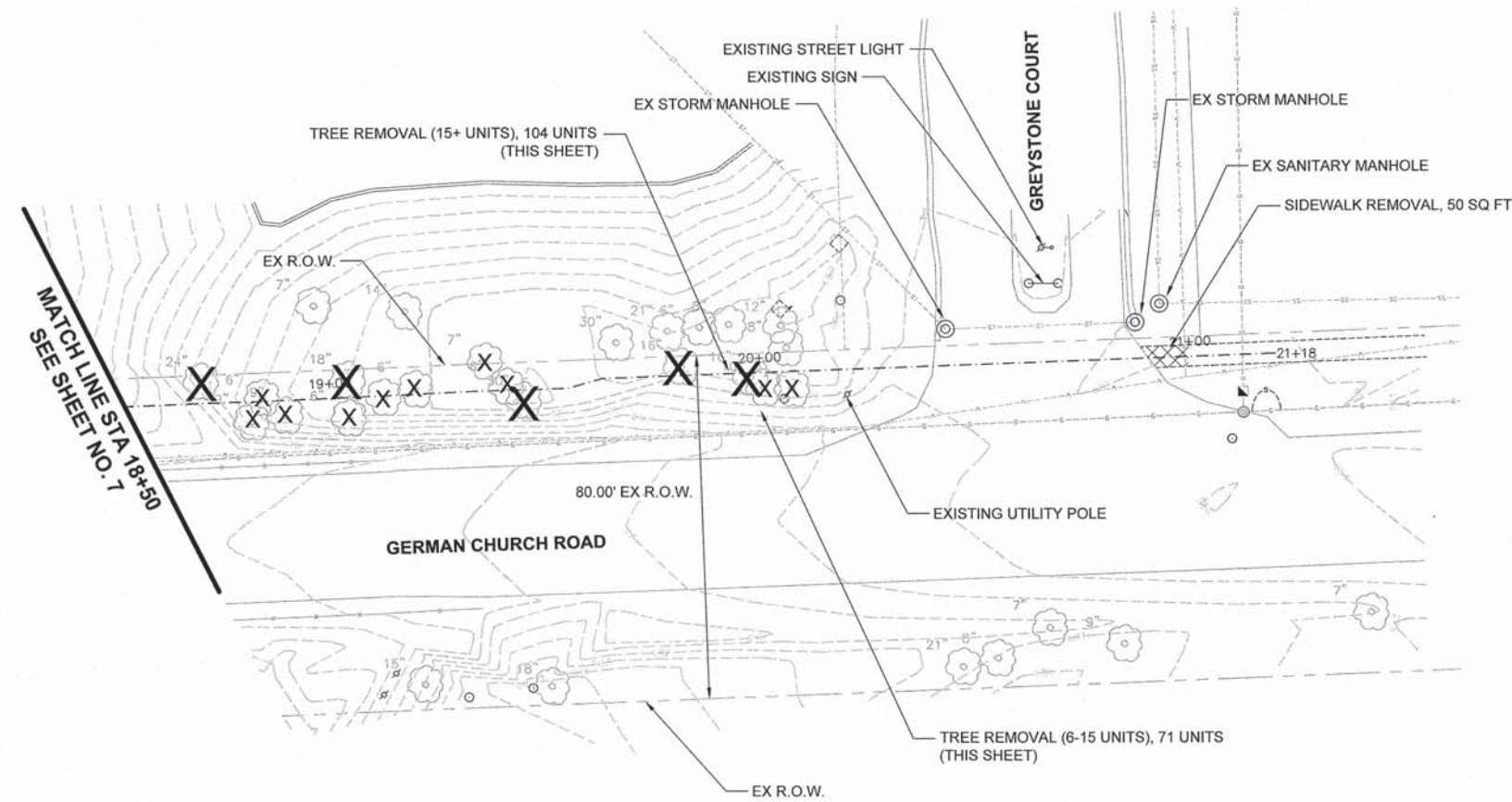
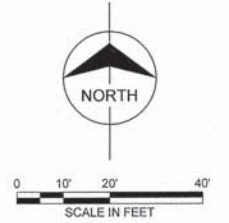

GERMAN CHURCH ROAD

EX R.O.W.

FILE NAME =	USER NAME =	DESIGNED -- AJB	REVISED --	STATE OF ILLINOIS DEPARTMENT OF TRANSPORTATION	REMOVAL PLAN	F.A.U. RTE.	SECTION	COUNTY	TOTAL SHEETS	SHEET NO.	
		DRAWN -- TRD	REVISED --			1552	14-00050-00-SW	COOK	23	7	
		CHECKED -- MAP	REVISED --			GERMAN CHURCH ROAD PED IMPROVEMENT CONTRACT NO. 61B38					
		DATE -- 01/28/2015	REVISED --			FED. ROAD DIST. NO. 1 ILLINOIS FED. AID PROJECT					
PLOT SCALE =				SCALE: 1"=20' SHEET 1 OF 2 SHEETS STA. 9+48 TO STA. 18+50							
PLOT DATE =											



- REMOVALS LEGEND**
-  EXISTING ASPHALT PAVEMENT TO BE REMOVED
 -  EXISTING DRIVEWAY APRON TO BE REMOVED
 -  EXISTING ASPHALT/GRAVEL SHOULDER TO BE REMOVED
 -  EXISTING SIDEWALK TO BE REMOVED
 -  EXISTING TREE TO BE REMOVED (OVER 15 UNITS DIAMETER)
 -  EXISTING TREE TO BE REMOVED (6 TO 15 UNITS DIAMETER)

MATCH LINE STA 18+50
SEE SHEET NO. 7

FILE NAME =	USER NAME =	DESIGNED -- A.J.B.	REVISED --	STATE OF ILLINOIS DEPARTMENT OF TRANSPORTATION	REMOVAL PLAN	F.A.U. RTE.	SECTION	COUNTY	TOTAL SHEETS	SHEET NO.
	DRAWN -- TRD	REVISED --	1552			14-00050-00-SW	COOK	23	8	
	PLOT SCALE =	CHECKED -- MAP	REVISED --			GERMAN CHURCH ROAD PED IMPROVEMENT		CONTRACT NO. 61B38		
	PLOT DATE =	DATE -- 01/28/2015	REVISED --			FED. ROAD DIST. NO. 1 ILLINOIS FED. AID PROJECT				
SCALE: 1"=20'						SHEET 2 OF 2 SHEETS		STA. 18+50 TO STA. 21+17		

PLAN	SURVEYED	DATE
	ALIGNED	
	NOTED	
	INT. OF WAY CHECKED	
	PAID FILE NAME	
	NO.	

PROFILE	SURVEYED	DATE
	PLotted	
	CHECKED	
	B.M. NOTED	
	STRUCTURE NOTATIONS CH'NG	
	NO.	

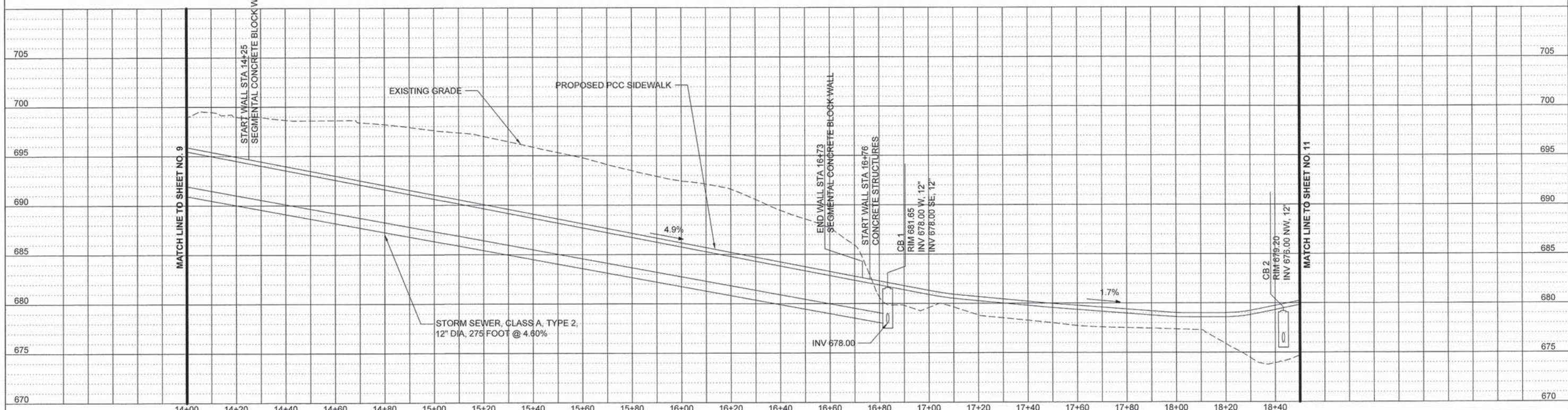
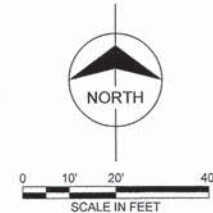
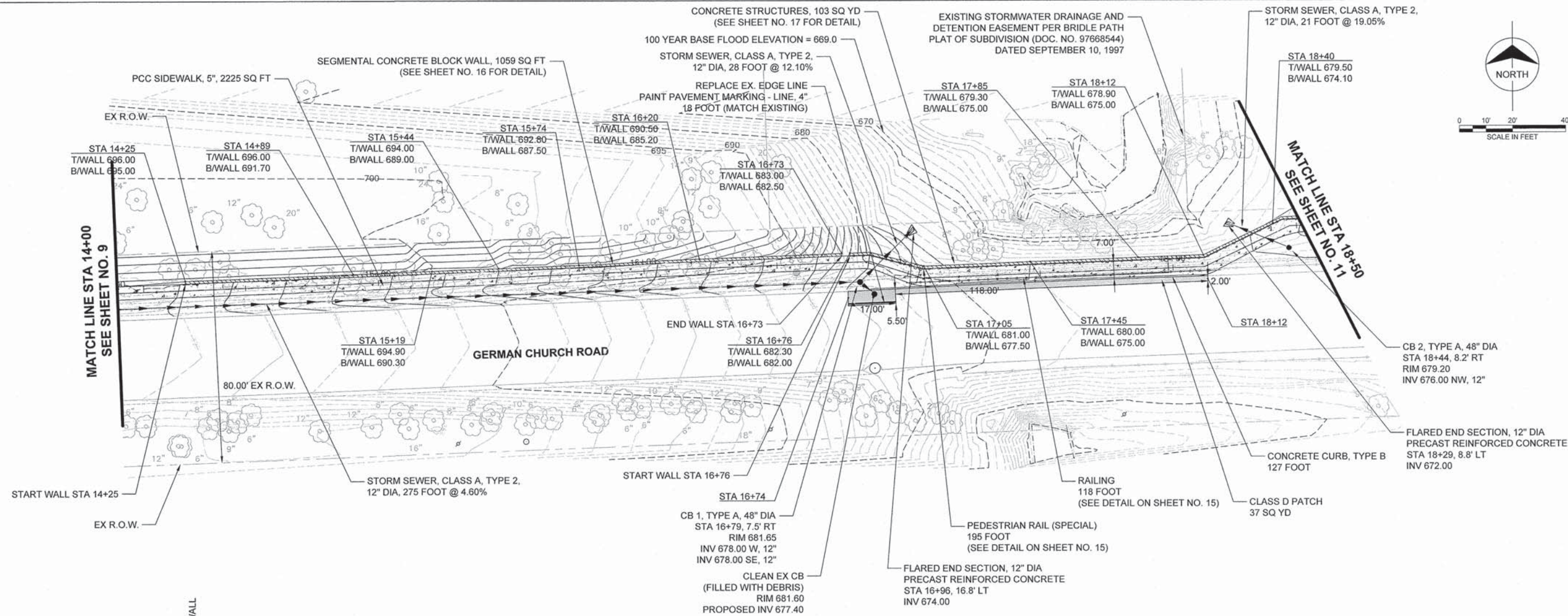

FILE NAME =	USER NAME =	DESIGNED -- AJB	REVISED --	STATE OF ILLINOIS DEPARTMENT OF TRANSPORTATION	PROPOSED PLAN AND PROFILE	F.A.U. R.T.E. =	SECTION =	COUNTY =	TOTAL SHEETS =	SHEET NO. =	
		DRAWN -- TRD	REVISED --			1552	14-00050-00-SW	COOK	23	10	
		CHECKED -- MAP	REVISED --			GERMAN CHURCH ROAD PED IMPROVEMENT CONTRACT NO. 61B38					
		DATE -- 01/28/2015	REVISED --			FED. ROAD DIST. NO. 1 ILLINOIS FED. AID PROJECT					

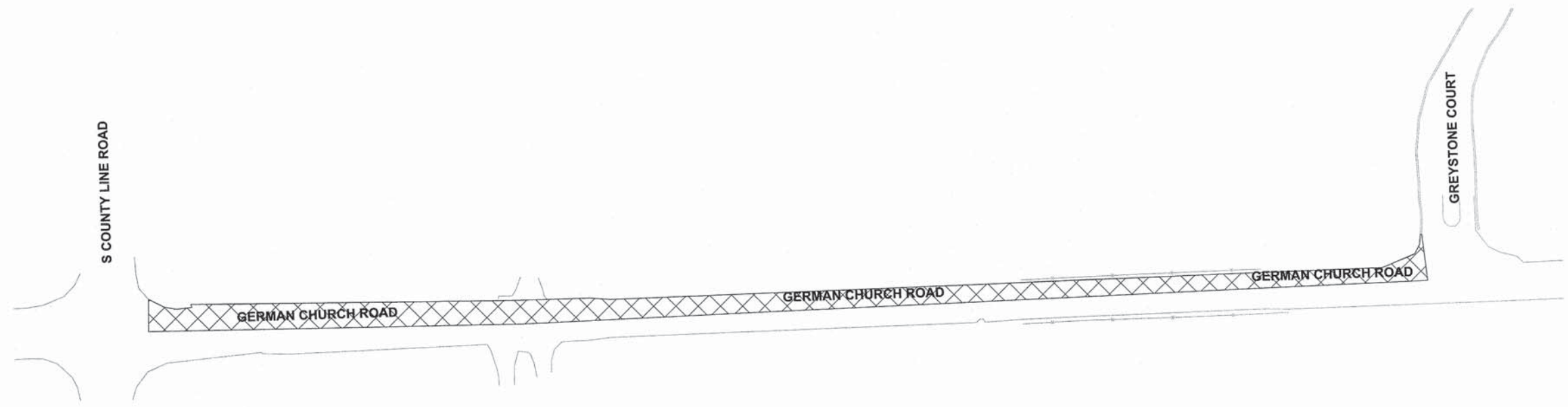
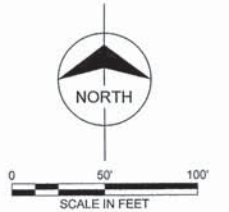

MAINTENANCE OF TRAFFIC GENERAL NOTES

ALL TRAFFIC CONTROL AND PROTECTION MEASURES SHALL BE IN ACCORDANCE WITH SECTION 701 OF THE STANDARD SPECIFICATIONS, THE TRAFFIC PLAN AND THE LATEST EDITION OF THE MUTCD.

THE CONTRACTOR SHALL OBTAIN WRITTEN APPROVAL OF THE ENGINEER FOR ANY METHODS OF TRAFFIC CONTROL AND PROTECTION DIFFERENT THAN THAT SHOWN ON THE PLANS. NO ADDITIONAL COMPENSATION WILL BE ALLOWED TO THE CONTRACTOR.

THE CONTRACTOR SHALL NOT CHANGE THE CONSTRUCTION STAGING PLANS WITHOUT WRITTEN APPROVAL OF THE ENGINEER AND ANY ADDITIONAL COSTS RESULTING FROM AN APPROVED CHANGE SHALL BE THE RESPONSIBILITY OF THE CONTRACTOR.

THE CONTRACTOR SHALL PROVIDE ALL SIGNS, BARRICADES AND TEMPORARY BARRIER WALLS AND PROTECTION NECESSARY FOR THE MAINTENANCE OF TRAFFIC AS NOTED IN THE CONTRACT DOCUMENTS, OR AS DIRECTED BY THE ENGINEER.

THE CONTRACTOR MUST NOTIFY ALL EMERGENCY SERVICES (POLICE, FIRE, ETC.), LOCAL SCHOOL DISTRICTS, AND LOCAL MUNICIPALITIES (VILLAGES, COUNTIES, TOWNSHIPS) AND POST OFFICE A MINIMUM OF 72 HOURS IN ADVANCE OF ANY SIDE ROAD CLOSURES OR DETOURS.

BURR RIDGE POLICE DEPARTMENT (NON-EMERGENCY): 630-654-8181
 BURR RIDGE FIRE DEPARTMENT (NON-EMERGENCY): 708-352-9229
 BURR RIDGE PUBLIC WORKS DEPARTMENT: 630-323-4733
 SCHOOL DISTRICT 180: 630-734-6600

SOLID WHITE LINES SHALL BE USED TO DEFINE OUTSIDE LANE LINES DURING MAINTENANCE OF TRAFFIC WHERE CURB AND GUTTER DOES NOT SERVE AS THE EDGE OF THE TRAFFIC LANE.

THE CONTRACTOR IS RESPONSIBLE FOR PROVIDING TEMPORARY DRAINAGE AND DE-WATERING ACTIVITIES TO ENSURE NO FLOODING OF ADJACENT PROPERTIES OR STANDING WATER IN THE CONSTRUCTION SITE.

ALL WARNING SIGNS SHALL BE BLACK LEGEND AND BORDER ON ORANGE REFLECTORIZED BACKGROUND UNLESS OTHERWISE SPECIFIED. ALL WARNING SIGNS TO BE 48" X 48".

THE CONTRACTOR SHALL MAINTAIN ACCESS TO ALL DRIVEWAYS AND SIDE STREETS DURING CONSTRUCTION. TEMPORARY ACCESS CLOSURES WILL BE ALLOWED ONLY AT THE DIRECTION OF THE ENGINEER.

ALL ADVANCE WARNING SIGNS FOR THE PROJECT SHALL BE INSTALLED PRIOR TO THE START OF CONSTRUCTION.

ALL TEMPORARY OR PERMANENT PAVEMENT MARKING PROPOSED WITHIN THE WORK AREA SHALL BE COMPLETED PRIOR TO THE CONSTRUCTION PHASE CHANGE.

THE COST OF FLAGGER SIGNING SHALL BE INCLUDED IN THE COST OF TRAFFIC CONTROL AND PROTECTION (SPECIAL).

CONTRACTOR SHALL COORDINATE ALL DETOUR SIGNS WITH ADJACENT CONSTRUCTION CONTRACTS (DO NOT KNOW OF ANY ADJACENT CONSTRUCTION CONTRACTS AT THIS TIME).

FLAGGER SIGNAGE SHALL BE COORDINATED WITH IDOT, COOK COUNTY, AND VILLAGE OF BURR RIDGE

CONSTRUCTION STAGING NOTES

THE NORTH LANE OF GERMAN CHURCH ROAD SHALL BE CLOSED ON WORKING DAYS BETWEEN 9:00AM AND 3:00PM. TWO FLAGGERS WILL MAINTAIN TRAFFIC ON THE SOUTH LANE OF GERMAN CHURCH ROAD.

PRESTAGE
 PERFORM NECESSARY TREE REMOVAL AND CLEARING.

INSTALL FLAGGER ROAD SIGNS. INSTALL TEMPORARY TRAFFIC CONTROL MEASURES AS REQUIRED.

INSTALL TEMPORARY FENCING FOR TREE PROTECTION AND INLET FILTERS ON ALL EXISTING OPEN GRATE STRUCTURES.

STAGE 1:
 REMOVE PAVEMENT AND ANCILLARY ITEMS AS REQUIRED WITHIN THE STAGE 1 CONSTRUCTION ZONE.

CONSTRUCT STORM SEWERS AND ASSOCIATED STRUCTURES IN STAGE 1 CONSTRUCTION ZONE.

CONSTRUCT THE NEW PAVEMENT WITHIN THE STAGE 1 CONSTRUCTION ZONE.

CONSTRUCT ASSOCIATED CURB AND GUTTER, SIDEWALK AND ANCILLARY ITEMS WITHIN THE STAGE 1 CONSTRUCTION ZONE.

STAGE 2:
 USE HIGHWAY STANDARDS AS NEEDED TO COMPLETE OTHER MINOR ITEMS AND CLEAN UP.

INSTALL LANDSCAPING.

REMOVE ALL TEMPORARY SIGNING AND TRAFFIC STAGING.

INSTALL PAVEMENT MARKINGS.

UNCOVER PERMANENT SIGNS.

FILE NAME=	USER NAME =	DESIGNED -- A.J.B	REVISED --	STATE OF ILLINOIS DEPARTMENT OF TRANSPORTATION	MAINTENANCE OF TRAFFIC PLAN			F.A.U. RTE.	SECTION	COUNTY	TOTAL SHEETS	SHEET NO.
		DRAWN -- TRD	REVISED --		SCALE: 1"=50'	SHEET 1 OF 1 SHEETS	STA. TO STA.	1552	14-00050-00-SW	COOK	23	12
	PLOT SCALE =	CHECKED -- MAP	REVISED --		GERMAN CHURCH ROAD PED IMPROVEMENT		CONTRACT NO. 61B38		FED. ROAD DIST. NO. 1 ILLINOIS FED. AID PROJECT			
	PLOT DATE =	DATE -- 01/28/2015	REVISED --									

S COUNTY LINE ROAD

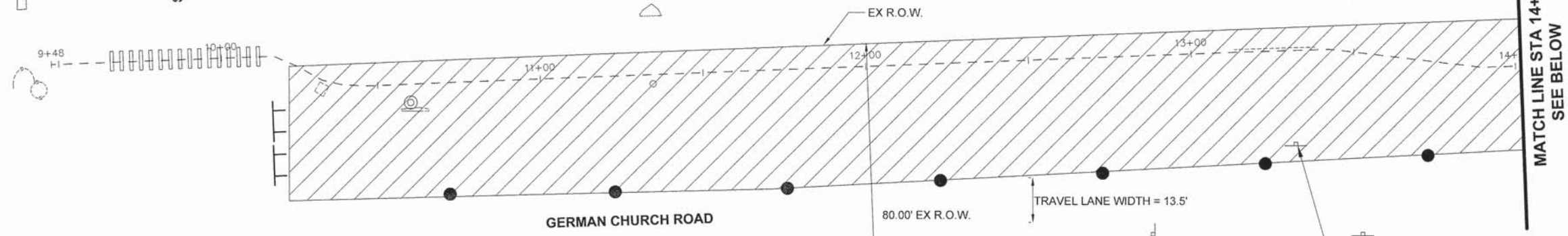
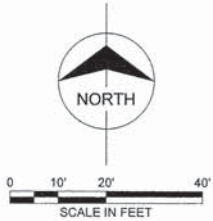

- LEGEND**
- WORK ZONE
 - TYPE III BARRICADES
 - CONE, DRUM OR BARRICADE

- NOTES:**
1. ADVANCE SIGNING FOR ROAD WORK SHALL BE PER IDOT STANDARD 701501-06
 2. WESTBOUND LANE CLOSURE WILL BE IN EFFECT FOR THE DURATION OF CONSTRUCTION
 3. CONE OR BARRICADE SPACING SHALL BE PER IDOT STANDARD 701501-06. POSITION ON EXISTING LANE PAVEMENT MARKINGS

WORK ZONE W21-1115(0)-3618
 SPEED LIMIT 40 R2-1-3648
 \$375 FINE MINIMUM R2-1106P-3618



FOR ADDITIONAL REQUIRED SIGNS, SEE SHEET NO. 13

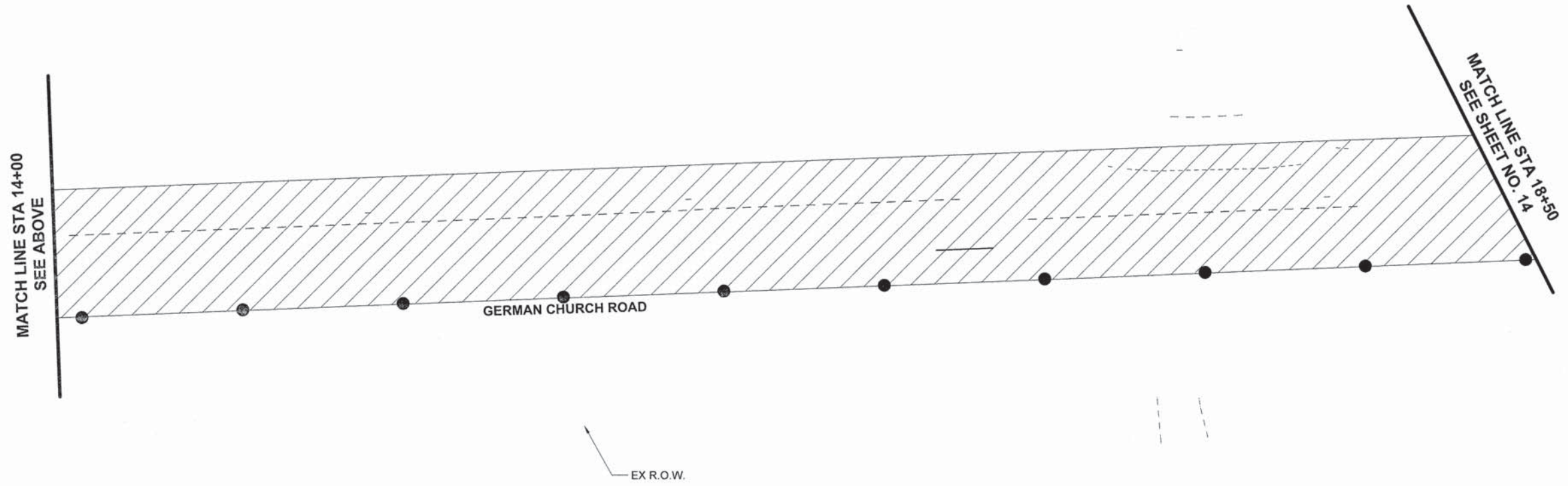

FILE NAME =	USER NAME =	DESIGNED -- AJB	REVISED --	STATE OF ILLINOIS DEPARTMENT OF TRANSPORTATION	MAINTENANCE OF TRAFFIC PLAN		F.A.U. RTE.	SECTION	COUNTY	TOTAL SHEETS	SHEET NO.
	PLOT SCALE =	DRAWN -- TRD	REVISED --				1552	14-00050-00-SW	COOK	23	12A
	PLOT DATE =	CHECKED -- MAP	REVISED --				GERMAN CHURCH ROAD PED IMPROVEMENT CONTRACT NO. 61B38				
	DATE -- 01/28/2015	REVISED --		SCALE: 1"=20'		SHEET 2 OF 3 SHEETS	STA. 9+48 TO STA. 18+50		FED. ROAD DIST. NO. 1 ILLINOIS FED. AID PROJECT		

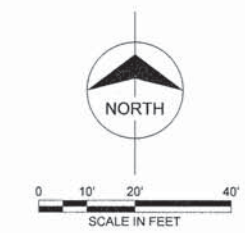

FOR ADDITIONAL REQUIRED SIGNS, SEE SHEET NO. 13

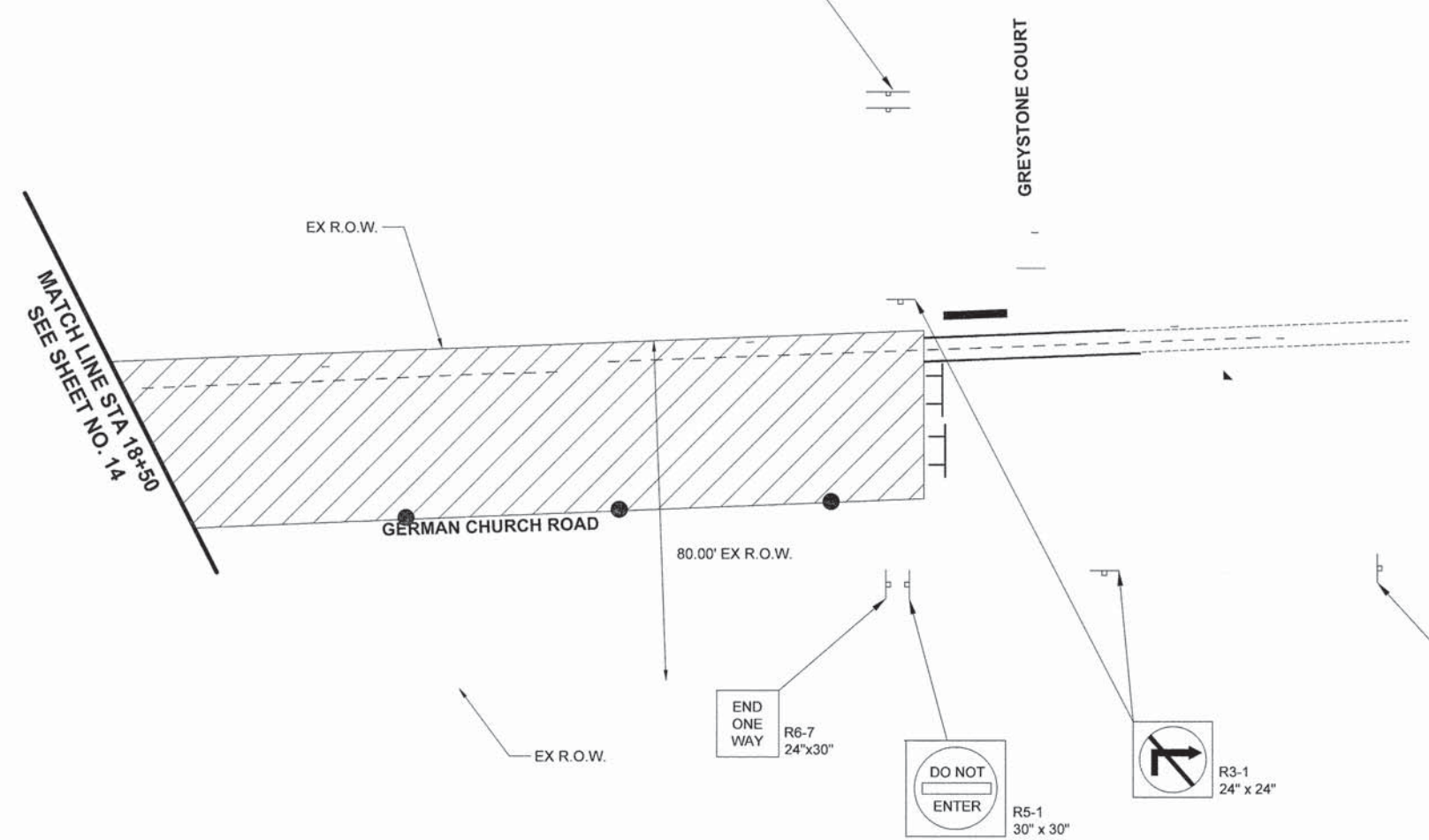

- LEGEND**
- WORK ZONE
 - TYPE III BARRICADES
 - CONE, DRUM OR BARRICADE

- NOTES:**
1. ADVANCE SIGNING FOR ROAD WORK SHALL BE PER IDOT STANDARD 701501-06
 2. WESTBOUND LANE CLOSURE WILL BE IN EFFECT FOR THE DURATION OF CONSTRUCTION
 3. CONE OR BARRICADE SPACING SHALL BE PER IDOT STANDARD 701501-06. POSITION ON EXISTING LANE PAVEMENT MARKINGS

FILE NAME =	USER NAME =	DESIGNED — A.J.B.	REVISED —	STATE OF ILLINOIS DEPARTMENT OF TRANSPORTATION	MAINTENANCE OF TRAFFIC PLAN	F.A.U. R.T.E.	SECTION	COUNTY	TOTAL SHEETS	SHEET NO.
	PLOT SCALE =	CHECKED — MAP	REVISED —			1552	14-00050-00-SW	COOK	23	12B
	PLOT DATE =	DATE — 01/28/2015	REVISED —			GERMAN CHURCH ROAD PED IMPROVEMENT		CONTRACT NO. 61B38		FED. ROAD DIST. NO. 1 ILLINOIS FED. AID PROJECT
SCALE: 1"=20'						SHEET 3 OF 3 SHEETS		STA. 18+50 TO STA. 21+17		

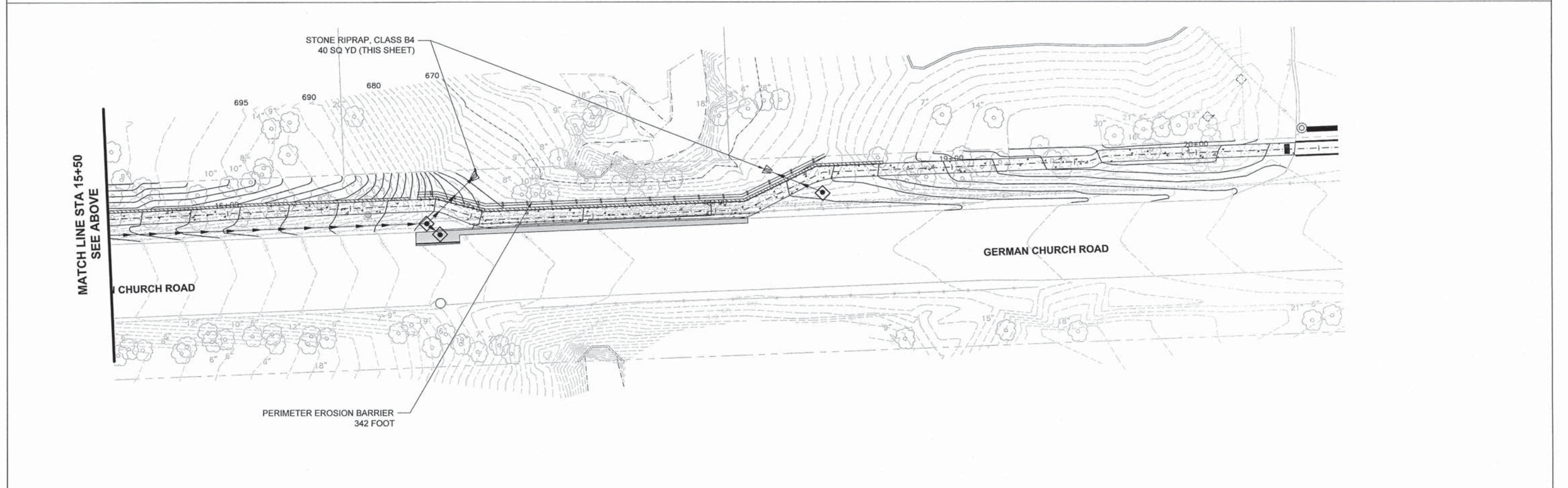
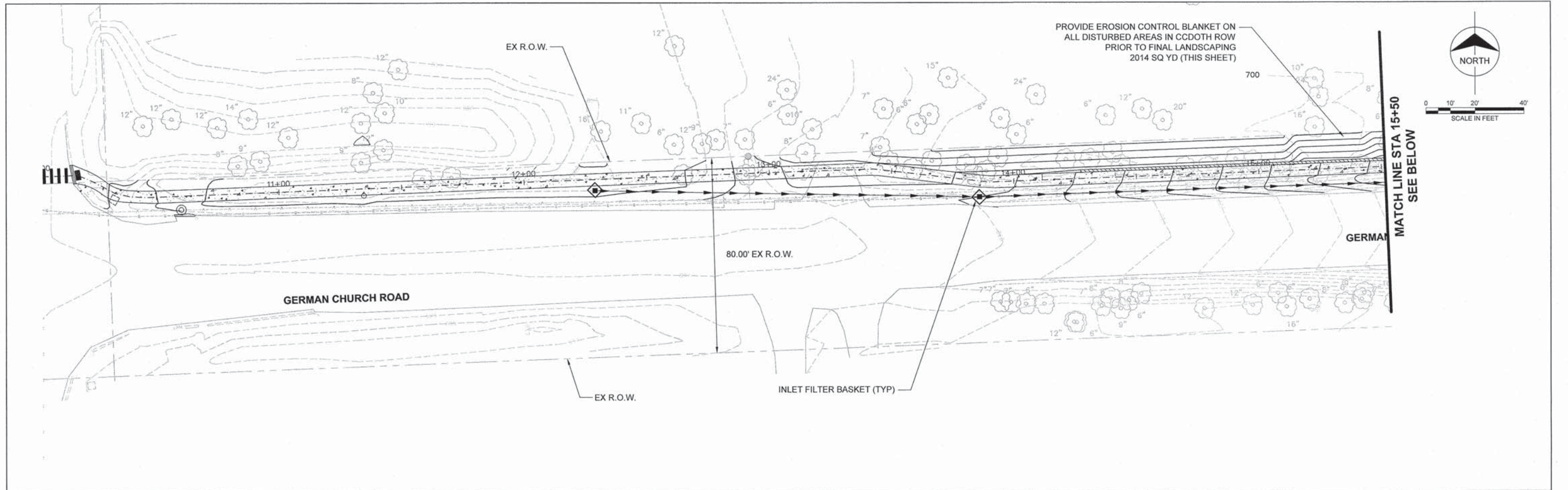

FILE NAME =	USER NAME =	DESIGNED -- A.J.B.	REVISED --	STATE OF ILLINOIS DEPARTMENT OF TRANSPORTATION	EROSION AND SEDIMENT CONTROL PLAN	F.A.U. RTE.	SECTION	COUNTY	TOTAL SHEETS	SHEET NO.	
		DRAWN -- TRD	REVISED --			1552	14-00050-00-SW	COOK	23	13	
		CHECKED -- MAP	REVISED --			GERMAN CHURCH ROAD PED IMPROVEMENT CONTRACT NO. 61B38					
		DATE -- 01/28/2015	REVISED --			FED. ROAD DIST. NO. 1 ILLINOIS FED. AID PROJECT					
				SCALE: 1"=20'		SHEET 1 OF 1 SHEETS		STA. 9+48 TO STA. 21+17			

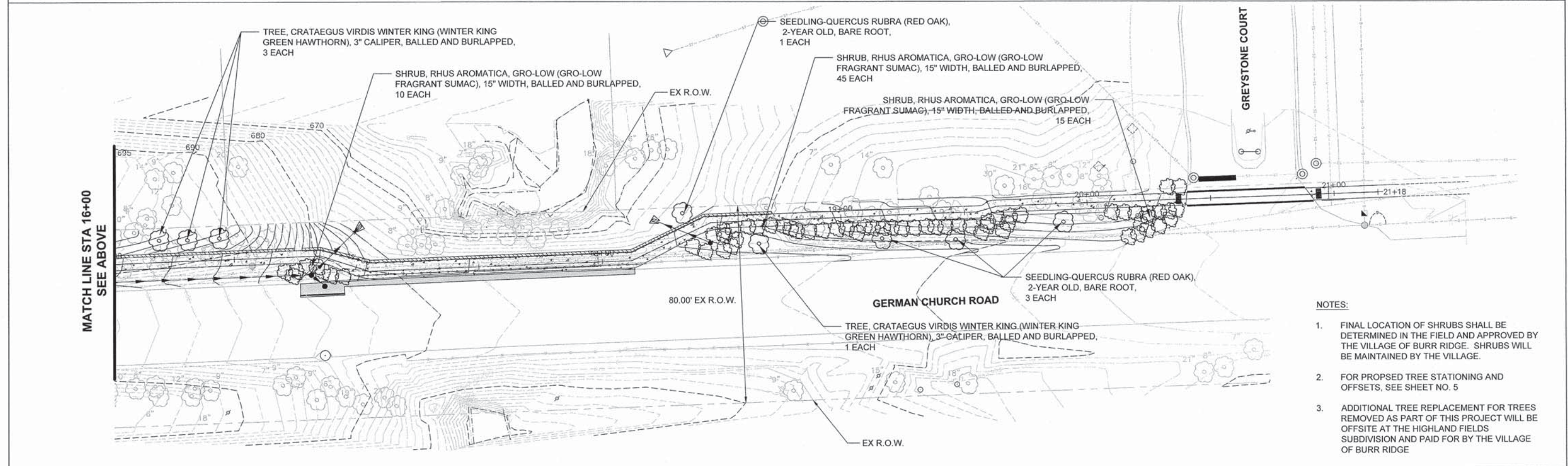
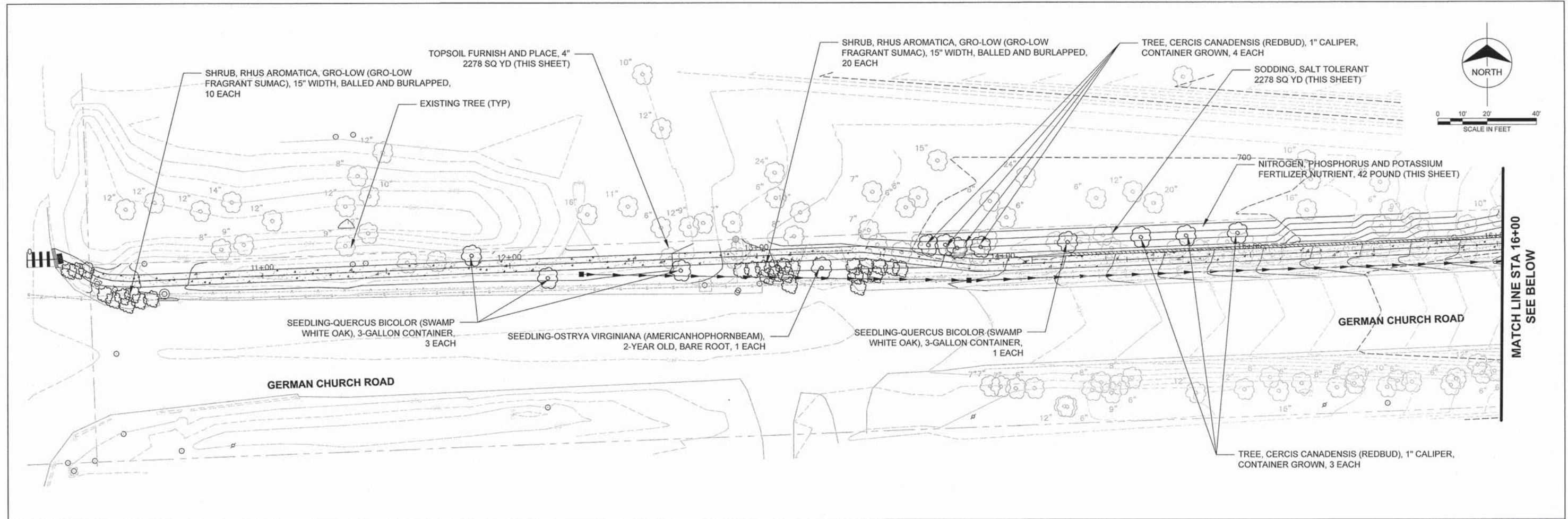

- NOTES:**
1. FINAL LOCATION OF SHRUBS SHALL BE DETERMINED IN THE FIELD AND APPROVED BY THE VILLAGE OF BURR RIDGE. SHRUBS WILL BE MAINTAINED BY THE VILLAGE.
 2. FOR PROPOSED TREE STATIONING AND OFFSETS, SEE SHEET NO. 5
 3. ADDITIONAL TREE REPLACEMENT FOR TREES REMOVED AS PART OF THIS PROJECT WILL BE OFFSITE AT THE HIGHLAND FIELDS SUBDIVISION AND PAID FOR BY THE VILLAGE OF BURR RIDGE

FILE NAME =	USER NAME =	DESIGNED --	AJB	REVISED --		STATE OF ILLINOIS DEPARTMENT OF TRANSPORTATION	LANDSCAPING PLAN	F.A.U. RTE.	SECTION	COUNTY	TOTAL SHEETS	SHEET NO.	
		DRAWN --	TRD	REVISED --				1552	14-00050-00-SW	COOK	23	14	
		CHECKED --	MAP	REVISED --				GERMAN CHURCH ROAD PED IMPROVEMENT CONTRACT NO. 61B38					
		DATE --	01/28/2015	REVISED --				FED. ROAD DIST. NO. 1 ILLINOIS FED. AID PROJECT					
SCALE: 1"=20'								SHEET 1 OF 1 SHEETS		STA. TO STA.			

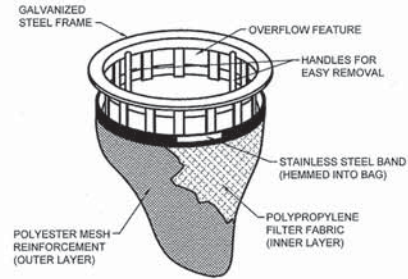

NOTE:
INSTALL TEMPORARY FILTER BASKET IN ALL STORM STRUCTURES WITH PERFORATED LID. REMOVE AFTER FINAL PAVING HAS BEEN COMPLETED.

FILTER BASKET
NTS

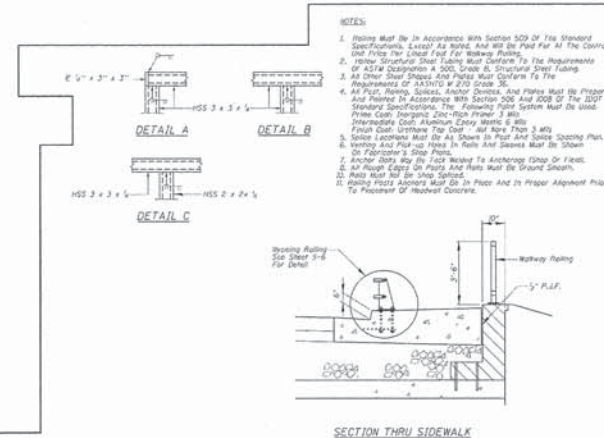

SECTION THRU SIDEWALK

BILL OF MATERIAL

Material	Qty	Unit	Quantity
Welding Rod	100	lb	2.00
Welding Gas	100	gal	1.00

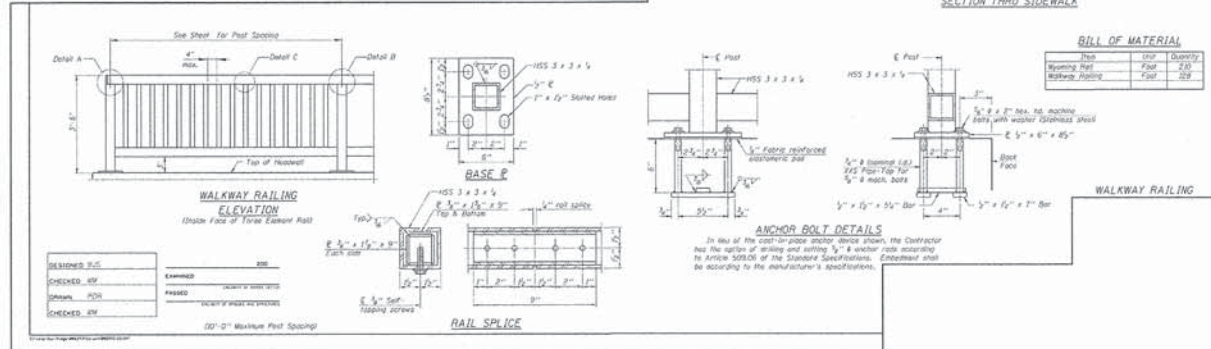

WALKWAY RAILING
ELEVATION

ANCHOR BOLT DETAILS

RAIL SPLICE

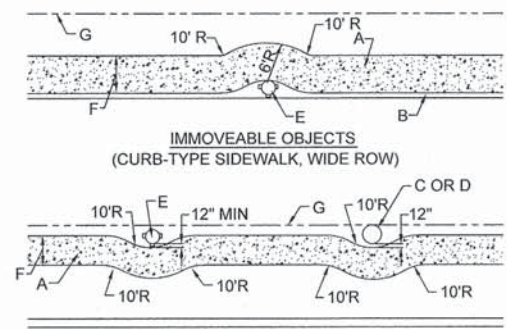

IMMOVEABLE OBJECTS
(SIDEWALK WITH PARKWAY)

SIDEWALK OBSTRUCTIONS
NOT TO SCALE

CONSTRUCTION NOTE:

- A. SIDEWALK
- B. CURB
- C. SERVICE POLE, SEE NOTES 1 AND 2.
- D. TREE TRUNK, SEE NOTE 1
- E. FIRE HYDRANT, SEE NOTES 1 AND 2.
- F. SIDEWALK WIDTH.
- G. RIGHT-OF-WAY (ROW)

GENERAL NOTES:

- 1. A FIRE HYDRANT, SERVICE POLE OR TREE TRUNK SHALL BE CONSIDERED IMMOVEABLE ONLY WHEN DIRECTED BY THE VILLAGE ENGINEER.
- 2. WHEN A SERVICE POLE OR FIRE HYDRANT IS LOCATED WITHIN THE SIDEWALK AREA, AND IS CONSIDERED IMMOVEABLE, A 1/2" EXPANSION JOINT SHALL BE INSTALLED ENCIRCLING THE OBJECT. THIS WORK SHALL BE INCIDENTAL TO THE SIDEWALK COST.

LEGEND

- A. 5' NORMAL WIDTH OR AS INDICATED ON PLANS
- B. AGGREGATE BASE COURSE, TY. B, 4" THICK, (CA-6)
- C. P.C.C. SIDEWALK
- D. SLOPE 1/4" PER FOOT MAXIMUM TO STREET SIDE, OR AS NOTED ON PLAN
- E. JOINTS, SEE NOTES 3 AND 4
- F. SLOPE 2% TO 8% TOWARDS STREET, OR AS NOTED ON PLAN
- G. CONCRETE THICKNESS, SEE NOTE 1
- H. COMPACTED SUBGRADE TO 95% OF THE STANDARD LABORATORY DENSITY

GENERAL NOTES

- 1. STANDARD THICKNESS OF PCC SIDEWALK SHALL BE A MINIMUM OF 5 INCHES. THICKNESS SHALL BE 8 INCHES ACROSS DRIVEWAY ENTRANCE.
- 2. WHERE WOODEN FORMS ARE USED, 2x4's ARE NOT ALLOWED. ONLY 2x6's SHALL BE USED.
- 3. PREFORMED 3/4" EXPANSION JOINTS SHALL BE CONSTRUCTED AT MAX. SPACING OF 40'.
- 4. FORMED OR SAW-CUT CONTRACTION JOINTS SHALL BE SPACED GENERALLY 5' APART, BUT NO LESS THAN 4' AND NO MORE THAN 6'.
- 5. 1/2" FOAM EXPANSION JOINTS SHALL BE INSTALLED WHERE SIDEWALK ABUTS BUILDINGS, TRAFFIC SIGNAL FOUNDATIONS, SERVICE POLES, AND OTHER IMMOVEABLE STRUCTURES.
- 6. CONCRETE TO BE MINIMUM 6-BAG MIX.

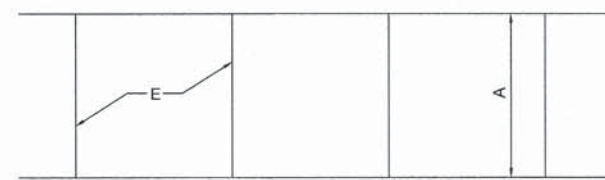

PLAN

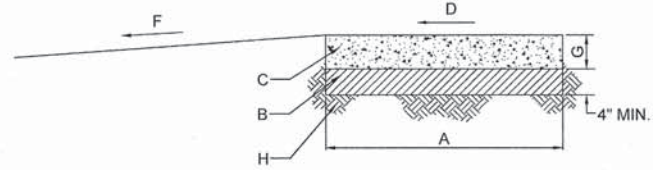

SIDEWALK DETAIL

P.C.C. SIDEWALK 5"
NOT TO SCALE

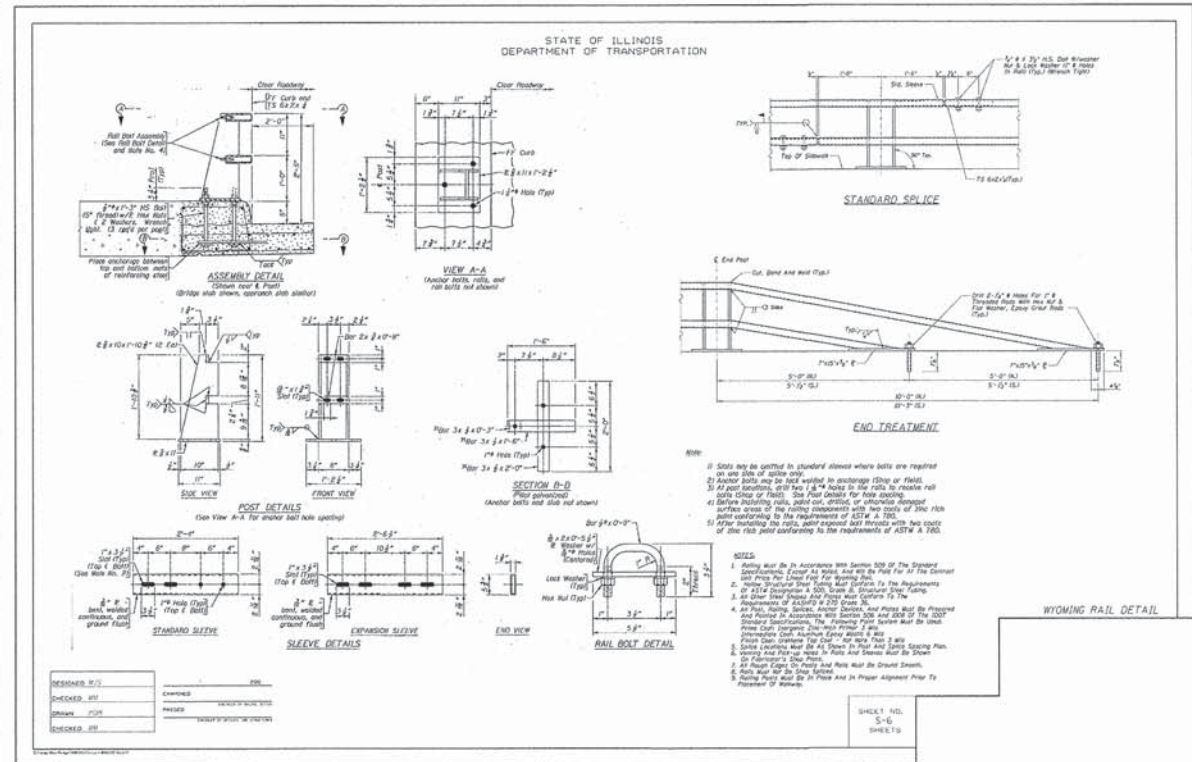

WYOMING RAIL DETAIL

FILE NAME =	USER NAME =	DESIGNED -- AJB	REVISED --
		DRAWN -- TRD	REVISED --
		CHECKED -- MAP	REVISED --
		DATE -- 01/28/2015	REVISED --

STATE OF ILLINOIS
DEPARTMENT OF TRANSPORTATION

SCALE: NONE	SHEET 1 OF 3 SHEETS	STA. TO STA.
-------------	---------------------	--------------

F.A.U. RTE.	SECTION	COUNTY	TOTAL SHEETS	SHEET NO.
1552	14-00050-00-SW	COOK	23	15
GERMAN CHURCH ROAD PED IMPROVEMENT			CONTRACT NO. 61B38	
FED. ROAD DIST. NO. 1 ILLINOIS FED. AID PROJECT				

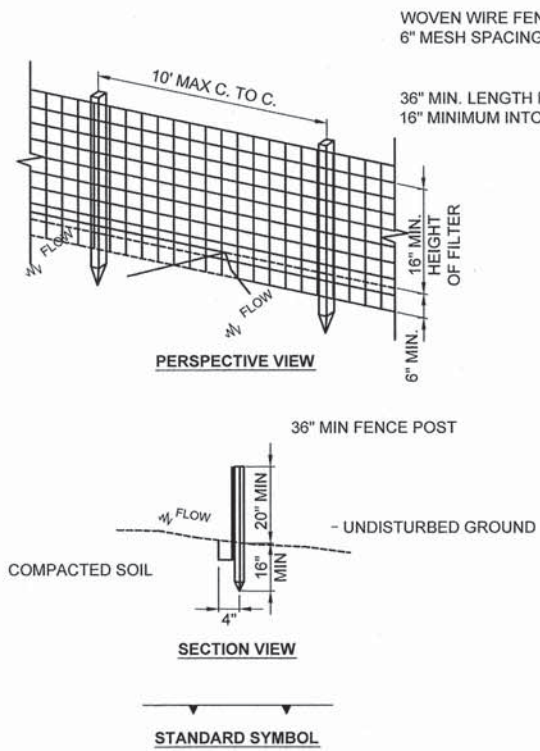

- CONSTRUCTION SPECIFICATIONS**
1. WOVEN WIRE FENCE TO BE FASTENED SECURELY TO FENCE POSTS WITH WIRE TIES OR STAPLES. POSTS SHALL BE STEEL EITHER "T" OR "U" TYPE OR HARDWOOD.
 2. FILTER CLOTH TO BE FASTENED SECURELY TO WOVEN WIRE FENCE WITH TIES SPACED EVERY 24" AT TOP AND MID SECTION. FENCE SHALL BE WOVEN WIRE, 6" MAXIMUM MESH OPENING.
 3. WHEN TWO SECTIONS OF FILTER CLOTH ADJOIN EACH OTHER THEY SHALL BE OVERLAPPED BY SIX INCHES AND FOLDED. FILTER CLOTH SHALL BE EITHER FILTER X, MIRAFI 100X, STABILINKA T140N, OR APPROVED EQUIVALENT.
 4. PREFABRICATED UNITS SHALL BE GEOFAB, ENVIROFENCE, OR APPROVED EQUIVALENT.
 5. MAINTENANCE SHALL BE PERFORMED AS NEEDED AND MATERIAL REMOVED WHEN "BULGES" DEVELOP IN THE SILT FENCE.

EROSION CONTROL SILT FENCE DETAIL
NTS

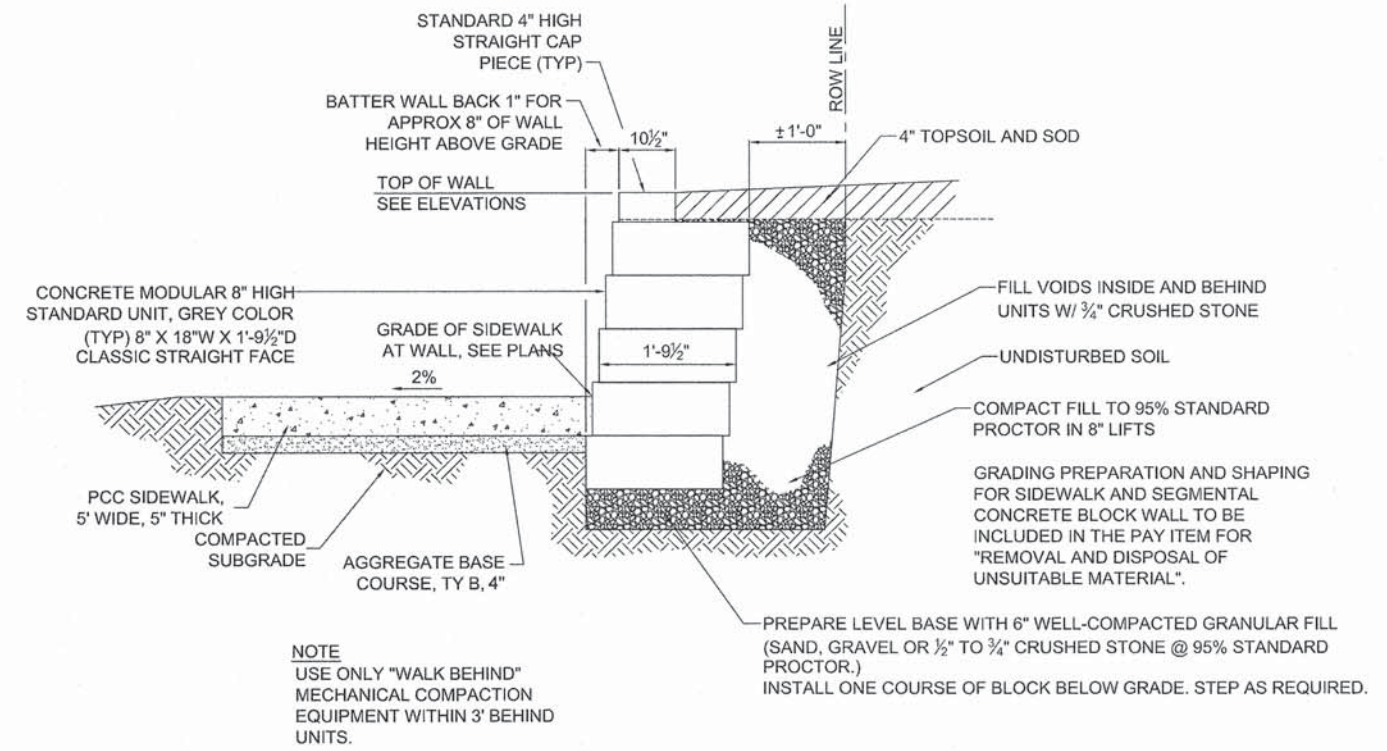

SEGMENTAL CONCRETE BLOCK WALL
TYPICAL SECTION
NOT TO SCALE

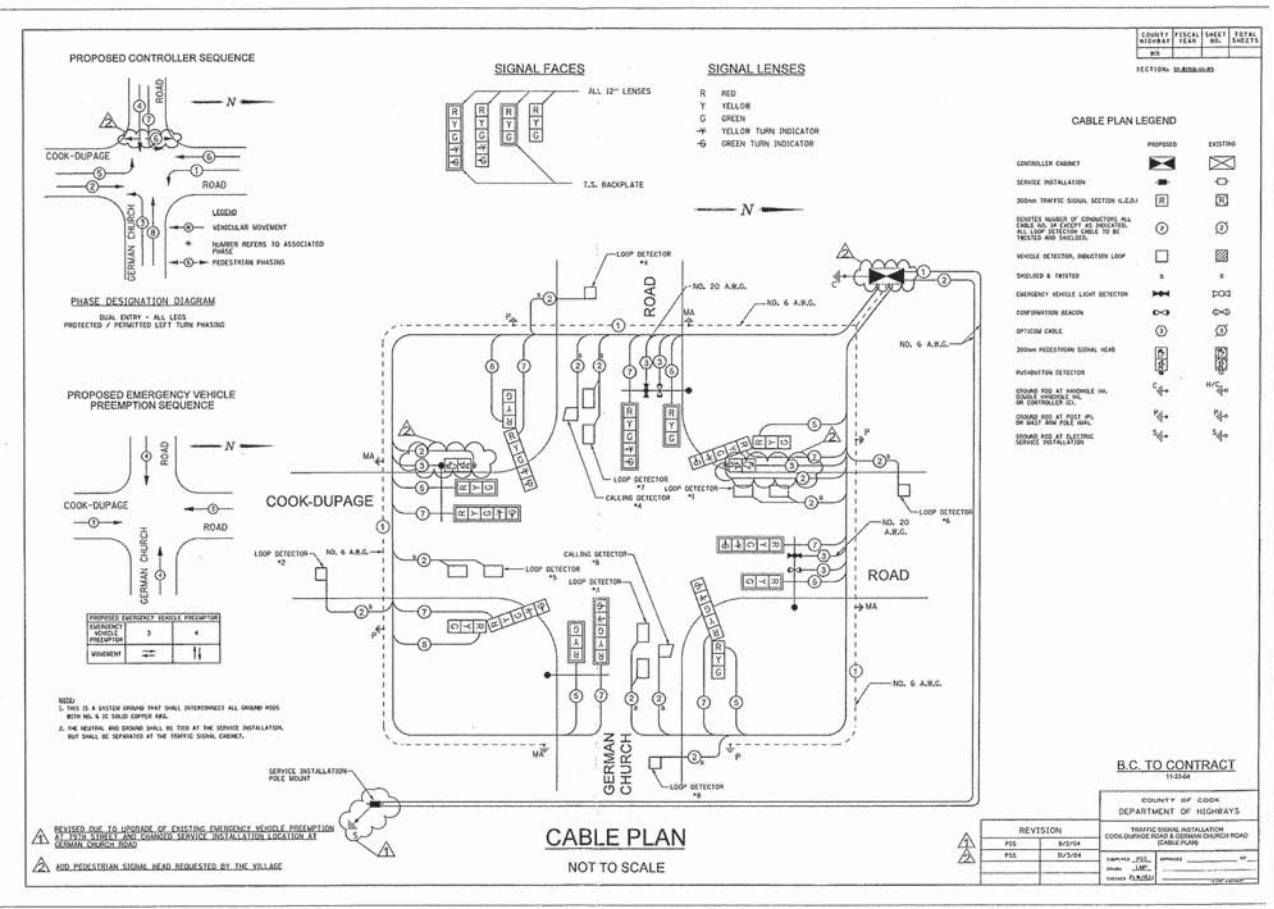
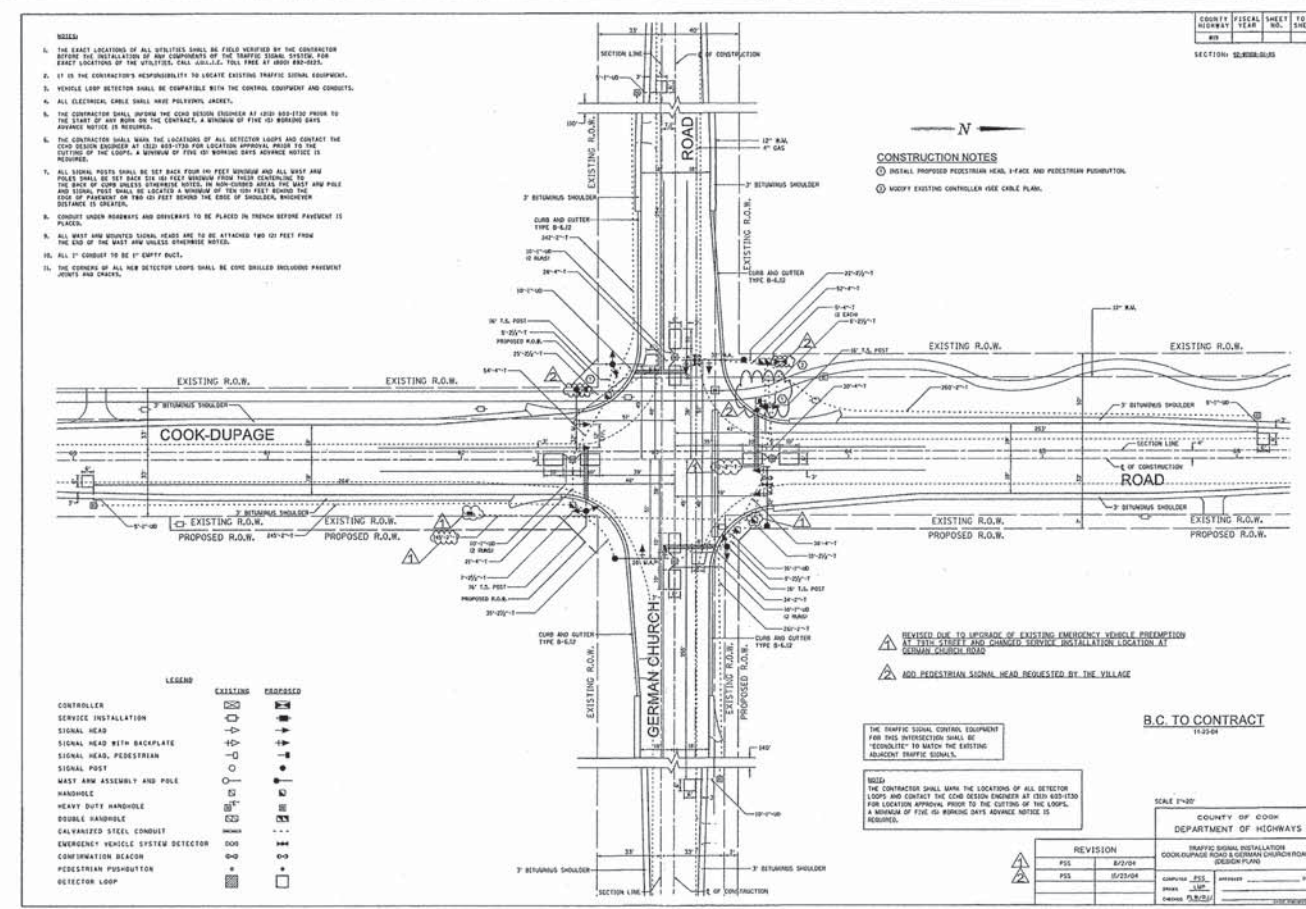

	Size	Bar List Length	Quantity	Weight
t ₁ (E)	6	8.17	246	3018
t ₂ (E)	5	8.17	246	2095
w1(E)	5	10.17	16	170
w2(E)	5	19.67	16	328
w3(E)	5	18.92	16	316
w4(E)	5	29.67	16	495
w5(E)	5	32.17	32	1074
w6(E)	5	16.08	32	537
w7(E)	5	13.50	8	113
w8(E)	5	16.00	8	134
w9(E)	5	8.17	8	68
w10(E)	5	8.92	8	74
w11(E)	5	5.67	8	47
w12(E)	5	21.25	16	355
n1(E)	6	4.33	240	1562
n2(E)	4	3.25	160	347
v1(E)	5	6.67	117	814
v2(E)	5	5.75	31	186
v3(E)	5	7.50	50	391
v4(E)	4	6.67	95	423
v5(E)	4	5.75	25	96
v6(E)	4	7.50	41	205
h1(E)	4	9.42	14	88
h2(E)	4	20.83	14	195
h3(E)	4	17.08	12	137
h4(E)	4	29.67	16	317
h5(E)	4	31.83	28	595
h6(E)	4	27.33	24	438
h7(E)	4	9.33	14	87
h8(E)	4	13.17	4	35
				14,741

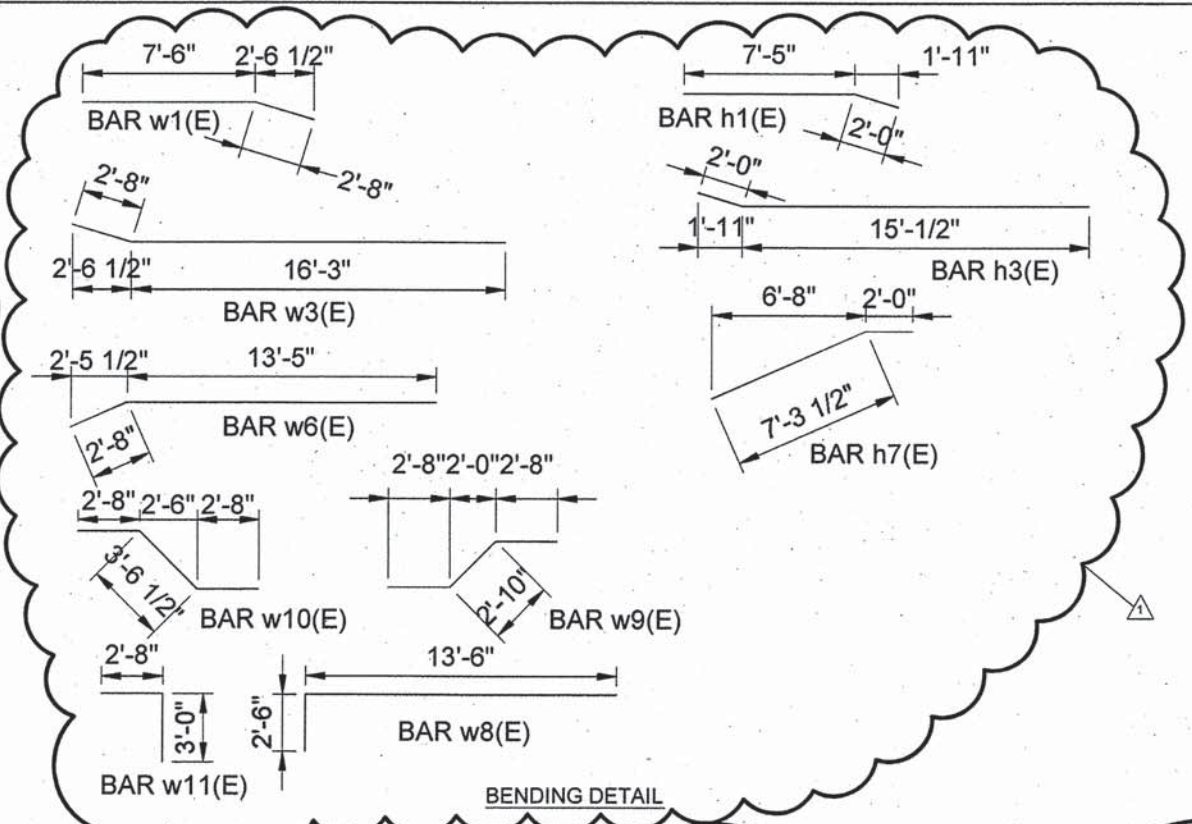

BILL OF MATERIAL		
ITEM	UNIT	TOTAL
STRUCTURE EXCAVATION	CU YD	414
CONCRETE STRUCTURES	CU YD	112
REINFORCEMENT BARS, EPOXY COATED	POUND	14741
POROUS GRANULAR BACKFILL	CU YD	165
GEOCOMPOSITE WALL DRAIN	SQ YD	200
PIPE UNDERDRAINS FOR STRUCTURES 4"	FOOT	200
FURNISHED EXCAVATION	CU YD	146
TEMPORARY SOIL RETENTION SYSTEM	SQ FT	1755

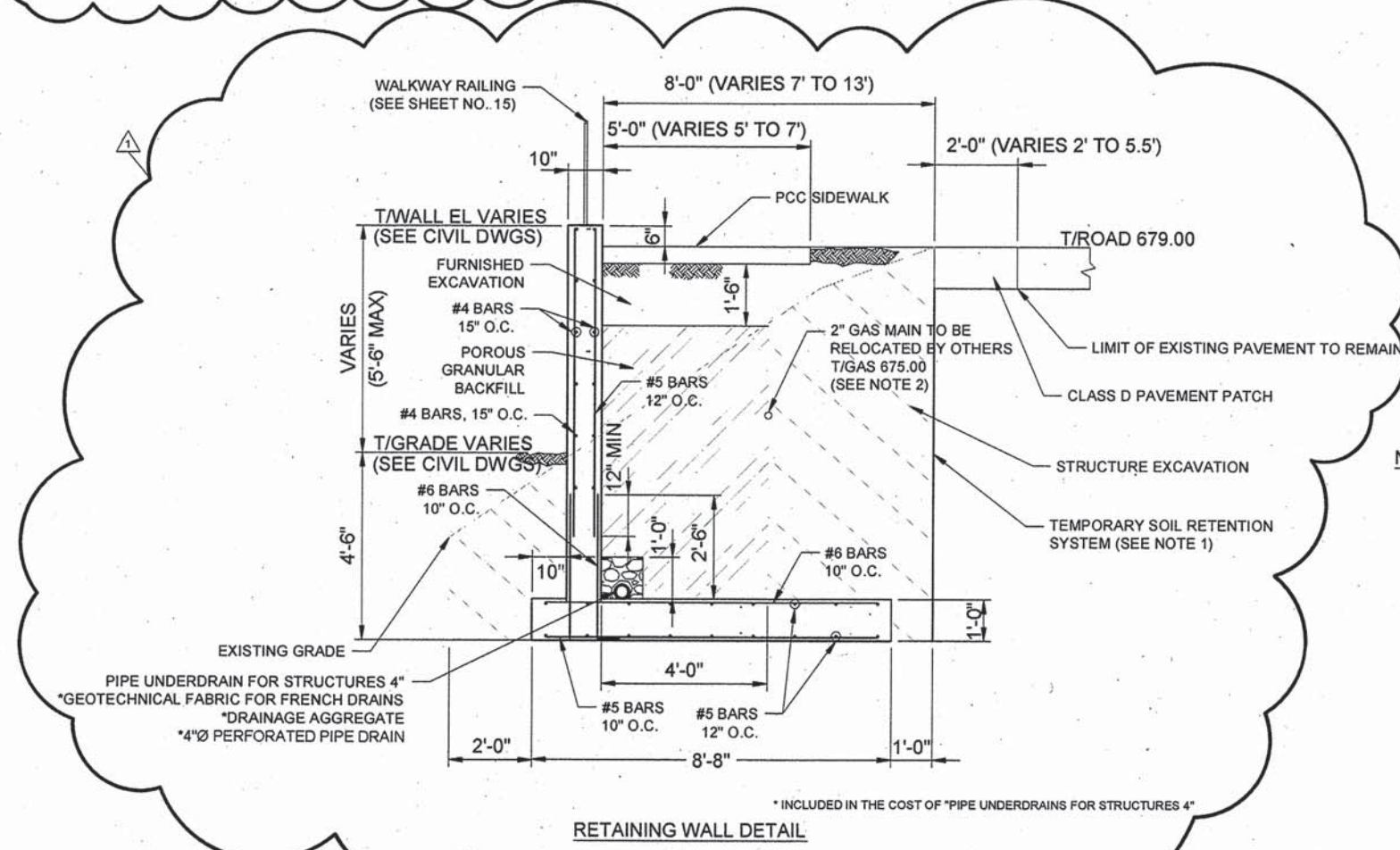

- NOTES:
- CONTRACTOR SHALL DESIGN AND PROVIDE THIS SYSTEM. REFER TO IDOT GUIDE BRIDGE SPECIAL PROVISIONS 44 (GBSP 44) INSTRUCTIONS.
 - CONTRACTOR SHALL PROVIDE TEMPORARY PROTECTION FOR ALL UNDERGROUND UTILITIES LOCATED WITHIN EXCAVATION LIMITS.

FILE NAME =	USER NAME =	DESIGNED -	REVISION -	DATE -
		AJB	06/02/2015	
		TRD		
PLOT SCALE =	CHECKED -	MAP	REVISION -	
PLOT DATE =	DATE -	01/28/2015	REVISION -	

STATE OF ILLINOIS
DEPARTMENT OF TRANSPORTATION

SCALE: NONE	SHEET 1 OF 3 SHEETS	STA. TO STA.
-------------	---------------------	--------------

F.A.U. RTE.	SECTION	COUNTY	TOTAL SHEETS	SHEET NO.
1552	14-00050-00-SW	COOK	23	17
GERMAN CHURCH ROAD PED IMPROVEMENT		CONTRACT NO. 61B38		
FED. ROAD DIST. NO. 1 ILLINOIS FED. AID PROJECT				

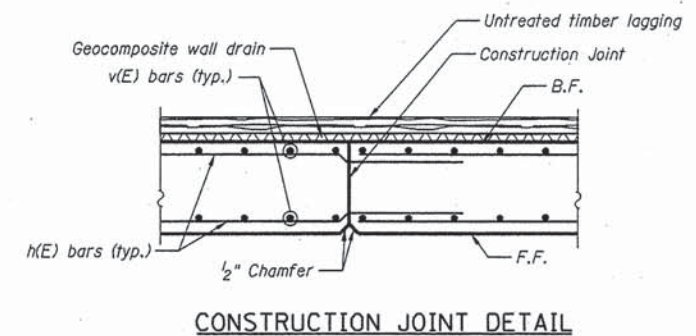
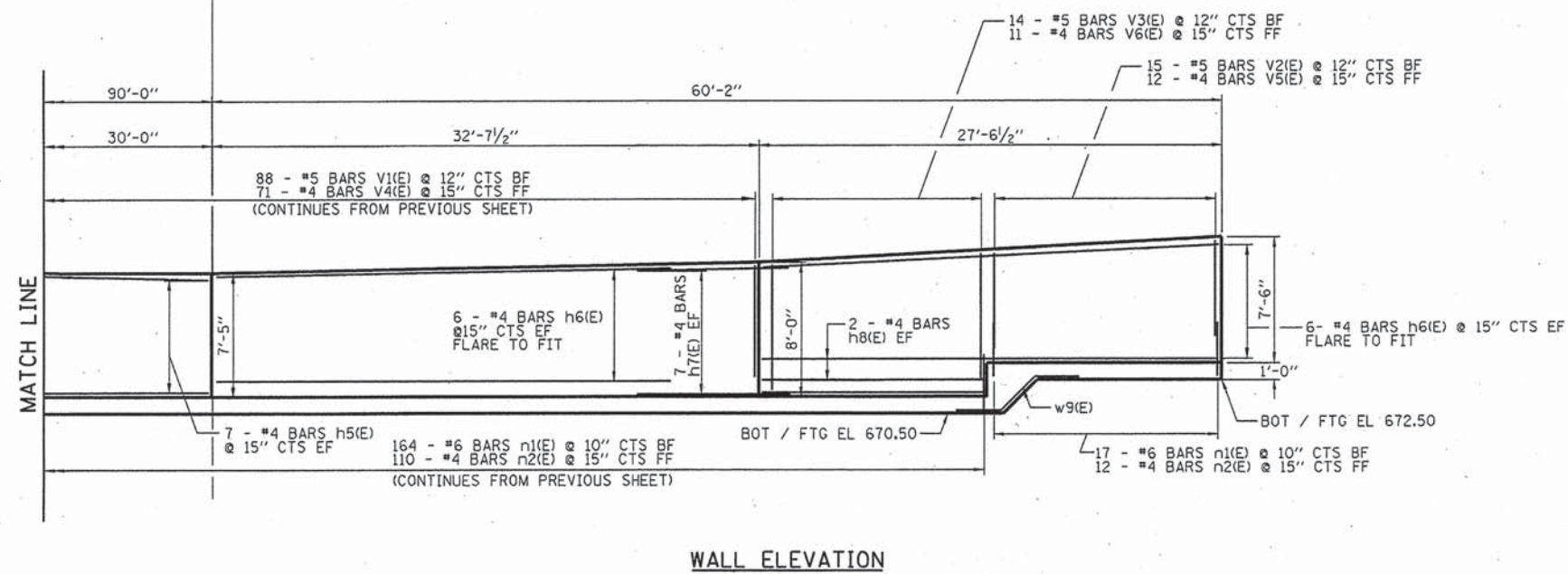
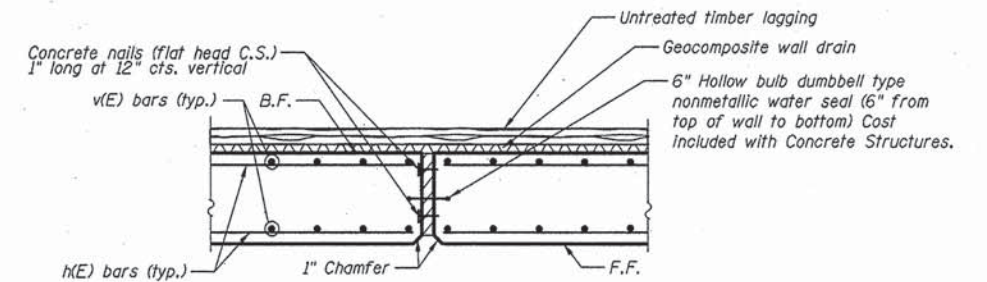
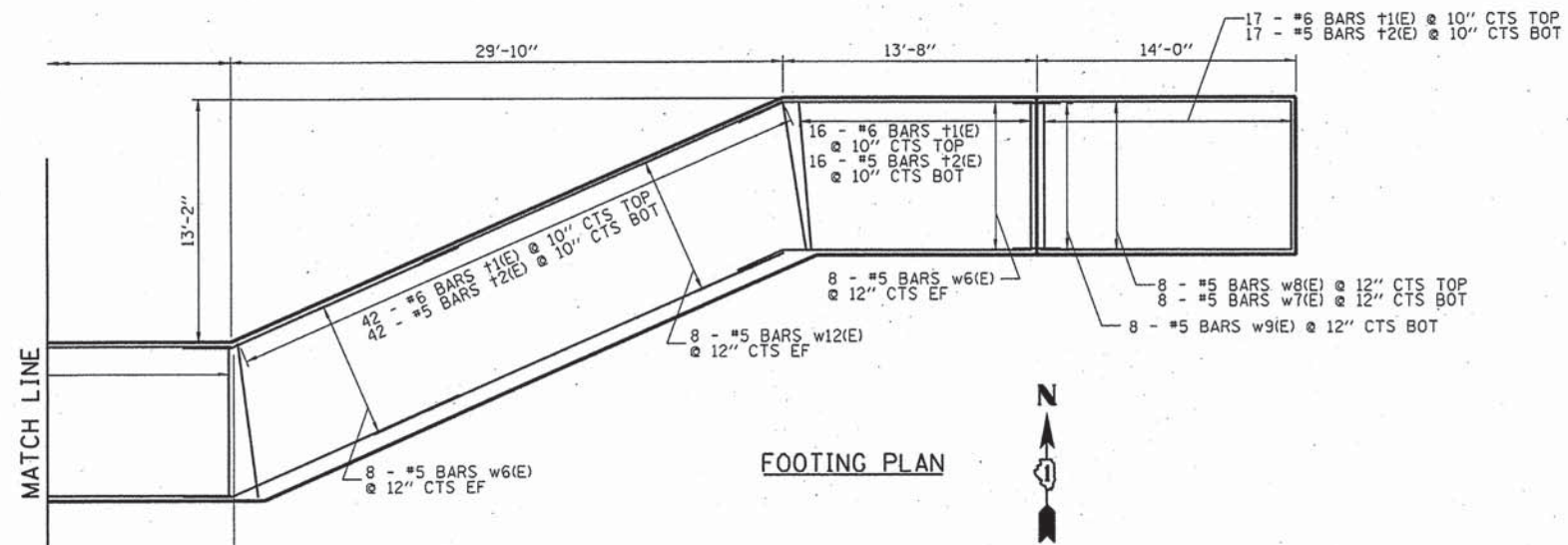

FILE NAME = 74445-shl-wall12.dgn	USER NAME = mpepruk	DESIGNED - JAR	REVISED - 06/02/2015
		DRAWN - MAP	REVISED -
		CHECKED - JAR	REVISED -
		DATE - 6/2/2015	REVISED -

STATE OF ILLINOIS
DEPARTMENT OF TRANSPORTATION

RETAINING WALL
PLAN AND ELEVATION

SCALE: 1"=10' SHEET 2 OF 2 SHEETS STA. TD STA.

F.A. RTE.	SECTION	COUNTY	TOTAL SHEETS	SHEET NO.
1552	14-00050-00-SW	COOK	23	178
CONTRACT NO. 61B38			ILLINOIS FED. AID PROJECT	

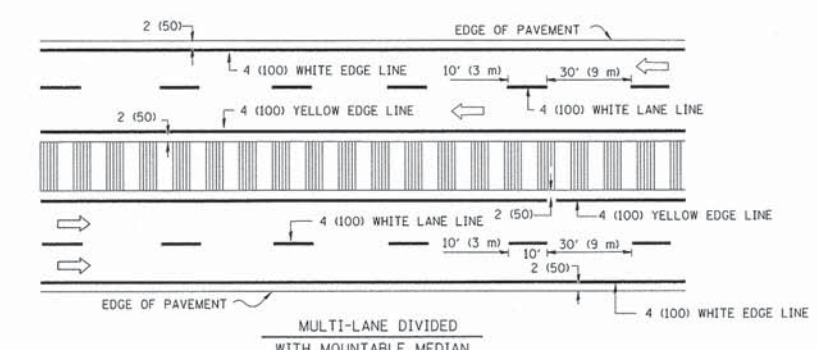
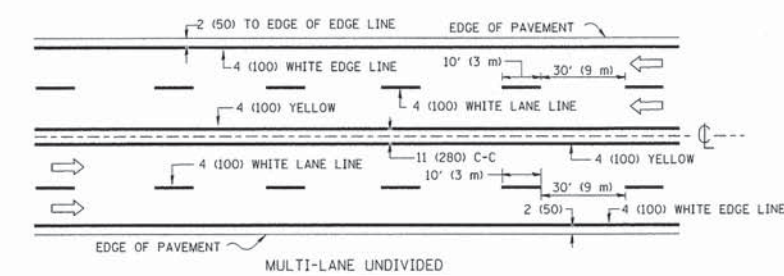
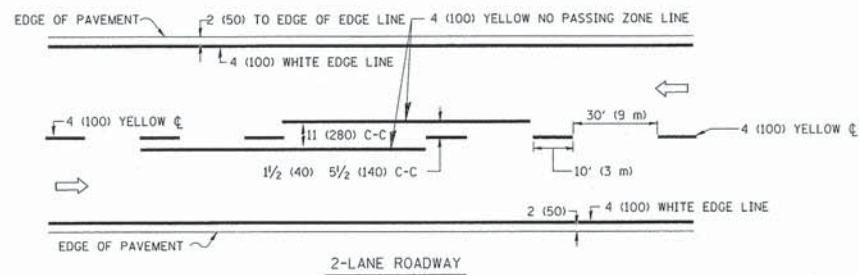

NOTE: MEDIANS WITH BARRIER CURB DO NOT REQUIRE AN EDGE LINE

TYPICAL LANE AND EDGE LINE MARKING

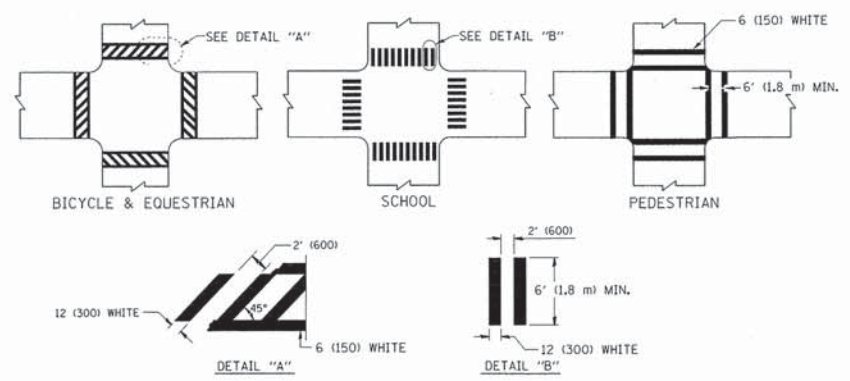

TYPICAL CROSSWALK MARKING

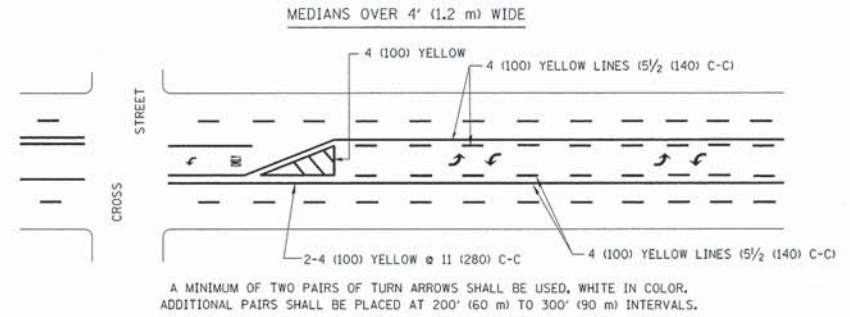
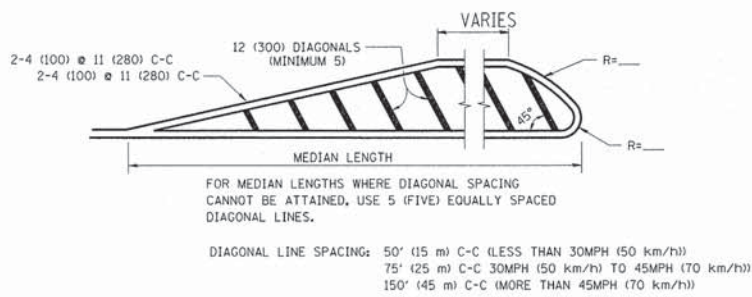
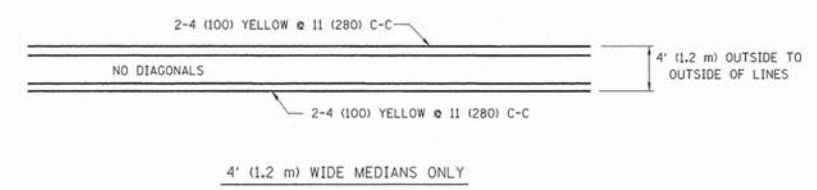

TYPICAL PAINTED MEDIAN MARKING

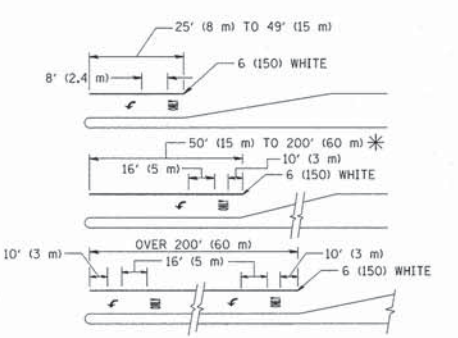

TYPICAL TURN LANE MARKING

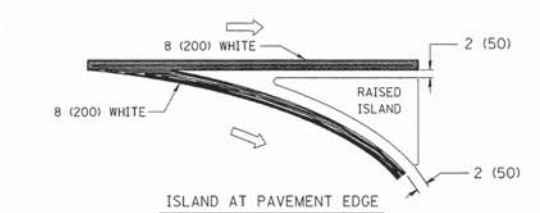
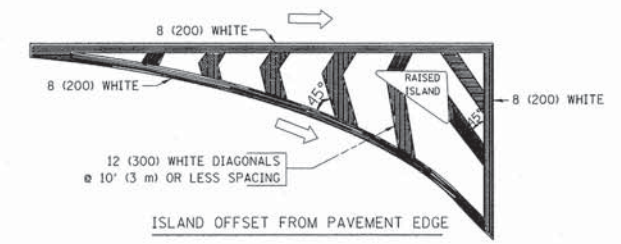

TYPICAL ISLAND MARKING

TYPE OF MARKING	WIDTH OF LINE	PATTERN	COLOR	SPACING / REMARKS
CENTERLINE ON 2 LANE PAVEMENT	4 (100)	SKIP-DASH	YELLOW	10' (3 m) LINE WITH 30' (9 m) SPACE
CENTERLINE ON MULTI-LANE UNDIVIDED PAVEMENT	2 @ 4 (100)	SOLID	YELLOW	11 (280) C-C
NO PASSING ZONE LINES FOR ONE DIRECTION FOR BOTH DIRECTIONS	4 (100) 2 @ 4 (100)	SOLID SOLID	YELLOW YELLOW	5 1/2 (140) C-C FROM SKIP-DASH CENTERLINE 11 (280) C-C OMIT SKIP-DASH CENTERLINE BETWEEN
LANE LINES	4 (100) 5 (125) ON FREEWAYS	SKIP-DASH SKIP-DASH	WHITE WHITE	10' (3 m) LINE WITH 30' (9 m) SPACE
DOTTED LINES (EXTENSIONS OF CENTER, LANE OR TURN LANE MARKINGS)	SAME AS LINE BEING EXTENDED	SKIP-DASH	SAME AS LINE BEING EXTENDED	2' (600) LINE WITH 6' (1.8 m) SPACE
EDGE LINES	4 (100)	SOLID	YELLOW-LEFT WHITE-RIGHT	OUTLINE MOUNTABLE MEDIANS IN YELLOW; EDGE LINES ARE NOT USED NEXT TO BARRIER CURB
TURN LANE MARKINGS	6 (150) LINE; FULL SIZE LETTERS & SYMBOLS (8' (2.4m))	SOLID	WHITE	SEE TYPICAL TURN LANE MARKING DETAIL
TWO WAY LEFT TURN MARKING	2 @ 4 (100) EACH DIRECTION 8' (2.4m) LEFT ARROW	SKIP-DASH AND SOLID IN PAIRS	YELLOW WHITE	10' (3 m) LINE WITH 30' (9 m) SPACE FOR SKIP-DASH; 5 1/2 (140) C-C BETWEEN SOLID LINE AND SKIP-DASH LINE SEE TYPICAL TWO-WAY LEFT TURN MARKING DETAIL
CROSSWALK LINES (PEDESTRIAN) A. DIAGONALS (BIKE & EQUESTRIAN) B. LONGITUDINAL BARS (SCHOOL)	2 @ 6 (150) 12 (300) @ 45° 12 (300) @ 90°	SOLID SOLID SOLID	WHITE WHITE WHITE	NOT LESS THAN 6' (1.8 m) APART 2' (600) APART 2' (600) APART SEE TYPICAL CROSSWALK MARKING DETAILS.
STOP LINES	24 (600)	SOLID	WHITE	PLACE 4' (1.2 m) IN ADVANCE OF AND PARALLEL TO CROSSWALK, IF PRESENT, OTHERWISE, PLACE AT DESIRED STOPPING POINT, PARALLEL TO CROSSROAD CENTERLINE, WHERE POSSIBLE
PAINTED MEDIANS	2 @ 4 (100) WITH 12 (300) DIAGONALS @ 45° NO DIAGONALS USED FOR 4' (1.2 m) WIDE MEDIANS	SOLID	YELLOW: TWO WAY TRAFFIC WHITE: ONE WAY TRAFFIC	11 (280) C-C FOR THE DOUBLE LINE SEE TYPICAL PAINTED MEDIAN MARKING.
GORE MARKING AND CHANNELIZING LINES	8 (200) WITH 12 (300) DIAGONALS @ 45°	SOLID	WHITE	DIAGONALS: 15' (4.5 m) C-C (LESS THAN 30MPH (50 km/h)) 20' (6 m) C-C (30MPH (50 km/h) TO 45MPH (70 km/h)) 30' (9 m) C-C (OVER 45MPH (70 km/h))
RAILROAD CROSSING	24 (600) TRANSVERSE LINES; "RR" IS 6' (1.8 m) LETTERS; 16 (400) LINE FOR "X"	SOLID	WHITE	SEE STATE STANDARD 780001 AREA OF: "R"=3.6 SQ. FT. (0.33 m ²) EACH "X"=54.0 SQ. FT. (5.0 m ²)
SHOULDER DIAGONALS	12 (300) @ 45°	SOLID	WHITE - RIGHT YELLOW - LEFT	50' (15 m) C-C (LESS THAN 30MPH (50 km/h)) 75' (25 m) C-C (30 MPH (50 km/h) TO 45MPH (70 km/h)) 150' (45 m) C-C (OVER 45MPH (70 km/h))

FOR FURTHER DETAILS ON PAVEMENT MARKING REFER TO STANDARD SPECIFICATIONS FOR ROAD AND BRIDGE CONSTRUCTION AND STATE STANDARD 780001.

All dimensions are in inches (millimeters) unless otherwise shown.

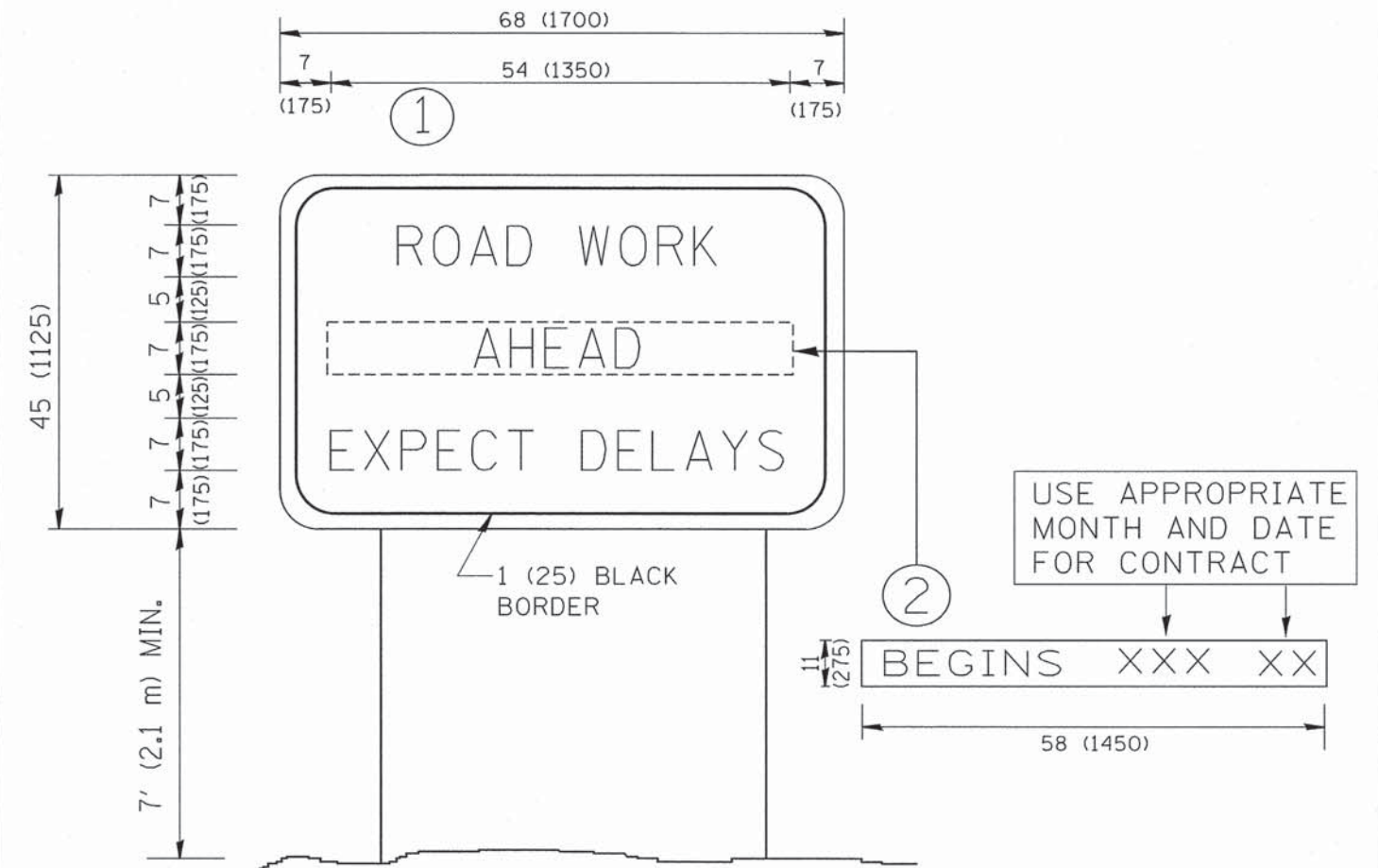

NOTES:

1. USE BLACK LETTERING ON ORANGE BACKGROUND.
2. ERECT SIGNS IN ADVANCE OF THE LOCATION FOR THE "ROAD CONSTRUCTION AHEAD" SIGN AT LOCATIONS AS DIRECTED BY THE ENGINEER.
3. ERECT SIGN ① WITH INSTALLED PANEL ② ONE WEEK PRIOR TO THE START OF CONSTRUCTION.
4. REMOVE PANEL ② SOON AFTER THE START OF CONSTRUCTION.
5. SEE SPECIAL PROVISION FOR "TEMPORARY INFORMATION SIGNING" FOR ADDITIONAL INFORMATION.
6. ONE SIGN ASSEMBLY EQUALS 25.70 SQ. FT. (2.3 SQ. M.)
7. SHALL BE PAID FOR AS TEMPORARY INFORMATION SIGNING.

ALL DIMENSIONS ARE IN INCHES (MILLIMETERS) UNLESS OTHERWISE SHOWN.

FILE NAME = W:\diststd\22x34\to22.dgn	USER NAME = geglianobt	DESIGNED -	REVISED - R. MIRS 09-15-97	STATE OF ILLINOIS DEPARTMENT OF TRANSPORTATION	ARTERIAL ROAD INFORMATION SIGN			F.A. RTE.	SECTION	COUNTY	TOTAL SHEETS	SHEET NO.		
		DRAWN -	REVISED - R. MIRS 12-11-97		SCALE: NONE	SHEET NO. 1	OF 1 SHEETS	STA.	TO STA.	1552	14-00500-00-SW	COOK	23	20
		PLOT SCALE = 50,000 ' / IN.	CHECKED -		REVISED - T. RAMMACHER 02-02-99				TC-22		CONTRACT NO. 61B38			
		PLOT DATE = 1/4/2008	DATE -		REVISED - C. JUCIUS 01-31-07				FED. ROAD DIST. NO. 1 ILLINOIS FED. AID PROJECT					

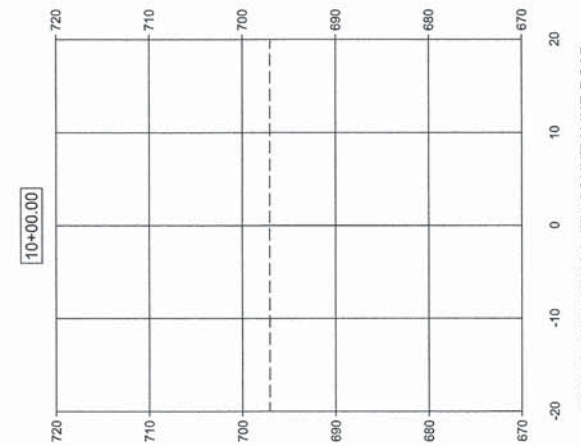
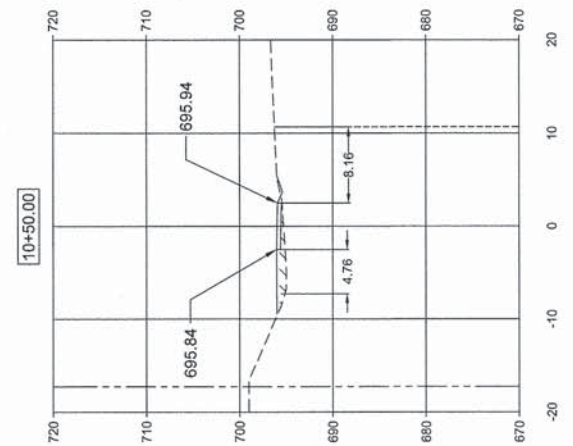
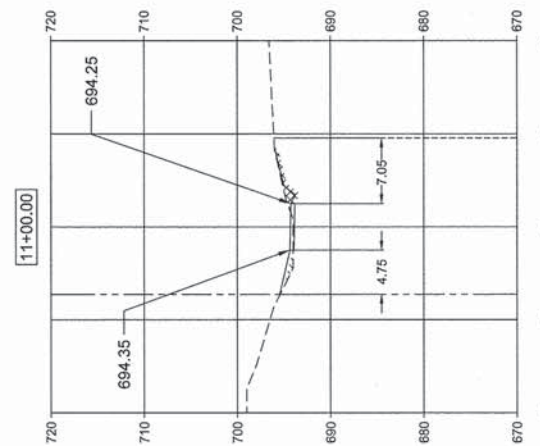
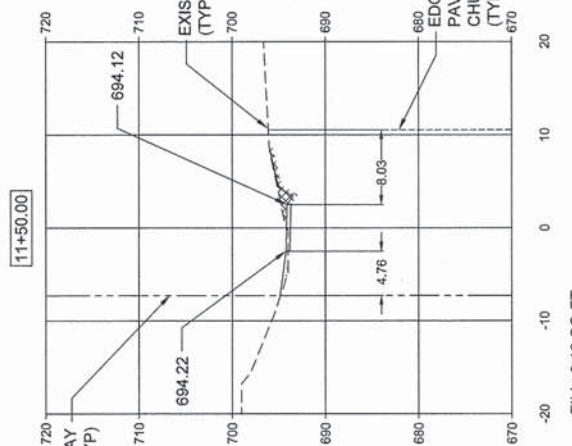
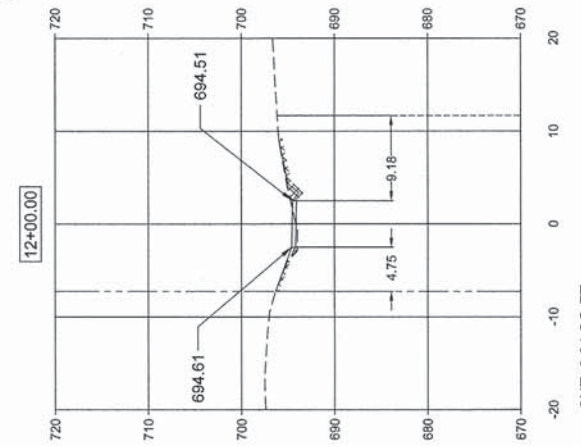
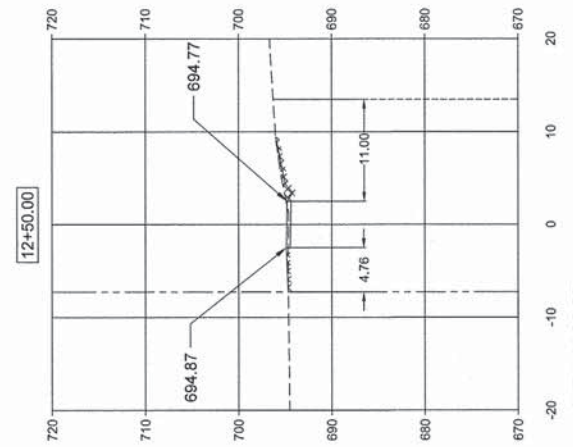
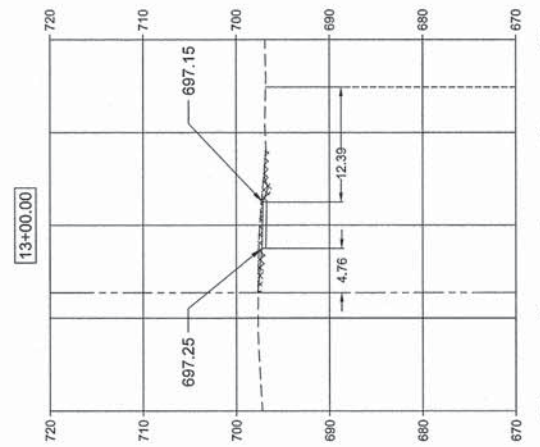
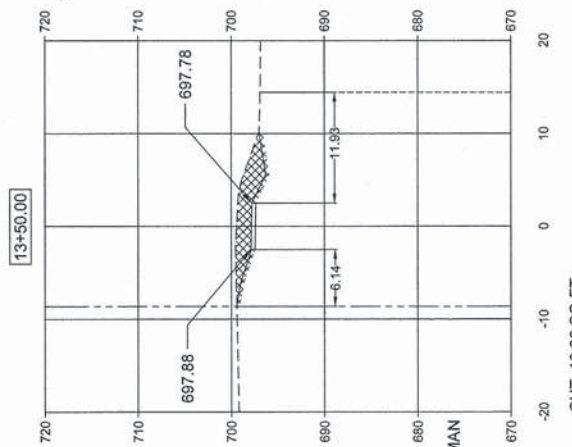
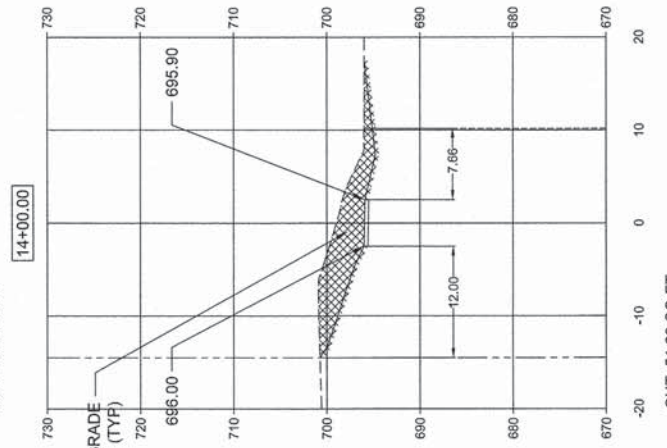
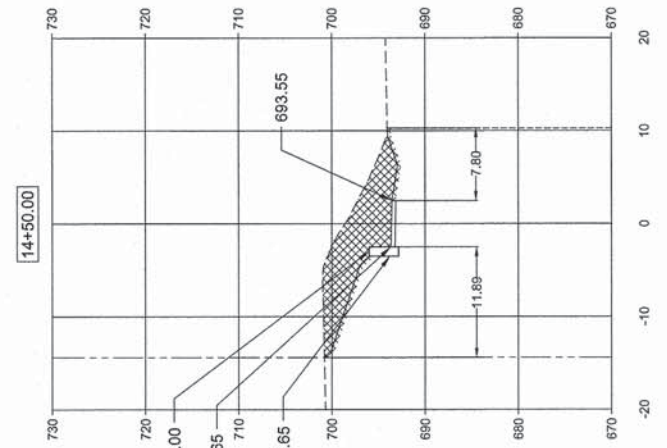
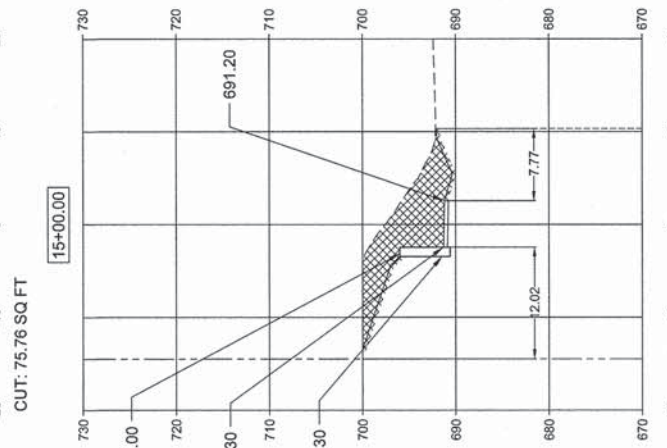
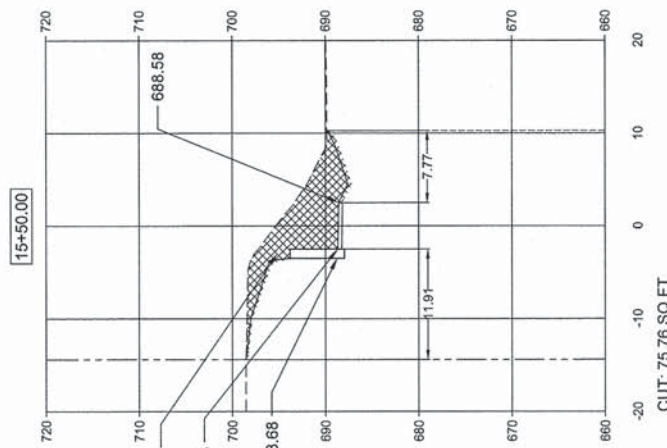

INTERSECTION W/ SOUTH COUNTY LINE ROAD

FILE NAME =

USER NAME =
 PLOT SCALE =
 PLOT DATE =

DESIGNED -- A.J.B.
 DRAWN -- TRD
 CHECKED -- MAP
 DATE -- 01/28/2015

REVISED --
 REVISED --
 REVISED --
 REVISED --

STATE OF ILLINOIS
 DEPARTMENT OF TRANSPORTATION

CROSS SECTIONS
 SCALE: 1"=10'
 SHEET 1 OF 3 SHEETS
 STA. 10+00 TO STA. 15+50

F.A.U. RTE.	SECTION	COUNTY	TOTAL SHEETS	SHEET NO.
1552	14-00050-00-SW	COOK	23	21
GERMAN CHURCH ROAD PED IMPROVEMENT			CONTRACT NO. 61B38	
FED. ROAD DIST. NO. 1 ILLINOIS FED. AID PROJECT				

