

STAGE I TRAFFIC

TRAFFIC CONTROL AND STAGING LEGEND

- WORK ZONE
- SIGN
- TRAFFIC SIGNAL
- DIRECTION OF TRAFFIC

- NOTES:
- SEE STANDARD 701321 FOR ALL NOTES, DETAILS, SIGNS, REFLECTORS, AND BARRICADE PLACEMENT.
 - TEMPORARY RUMBLE STRIPS ARE NOT REQUIRED.

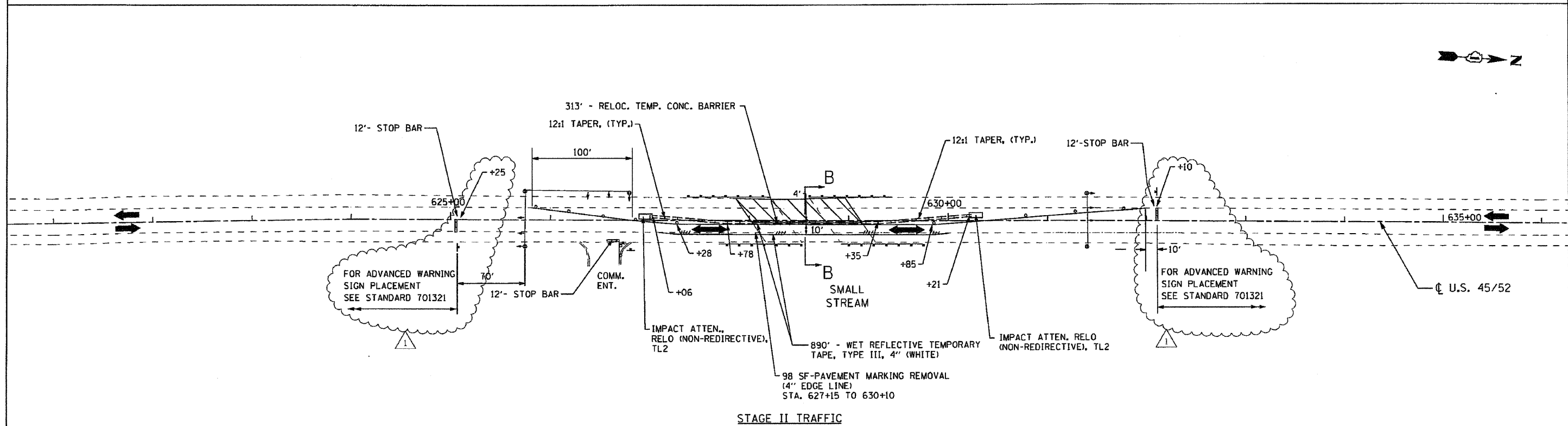

STAGE II TRAFFIC

FILE NAME = 68068 staging2.dgn
PLOT DATE = 8/28/2008

CHRISTIAN-ROGE & ASSOCIATES, INC.
ENGINEERS-PLANNERS-SURVEYORS
211 WEST WACKER DRIVE
CHICAGO, ILLINOIS 60606
PHONE: (312)372-2023 FAX: (312)372-5274

DESIGNED - S.J.P.	REVISED ADD. #1 08/27/08
DRAWN - A.Y.	REVISED -
CHECKED - E.J.M.	REVISED -
DATE - JULY 10, 2008	REVISED -

STATE OF ILLINOIS
DEPARTMENT OF TRANSPORTATION

SUGGESTED TRAFFIC CONTROL AND STAGING PLAN
U.S. 45 / 52

SCALE: 1" = 50' SHEET NO. 2 OF 2 SHEETS STA. 627+50 TO STA. 629+12.1

F.A.P. RTE.	SECTION	COUNTY	TOTAL SHEETS	SHEET NO.
330	17 B-1-1-1	WILL	29	8
FED. ROAD DIST. NO. 1 (ILLINOIS) FED. AID PROJECT			CONTRACT NO. 60D68	