

SEQUENCE OF OPERATION





MOVEMENT	U.S. RTE. 45/52		U.S. RTE. 45/52		U.S. RTE. 45/52				F L A S H	
	COMMERCIAL	DRIVE	COMMERCIAL	DRIVE	COMMERCIAL	DRIVE				
PHASE	1		2		3					
INTERVAL	1	2A	2B	3	4A	4B	5	6A	6B	
CHANGE TO		2, 3			1, 3			1, 2		
U.S. RTE.45/52 SIGNAL (NORTH BOUND)	G	Y	R	R	R	R	R	R	R	R
U.S. RTE.45/52 SIGNAL (SOUTH BOUND)	R	R	R	G	Y	R	R	R	R	R
COMMERCIAL DRIVE SIGNAL (NORTH BOUND & SOUTH BOUND)	R	R	R	R	R	R	G	Y	R	R

TEMPORARY TRAFFIC SIGNAL BILL OF MATERIALS

DESCRIPTION	UNIT	QUANTITY
TEMPORARY BRIDGE TRAFFIC SIGNAL INSTALLATION	EACH	1

TEMPORARY CABLE DIAGRAM LEGEND

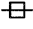
PROPOSED

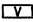
-  TEMPORARY TRAFFIC SIGNAL SECTION OR PEDESTRIAN SIGNAL SECTION 12" (300 mm)
-  TEMPORARY CONTROLLER CABINET
-  TEMPORARY SERVICE INSTALLATION
-  INDICATES NUMBER OF CONDUCTORS IN CABLE. ALL CONDUCTORS TO BE NUMBER 14 AWG WIRE UNLESS OTHERWISE NOTED.
-  VIDEO DETECTOR SENSOR

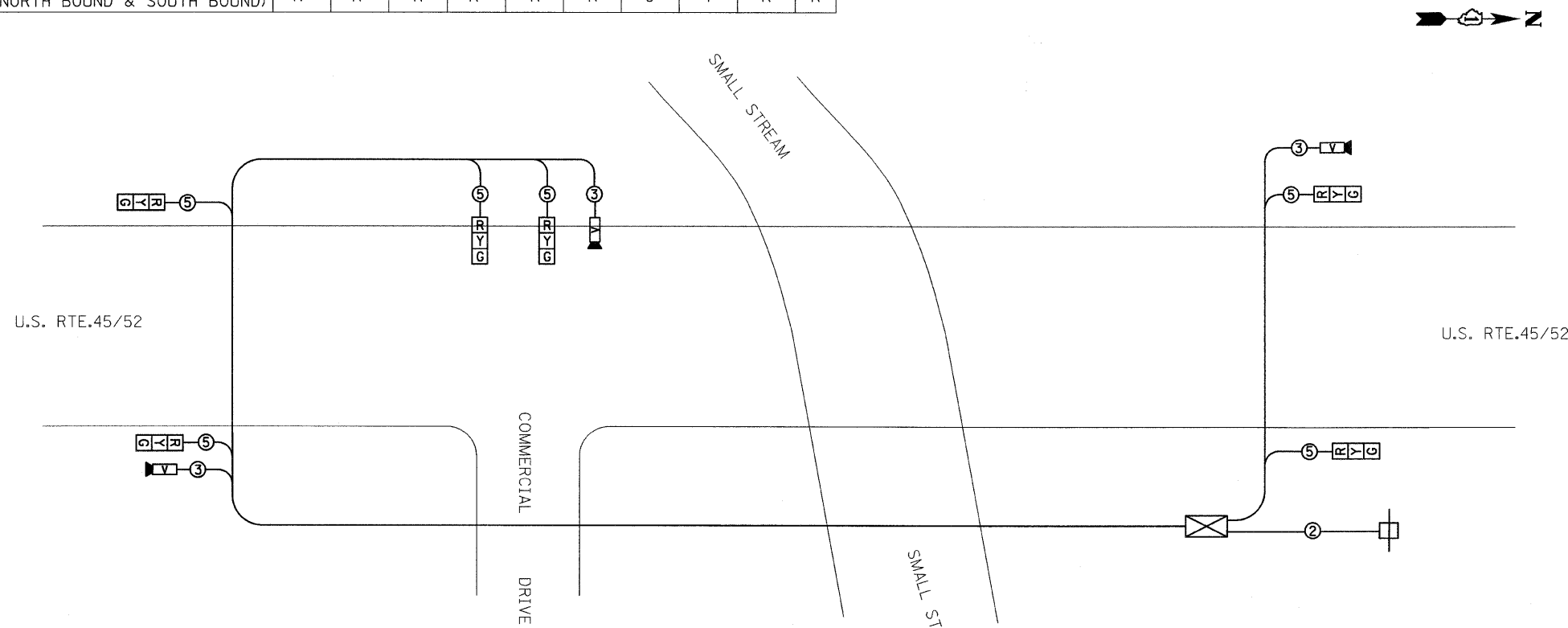

NOTES:

1. HEADS SHALL BE PLACED AS INDICATED ON THE TEMPORARY TRAFFIC SIGNAL PLAN OR AS DIRECTED BY THE ENGINEER. THE CONTRACTOR SHALL FURNISH ENOUGH CABLE SLACK TO RELOCATE HEADS TO ANY POSITION ON THE SPAN WIRE OR AT LOCATIONS ILLUSTRATED ON THE PLANS FOR CONSTRUCTION STAGING.
2. THE PROPOSED TEMPORARY BRIDGE TRAFFIC SIGNAL SHALL BE ACTIVATED, TESTED OPERATIONAL AND APPROVED BY THE ENGINEER BEFORE ANY ANY PERMANENT LANE CLOSURES.
3. ALL LABOR AND MATERIALS TO COMPLY WITH THESE REQUIREMENTS SHALL BE CONSIDERED INCLUDED IN THE BID PRICE OF TEMPORARY BRIDGE TRAFFIC SIGNAL INSTALLTION.
4. REMOVAL OF TEMPORARY SIGNALS SHOULD BE DONE AS DIRECTED BY THE ENGINEER AND MUST BE DONE IN COORDINATION WITH THE REMOVAL OF TEMPORARY LIGHTING.

I.D.O.T TRAFFIC SIGNAL INSTALLATION ELECTRICAL SERVICE REQUIREMENTS					TOTAL WATTAGE
TYPE	NO. LAMPS	WATTAGE		% OPERATION	
		INCAND.	LED		
SIGNAL (RED)	6	135	17	0.50	51.0
(YELLOW)	6	135	25	0.25	37.5
(GREEN)	6	135	15	0.25	22.5
ARROW		135	12	0.10	
PED. SIGNAL		90	25	1.00	
CONTROLLER	1	100	100	1.00	100.00
ILLUM. SIGN		84		0.05	
V.D.S.	1		25	1.00	25
FLASHER				0.50	--
ENERGY COSTS TO BE BILLED TO ADDRESS:				TOTAL =	236
ENERGY SUPPLY CONTACT: LUCILLE JONES					
PHONE: (815) 724-5607					
COMPANY: COM. ED.					

FILE NAME = 60668 signal 2.dgn
 PLOT DATE = 7/7/2008
 **CHRISTIAN-ROGE & ASSOCIATES, INC.**
 ENGINEERS-PLANNERS-SURVEYORS
 211 WEST WACKER DRIVE
 CHICAGO, ILLINOIS 60606
 PHONE: (312)372-2023 FAX: (312)372-5274

DESIGNED - M.A.
 DRAWN - M.A.
 CHECKED - S.J.P. / M.A.
 DATE - 07-07-08
 REVISED -
 REVISED -
 REVISED -
 REVISED -

STATE OF ILLINOIS
 DEPARTMENT OF TRANSPORTATION

TEMPORARY CABLE PLAN
 AND PHASE DESIGNATION DIAGRAM
 U.S. 45 / 52
 SCALE: NONE SHEET NO. 1 OF 2 SHEETS STA. 621+00 TO STA. 636+00

F.A.P. RTE. 330	SECTION 17 B-1-I-1	COUNTY WILL	TOTAL SHEETS 29	SHEET NO. 10
CONTRACT NO. 60668				FED. ROAD DIST. NO. 1 (ILLINOIS) FED. AID PROJECT