

**REINFORCEMENT PLAN**  
(With Proposed Concrete Overlay) 46'-0"

**BILL OF MATERIAL**

Bar	No.	Size	Length	Shape	
a(E)	39	#4	27'-10"	—	
a <sub>2</sub> (E)	39	#4	25'-9"	—	
b(E)	94	#4	20'-0"	—	
Reinforcement Bars, Epoxy Coated				Pound	2,650
Bar Splicers				Each	39
Concrete Wearing Surface, 5"				Sq. Yd.	203
Bridge Deck Grooving				Sq. Yd.	180
Protective Coat				Sq. Yd.	217

Bars Indicated Thus 22x2-#4 etc., Indicates 22 Lines of Bars With 2 Lengths Per Line

**MIN. LAP:**  
#4 Bars = 1'-8"

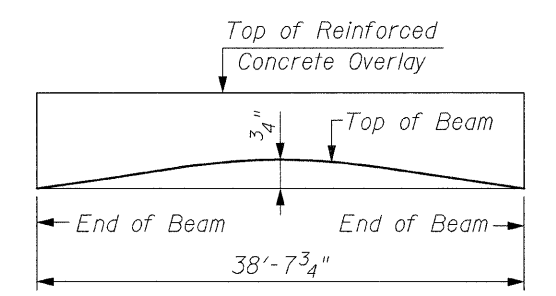

**REINFORCED CONCRETE WEARING SURFACE PROFILE**

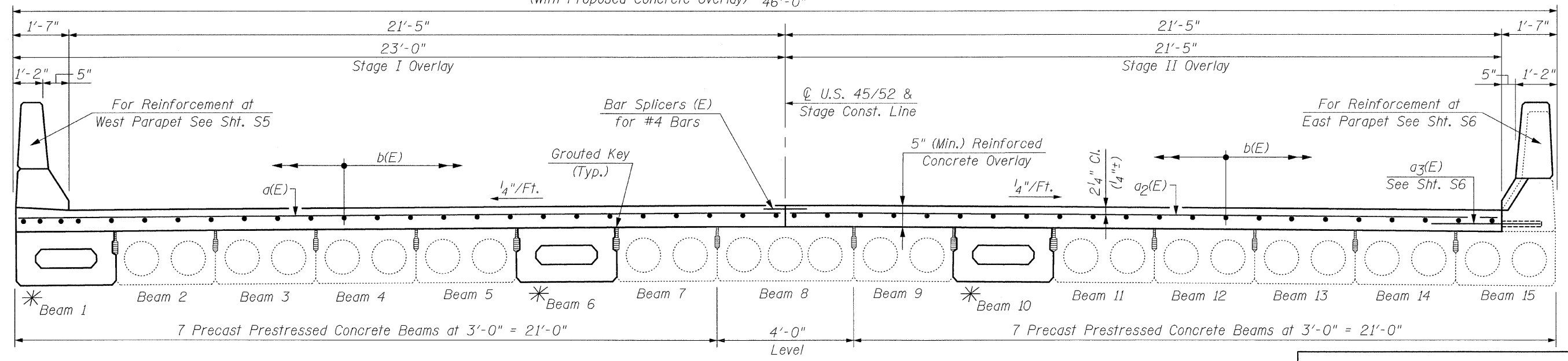

**PROPOSED DECK CROSS SECTION**  
(Looking North)

\* Proposed Precast Prestressed Concrete Deck Beams (17" Depth)

**CR & A**  
CHRISTIAN-ROGE & ASSOCIATES, INC.  
ENGINEERS / PLANNERS / SURVEYORS  
211 W. WACKER DRIVE CHICAGO, IL. 60606  
PHONE: (312)372-2023 FAX: (312)372-5274

FILE NAME = reinforcement.plan.sht	USER NAME = IDDT	DESIGNED - B.N.S.	REVISED -	<b>STATE OF ILLINOIS DEPARTMENT OF TRANSPORTATION</b>	<b>REINFORCEMENT PLAN U.S. 45 / 52 OVER SMALL STREAM</b>			F.A.P. RTE. 330	SECTION 17 B-1-1-1	COUNTY WILL	TOTAL SHEETS 29	SHEET NO. 16
PLOT SCALE = 50.0000' / IN.	CHECKED - B.N.S. / J.C.N.	DATE - JULY 7, 2008	REVISED -		SCALE:	SHEET NO. S4 OF S11 SHEETS	STA.	TO STA.	CONTRACT NO. 60D68			
PLOT DATE = 7/7/2008	DATE - JULY 7, 2008	REVISED -	REVISED -		FED. ROAD DIST. NO. ILLINOIS FED. AID PROJECT							
S.N. 099-0122												