

| F.A.I. RTE. | SECTION | COUNTY | TOTAL SHEETS | SHEET NO. |
|--------------------------|---------|---------------------------|--------------|-----------|
| 57 | * | WILL | 303 | 41 |
| STA. | | TO STA. | | |
| FED. ROAD DIST. NO. | | ILLINOIS FED. AID PROJECT | | |
| +991&2) R-3&9-1HB-1-BR-2 | | CONTRACT: 62253 | | |

RAMP A, B, C, AND D TRAFFIC CONTROL NOTES

| BARRICADE TYPE II | |
|-------------------|----------|
| LOCATION | SPACING |
| TANGENT | 100' CTS |
| CURVES | 25' CTS |
| RETURNS | 25' CTS |
| SHOULDER TAPERS | 50' CTS |
| TAPERS | 12' CTS |

RAMPS A, B, C, AND D TRAFFIC CONTROL LEGEND

- TEMPORARY PAVEMENT
- WORK AREA
- DIRECTION OF TRAFFIC
- ARROW BOARD
- TRAFFIC SIGN
- BARRICADE TYPE II, DRUM OR VERTICAL BARRICADE WITH MONO-DIRECTIONAL STEADY BURNING LIGHT (SEE NOTES FOR SPACING)
- BARRICADE TYPE III WITH STEADY BURNING LIGHT
- TEMPORARY PAVEMENT MARKINGS, TYPE III
- SKIP-DASH WHITE, 5"
- SKIP-DASH YELLOW, 5"
- STOP LINE, 24"
- SOLID LINE, 4"
- DOUBLE CENTERLINE, YELLOW, 4"
- DOTTED LINES (2'-6" SPACE), 4"
- TEMPORARY BARRIER WALL WITH BARRIER WALL REFLECTORS



SEE MANHATTAN-MONEE ROAD AND RAMP A STAGE I SHEETS FOR DETAILS

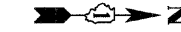

SEE MANHATTAN-MONEE ROAD AND RAMP D STAGE I SHEETS FOR DETAILS

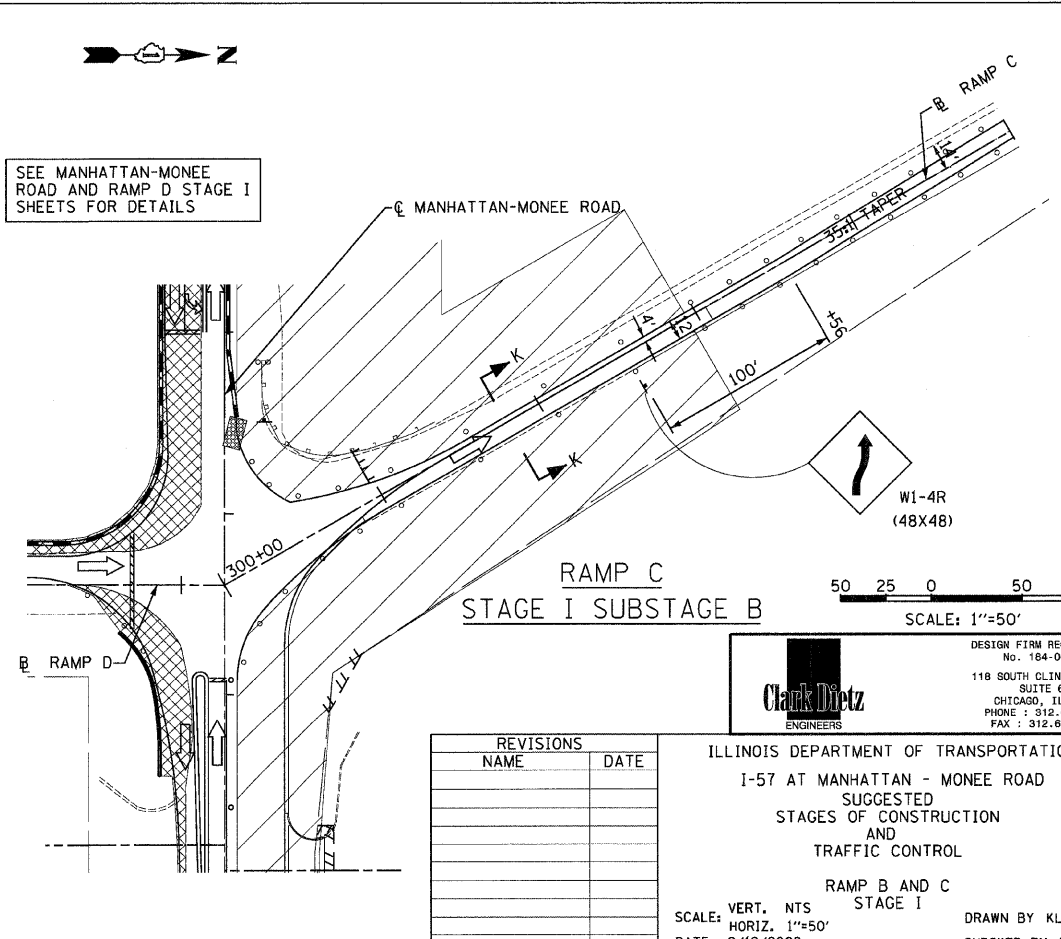
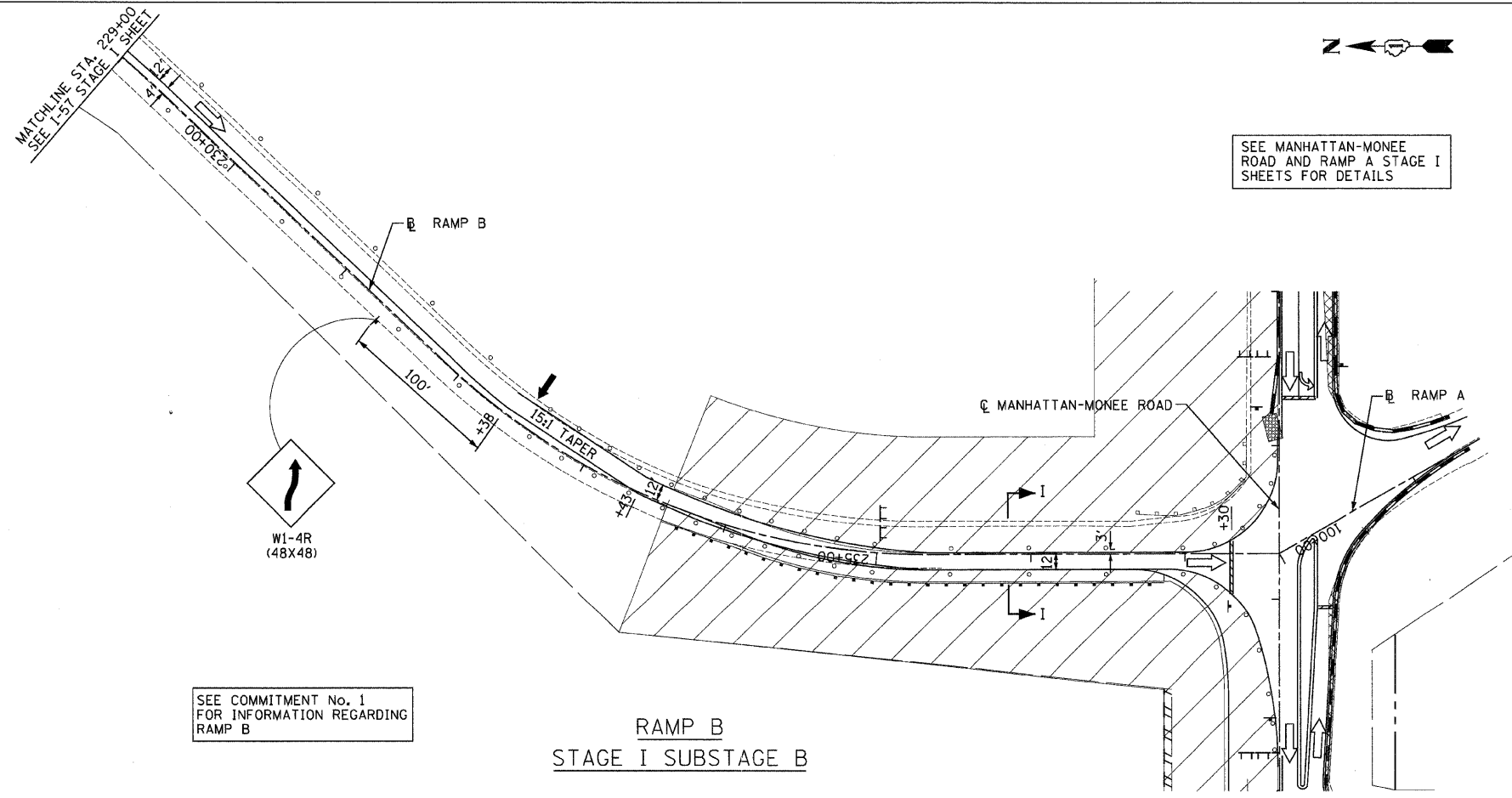
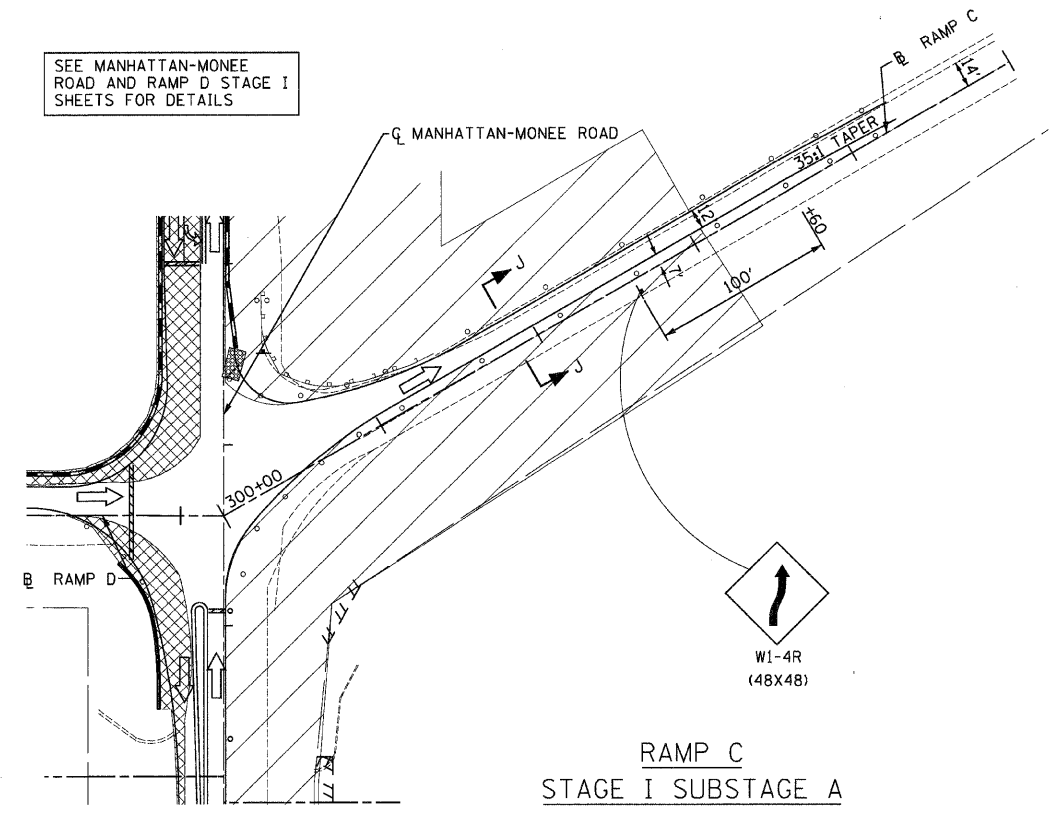
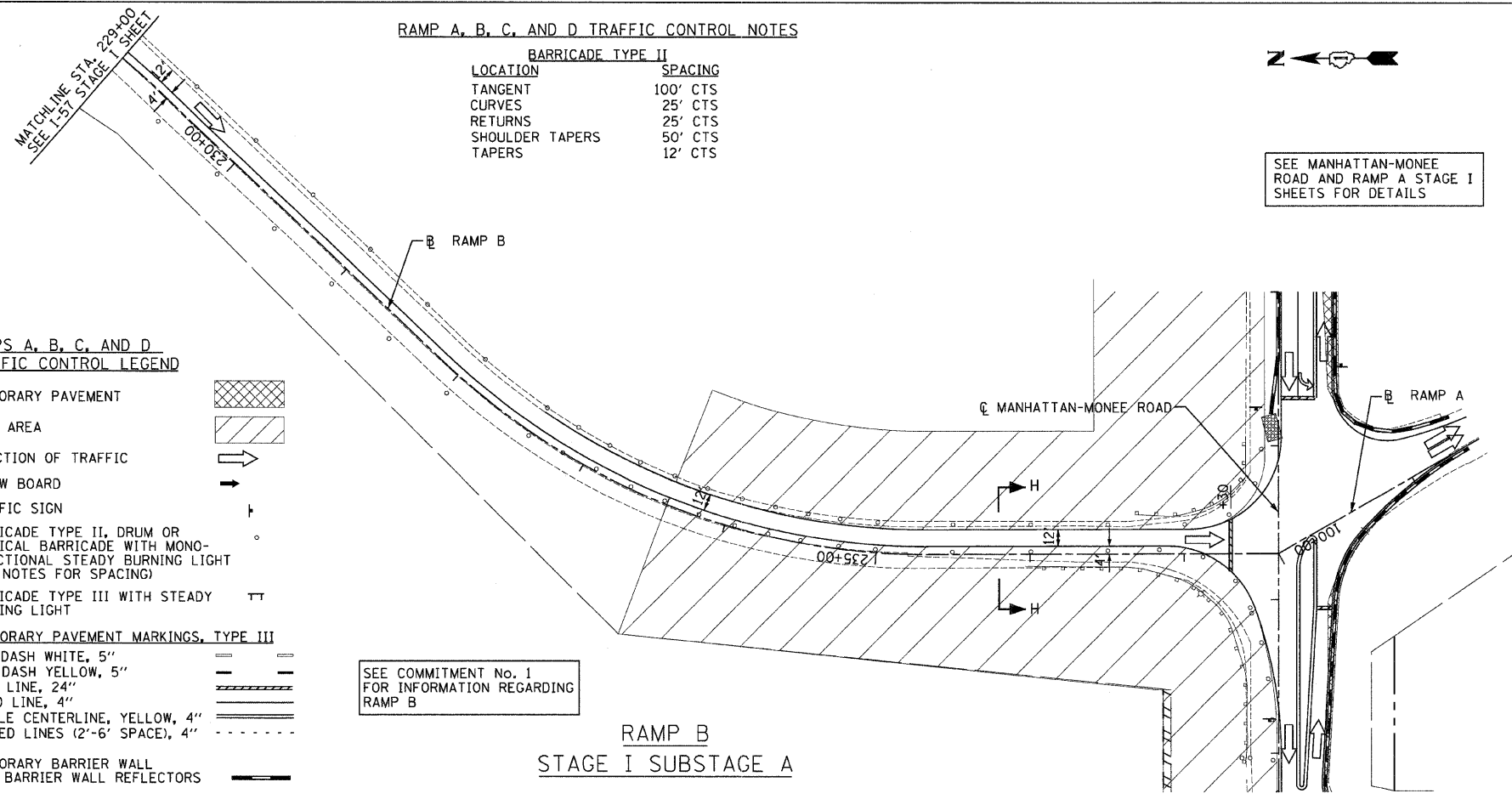

p:\102231\plans\ahc\sta\102231CSPL2211.dgn 8/1/2008

| REVISIONS | |
|-----------|------|
| NAME | DATE |
| | |
| | |
| | |
| | |
| | |

Clark Dietz
ENGINEERS

DESIGN FIRM REGISTRATION
No. 184-000450
118 SOUTH CLINTON STREET
SUITE 800
CHICAGO, IL 60661
PHONE : 312.648.9900
FAX : 312.648.0204

ILLINOIS DEPARTMENT OF TRANSPORTATION
I-57 AT MANHATTAN - MONEE ROAD
SUGGESTED STAGES OF CONSTRUCTION AND TRAFFIC CONTROL
RAMP B AND C STAGE I
SCALE: VERT. NTS
HORIZ. 1"=50'
DATE 9/19/2008
DRAWN BY KLM
CHECKED BY TMW