

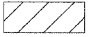









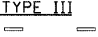
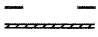
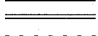

**MANHATTAN-MONEE ROAD TRAFFIC CONTROL LEGEND**

- TEMPORARY PAVEMENT, 6 IN. 
- WORK AREA 
- DIRECTION OF TRAFFIC 
- ARROW BOARD 
- TRAFFIC SIGN 
- BARRICADE TYPE II, DRUM OR VERTICAL BARRICADE WITH MONO-DIRECTIONAL STEADY BURNING LIGHT (SEE NOTES FOR SPACING) 
- BARRICADE TYPE III WITH STEADY BURNING LIGHT 
- TEMPORARY PAVEMENT MARKINGS, TYPE III  
 SKIP-DASH WHITE, 5"   
 SKIP DASH YELLOW, 5"   
 STOP LINE, 24"   
 SOLID LINE, 4"   
 DOUBLE CENTERLINE, YELLOW, 4"   
 DOTTED LINES (2'-6" SPACE), 4" 
- TEMPORARY BARRIER WALL WITH BARRIER WALL REFLECTORS 
- TEMPORARY IMPACT ATTENUATORS 

**MANHATTAN-MONEE ROAD TRAFFIC CONTROL NOTES**

BARRICADE TYPE I OR TYPE II LOCATION	SPACING
TANGENT	100' CTS
RETURNS	25' CTS
CURVES	25' CTS
SHOULDER TAPERS	50' CTS
TAPERS	12' CTS

F.A.I. RTE.	SECTION	COUNTY	TOTAL SHEETS	SHEET NO.
57		WILL	303	47
STA. TO STA.				
FED. ROAD DIST. NO.		ILLINOIS	FED. AID PROJECT	
*991(2) R-389-11B-1-BR-2		CONTRACT: 62253		

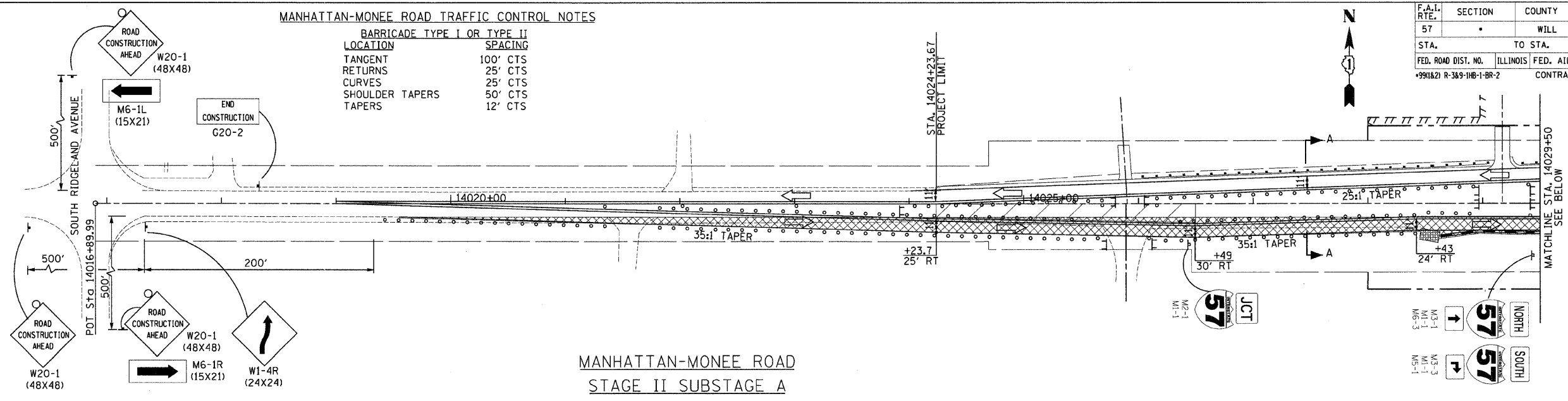

**MANHATTAN-MONEE ROAD STAGE II SUBSTAGE A**

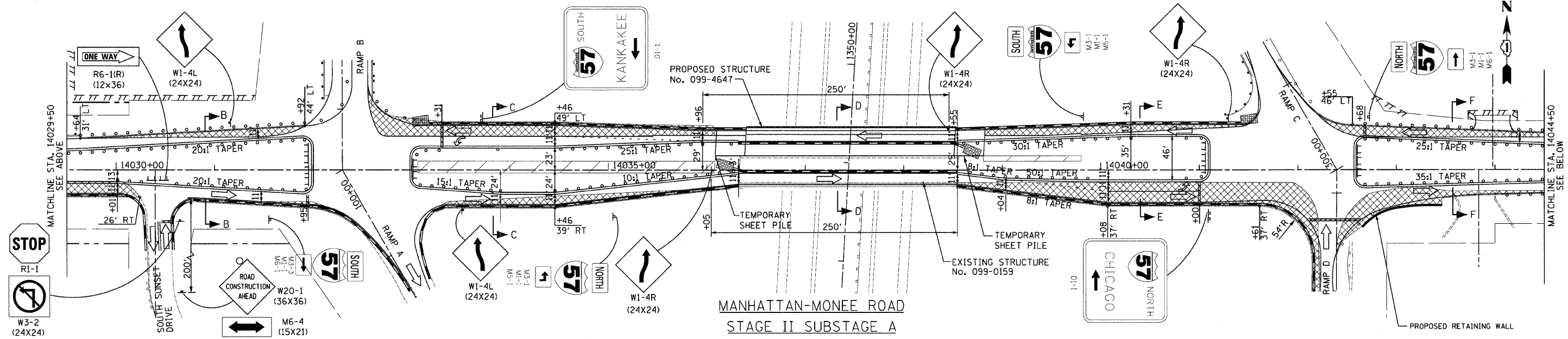

**MANHATTAN-MONEE ROAD STAGE II SUBSTAGE A**

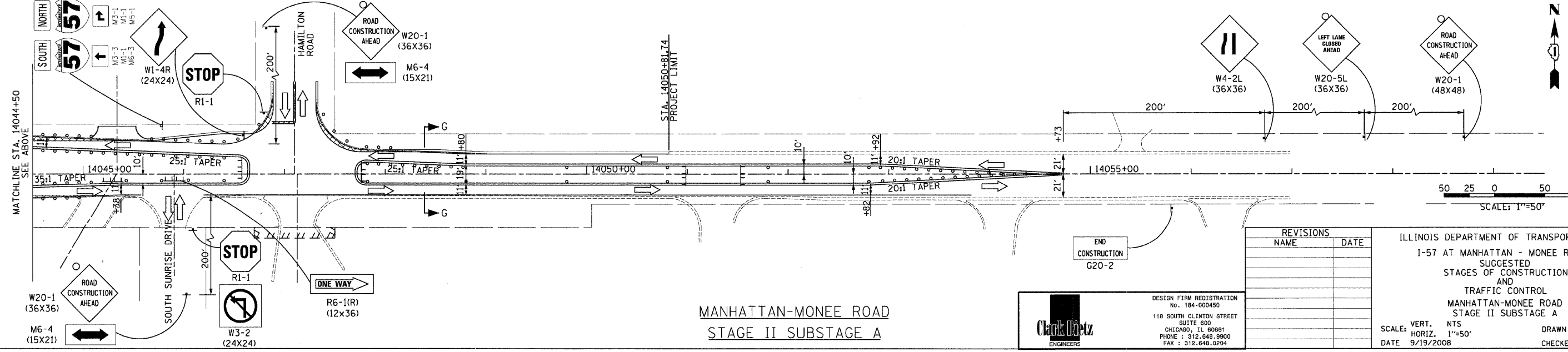

**MANHATTAN-MONEE ROAD STAGE II SUBSTAGE A**

REVISIONS	NAME	DATE

ILLINOIS DEPARTMENT OF TRANSPORTATION  
 I-57 AT MANHATTAN - MONEE ROAD  
 SUGGESTED STAGES OF CONSTRUCTION AND TRAFFIC CONTROL  
 MANHATTAN-MONEE ROAD STAGE II SUBSTAGE A  
 SCALE: VERT. NTS 1"=50'  
 DATE 9/19/2008  
 DRAWN BY KLM  
 CHECKED BY TNW

**Clark Dietz ENGINEERS**  
 DESIGN FIRM REGISTRATION No. 184-000450  
 118 SOUTH CLINTON STREET SUITE 600 CHICAGO, IL 60681  
 PHONE : 312.646.8960 FAX : 312.646.0294

6:\02231\plans\sheet\02231CSP1.0121.dgn  
 8/17/2008