

MANHATTAN-MONEE ROAD TRAFFIC CONTROL LEGEND

- TEMPORARY PAVEMENT, 6 IN.
- WORK AREA
- DIRECTION OF TRAFFIC
- ARROW BOARD
- TRAFFIC SIGN
- BARRICADE TYPE II, DRUM OR VERTICAL BARRICADE WITH MONO-DIRECTIONAL STEADY BURNING LIGHT (SEE NOTES FOR SPACING)
- BARRICADE TYPE III WITH STEADY BURNING LIGHT
- TEMPORARY PAVEMENT MARKINGS, TYPE III
 - SKIP-DASH WHITE, 5"
 - SKIP DASH YELLOW, 5"
 - STOP LINE, 24"
 - SOLID LINE, 4"
 - DOUBLE CENTERLINE, YELLOW, 4"
 - DOTTED LINES (2'-6" SPACE), 4"
- TEMPORARY BARRIER WALL WITH BARRIER WALL REFLECTORS
- TEMPORARY IMPACT ATTENUATORS

MANHATTAN-MONEE ROAD TRAFFIC CONTROL NOTES

BARRICADE TYPE I OR TYPE II	
LOCATION	SPACING
TANGENT	100' CTS
RETURNS	25' CTS
CURVES	25' CTS
SHOULDER TAPERS	50' CTS
TAPERS	12' CTS

F.A.I. RTE.	SECTION	COUNTY	TOTAL SHEETS	SHEET NO.
57		WILL	303	49
STA. TO STA.				
FED. ROAD DIST. NO.		ILLINOIS	FED. AID PROJECT	
+9910231 R-389-10B-1-BR-2		CONTRACT: 62253		

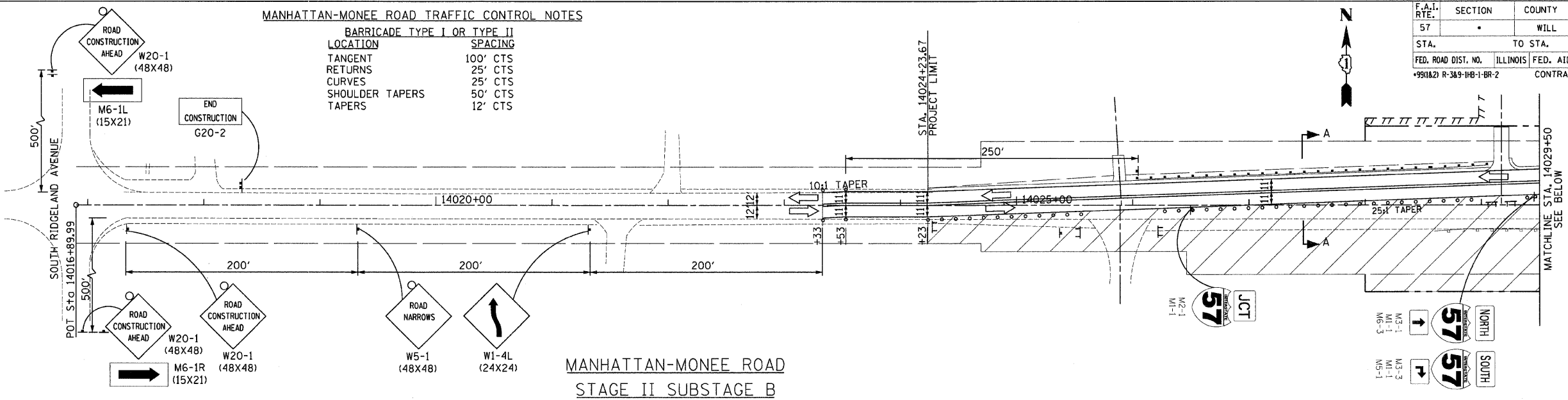

**MANHATTAN-MONEE ROAD
STAGE II SUBSTAGE B**

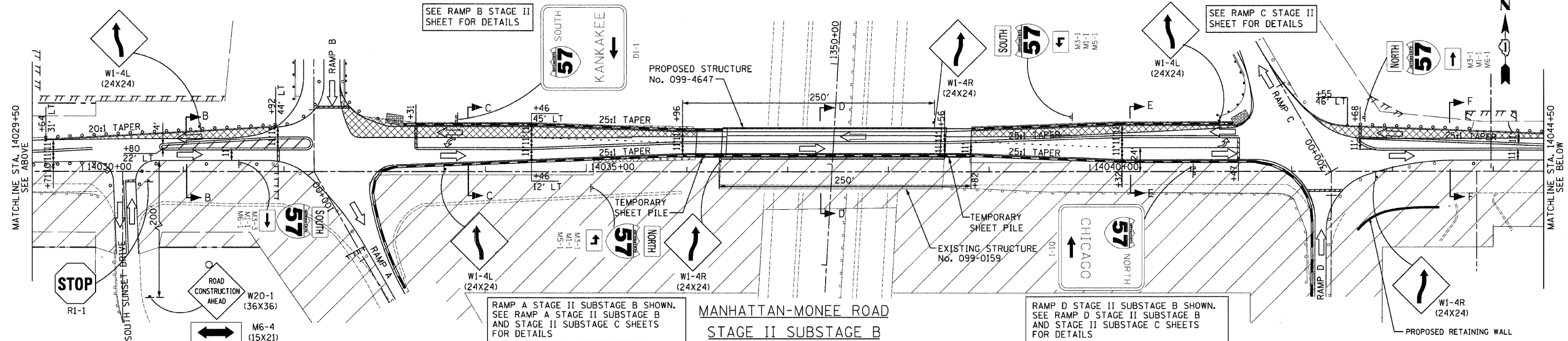

**MANHATTAN-MONEE ROAD
STAGE II SUBSTAGE B**

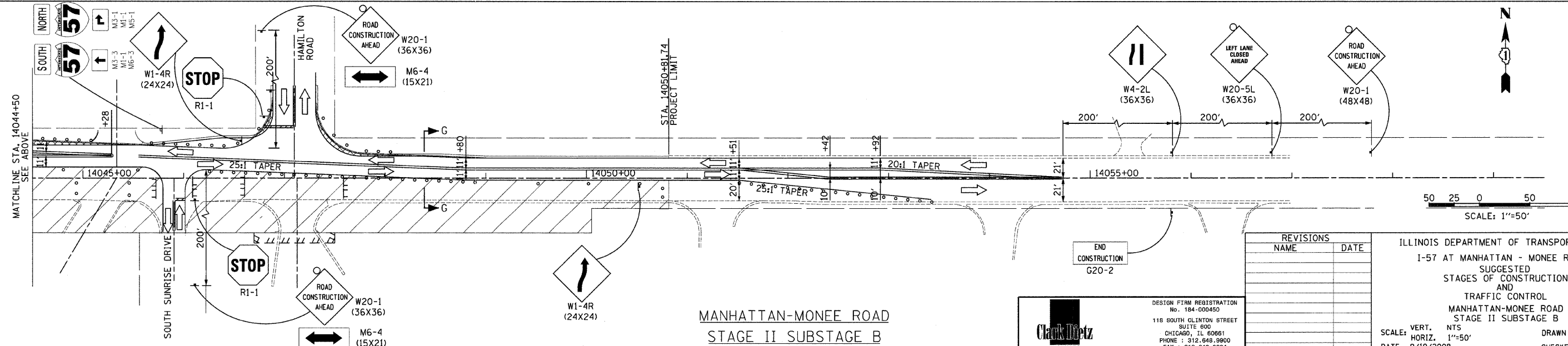

**MANHATTAN-MONEE ROAD
STAGE II SUBSTAGE B**

SCALE: 1"=50'

REVISIONS	
NAME	DATE

ILLINOIS DEPARTMENT OF TRANSPORTATION
I-57 AT MANHATTAN - MONEE ROAD
SUGGESTED STAGES OF CONSTRUCTION AND TRAFFIC CONTROL
MANHATTAN-MONEE ROAD
STAGE II SUBSTAGE B
SCALE: VERT. NTS
HORIZ. 1"=50'
DATE 9/19/2008
DRAWN BY KLM
CHECKED BY TMW

Clark Dietz
ENGINEERS

DESIGN FIRM REGISTRATION No. 184-000450
118 SOUTH CLINTON STREET SUITE 600
CHICAGO, IL 60661
PHONE : 312.648.9900 FAX : 312.648.0204

P:\102231\plama\ahereeta\102231\CSP1\0122.dgn
 8/17/2008