

CONTRACT NO. 63024		F.A. RTE.	SECTION	COUNTY	TOTAL SHEETS	SHEET NO.
2552	00-00114-00-PV	DuPage	563	544		
STA. TO STA.		ILLINOIS FED. AID PROJECT				
FED. ROAD DIST. NO.						

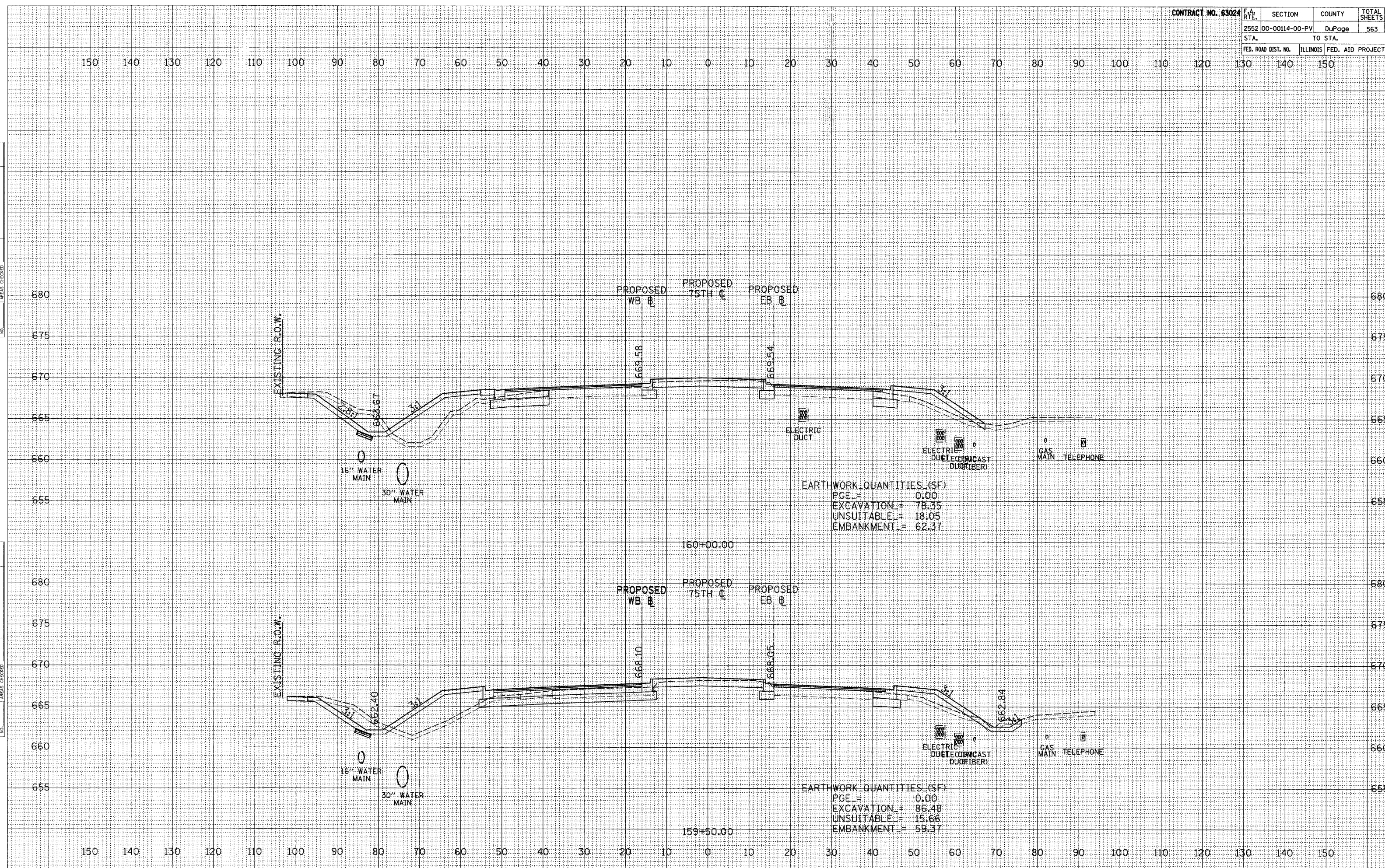

EARTHWORK QUANTITIES (SF)
 PGE = 0.00
 EXCAVATION = 78.35
 UNSUITABLE = 18.05
 EMBANKMENT = 62.37

EARTHWORK QUANTITIES (SF)
 PGE = 0.00
 EXCAVATION = 86.48
 UNSUITABLE = 15.66
 EMBANKMENT = 59.37

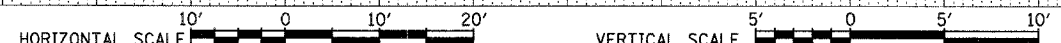

75TH ST. CROSS SECTIONS

SURVEY PLOTTED
 NOTE BOOK TEMPLATE
 AREAS CHECKED

SURVEY PLOTTED
 NOTE BOOK TEMPLATE
 AREAS CHECKED