

SECTION	COUNTY	TOTAL SHEETS	SHEET NO.
08-00053-00-LT	COOK/DUPAGE	15	6
IL RTE. 83 - STA. 1056+00 TO STA. 1078+00			
LIGHTING PLAN			

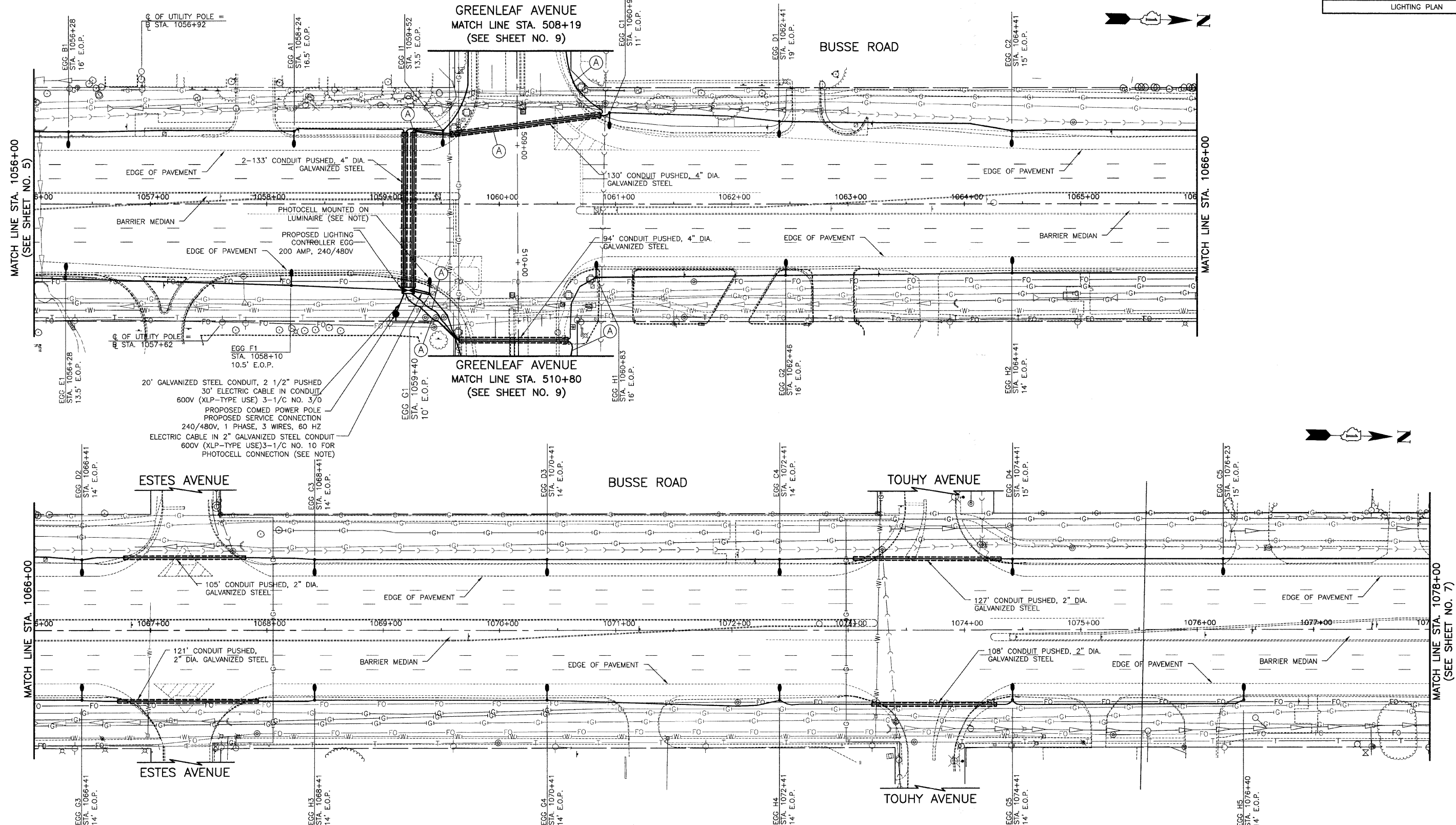

20' GALVANIZED STEEL CONDUIT, 2 1/2" PUSHED  
 30' ELECTRIC CABLE IN CONDUIT  
 600V (XLP-TYPE USE) 3-1/C NO. 3/0  
 PROPOSED COMED POWER POLE  
 PROPOSED SERVICE CONNECTION  
 240/480V, 1 PHASE, 3 WIRES, 60 HZ  
 ELECTRIC CABLE IN 2" GALVANIZED STEEL CONDUIT  
 600V (XLP-TYPE USE) 3-1/C NO. 10 FOR  
 PHOTOCELL CONNECTION (SEE NOTE)

- NOTE:
- ALL PHOTOCELL MATERIAL AND INSTALLATION SHALL BE PART OF THE PAY ITEM "LIGHTING CONTROLLER, SPECIAL."
  - ALL UNIT DUCT IS 600V, 3-1C NO.4, 1/C NO.4 GROUND, (XLP-TYPE USE), 1 1/4" DIA. POLYETHYLENE EXCEPT WHERE NOTED WITH (A), WHICH IS UNIT DUCT, 600V, 3-1C NO.8, 1/C NO.8 GROUND, (XLP-TYPE USE), 1" DIA. POLYETHYLENE

REVISIONS	
NAME	DATE

ILLINOIS DEPARTMENT OF TRANSPORTATION  
 ILLINOIS ROUTE 83  
 ROADWAY LIGHTING  
**LIGHTING PLAN**

ILLINOIS ROUTE 83 (BUSSE ROAD)  
 STA. 1056+00 TO STA. 1078+00

DATE: 05/14/2008  
 CHECKED BY: D.N.M.

SCALE IN FEET

