

SECTION	COUNTY	TOTAL SHEETS	SHEET NO.
08-00053-00-LT	COOK/DUPAGE	15	12
ILLINOIS ROUTE 83 (BUSSE ROAD)			
LIGHTING DETAILS			

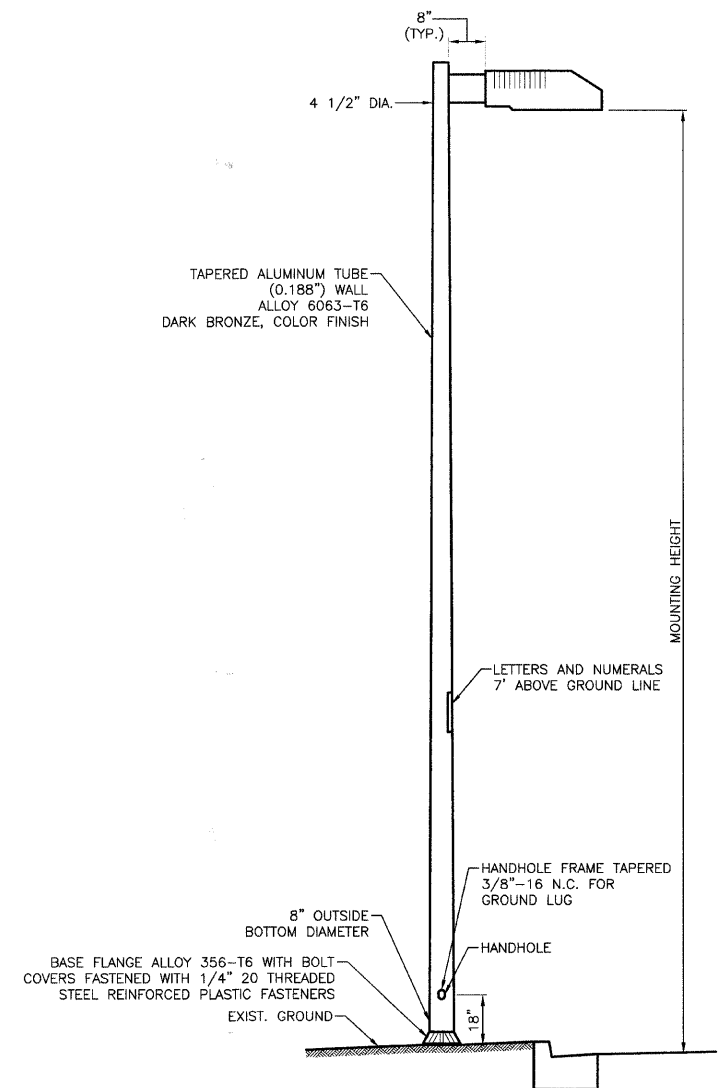

KIM LIGHTING UNIT DETAIL

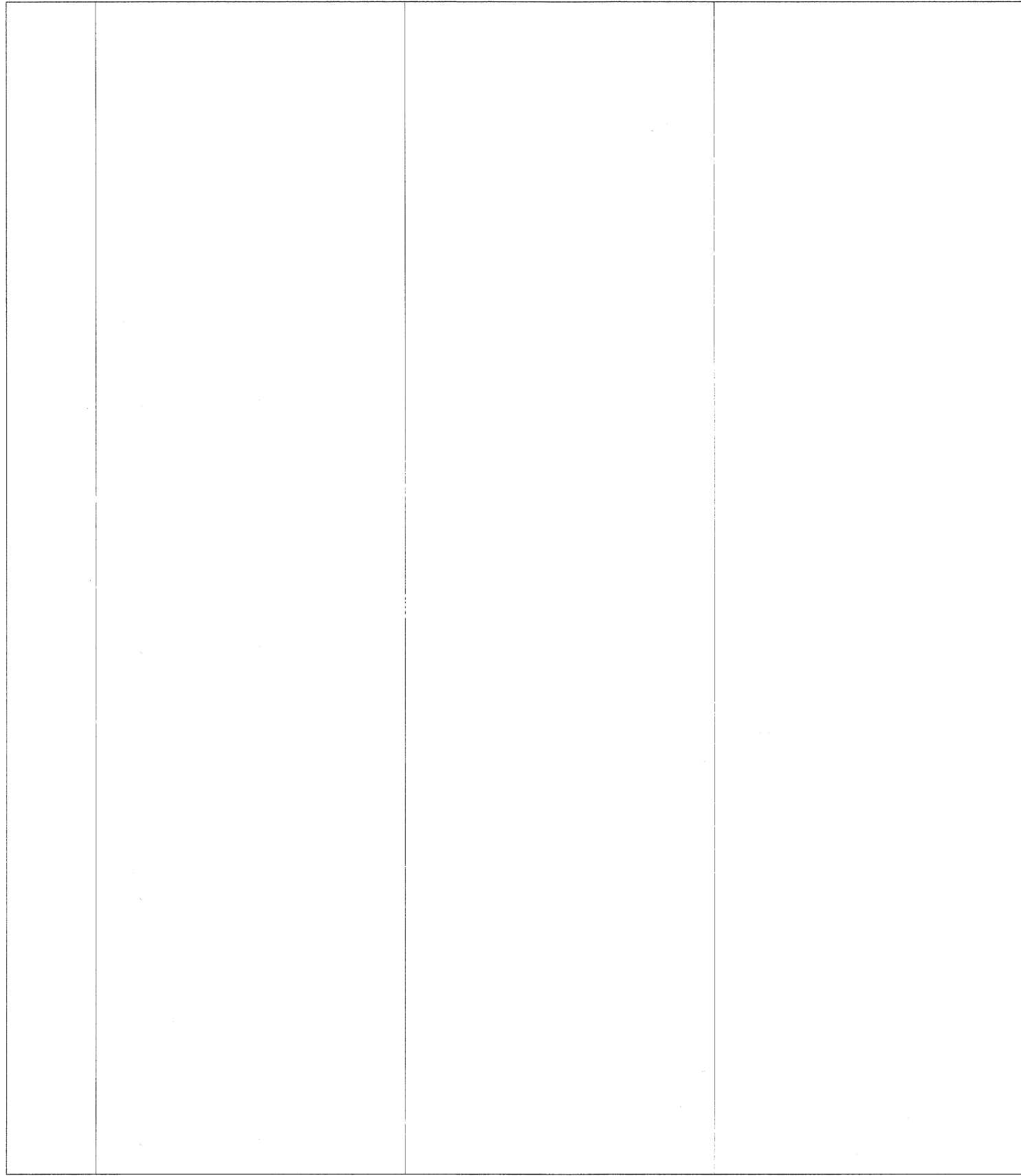
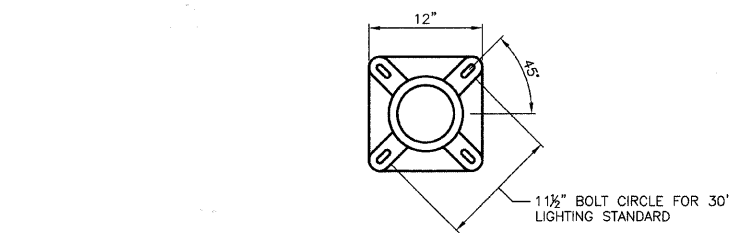

KIM LIGHTING UNIT ANCHOR BASE DETAIL

30 FT. LIGHT STANDARD

LUMINAIRE:
 KIM LIGHTING - AR3 MODEL (NO SUBSTITUTIONS)
 250 WATT, H.P.S., M-C-III, 240V,
 30 FT. M.H., 8 IN. SUPPORT ARM,
 DARK BRONZE-POWDER COAT FINISH

POLE:
 ROUND TAPERED ALUMINUM,
 KIM-LIGHTING-LTRA30-8188
 DARK BRONZE-POWDER COAT FINISH,
 11-1/2" BOLT CIRCLE, OR APPROVED EQUAL

REVISIONS	
NAME	DATE

ILLINOIS DEPARTMENT OF TRANSPORTATION
 ILLINOIS ROUTE 83
 ROADWAY LIGHTING
LIGHTING DETAILS

ILLINOIS ROUTE 83
 (BUSSE ROAD)

DATE: 05/14/2008
 CHECKED BY: D.N.M.