

TRAFFIC SIGNAL LEGEND

- CONTROLLER
- SERVICE INSTALLATION
- SIGNAL HEAD
- SIGNAL HEAD WITH BACKPLATE
- SIGNAL HEAD, PEDESTRIAN
- SIGNAL POST
- POST ARM ASSEMBLY AND POLE, STEEL
- POST ARM ASSEMBLY AND POLE, ALUMINUM
- CONDUIT TRENCH
- URD DUCT
- HANDHOLE
- HEAVY DUTY HANDHOLE
- DOUBLE HANDHOLE
- G.S. CONDUIT IN TRENCH OR PUSHED
- PEDESTRIAN PUSHBUTTON DETECTOR
- DETECTOR LOOP
- CAST IRON JUNCTION BOX
- EMERGENCY VEHICLE SYSTEM DETECTOR
- SIGNAL HEAD OPTICALLY PROGRAMMED
- CONDUIT SPLICE
- WOOD POLE
- SIDEWALK TO BE REMOVED & REPLACED
- CONC. CURB & GUTTER TO BE REMOVED & REPLACED
- RELOCATED SIGNAL HEAD
- EMERGENCY VEHICLE LIGHT DETECTOR
- CONFIRMATION BEACON
- EXIST. R.O.W.

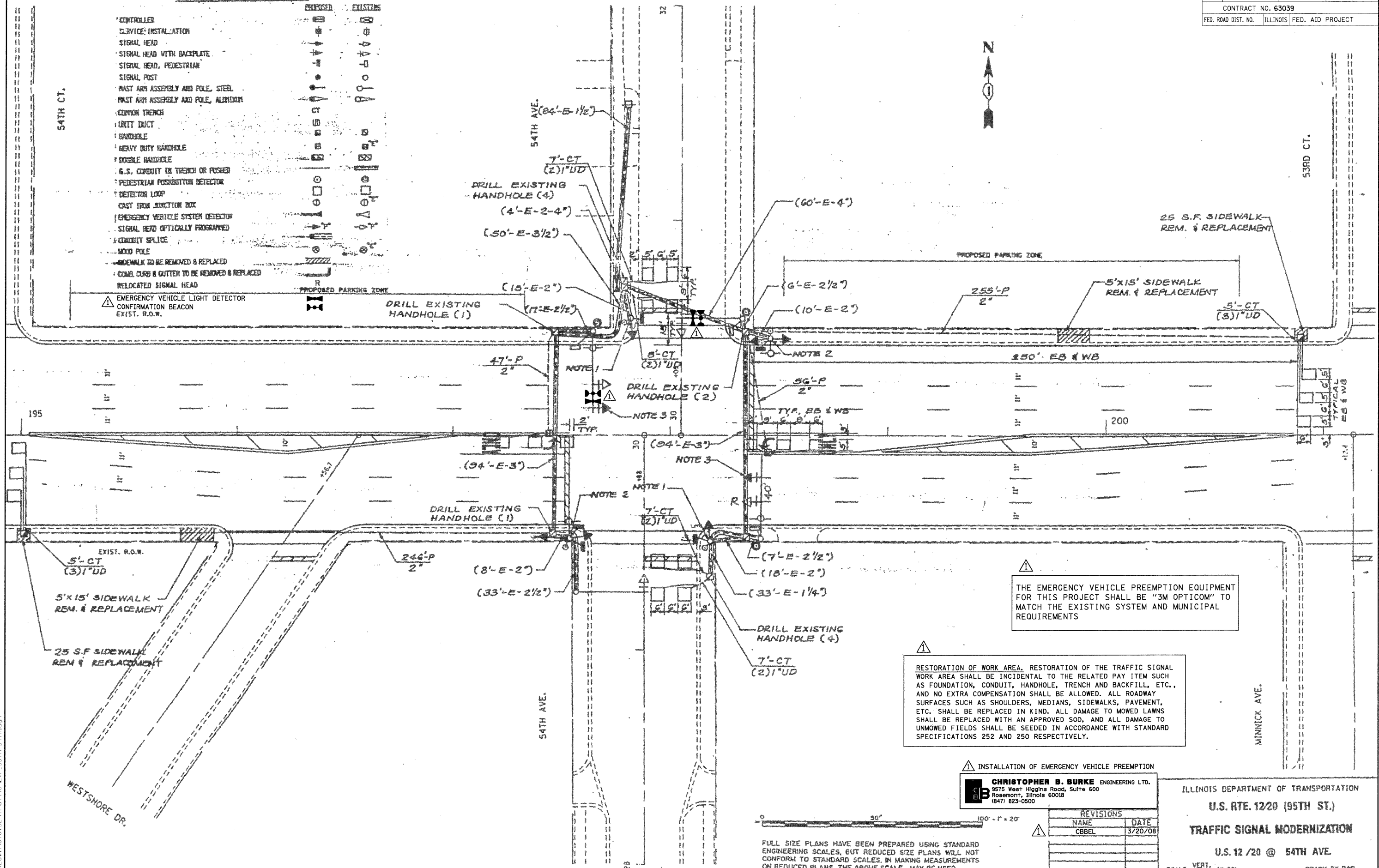

THE EMERGENCY VEHICLE PREEMPTION EQUIPMENT FOR THIS PROJECT SHALL BE "3M OPTICOM" TO MATCH THE EXISTING SYSTEM AND MUNICIPAL REQUIREMENTS

RESTORATION OF WORK AREA, RESTORATION OF THE TRAFFIC SIGNAL WORK AREA SHALL BE INCIDENTAL TO THE RELATED PAY ITEM SUCH AS FOUNDATION, CONDUIT, HANDHOLE, TRENCH AND BACKFILL, ETC., AND NO EXTRA COMPENSATION SHALL BE ALLOWED. ALL ROADWAY SURFACES SUCH AS SHOULDERS, MEDIANS, SIDEWALKS, PAVEMENT, ETC. SHALL BE REPLACED IN KIND. ALL DAMAGE TO MOWED LAWNS SHALL BE REPLACED WITH AN APPROVED SOD, AND ALL DAMAGE TO UNMOWED FIELDS SHALL BE SEEDING IN ACCORDANCE WITH STANDARD SPECIFICATIONS 252 AND 250 RESPECTIVELY.

INSTALLATION OF EMERGENCY VEHICLE PREEMPTION

CHRISTOPHER B. BURKE ENGINEERING LTD.
 9575 West Higgins Road, Suite 600
 Rosemont, Illinois 60018
 (847) 823-0500

REVISIONS	
NAME	DATE
CBBEL	3/20/08

ILLINOIS DEPARTMENT OF TRANSPORTATION
U.S. RTE. 12/20 (95TH ST.)
TRAFFIC SIGNAL MODERNIZATION
U.S. 12 /20 @ 54TH AVE.
 SCALE: VERT. 1"=20'
 HORIZ. 1"=20'
 DATE 06/03/93
 DRAWN BY RAC
 CHECKED BY SPV

N:\ocklawn\070732\Traffic\NEVP_95th-54th.dgn