

F.A.U. RTE.	SECTION	COUNTY	TOTAL SHEETS	SHEET NO.
2305	06-00019-00-RS	KANE	18	13
CONTRACT NO. 63062				

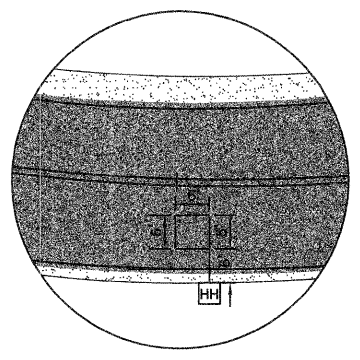

DETAIL A

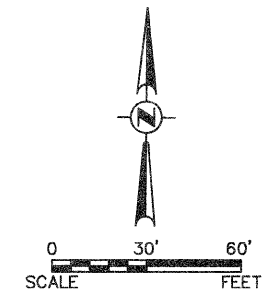
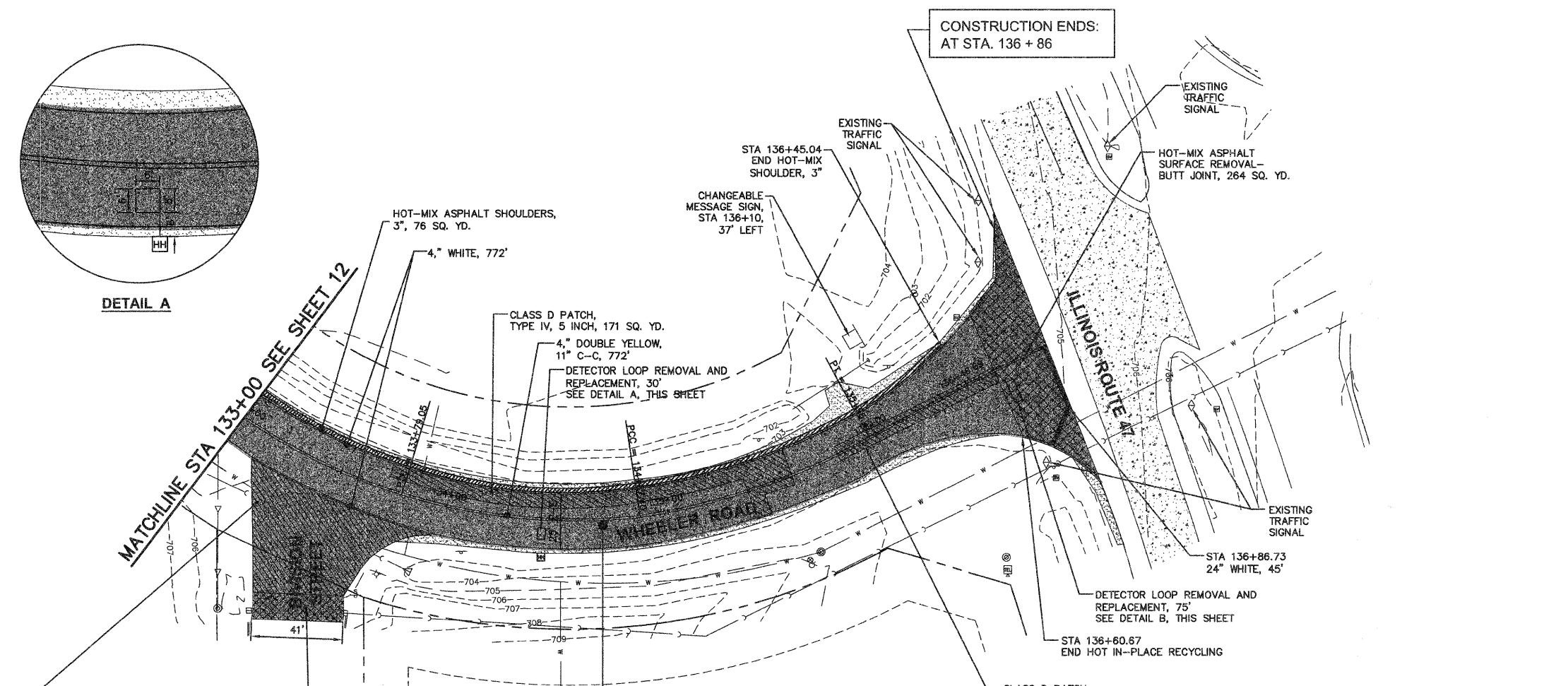

- HOT-MIX ASPHALT SHOULDERS, 3"
- CLASS C & D PATCHES
- HOT-MIX ASPHALT SURFACE REMOVAL - BUTT JOINT
- RESURFACING

- NOTES:
- STRIP REFLECTIVE CRACK CONTROL TO BE USED FOR ALL LONGITUDINAL CRACKS, AND TRANSVERSE CRACKS AS DIRECTED BY THE ENGINEER.
 - THE REQUIRED 3" SHOULDER EXCAVATION WILL BE INCLUDED IN THE "HOT-MIX ASPHALT SHOULDERS, 3", PAY ITEM. LEVELING BINDER 3/4" AND SURFACE COURSE, 1 3/4" WILL BE PLACED ON TOP OF THE ASPHALT SHOULDER, AND SHALL BE PAVED MONOLITHICALLY WITH THE MAINLINE PAVING OPERATORS.
 - ALONG THE PORTION OF THE ROADWAY THAT WILL RECEIVE NEW PAVED SHOULDERS, ANY AGGREGATE EXTENDING BEYOND THE SHOULDER WILL BE REMOVED AND RESTORED. THIS WORK SHALL BE CONSIDERED AS INCIDENTAL TO HOT-MIX ASPHALT SHOULDERS, 3".
 - THE CONSTRUCTION LIMIT FOR DRIVEWAYS SHALL BE AT THE ROW LINE UNLESS THERE IS AN EXISTING CONCRETE APRON CLOSER TO THE ROADWAY, OR AS OTHERWISE DIRECTED BY THE ENGINEER.
 - BARRICADES OR TEMPORARY RAMPS TO BE USED BY THE CONTRACTOR AROUND UTILITY ADJUSTMENTS AS DIRECTED BY THE ENGINEER.
 - ALL PAVEMENT MARKINGS ARE TO BE THERMOPLASTIC.

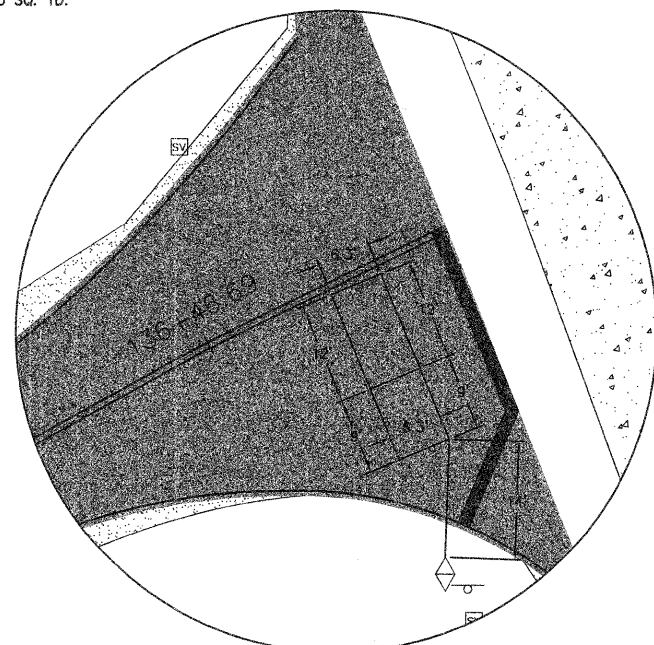

DETAIL B

Plotted: July 15, 2008 @ 10:29 AM By: Jim Gales - Tab: 13 Plan 22x34

COPYRIGHT © 2008 ENGINEERING ENTERPRISES, INC.

Engineering Enterprises, Inc.
 CIVIL ENGINEERS & LAND SURVEYORS
 52 Wheeler Road
 Sugar Grove, Illinois 60554
 Phone: (630) 466-9350

VILLAGE OF SUGAR GROVE
 10 MUNICIPAL DRIVE
 SUGAR GROVE, IL 60554

NO.	DATE	REVISIONS
2	7/15/08	PER IDOT COMMENTS
1	7/2/08	PER IDOT COMMENTS

WHEELER ROAD LAPP RESURFACING

PLAN, CONSTRUCTION NOTES, AND DETAILS

DATE:	MAY 2008
PROJECT NO:	SG0825
FILE NO:	SG0825-PLAN
SHEET	13 OF 18

Path: H:\S\SG\PROJ\SG0825\DWG\DWG_FINAL_ENG\SG0825-PLAN