

FOR INDEX OF SHEETS, SEE SHEET NO.2

STATE OF ILLINOIS DEPARTMENT OF TRANSPORTATION DIVISION OF HIGHWAYS PLANS FOR PROPOSED FEDERAL AID HIGHWAY RESURFACING

**HANKES ROAD - FAU ROUTE 2300
PROJECT NO. M-9003(069)
SECTION NO. 08-00020-00-RS
FROM 5,900 FEET WEST OF ILLINOIS ROUTE 56
TO 100' WEST OF ILLINOIS ROUTE 56
VILLAGE OF SUGAR GROVE
KANE COUNTY
JOB NO. C-91-519-08**

F.A.U. RTE.	SECTION	COUNTY	TOTAL SHEETS	SHEET NO.
2300	08-00020-00-RS	KANE	17	1
FED. ROAD DIST. NO.		ILLINOIS	FED. AID PROJECT - IAPP	
CONTRACT NO. 63063				

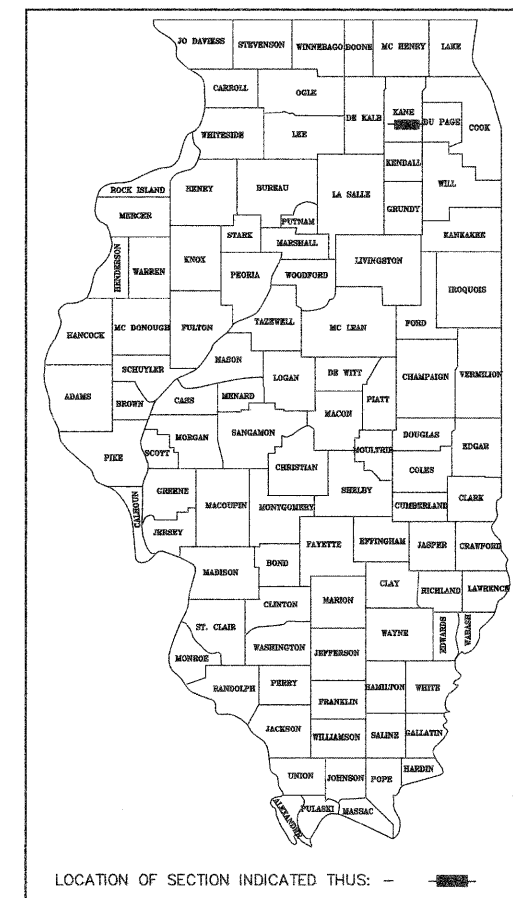

DESIGN DESIGNATION	
HANKES ROAD:	MINOR ARTERIAL DESIGN SPEED = 35 M.P.H. POSTED SPEED = 35 M.P.H. ADT(2008) = 3000

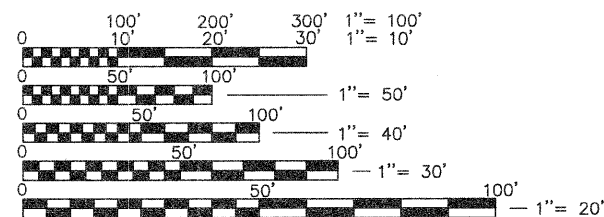

FULL SIZE PLANS HAVE BEEN PREPARED USING STANDARD ENGINEERING SCALES, REDUCED SIZED PLANS WILL NOT CONFORM TO STANDARD SCALES, IN MAKING MEASUREMENTS ON REDUCED PLANS, THE ABOVE SCALES MAY BE USED.

J.U.L.I.E.
JOINT UTILITY LOCATION INFORMATION FOR EXCAVATION
1-800-892-0123

CONTRACT 63063

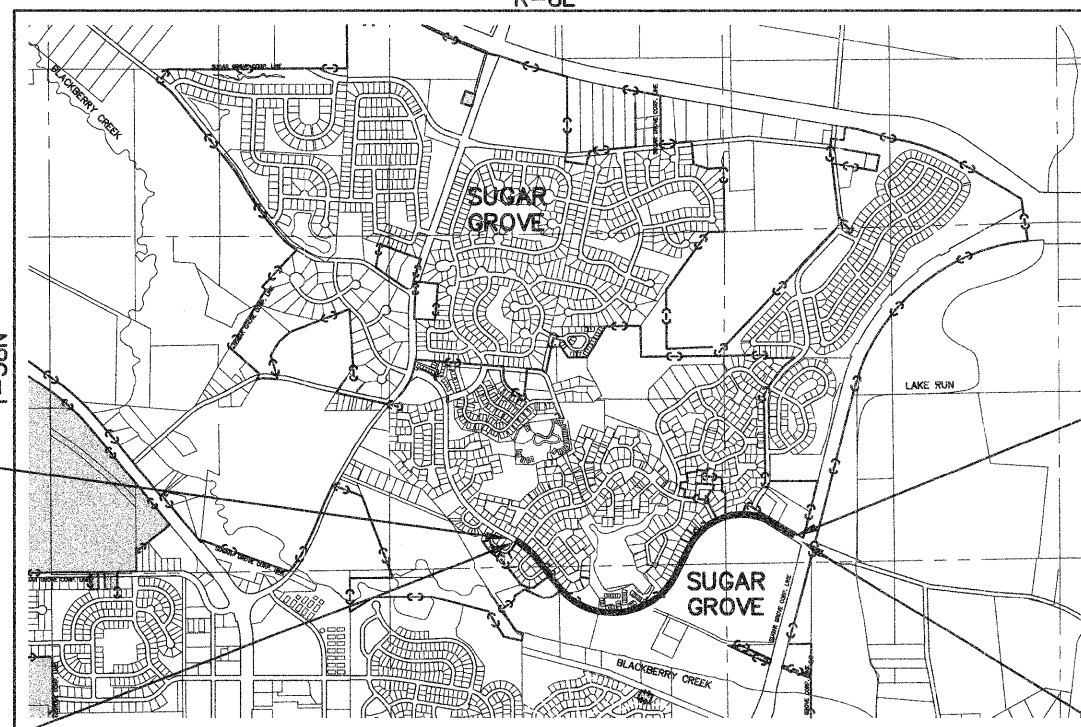

PROJECT BEGINS
STA. 5+00.00
HANKES RD.

CONSTRUCTION ENDS
STA. 63+23
HANKES RD.

CONSTRUCTION BEGINS
STA. 5+23
HANKES RD.

PROJECT ENDS
STA. 65+29
HANKES RD.

LOCATION MAP
N.T.S.

GROSS LENGTH OF PROJECT = 5,800 FEET (1.10 MILES)
NET LENGTH OF PROJECT = 5,800 FEET (1.10 MILES)

TOPOGRAPHICAL INFORMATION FROM SURVEY
BY ENGINEERING ENTERPRISES, INC.

STATE OF ILLINOIS DEPARTMENT OF TRANSPORTATION DIVISION OF HIGHWAYS	
APPROVED	July 17, 2008 <i>Art Spauld</i> VILLAGE OF SUGAR GROVE, DIRECTOR OF PUBLIC WORKS
PASSED	July 23, 2008 <i>Christopher Holt</i> DISTRICT 1 ENGINEER OF LOCAL ROADS & STREETS
RELEASING FOR BID BASED ON LIMITED REVIEW	July 23, 2008 <i>Diane M. O'Keefe</i> DEPUTY DIRECTOR OF HIGHWAYS, REGION 1 ENGINEER

DATE: JULY 17, 2008
BY: *Nathaniel J. Koehneke*
NATHANIEL J. KOEHNEKE
LICENSE EXPIRES: NOVEMBER 30, 2009

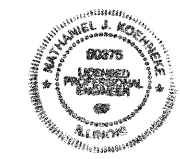

Engineering Enterprises, Inc.
CONSULTING ENGINEERS
52 Wheeler Road
Sugar Grove, Illinois 60554
Phone: (630) 466-9350

PRINTED BY THE AUTHORITY OF THE STATE OF ILLINOIS

FIELD ENGINEER: MARILYN SOLOMON (847) 705-4407
CONSULTING ENGINEER: ENGINEERING ENTERPRISES, INC. CONTACT: NATHANIEL J. KOEHNEKE (630)-466-9350
Plotted: July 15, 2008 @ 1:24 PM By: Jim Gates - Tab: 01 Cover 23x34
COPYRIGHT © 2008 ENGINEERING ENTERPRISES, INC.