

CONTRACT NO. 63071

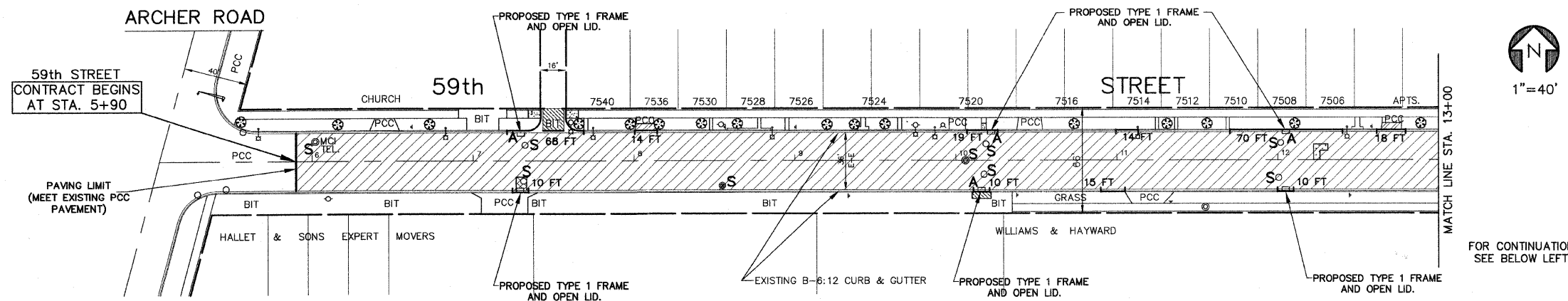

- LEGEND**
- DENOTES HOT-MIX ASPHALT SURFACE REMOVAL-BUTT JOINT, (4.5' WIDTH)
 - DENOTES DRIVEWAY PAVEMENT REMOVAL, 3" AND INCIDENTAL HOT-MIX ASPHALT SURFACING, 3"
 - DENOTES CLASS D PATCHES, TYPE II, 4" (FOR AGGREGATE BASE STREETS)
-AS DIRECTED BY THE ENGINEER
 - DENOTES CLASS D PATCHES, TYPE II-III, 8" (FOR CONCRETE BASE STREETS)
-AS DIRECTED BY THE ENGINEER
 - DENOTES PAVEMENT REMOVAL AND P.C. CONCRETE PAVEMENT REPLACEMENT, 8"
 - DENOTES HOT-MIX ASPHALT SURFACE REMOVAL (SEE SHEET 3 FOR SCOPE OF WORK)
 - DENOTES P.C. CONCRETE SIDEWALK, 5" REMOVAL AND SIDEWALK REMOVAL, WITH DETECTABLE WARNING STRIP WHERE APPLICABLE
 - "A"
DENOTES EXISTING VALVE VAULTS, VALVE BOXES, CATCH BASINS AND MANHOLES TO BE CLEANED, GROUTED, AND ADJUSTED TO GRADE WITH NEW ADJUSTING RINGS. (ALL TOP BANDS OF FALLEN COMMON OR CONCRETE BRICK TO BE REPLACED WITH PRECAST CONCRETE ADJUSTING RINGS)
 - "S"
DENOTES EXISTING STRUCTURES TO BE ADJUSTED (SPECIAL)
 - "F"
DENOTES EXISTING STRUCTURES TO BE FILLED
 - DENOTES COMBINATION CONCRETE CURB & GUTTER REMOVAL AND REPLACEMENT (DEPRESS AT SIDEWALK)
 - DENOTES EXISTING SIDEWALK RAMP TO REMAIN

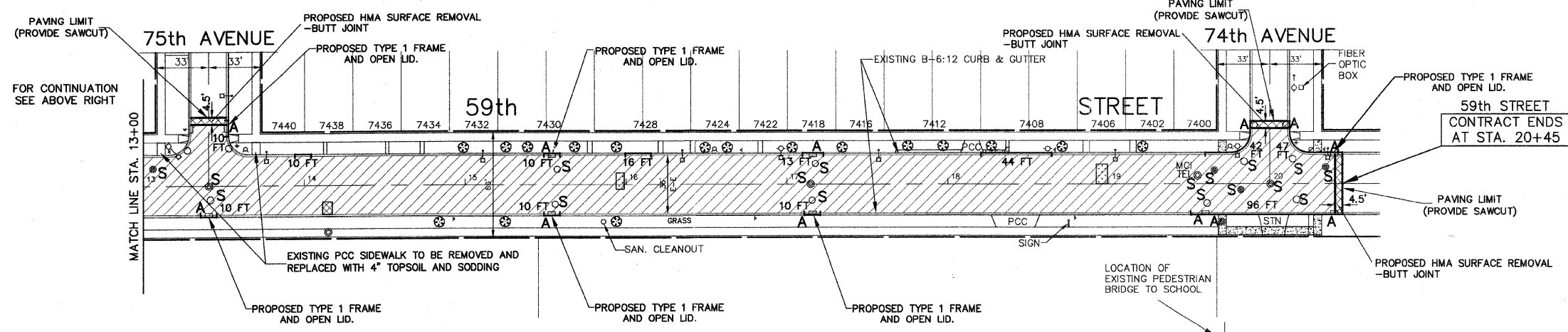

- NOTE:**
- 1 ALL NEW CATCH BASINS SHALL BE INSTALLED WITH HALF TRAPS, WHICH SHALL BE INCLUDED IN THE DRAINAGE STRUCTURE PAY ITEM.
 - 2 ALL EXISTING FRAMES AND LIDS THAT ARE TO BE REPLACED (AS DIRECTED BY THE ENGINEER) SHALL BE SALVAGED TO THE CONTRACTOR.
 - 3 STORM SEWER CONNECTIONS TO EXISTING MANHOLES AND CATCH BASINS SHALL BE CONSIDERED INCIDENTAL TO THE CONTRACT.
 - 4 ALL SAW CUTS SHALL BE CONSIDERED INCIDENTAL TO THE CONTRACT

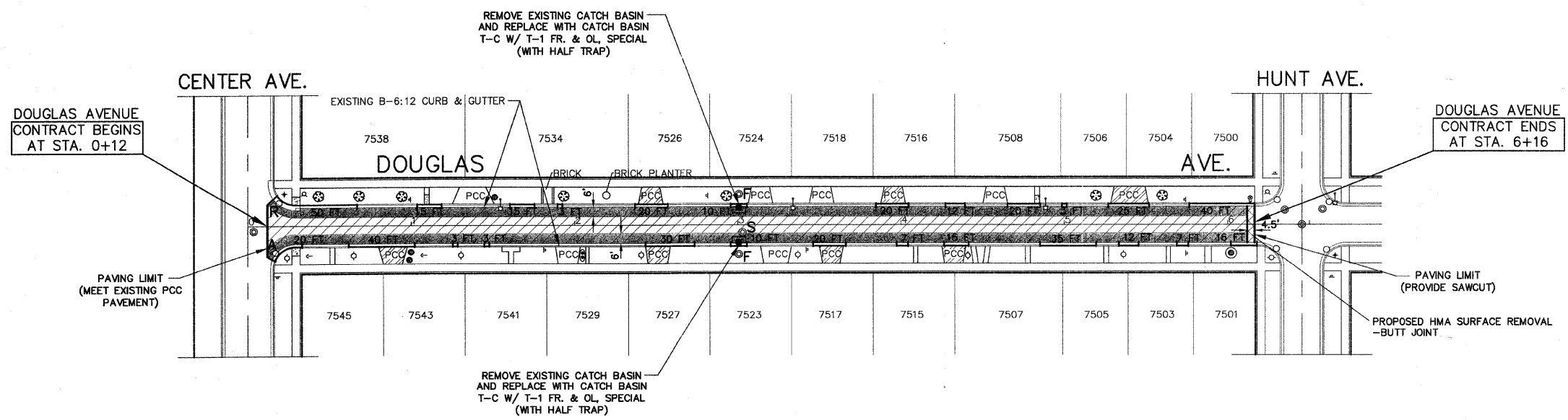

FOR TYPICAL CROSS SECTION OF NEW PAVEMENT WORK SEE SHEET 3

IMPORTANT!
FULL SIZE PLANS HAVE BEEN PREPARED USING STANDARD ENGINEERING SCALES. REDUCED SIZED PLANS WILL NOT CONFORM TO STANDARD SCALES INDICATED IN TITLE BLOCK.

REVISIONS			
NO.	BY	DATE	DESCRIPTION

PLAN:
59th ST.- ARCHER RD. to 74th AVE.
DOUGLAS AVE.- CENTER AVE. to HUNT AVE.

PROJECT NO. 07371	SCALE NONE	SHEET 4
DRAWN/DESIGNED JFP/JLC	DATE MAY, 2008	OF 10
CHECKED/APPROVED JLC	FIELD BOOK NO. FILE	SHEETS