

STATE OF ILLINOIS  
DEPARTMENT OF TRANSPORTATION

ROUTE NO.	SECTION	COUNTY	TOTAL SHEETS	SHEET NO.
U.S. 20	(3)BM-1	WINNEBAGO	13	13
FED. ROAD DIST. NO. 7		ILLINOIS	FED. AID PROJECT-	

CONTRACT # 64E16

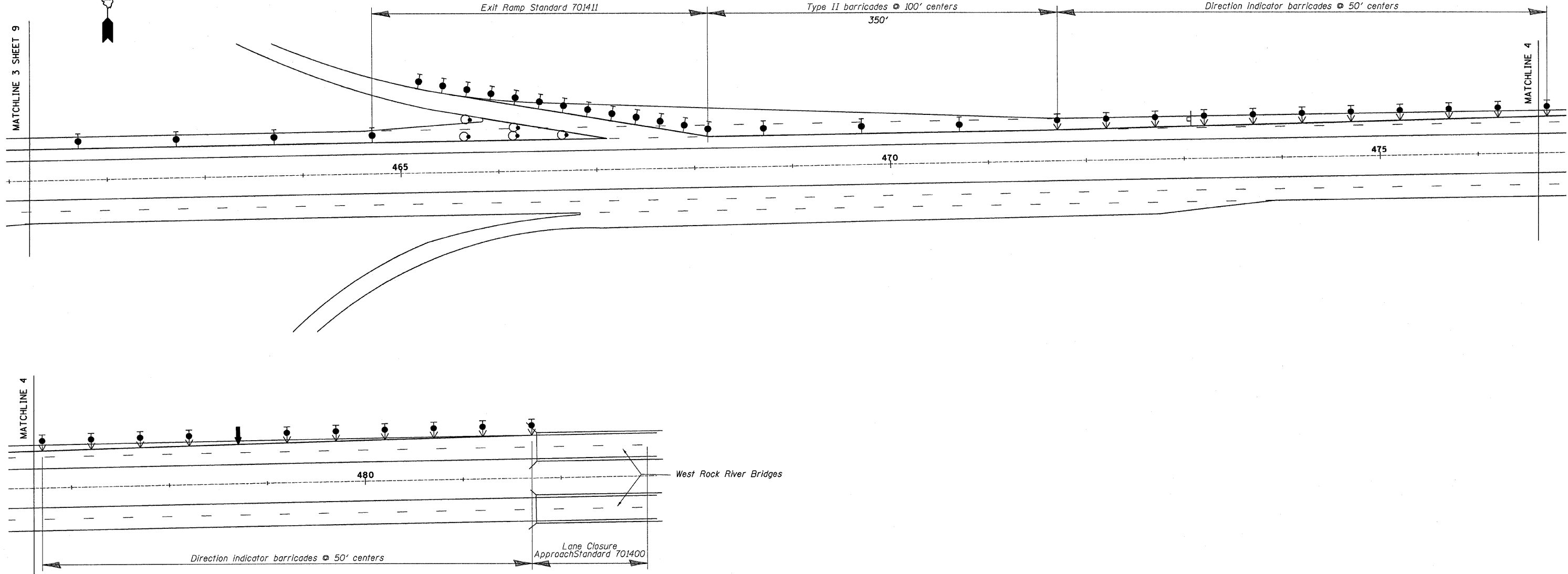

DESIGNED	M.H.
CHECKED	P.B.
DRAWN	M.H.
CHECKED	P.B.

TRAFFIC CONTROL AND PROTECTION  
STAGE II  
US ROUTE 20 OVER ILLINOIS ROUTE 2  
FAP ROUTE 301 (US20), SECTION (3)BM-1  
WINNEBAGO COUNTY  
STATION 455+34.50  
STRUCTURE NO. 101-0055 & 101-0056

SCALE: 1" = 50' DATE: May, 2008  
Soodan & Associates, Inc.  
100 North LaSalle Street, Suite 1900  
Chicago, Illinois 60602

Soodan