

| F.A.P. RTE.                  | SECTION         | COUNTY | TOTAL SHEETS     | SHEET NO. |
|------------------------------|-----------------|--------|------------------|-----------|
| 326                          | (111CS) W&RS-21 | GRUNDY | 85               | 85-J      |
| STA. TO STA.                 |                 |        | FED. AID PROJECT |           |
| FED. ROAD DIST. NO. ILLINOIS |                 |        |                  |           |

**SO-DEEP**  
The Subsurface Utility Engineering Company  
449 Monroe Falls Road  
Tallmadge, OH 44278  
(330) 794-4455

### So-Deep Test Hole Certification Form

© So-Deep 1988, 1991

So-Deep, Corporate Office  
8397 Euclid Avenue  
Manassas Park, VA 20111  
(703)361-6005  
Control # 36.8433  
Test Hole # 110  
Plan Scale 1"=30'  
Sheet # 2  
SPORM X-ING  
Proposed Date JULY 15, 2008

City, County, State CITY OF MORRIS, IL  
Gen. Loc. NW CORNER JEFFERSON ST & DIVISION ST  
Recorded Size/Material/Type 9" W&R UNK. TYPE (AT&T) TELE. DUCT  
Foreman/Truck/Form By J. CLINE / 219 / P. REYNOLDS

Condition of paving prior to work ASPHALT RDWY IN GOOD COND.

B.M. 1 Elev. = 828.81'  
is GIVEN  
B.M. 2 Elev. = 818.18'  
is GIVEN

Description: (BM #102) TOP OF RR SPIKE FOUND IN L.P., 37' LT OF STA. 15+97.8, DIVISION ST.  
Description: (BM #101) CHIS "X" FOUND NE CAP BOLT OF P.H., 39' RT OF STA. 11+488, DIVISION ST.

SO-DEEP will attempt to use the B.M.'s most applicable to your design. If however, B.M.'s differ by more than .05', resulting differences could cause design conflicts.

Benchmarks check BY 0.00'  
Elevations are referenced to B.M.#1

Recorded Size/Type of utility WAS FOUND

There WERE additional utilities in the test hole

The utility WAS in good condition.

Paving Thickness and type 1" ASPHALT

Color of ribbon installed ORANGE & BLUE

Soil Type MOIST SAND

Field Condition MODERATE RD TRAFFIC

T.H. tied to P.K. NAIL

9" 4 1/2" P.L.A. (AT&T) TELE. CONDUITS 1.12" H"  
Size/Material/Type  
Portion of pipe exposed for C.D. measurement:  
N/A

Remarks: ALSO FOUND IN TEST HOLE A 8" D.I. (C.O.M.) WATER LINE RUNNING BENEATH & PERPENDICULAR TO THE 9" TELE. CONDUITS. TELE. DUCT CONTAINS FIBER OPTICS AT THIS LOCATION.

PREPARED WITHOUT AT&T RECORDS. WE ACCEPT NO LIABILITY FOR FACILITIES OTHER THAN THOSE DEPICTED ON THIS CERTIFICATION FORM.

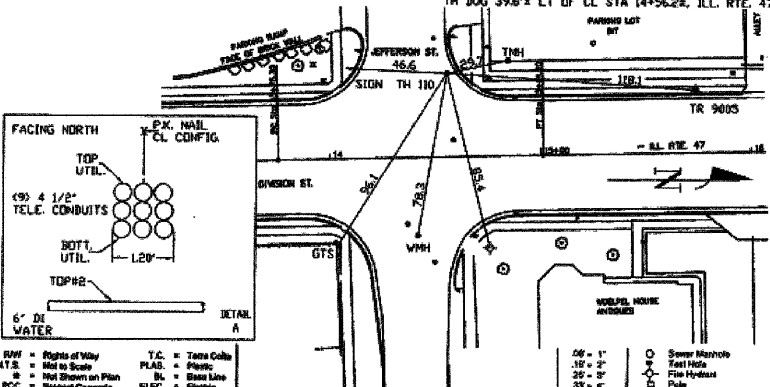

- |                              |                      |           |                         |
|------------------------------|----------------------|-----------|-------------------------|
| B.W. = Right of Way          | T.C. = Trench Collar | 26" - 1"  | ○ Sewer Manhole         |
| N.T.S. = Not to Scale        | P.L.A. = Plastic     | 18" - 2"  | ○ Test Hole             |
| PC = Precast Concrete        | BL = Base Line       | 20" - 3"  | ○ Fire Hydrant          |
| CONC. = Concrete             | ELEC. = Electric     | 22" - 4"  | ○ Pole                  |
| O.D. = Outside Diameter      | TELE. = Telephone    | 24" - 6"  | ○ Fence Line            |
| CL = Cast Iron               | T.H. = Test Hole     | 26" - 8"  | ○ Electric Manhole      |
| DL = Ductile Iron            | SW = Sewer           | 28" - 7"  | ○ T.S. = Trench Station |
| R.P.C. = Rough Pore Concrete | DW = Driveway        | 30" - 6"  | ○ Valve                 |
| CL = Cast Iron               | BM = Benchmark       | 32" - 5"  | ○ Water Meter           |
|                              | C.B. = Catch Basin   | 34" - 10" | ○ Telephone Manhole     |
|                              | GV = Gas Valve       | 36" - 11" | □ Telephone Pedestal    |

Performing out-of-sight work...with vision!<sup>SM</sup>

Note: To eliminate mistakes and check this work, So-Deep suggests you scale and plot all dimensions on the plan and review all elevations carefully. So-Deep is responsible only for information shown on our forms.

**SO-DEEP**  
The Subsurface Utility Engineering Company  
449 Monroe Falls Road  
Tallmadge, OH 44278  
(330) 794-4455

### So-Deep Test Hole Certification Form

© So-Deep 1988, 1991

So-Deep, Corporate Office  
8397 Euclid Avenue  
Manassas Park, VA 20111  
(703)361-6005  
Control # 36.8433  
Test Hole # 111  
Plan Scale 1"=30'  
Sheet # 2  
CURB & GUTTER  
Proposed Date JULY 15, 2008

City, County, State CITY OF MORRIS, IL  
Gen. Loc. NE CORNER OF JEFFERSON ST & DIVISION ST  
Recorded Size/Material/Type 8" UNK TYPE (C.O.M.) WATER LINE  
Foreman/Truck/Form By J. CLINE / 219 / P. REYNOLDS

Condition of paving prior to work CONG. GUTTER IN GOOD CONDITION

B.M. 1 Elev. = 828.81'  
is GIVEN  
B.M. 2 Elev. = 818.18'  
is GIVEN

Description: (BM #102) TOP OF RR SPIKE FOUND IN L.P., 37' LT OF STA. 15+97.8, DIVISION ST.  
Description: (BM #101) CHIS "X" FOUND NE CAP BOLT OF P.H., 39' RT OF STA. 11+488, DIVISION ST.

SO-DEEP will attempt to use the B.M.'s most applicable to your design. If however, B.M.'s differ by more than .05', resulting differences could cause design conflicts.

Benchmarks check BY 0.00'  
Elevations are referenced to B.M.#1

Recorded Size/Type of utility WAS FOUND

There WERE NOT additional utilities in the test hole

The utility WAS in good condition.

Paving Thickness and type 1" CONCRETE

Color of ribbon installed BLUE

Soil Type WET SAND

Field Condition CONCRETE GUTTER

T.H. tied to CHIS "X"

8" 3" D.I. WATER LINE  
Size/Material/Type  
Portion of pipe exposed for C.D. measurement:  
FULL

Remarks: NONE

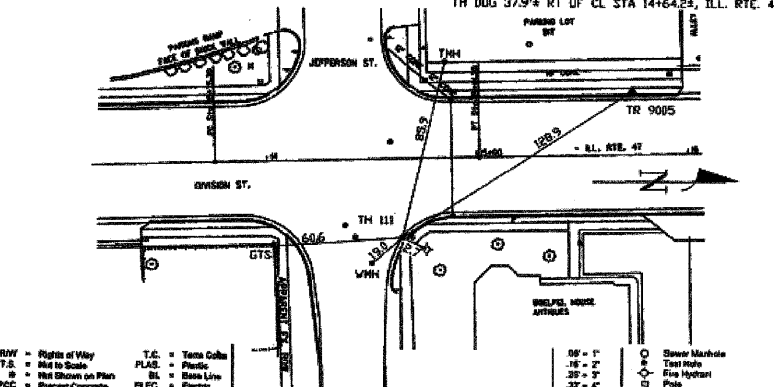

- |                              |                      |           |                         |
|------------------------------|----------------------|-----------|-------------------------|
| B.W. = Right of Way          | T.C. = Trench Collar | 26" - 1"  | ○ Sewer Manhole         |
| N.T.S. = Not to Scale        | P.L.A. = Plastic     | 18" - 2"  | ○ Test Hole             |
| PC = Precast Concrete        | BL = Base Line       | 20" - 3"  | ○ Fire Hydrant          |
| CONC. = Concrete             | ELEC. = Electric     | 22" - 4"  | ○ Pole                  |
| O.D. = Outside Diameter      | TELE. = Telephone    | 24" - 6"  | ○ Fence Line            |
| CL = Cast Iron               | T.H. = Test Hole     | 26" - 8"  | ○ Electric Manhole      |
| DL = Ductile Iron            | SW = Sewer           | 28" - 7"  | ○ T.S. = Trench Station |
| R.P.C. = Rough Pore Concrete | DW = Driveway        | 30" - 6"  | ○ Valve                 |
| CL = Cast Iron               | BM = Benchmark       | 32" - 5"  | ○ Water Meter           |
|                              | C.B. = Catch Basin   | 34" - 10" | ○ Telephone Manhole     |
|                              | GV = Gas Valve       | 36" - 11" | □ Telephone Pedestal    |

Performing out-of-sight work...with vision!<sup>SM</sup>

Note: To eliminate mistakes and check this work, So-Deep suggests you scale and plot all dimensions on the plan and review all elevations carefully. So-Deep is responsible only for information shown on our forms.

**SO-DEEP**  
The Subsurface Utility Engineering Company  
449 Monroe Falls Road  
Tallmadge, OH 44278  
(330) 794-4455

### So-Deep Test Hole Certification Form

© So-Deep 1988, 1991

So-Deep, Corporate Office  
8397 Euclid Avenue  
Manassas Park, VA 20111  
(703)361-6005  
Control # 36.8433  
Test Hole # 112  
Plan Scale 1"=30'  
Sheet # 2  
CURB & GUTTER  
Proposed Date JULY 12, 2008

City, County, State CITY OF MORRIS, IL  
Gen. Loc. DIVISION ST JUST NORTH OF JEFFERSON ST  
Recorded Size/Material/Type 8" W&R UNK. TYPE (AT&T) TELE. DUCT  
Foreman/Truck/Form By J. CLINE / 219 / P. REYNOLDS

Condition of paving prior to work CONG. SW IN GOOD CONDITION

B.M. 1 Elev. = 828.81'  
is GIVEN  
B.M. 2 Elev. = 828.81'  
is GIVEN

Description: (BM #102) TOP OF RR SPIKE FOUND IN L.P., 37' LT OF STA. 15+97.8, DIVISION ST.  
Description: (BM #104) CHIS "X" FOUND NE CAP BOLT OF P.H., 40' RT OF STA. 21+352, DIVISION ST.

SO-DEEP will attempt to use the B.M.'s most applicable to your design. If however, B.M.'s differ by more than .05', resulting differences could cause design conflicts.

Benchmarks check BY 0.00'  
Elevations are referenced to B.M.#1

Recorded Size/Type of utility WAS FOUND

There WERE NOT additional utilities in the test hole

The utility WAS in good condition.

Paving Thickness and type 4" CONCRETE

Color of ribbon installed ORANGE

Soil Type MOIST SAND

Field Condition CONCRETE SW

T.H. tied to CHIS "X"

8" 4 1/2" P.L.A. (AT&T) TELE. CONDUITS 0.96" H"  
Size/Material/Type  
Portion of pipe exposed for C.D. measurement:  
N/A

Remarks: TELE. DUCT CONTAINS FIBER OPTICS AT THIS LOCATION.

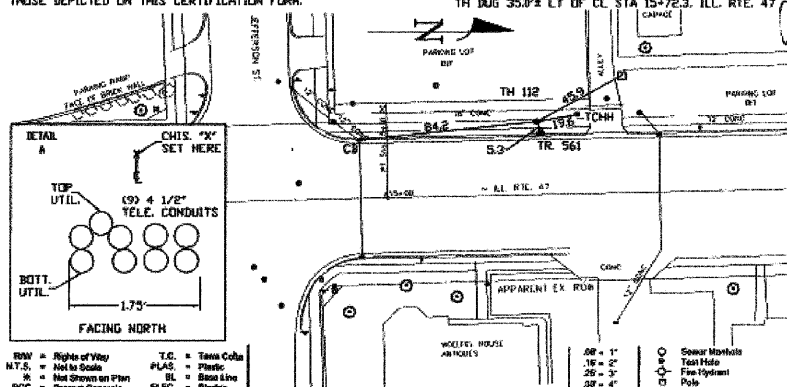

- |                              |                      |           |                         |
|------------------------------|----------------------|-----------|-------------------------|
| B.W. = Right of Way          | T.C. = Trench Collar | 26" - 1"  | ○ Sewer Manhole         |
| N.T.S. = Not to Scale        | P.L.A. = Plastic     | 18" - 2"  | ○ Test Hole             |
| PC = Precast Concrete        | BL = Base Line       | 20" - 3"  | ○ Fire Hydrant          |
| CONC. = Concrete             | ELEC. = Electric     | 22" - 4"  | ○ Pole                  |
| O.D. = Outside Diameter      | TELE. = Telephone    | 24" - 6"  | ○ Fence Line            |
| CL = Cast Iron               | T.H. = Test Hole     | 26" - 8"  | ○ Electric Manhole      |
| DL = Ductile Iron            | SW = Sewer           | 28" - 7"  | ○ T.S. = Trench Station |
| R.P.C. = Rough Pore Concrete | DW = Driveway        | 30" - 6"  | ○ Valve                 |
| CL = Cast Iron               | BM = Benchmark       | 32" - 5"  | ○ Water Meter           |
|                              | C.B. = Catch Basin   | 34" - 10" | ○ Telephone Manhole     |
|                              | GV = Gas Valve       | 36" - 11" | □ Telephone Pedestal    |

Performing out-of-sight work...with vision!<sup>SM</sup>

Note: To eliminate mistakes and check this work, So-Deep suggests you scale and plot all dimensions on the plan and review all elevations carefully. So-Deep is responsible only for information shown on our forms.

| REVISIONS |      |
|-----------|------|
| NAME      | DATE |
|           |      |
|           |      |
|           |      |
|           |      |
|           |      |

ILLINOIS DEPARTMENT OF TRANSPORTATION  
**SUBSURFACE UTILITY ENGINEERING TEST HOLES**  
SCALE: NONE  
DATE: 09/2007  
DRAWN BY: KHH  
CHECKED BY: FML